



For Sublease

Contact brokers for rate!

18875 E Bromley Lane

Brighton, CO 80601

Property Specifications

- Available Size: 100,000 - 774,155 SF
- Office Size: ±20,000 SF
- Power: Four (4) individual 2,500 KVA substations - each providing 3,000 amps / 480 volts / 3 phase
- Power Provider: United Power Cooperative
- Clear Height: 32'
- Loading: 22 Dock Doors
- Sprinklers: ESFR
- Column Spacing: 48' x 58'
- Slab Thickness: 8" Slab-on-grade
- 2025 OPEX: \$2.99/SF

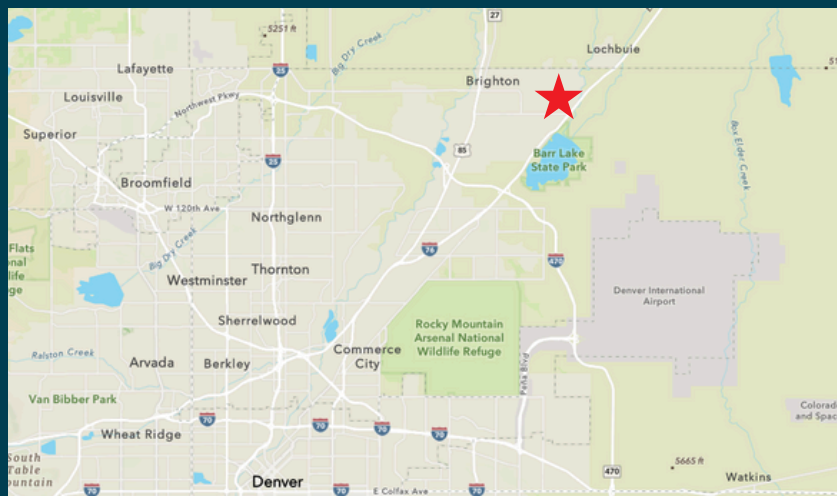
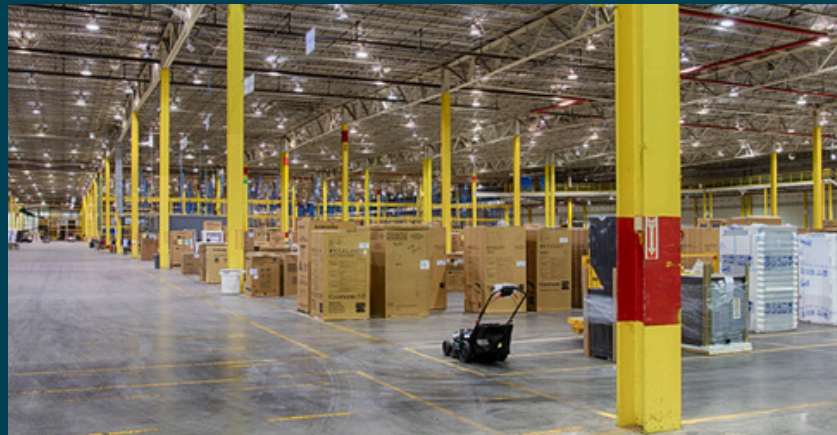

Industrial Warehouse Building for Sublease



For more information, please contact:

Carmon Hicks

Industrial Services

+1 303 217 7975

carmon.hicks@jll.com

Patrick McGettigan

Industrial Services

+1 303 217 7956

patrick.mcgettigan@jll.com

James McGill

Industrial Services

+1 303 260 6536

james.mcgill@jll.com



Although information has been obtained from sources deemed reliable, neither Owner nor JLL makes any guarantees, warranties or representations, express or implied, as to the completeness or accuracy as to the information contained herein. Any projections, opinions, assumptions or estimates used are for example only. There may be differences between projected and actual results, and those differences may be material. The Property may be withdrawn without notice. Neither Owner nor JLL accepts any liability for any loss or damage suffered by any party resulting from reliance on this information. If the recipient of this information has signed a confidentiality agreement regarding this matter, this information is subject to the terms of that agreement.

©2025. Jones Lang LaSalle IP, Inc. All rights reserved