



For Sublease

67,572 SF Available



26533 Evergreen Road | Southfield, MI

Property Highlights

- 67,572 SF of open office space on the 6th and 7th floor
- Move in ready
- Building amenities include: covered parking, fitness center, cafeteria, sundry shop, dry cleaning, and on site management
- Located in Southfield's premier office district
- Sublease through 4/30/2026



Photos



**Interior renderings*

Although information has been obtained from sources deemed reliable, JLL does not make any guarantees, warranties or representations, express or implied, as to the completeness or accuracy as to the information contained herein. Any projections, opinions, assumptions or estimates used are for example only. There may be differences between projected and actual results, and those differences may be material. JLL does not accept any liability for any loss or damage suffered by any party resulting from reliance on this information. If the recipient of this information has signed a confidentiality agreement with JLL regarding this matter, this information is subject to the terms of that agreement. ©2025. Jones Lang LaSalle IP, Inc. All rights reserved.



Floor Plans

6th Floor | 33,786 SF Available

14 Offices & 235 Desks

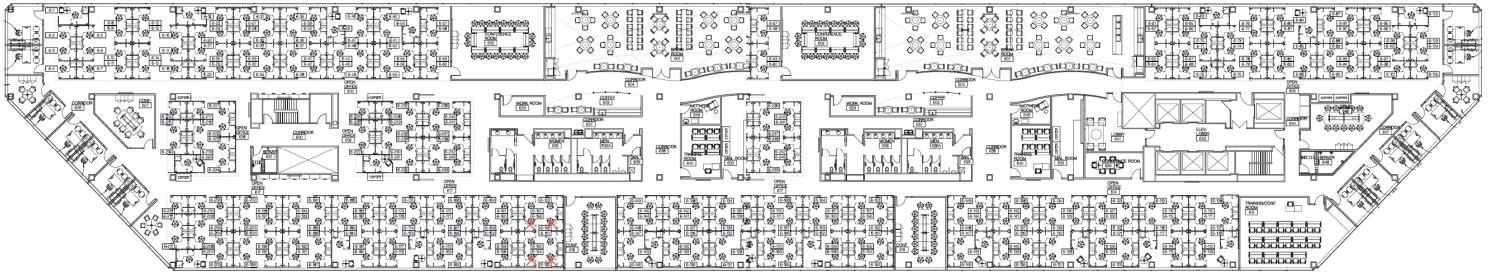

7th Floor | 33,786 SF Available

5 Offices & 150 Desks

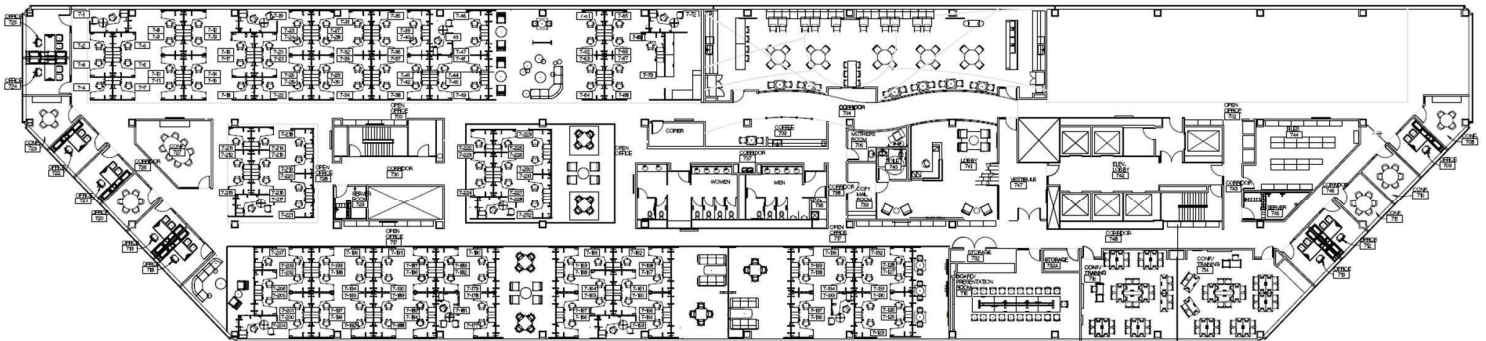

Contact

Dave MacDonald

+1 248 581 3333
dave.macdonald@jll.com

Zach Resnick

+1 248 581 3263
zach.resnick@jll.com

Although information has been obtained from sources deemed reliable, JLL does not make any guarantees, warranties or representations, express or implied, as to the completeness or accuracy as to the information contained herein. Any projections, opinions, assumptions or estimates used are for example only. There may be differences between projected and actual results, and those differences may be material. JLL does not accept any liability for any loss or damage suffered by any party resulting from reliance on this information. If the recipient of this information has signed a confidentiality agreement with JLL regarding this matter, this information is subject to the terms of that agreement. ©2025. Jones Lang LaSalle IP, Inc. All rights reserved.

