

# For Lease

Premier office space available



## Property specifications

Availabilities	2 <sup>nd</sup> floor: 2,440 SF
	2 <sup>nd</sup> floor: 7,567 SF (Fully furnished, high-end finishes)
	3 <sup>rd</sup> floor: 2,349 SF
	3 <sup>rd</sup> floor: 2,047 SF
	3 <sup>rd</sup> floor: 786 SF
	4 <sup>th</sup> floor: 4,292 SF
	5 <sup>th</sup> floor: 4,118 SF
	5 <sup>th</sup> floor: 2,581 SF

Rental rate	\$34.50 PSF plus utilities
-------------	----------------------------

Possession	Immediate
------------	-----------

Building highlights	<ul style="list-style-type: none"><li>• Ground floor retail including Ruth's Chris Steak House, Jos. A. Bank &amp; Visionworks</li><li>• Concierge, café, 24/7 building access</li><li>• On-site management</li></ul>
---------------------	---

Location	<ul style="list-style-type: none"><li>• Walking distance to Roosevelt Field Mall</li><li>• Close proximity to Meadowbrook Parkway (Exit M1)</li></ul>
----------	---

**600 Old Country Road  
Garden City, NY**

### Joseph Lopresti

Executive Vice President  
Licensed Real Estate Salesperson  
+1 631 962 7384  
[joseph.lopresti@jll.com](mailto:joseph.lopresti@jll.com)

### Kyle Crennan

Managing Director  
Licensed Real Estate Salesperson  
+1 631 962 2896  
[kyle.crennan@jll.com](mailto:kyle.crennan@jll.com)



Floor plan: 5th floor: 4,118 SF and 2<sup>nd</sup> floor: 7,567 SF

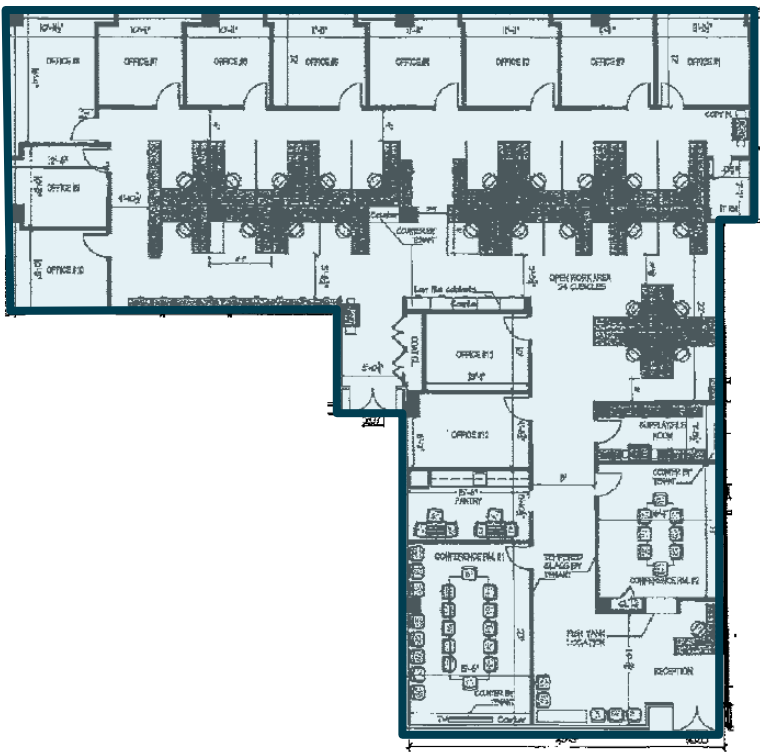
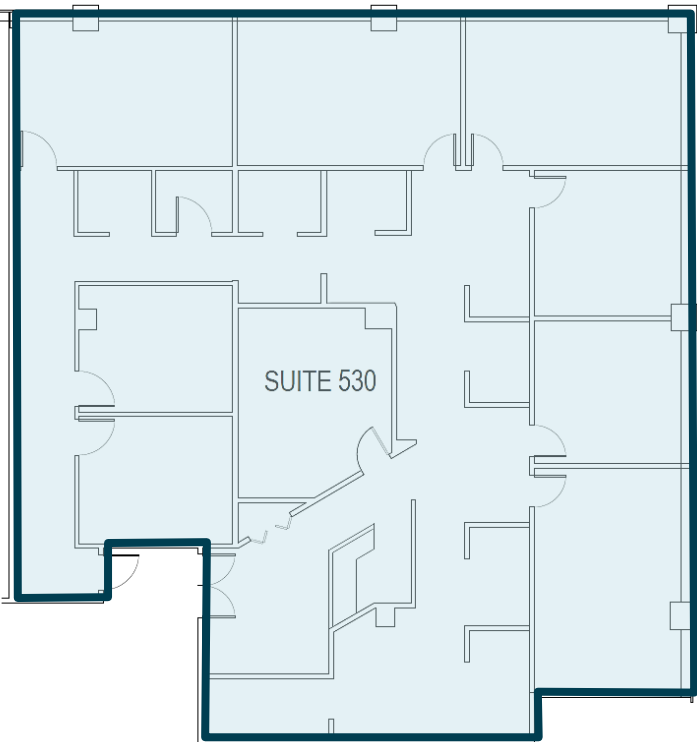

Location map:

