

Hauppauge Office Park

878 Veterans Memorial Highway, Hauppauge, NY



For Lease

Large Block Availability

 **JLL** SEE A BRIGHTER WAY

Specifications

Complex highlights

- 85 seat auditorium-style conference center
- 18 seat executive/boardroom style conferencing facility
- Fitness center with 2 racquetball courts, sauna, and steam room
- Full service café for breakfast, lunch, and catering
- On-site property management and security

Building features

- Furnished space
- Ideal for Headquarters
- Loading dock
- Tremendous parking ratio
- Rental rate: upon request

Floor	Availability	Possession
Garden level	8,000 SF	Arranged
1st floor	20,329 SF	Arranged
2nd floor	20,329 SF	Arranged
3rd floor	20,329 SF	Arranged



Floor plans

1st floor: 20,329 SF

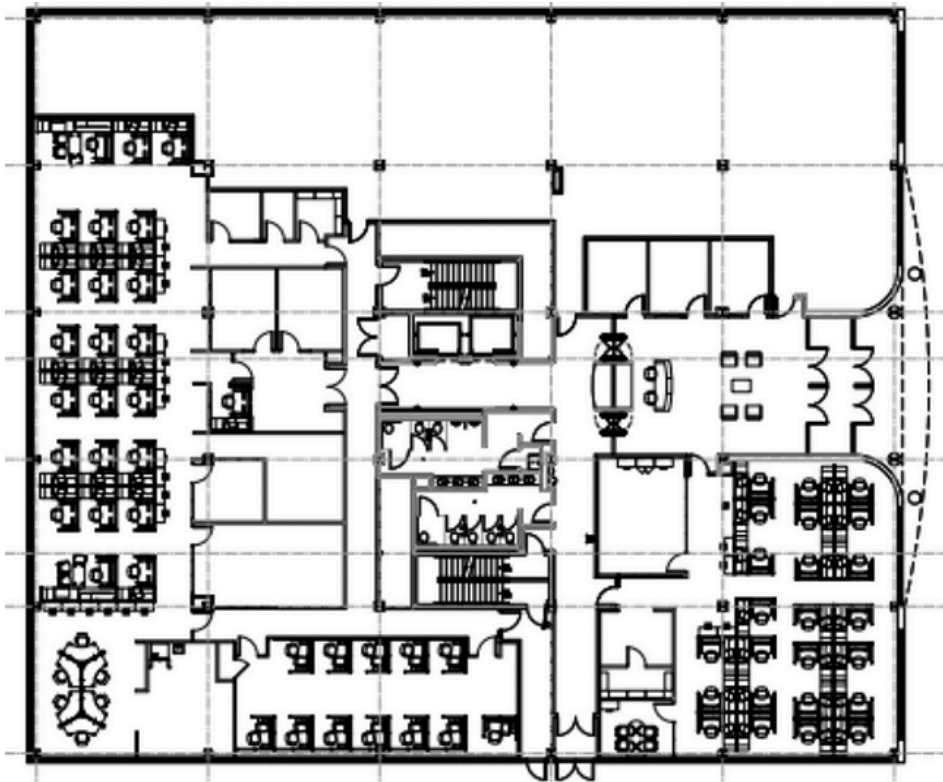

2nd & 3rd floor: 20,329 SF

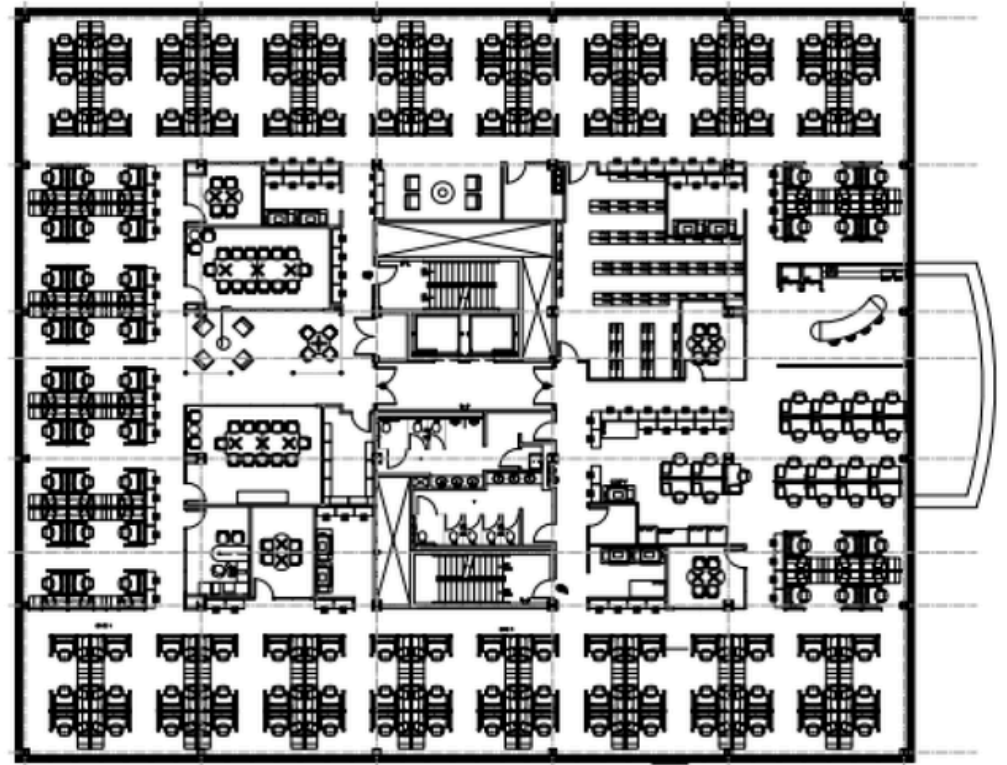



For more information, please contact:

Ray Ruiz

Managing Director
Licensed Real Estate Broker
ray.ruiz@jll.com
+1 631 962 2890

Marianne Dugan

Vice President
Licensed Real Estate Salesperson
marianne.dugan@jll.com
+1 631 962 2891

John A. Nielsen

Vice President
Licensed Real Estate Salesperson
johna.nielsen@jll.com
+1 631 962 7382