

# 6,124 SF

**7220 Fenwick Lane**  
**Westminster, CA 92683**

Prologis West Orange County Business Center

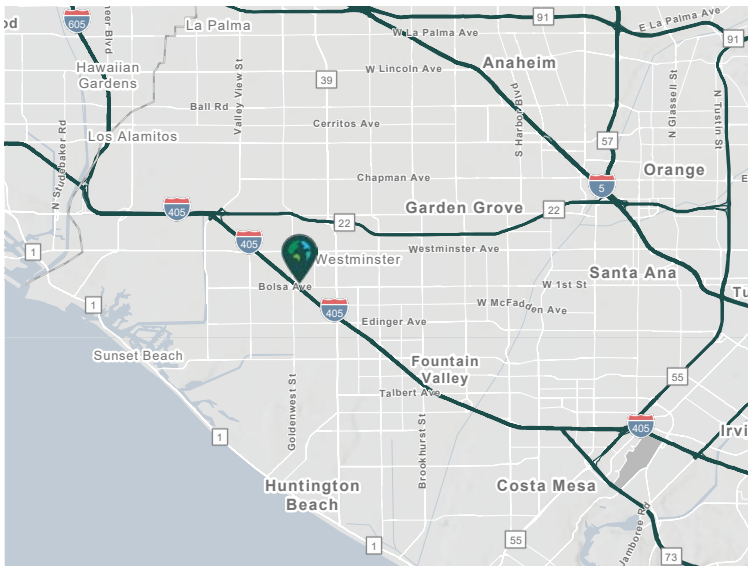

- Immediate access to the 405 Freeway
- Strategic West Orange County location with skilled and diversified work force
- Close to retail/dining amenities at the Westminster Mall and Bella Terra

## Property Features

Available Space	+6,124 SF
Warehouse SF	+5,608 SF
Office SF	+516 SF
Clear Height	16'-6"
Drive-in Door	1
Car Parking Ratio	+1.25/1,000 SF
Electrical Service	400a, 120/208v
Sprinkler	.33 gpm/3,000 SF
Yard	Fenced/shared yard



Unlock the full potential of your  
**warehouse with one strategic,  
single-source partner.**

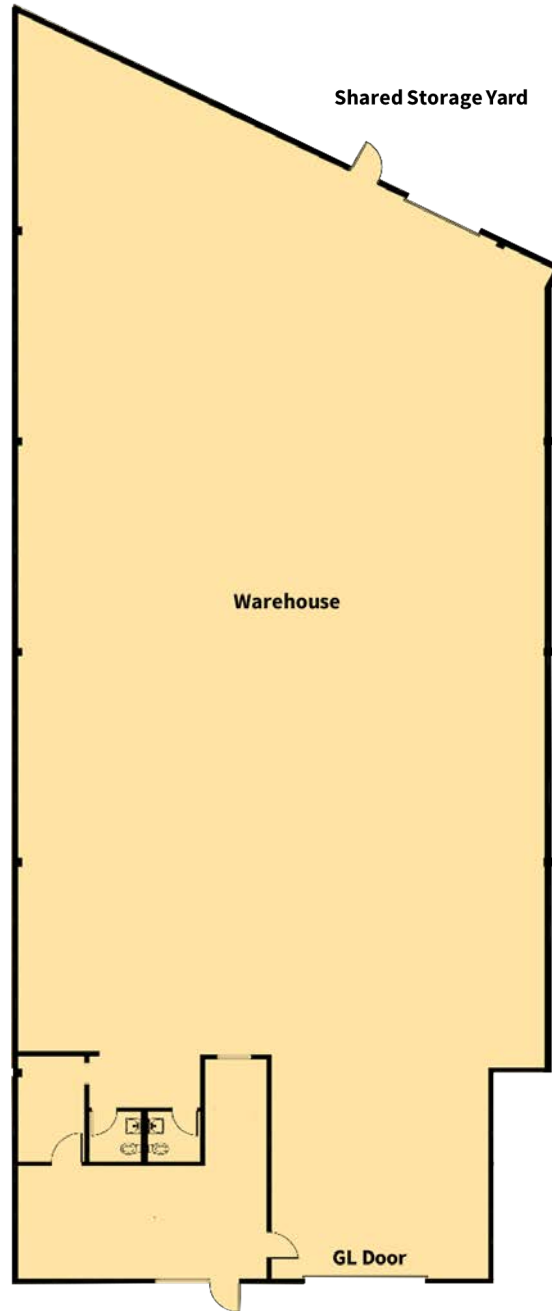

**JLL**  
**Steve Wagner**  
steve.wagner@jll.com  
ph +1 949 683 9780  
License #01314652

**JLL**  
**Zach Niles**  
zach.niles@jll.com  
ph +1 949 278 6608  
License #01311756

**JLL**  
**Louis Tomaselli**  
louis.tomaselli@jll.com  
ph +1 949 885 2985  
License #00904844

**Prologis**  
**Parker Hutchison**  
phutchison@prologis.com  
ph +1 562 345 9209  
prologis.com  
Cal DRE License #01944561