

# For lease

10715 Springdale Ave, Unit 4  
Santa Fe Springs, CA 90670



**Building size** 14,400 SF

**Office size** 1,775 SF

**Clear height** 22'

**Sprinkler system** .33/3,000 GPM calculated

**Loading** 2 DH with edge of dock levelers

**Power** 225 amps, 277/480 volts (verify)

**Asking rate** TBD

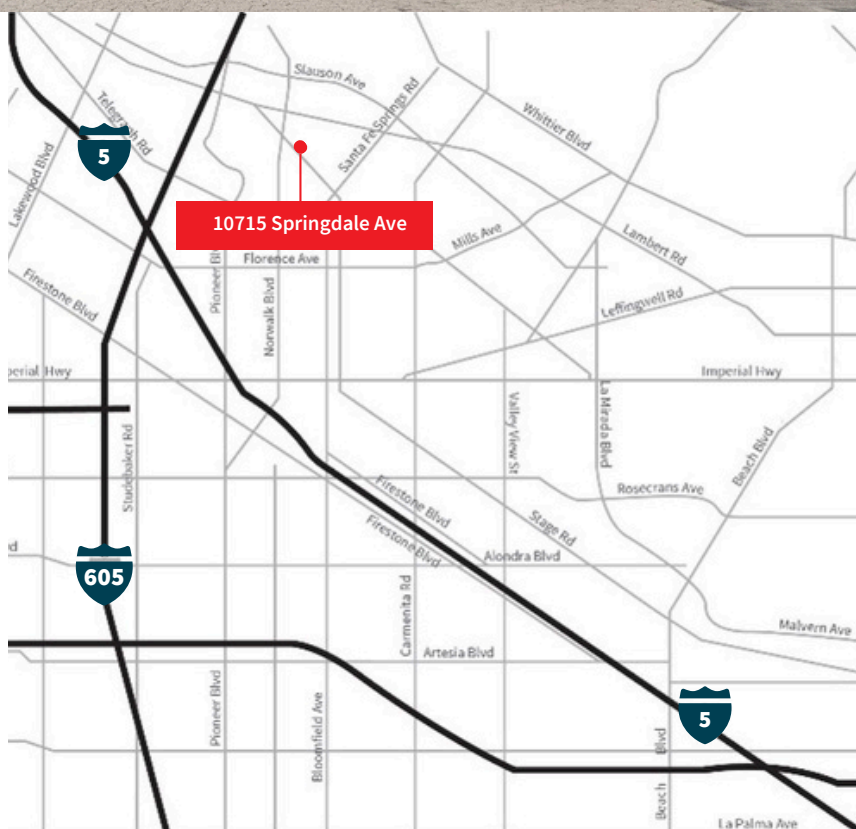



Property Photos



# 10715 Springdale Ave, Unit 4 Santa Fe Springs

10715 Springdale

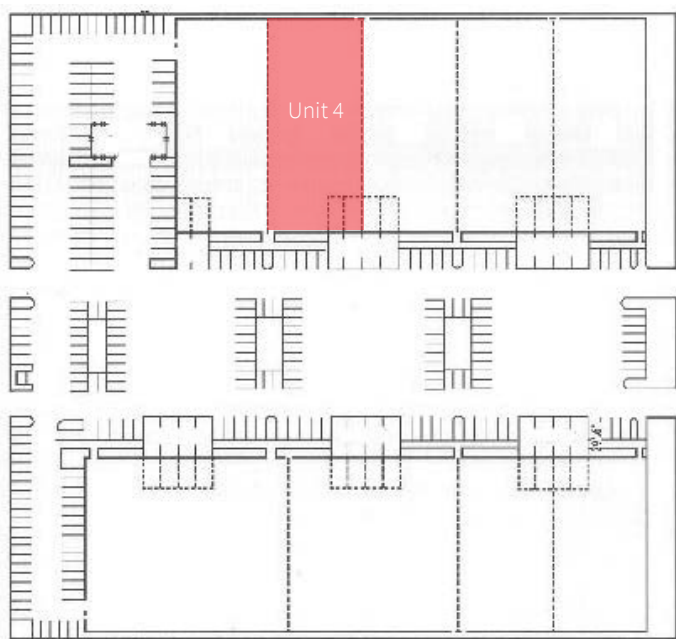

10725 Springdale

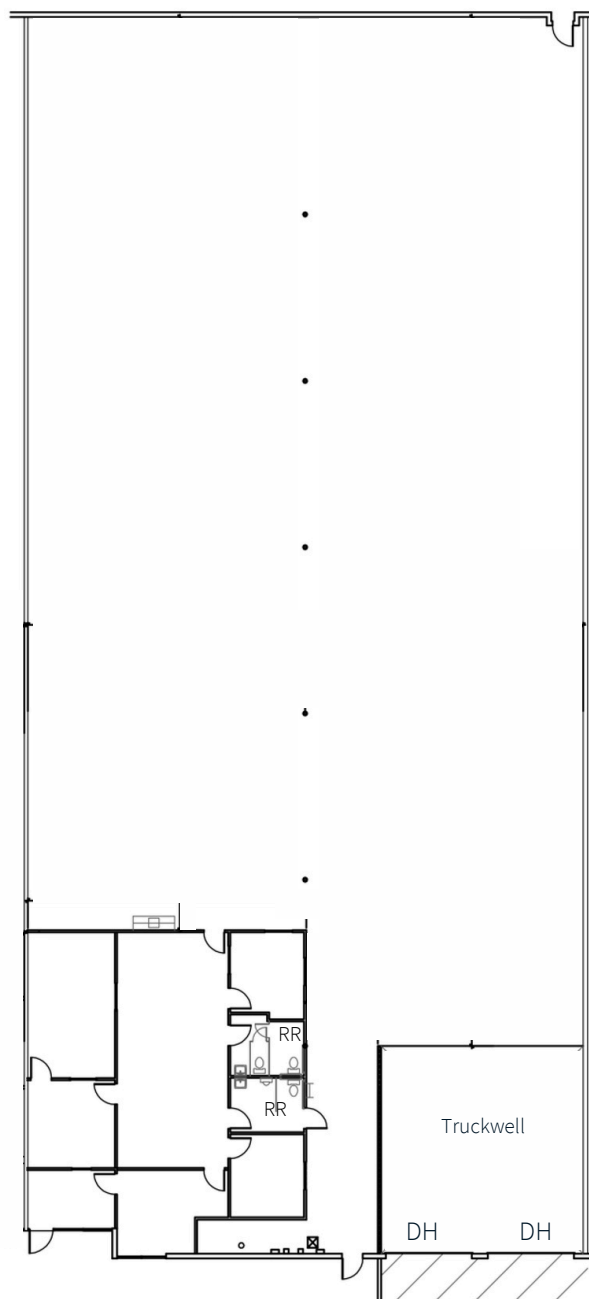

Although information has been obtained from sources deemed reliable, neither Owner nor JLL makes any guarantees, warranties or representations, express or implied, as to the completeness or accuracy as to the information contained herein. Any projections, opinions, assumptions or estimates used are for example only. There may be differences between projected and actual results, and those differences may be material. The Property may be withdrawn without notice. Neither Owner nor JLL accepts any liability for any loss or damage suffered by any party resulting from reliance on this information. If the recipient of this information has signed a confidentiality agreement regarding this matter, this information is subject to the terms of that agreement. © 2024 Jones Lang LaSalle IP, Inc. All rights reserved.

## Ashley Ramirez

ashley.ramirez@jll.com  
(949) 885-2913  
Lic. #02106273

## Luke McDaniel

luke.mcdaniel@jll.com  
(949) 885-2974  
Lic. #01203625

## Cameron Driscoll

cameron.driscoll@jll.com  
(949) 885-2976  
Lic. #01224141

## Erin McCloskey

erin.mccloskey@jll.com  
(949) 930-7891  
Lic. #02244405