

For Lease: Building 3

13,153 SF

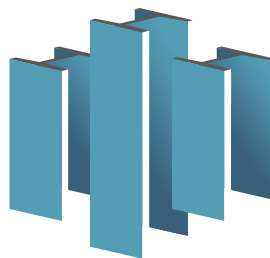

4725-E Entrance Dr
Charlotte, NC

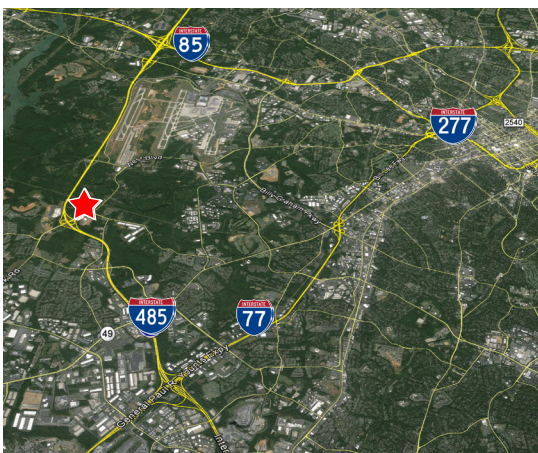

STEELE CREEK
COMMERCE PARK



LEASING BY:



Brad Cherry, CCIM, SIOR

Executive Managing Director

+1 704 927 3013

brad.cherry@jll.com

Spencer Yorke

Executive Managing Director

+1 704 996 7545

spencer.yorke@jll.com

Rich Grieder

Managing Director

+1 704 804 5783

rich.grieder@jll.com

OWNED & MANAGED BY:

EASTGROUP
PROPERTIES

JLL Charlotte | 650 S. Tryon Street, Suite 600 | Charlotte, NC 28209

For Lease: Building 3

13,153 SF

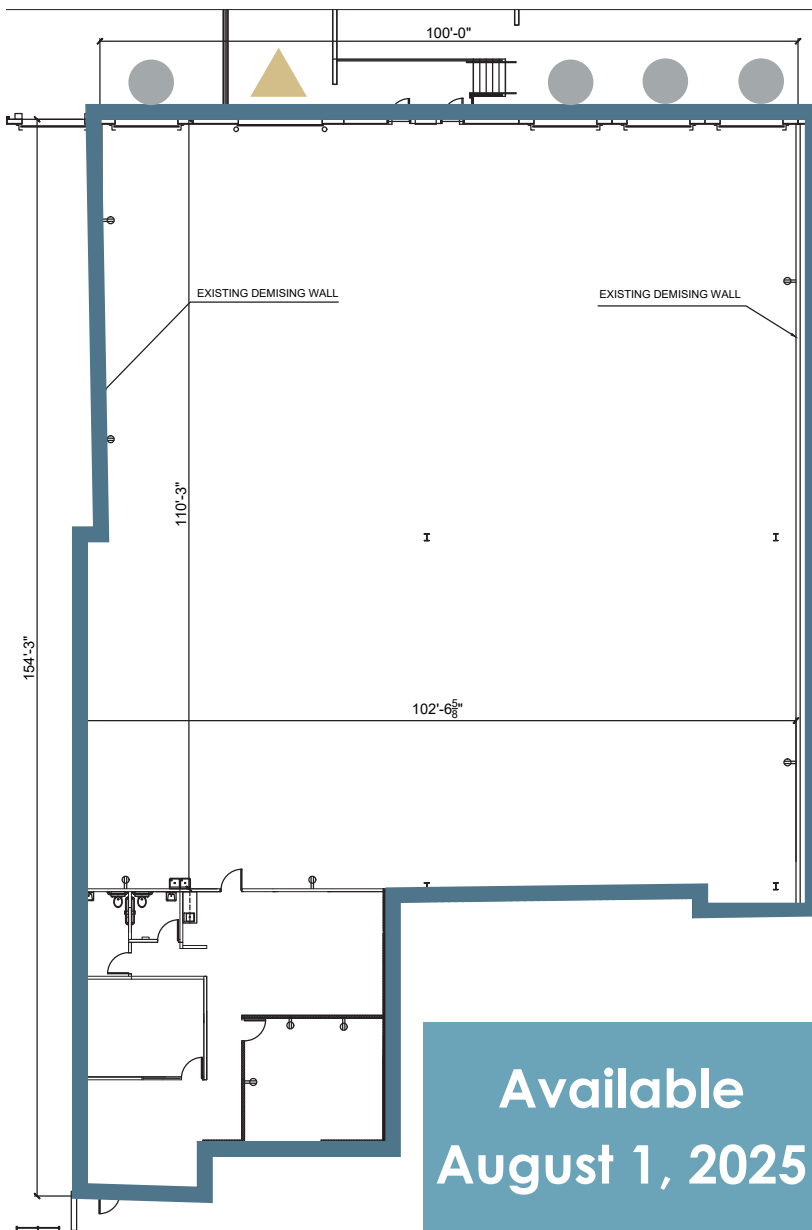

Building Features

Size (SF):	108,295
Available (SF):	13,153
Construction:	Tilt wall
Year built:	2014
Zoning:	I-2 (CD)
Sprinkler:	ESFR
Signage:	Building & monument
Parking:	Ample

Warehouse Features

Size (SF):	11,393
Ceiling Height:	30'
Loading:	Rear
Dock Doors:	4
Drive-in Doors:	1
Lighting:	T-5

Office Features

Size (SF):	1,760
------------	-------

Utilities

Sewer/Water:	Char-Meck
Power:	Duke
Gas:	PNG

Interstate Access:

Less than .5 miles to I-485
±4 miles to I-77
±5 miles to I-85



drive-in door



dock high door

LEASING BY:



OWNED & MANAGED BY:

EASTGROUP
PROPERTIES

Brad Cherry, CCIM, SIOR

Executive Managing Director

+1 704 927 3013

brad.cherry@jll.com

Spencer Yorke

Executive Managing Director

+1 704 996 7545

spencer.yorke@jll.com

Rich Grieder

Managing Director

+1 704 804 5783

rich.grieder@jll.com

JLL Charlotte | 650 S. Tryon Street, Suite 600 | Charlotte, NC 28209