



ICONIC
MODERN
CLASS A
OFFICE
SPACE FOR
LEASE

3333 NORTH
DIGITAL DRIVE



Jones Lang LaSalle Brokerage, Inc.



space details

available space

3,746 RSF
Suite 230

lease rate

\$30.00 FSG

building size

70,416 SF

parking ratio

4/1,000

year built

2016

available date

NOW

floor plans

**DRIVE
TOWER**
LEHI | UTAH

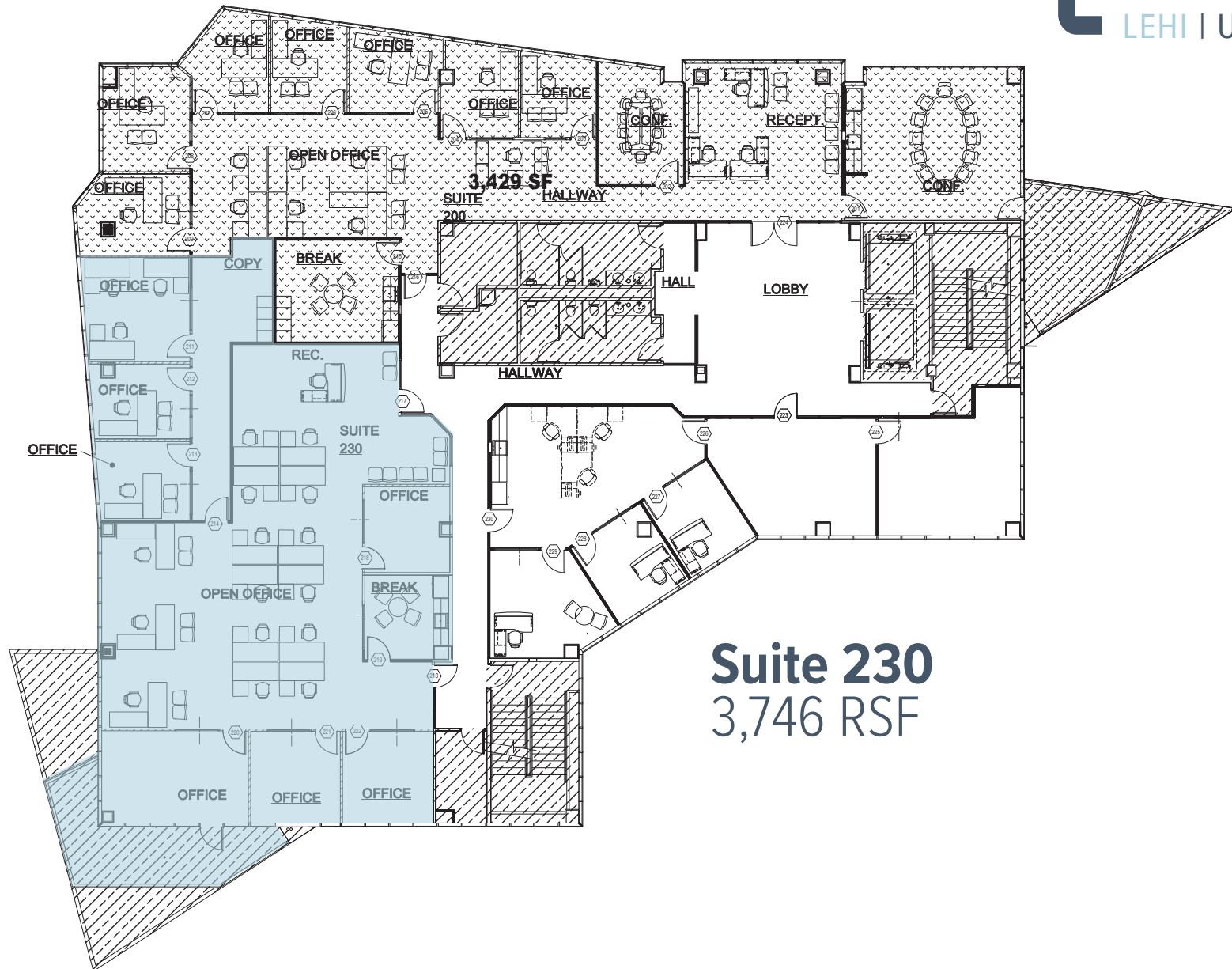

Suite 230
3,746 RSF

a destination for work and play



STATE OF THE ART

seven story modern
glass tower



AMAZING

mountain and
valley views



AMPLE

underground
parking



ON SITE

fitness
center



UNMATCHED

visibility and
access to I-15



DESIRABLE

eastside
location



WALKABLE

to an abundance of amenities,
restaurants and shops



MODERN

and highly prominent
North Lehi location





DRIVE
TOWER
LEHI | UTAH





David Nixon

+ 1 801 456 9518

david.nixon@jll.com

Jones Lang LaSalle Brokerage, Inc.

©2025 Jones Lang LaSalle LP, Inc. All rights reserved. All information contained herein is from sources deemed reliable; however, no representation or warranty is made to the accuracy thereof.