



Elevate your business
to iconic heights.

Truist Plaza | 303 Peachtree St, Atlanta, GA 30308

TRUIST
PLAZA



Timeless form meets modern function

Soaring 60 stories above Peachtree, this iconic city landmark carves a distinctive signature along the Atlanta skyline to provide a timeless and inspiring office setting. With a pedestrian skybridge linking tenants to Truist Plaza Garden Offices, the 1.9 million SF complex offers a remarkable Class A+ experience that features indoor/outdoor amenities, stunning views, exceptional accessibility and historic charm.



Features & Highlights

- Typical floor plan: 21,500 – 25,000 SF
- State-of-the-art conference center with 5 individual meeting rooms
- On-site restaurants & food court with options from fine dining to fast-casual
- Fitness center with dedicated locker rooms
- Corporate concierge services
- More than 1 million SF of covered parking
- Street-level visitor parking
- Grand outdoor, tree-lined plazas
- Electric vehicle (EV) parking
- Enhanced, 24/7 security service and badge access entry
- Free public WiFi in all common areas



On-site
retail &
services



Truist Branch Bank
and ATM



Sundries Shop



Shoeshine
Station



FedEx and UPS
Drop Box



Dentist



Auto Salon

An iconic Atlanta landmark



Designed and developed by internationally renowned architect, John Portman, Jr., this awe-inspiring Atlanta icon is elevating the tenant experience through timeless style and elegant details inside and out.







A legacy of Atlanta design



Portman Holdings has joined forces with Truist Bank to draw on decades of intimate knowledge into the Atlanta market to provide innovative, customized solutions for tenants all over the city. This includes the award-winning Truist Plaza, which houses Truist's Atlanta headquarters.

Amenities to keep you moving



Conference Center

Highlighted by stunning, unobstructed city views, Truist Plaza is designed with efficient floor plans, ample collaboration space, retail activation and a myriad of lifestyle offerings to offer an enhanced tenant experience that keeps employees productive on and off the clock.



Truist Plaza Fitness Center



Truist Plaza Food Court



Guest Services



Stunning City Views



Efficient Floor Plans

Leave the car keys behind

Located in the heart of Downtown Atlanta, Truist Plaza puts tenants squarely at the center of the city's most exciting experiences, delivering remarkable access to more than 80 destinations within less than 10 minutes.

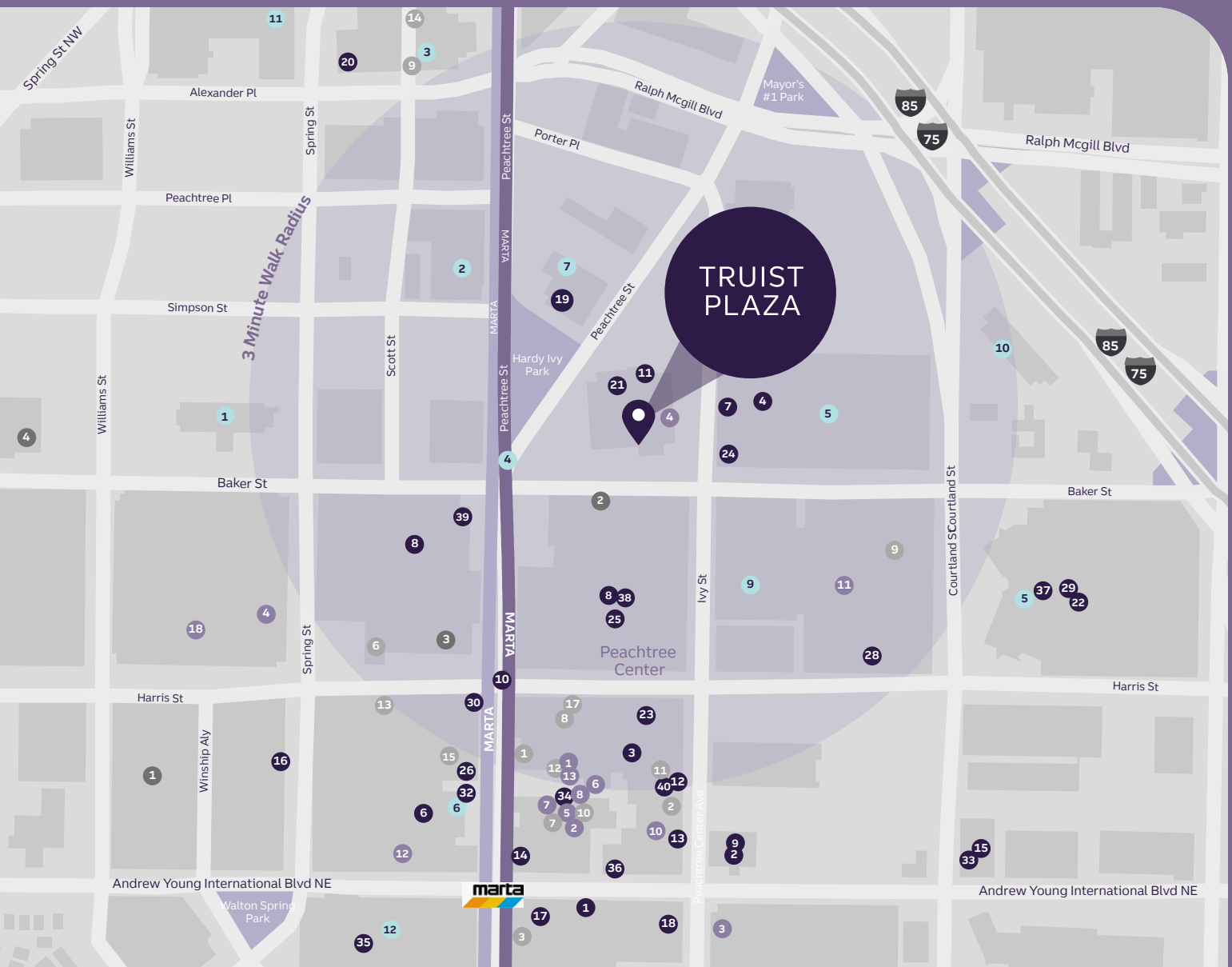

Restaurants

1. Amalfi Cucina & Mercato - Atlanta
2. Atalian KITCHEN & BAR
3. Aviva by Kameel - Atlanta
4. Big Kahuna
5. Cafe Cubism
6. Cafe Momo
7. Canyon Grill
8. Corner Bakery
9. Cuts Steakhouse
10. Farmers Basket
11. Garden Deli
12. Gibney's Pub
13. Gus's World Famous Fried Chicken
14. Hard Rock Cafe
15. Harlem Nights Ultra Lounge
16. Haveli Lounge And Kitchen
17. Hooters
18. Hsu's Atlanta
19. Max Lager's Wood-Fired Grill & Brewery
20. Mellow Mushroom
21. Morton's The Steakhouse
22. Nikolai's Roof
23. Noodle Cafe
24. Pacific Rim Bistro
25. Polaris
26. Ray's In the City - Atlanta
27. Saito - Sushi, Steak and Cocktails
28. Sear
29. Southern Elements
30. Streatery
31. Sway
32. The Drafting Table Cocktails & Kitchen
33. The Goodz
34. The Hub at Peachtree Center
35. The Sun Dial Restaurant, Bar & View
36. Tin Lizzy's Cantina
37. Trader Vic's
38. Twenty-Two Storys
39. White Oak Kitchen & Cocktails
40. Yami Yami Japanese Restaurant

Fast Food

- | | |
|----------------------|----------------------------|
| 1. Caribou Coffee | 8. Gus's Fried Chicken |
| 2. Chick-fil-A | 9. Jimmy John's |
| 3. Dairy Queen | 10. Salata |
| 4. Dunkin' | 11. Starbucks |
| 5. Firehouse Subs | 12. Wahlburgers |
| 6. Freshii | 13. Willy's Mexicana Grill |
| 7. Great Wraps Grill | |

Hotels

- | | |
|--------------------------------|------------------------------|
| 1. Aloft Hotels | 7. Hyatt Place |
| 2. Ascend Hotel Collection | 8. Hyatt Regency |
| 3. Autograph Collection Hotels | 9. Marriott Hotels & Resorts |
| 4. Element by Westin | 10. Motel 6 |
| 5. Hilton International | 11. W Hotels |
| 6. Hotel Indigo | 12. Westin Hotels & Resorts |

Arts & Entertainment

- | | |
|--------------------------|---------------------------------|
| 1. AmericasMart Atlanta | 3. Capital City Club |
| 2. BIM Conference Center | 4. Children's Museum of Atlanta |

Retail

- | | |
|-----------------------------|--------------------------------|
| 1. CVS Pharmacy | 11. All About Watches |
| 2. Gregory Jacobs Clothier | 12. Socks N Socks |
| 3. Jos. A. Bank | 13. Jaunty Company |
| 4. Archer Diamonds | 14. Yoe Furniture Depot |
| 5. Tower Lobby Shops | 15. Kahn's Jewelry |
| 6. Mistura Timepieces | 16. Peachtree Center Newsstand |
| 7. My Phone Fixery | 17. Puttin On the Glitz |
| 8. Flame of Life | 18. Swank |
| 9. Hello Atlanta | |
| 10. The Fans Wear - Atlanta | |

A commuter-friendly destination

The commuter-friendly location of Truist Plaza along Peachtree provides easy access to all modes of efficient Atlanta transit, including MARTA rail and bus, the Downtown Connector and Hartsfield-Jackson Atlanta International Airport. Truist Plaza is also walkable to convention hotels, city shops and restaurants through a network of climate-controlled sky bridges.

98

Walk Score





76

Transit Score

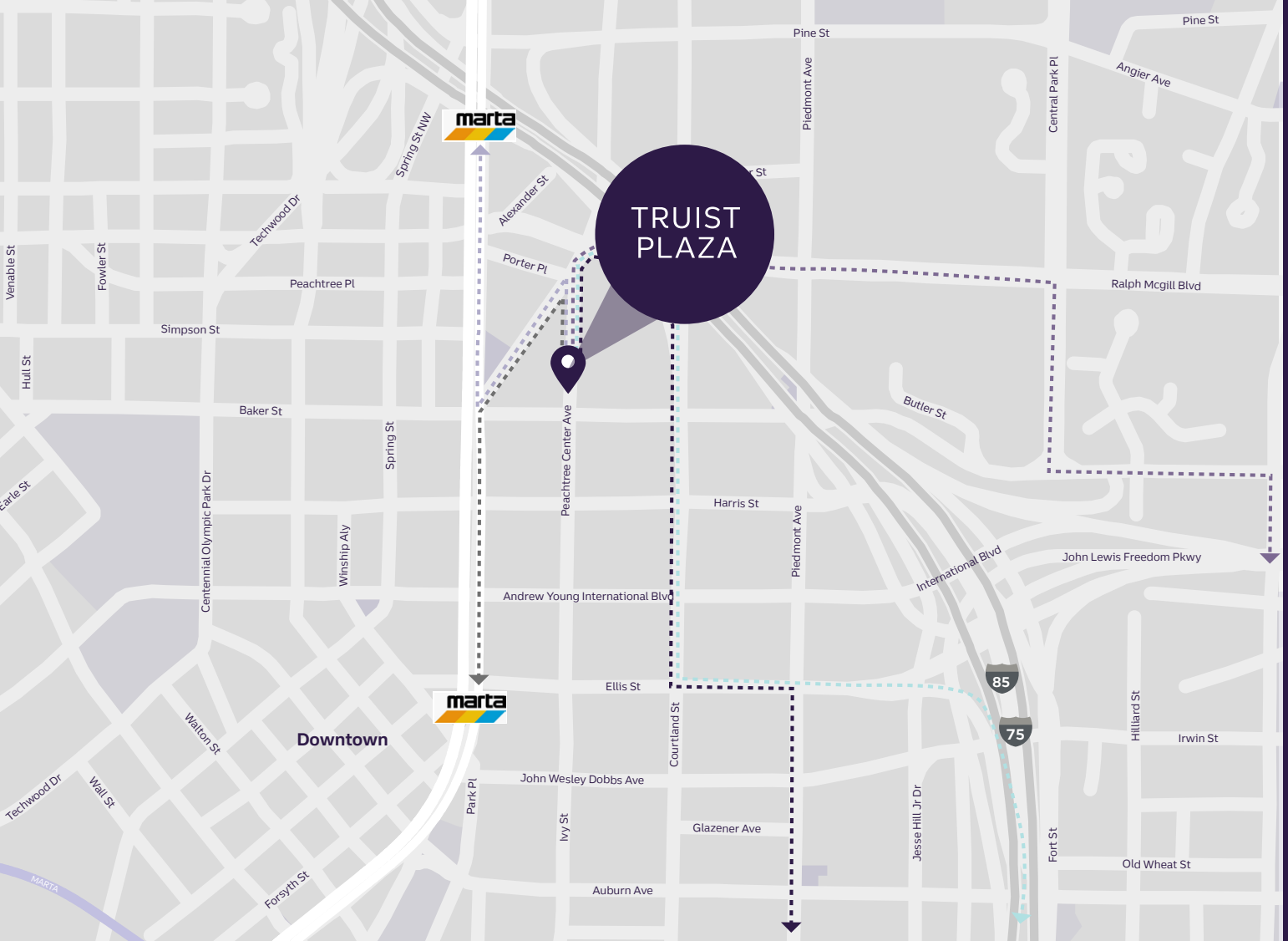
75

Bike Score



	Hartsfield-Jackson Atlanta International Airport	25 Min Drive
	Downtown Connector	5 Min Drive
	John Lewis Freedom Parkway	13 Min Drive
	Civic Center MARTA Station	7 Min Walk
	Peachtree Center MARTA Station	9 Min Walk

Popular area destinations

Ponce City Market: 5 min

Midtown: 5 min

State Farm Arena: 5 min

Georgia Tech: 8 min

Mercedes Benz Stadium: 9 min

Buckhead: 20 min

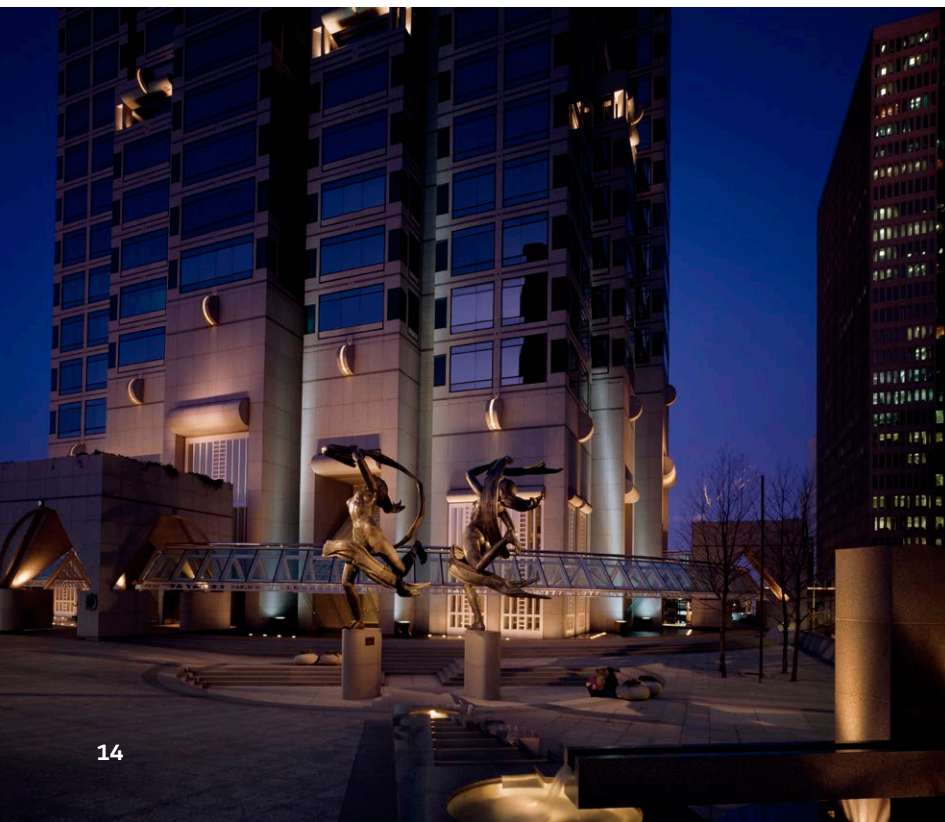

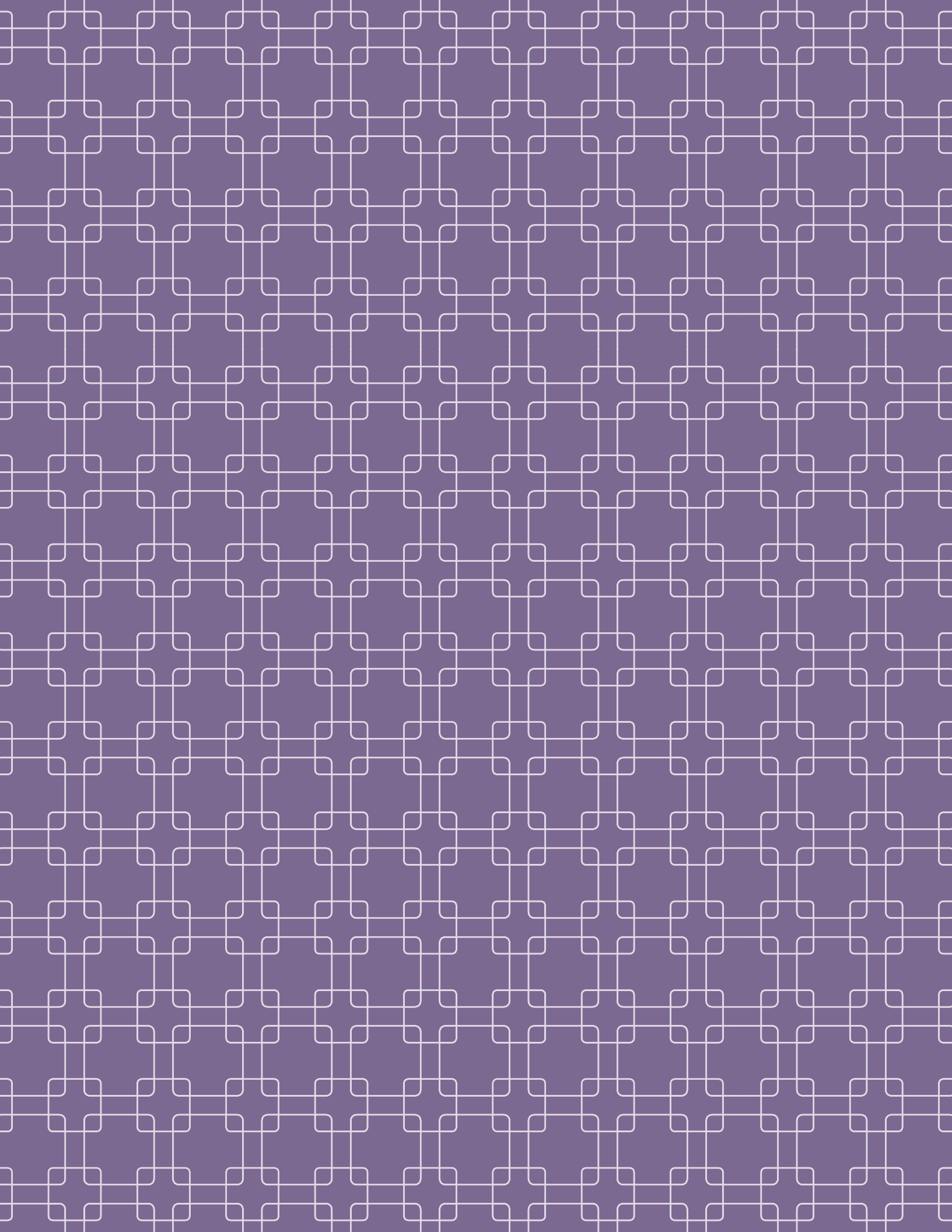

TRUIST
PLAZA



For more leasing information on Truist Plaza, please contact:

Jeff Taylor
JLL
770.329.0191
jeffm.taylor@jll.com

Caroline Fisher
JLL
404.995.6305
caroline.fisher@jll.com

David Horne
JLL
404.995.6321
david.horne@jll.com