

133,602 SF CROSS DOCK WAREHOUSE

with 11,653 SF office



Seagis Doral @ 25th
Cross-dock facility

FOR LEASE

10005 NW 21st Street | Doral, FL 33172



Highlights

- 133,602 total SF
- 121,949 warehouse SF
- 11,653 office SF
- Heavy power
800A, 3Phase, 277V/480V
- 40' x 40' column spacing
- 24 - 9'x10' dock-high doors
- 2 - 9' x 16' dock-high doors
- 2 - 12'x16' dock-high doors
with ramps
- ESFR sprinkler system
- 30' clear height
- 123 parking spaces
- Cross-dock distribution
- Available July 1, 2026

PROPERTY DETAILS

Overall site plan

10005 NW 21st Street, | Doral, FL 33172

Suite 100 | 133,602 SF Total

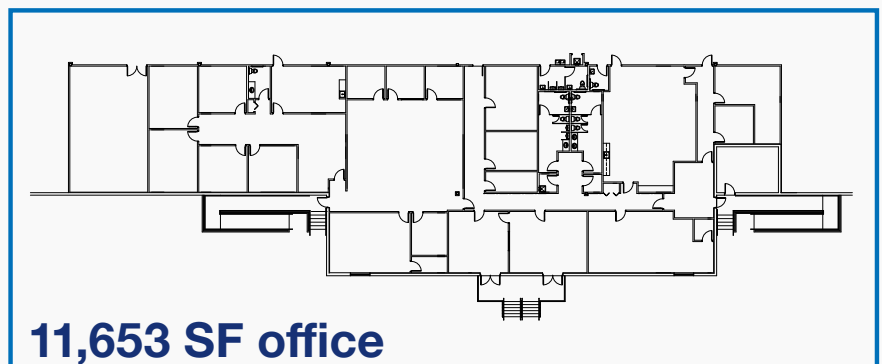
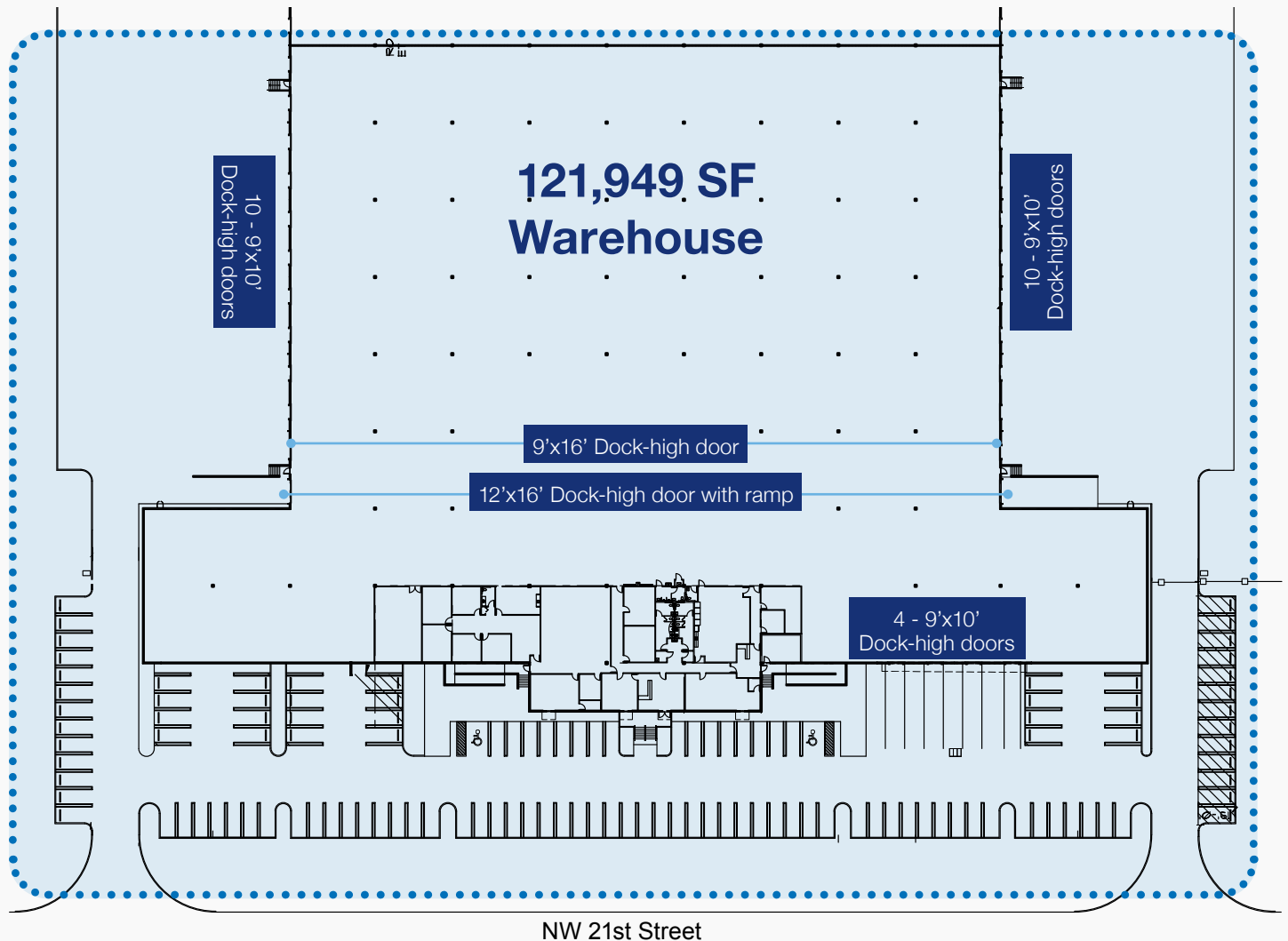

PROPERTY DETAILS

Image gallery

10005 NW 21st Street, | Doral, FL 33172

Suite 100 | 133,602 SF Total



PROPERTY DETAILS

Location overview

10005 NW 21st Street, | Doral, FL 33172

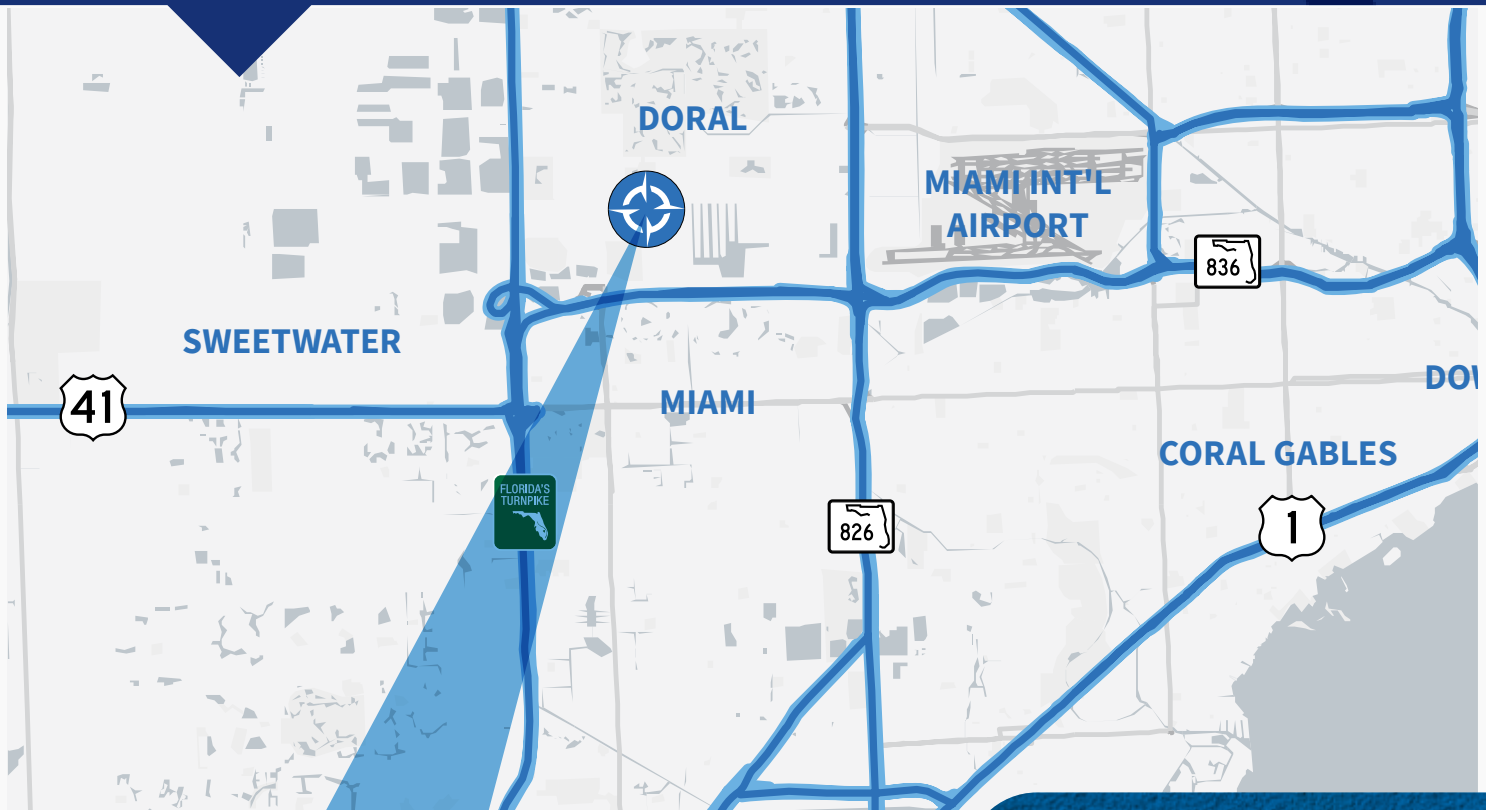

Location details

- Direct access to NW 25th Street
- NW 25th Street viaduct provides immediate access to major throughfares
- Proximity to Miami International Airport enhances connectivity and distribution efficiency

FOR LEASING INQUIRIES, PLEASE CONTACT:

Ana Rivera
305 778 7652
ana.rivera@jll.com

Brian Smith
305 960 8403
smith.brian@jll.com

Audley Bosch
305 960 8404
audley.bosch@jll.com

