



6101 Johns Road, Tampa, FL 33634

## Class A Tilt-Wall Construction Available for Lease



STONEMONT



Jones Lang LaSalle Brokerage, Inc., a licensed real estate broker



# PROJECT OVERVIEW

TIA Executive Center is a 100,698 square foot Class A industrial building that is situated in close proximity to the Tampa International Airport, offering excellent accessibility and convenience for businesses looking to establish a presence in Tampa, Florida. With its modern tilt-wall construction, the property provides a high-quality and efficient space for a range of industrial operations.



**BUILDING SIZE**  
100,698 SF



**SPEC OFFICE**  
2,600 SF



**SPRINKLER**  
ESFR



**CLEAR HEIGHT**  
32'



**POWER**  
1,600A,  
480V, 3-phase

## SITE PLAN



# BUILDING SPECS

ADDRESS	6101 JOHNS ROAD, TAMPA, FL 33634
CONSTRUCTION	TILT-WALL
BUILDING SIZE	100,698 SF
AVAILABLE SIZE	100,698 SF
SPEC OFFICE SF	2,600 SF
BUILDING DIMENSIONS	516' X 195'
COLUMN SPACING	50'W X 45'D, 60' SPEED BAY
LOADING	REAR-LOAD
DOCK-HIGH DOORS	16 (9' X 10') & 17 KNOCKOUTS
DRIVE-IN DOORS	2 (12' X 14')
POWER	1,600A, 480V, 3-PHASE
CLEAR HEIGHT	32'
TRUCK COURT DEPTH	130'
CAR PARKING	101
DELIVERY DATE	Q3 2025
SLAB	6", 4000 PSI
ROOF	60MIL TPO, R-19

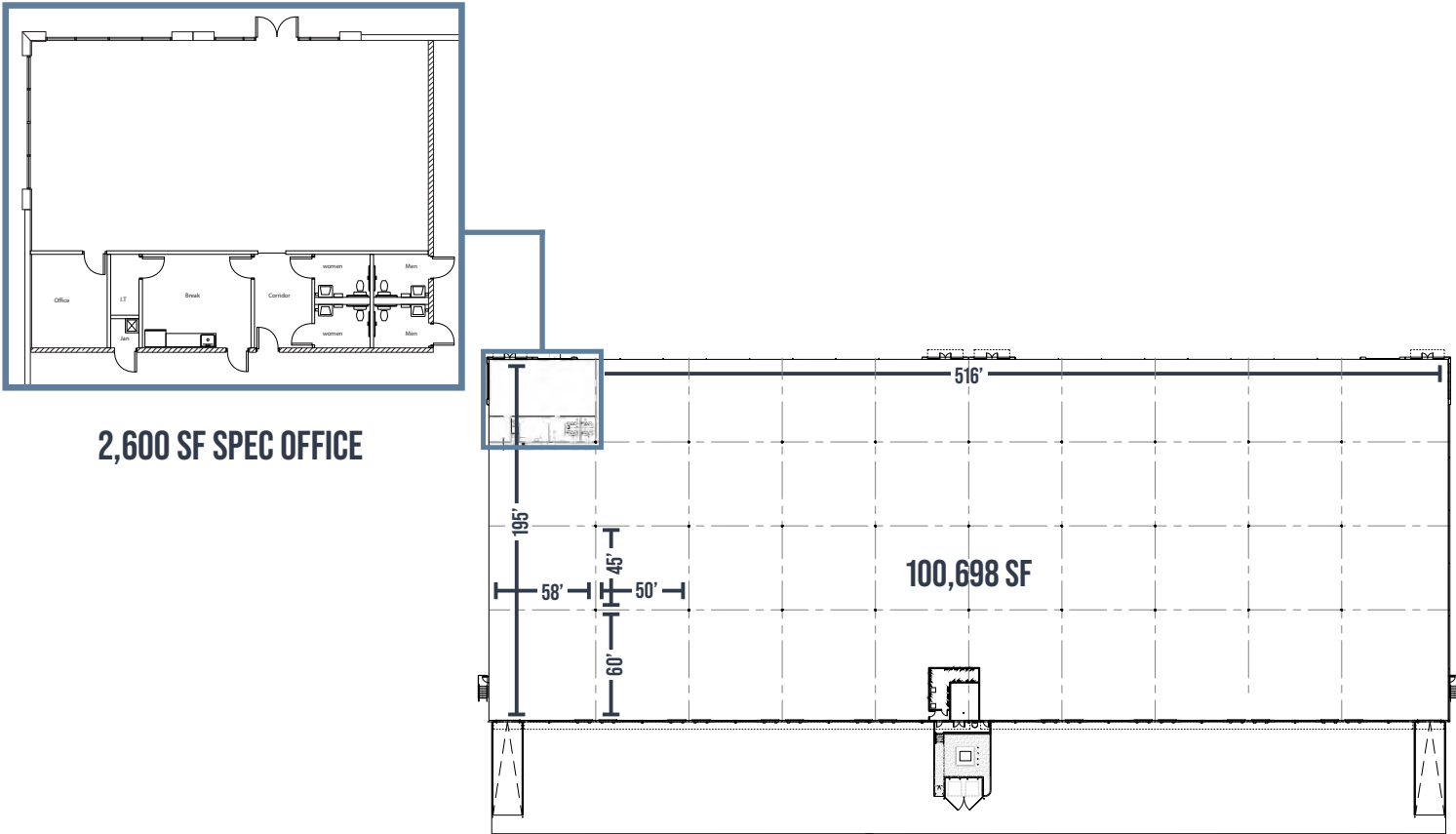



# CONSTRUCTION PROGRESS





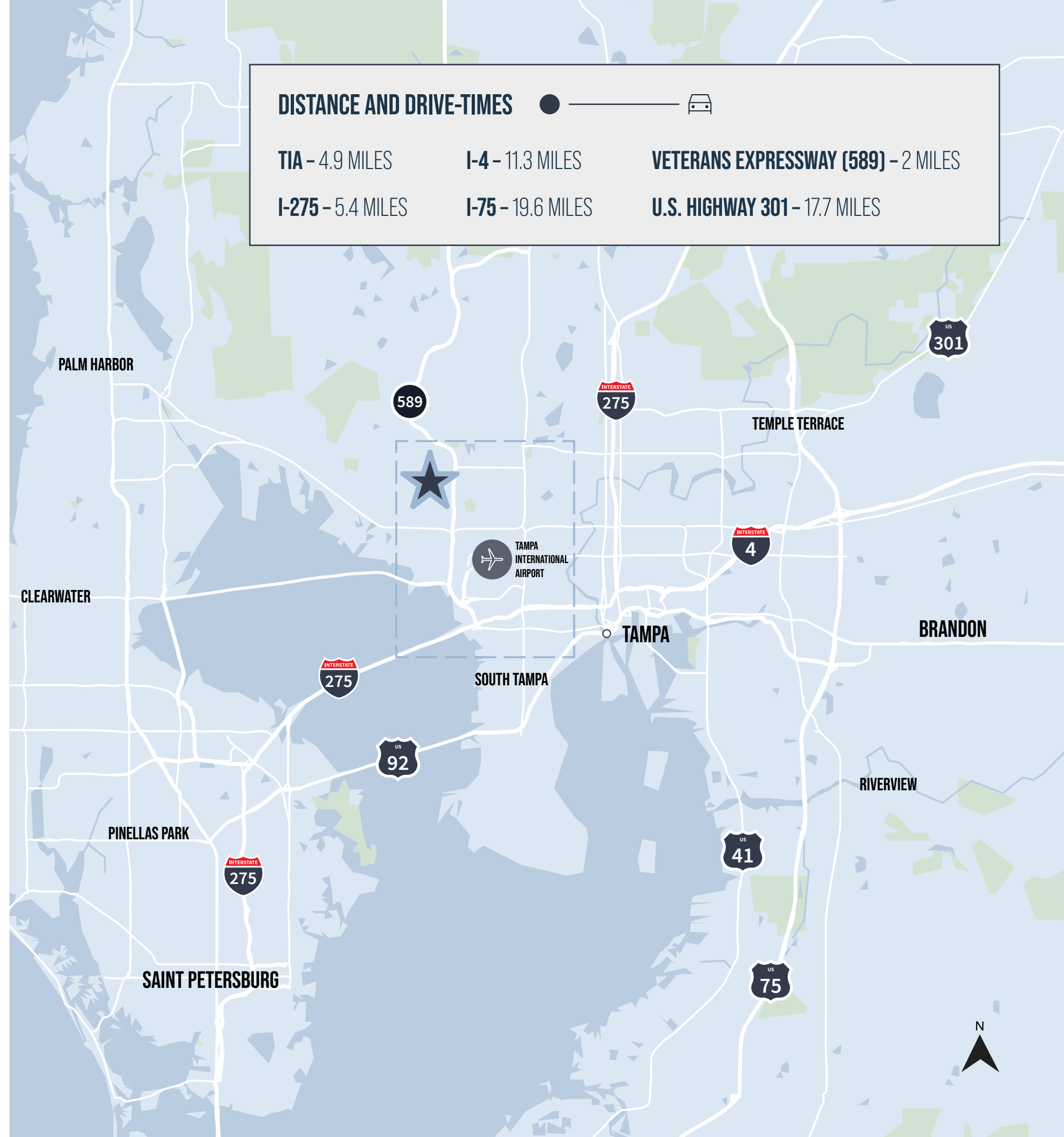
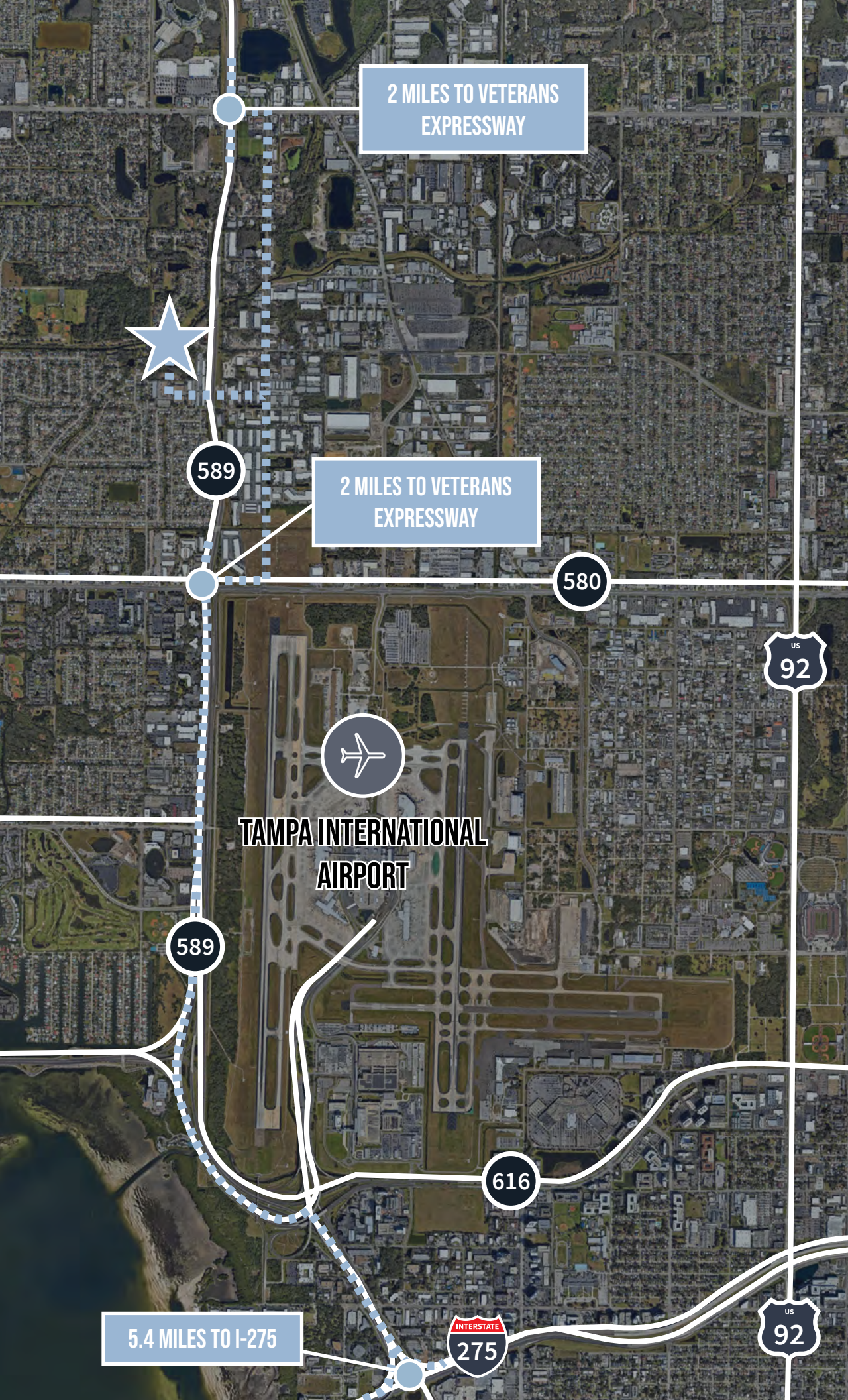





# TIA EXECUTIVE CENTER



## STONEMONT

Although information has been obtained from sources deemed reliable, JLL does not make any guarantees, warranties or representations, express or implied, as to the completeness or accuracy as to the information contained herein. Any projections, opinions, assumptions or estimates used are for example only. There may be differences between projected and actual results, and those differences may be material. JLL does not accept any liability for any loss or damage suffered by any party resulting from reliance on this information. If the recipient of this information has signed a confidentiality agreement with JLL regarding this matter, this information is subject to the terms of that agreement.  
©2024. Jones Lang LaSalle Brokerage, Inc. All rights reserved.



### **Peter Cecora, SIOR**

Executive Managing Director  
+1 813 387 1297  
[peter.cecora@jll.com](mailto:peter.cecora@jll.com)

### **John C. Dunphy, SIOR, CCIM**

Executive Managing Director  
+1 813 387 1312  
[johnc.dunphy@jll.com](mailto:johnc.dunphy@jll.com)

### **Harrison Pithers**

Associate  
+1 813 610 0239  
[harrison.pithers@jll.com](mailto:harrison.pithers@jll.com)