



CLYBOURN

CENTER



2029-2077 N Clybourn Ave
Boutique retail space available for lease in Lincoln Park





WELCOME TO LINCOLN PARK'S

Clybourn Corridor

Lincoln Park, a designated community located on the north side, is one of the most affluent neighborhoods in Chicago. A picturesque neighborhood with sweeping city views and botanical gardens, it has everything from beautiful community parks, amazing eateries, and acclaimed shopping. It is most known for its diverse community filled with breathtaking architecture.

Nestled on the western side of Lincoln Park, Clybourn Center presents a prime opportunity for retailers to join a prestigious lineup of well known, national brands along this highly trafficked retail corridor.

1 MILE RADIUS



57,689
POPULATION



58,422
DAYTIME POPULATION



\$222,055
AVG HOUSEHOLD INCOME



26,588
HOUSEHOLD



LINCOLN PARK'S Retail Landscape





Clybourn Center

AVAILABILITIES

RESIDENCE

ALLEY

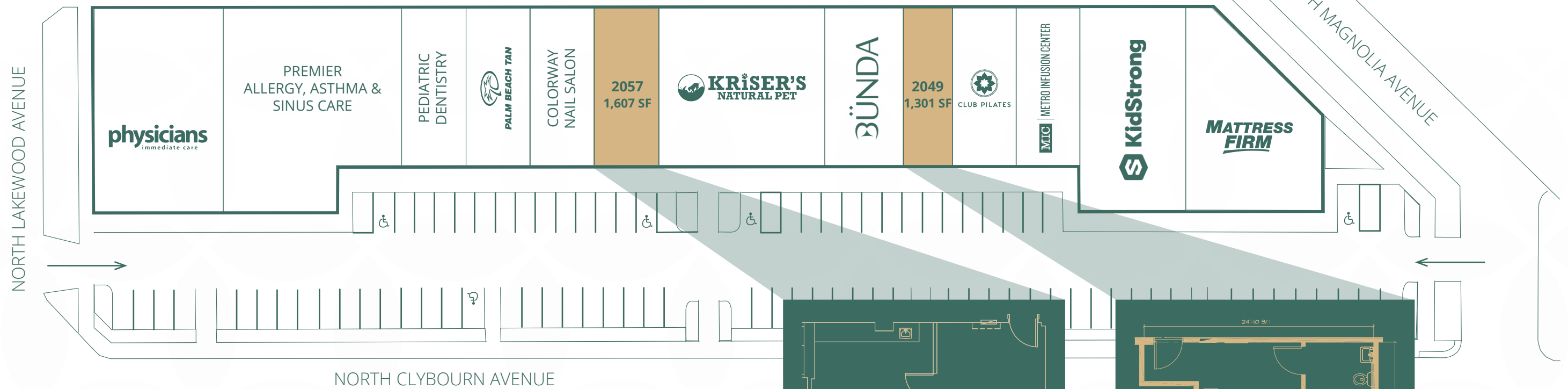

Up to 1,607 SF inline space available for lease



94 Parking Spots with two access points



5 Minute Drive time to/from I-90/94



Sits across the street from a 121 unit residential building



Less than one mile from the North/Clybourn Red Line Station, Armitage Brown & Purple Express Line Station, and Fullerton Red/Brown/Purple Line Station

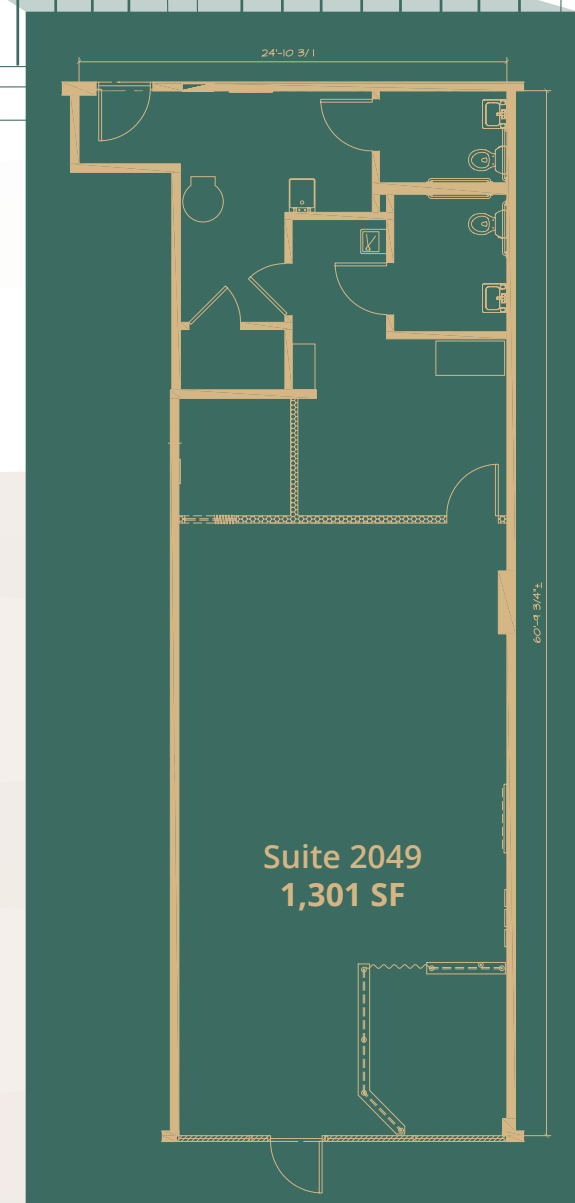
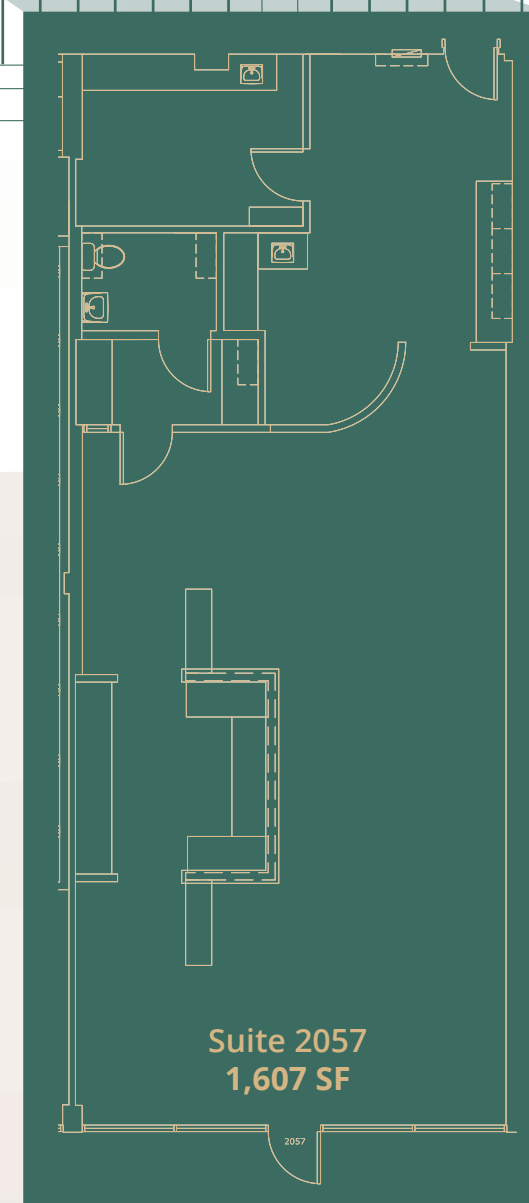



CLYBOURN

CENTER

2029-2077 N Clybourn Ave

Steve Schwartz

+1 312 228 2157

steve.schwartz@jll.com

Courtney Rouleau

+1 312 228 3431

courtney.rouleau@jll.com



Although information has been obtained from sources deemed reliable, neither Owner nor JLL makes any guarantees, warranties or representations, express or implied, as to the completeness or accuracy as to the information contained herein. Any projections, opinions, assumptions or estimates used are for example only. There may be differences between projected and actual results, and those differences may be material. The Property may be withdrawn without notice. Neither Owner nor JLL accepts any liability for any loss or damage suffered by any party resulting from reliance on this information. If the recipient of this information has signed a confidentiality agreement regarding this matter, this information is subject to the terms of that agreement. ©2025 Jones Lang LaSalle IP, Inc. All rights reserved.