

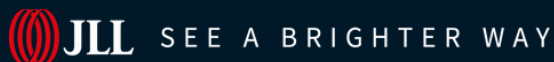

For Sublease

1308 Ninth St, Suite 100

5,500 SF Advanced Manufacturing Available



Eddie Shuai

License #01454419

M +1 415 336 3573

eddie.shuai@jll.com

Kristi Childers

License #01997043

M +1 510 812 2878

kristi.childers@jll.com

Jones Lang LaSalle Brokerage, Inc. License #: 01856260

1308 9th St, Suite 100 Berkeley, CA

Property specifications

- 5,500 SF available
- Single story warehouse/mfg space
- 16-18' clear height
- 1 drive-in door
- Epoxy sealed concrete slab
- Distributed power throughout
- Power: 500a 120/208v
- Distributed CDA piping in place
- Two (2) dedicated parking stalls
- Floor drain in warehouse
- Sublease LED: 2/28/2028

Advantages and amenities

- Close to Retail and Banking
- Restaurants nearby include Lulu Berkeley, Fieldwork Brewing, Picante and Philz Coffee
- Close to I-80, I-580 and major airports

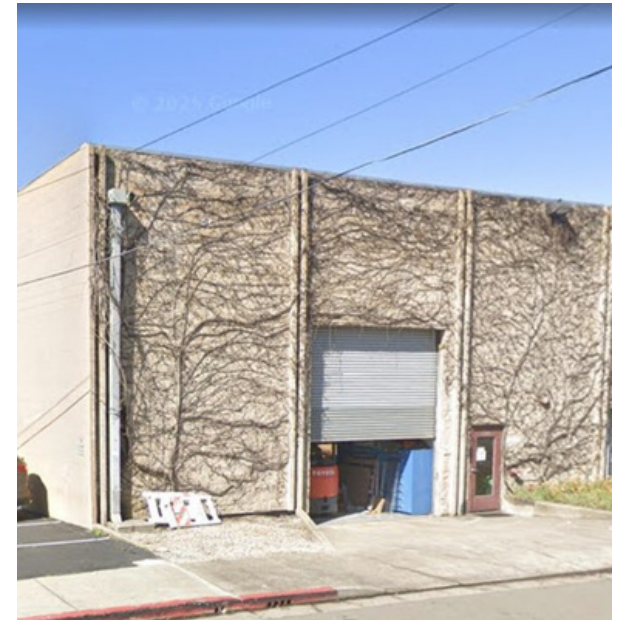
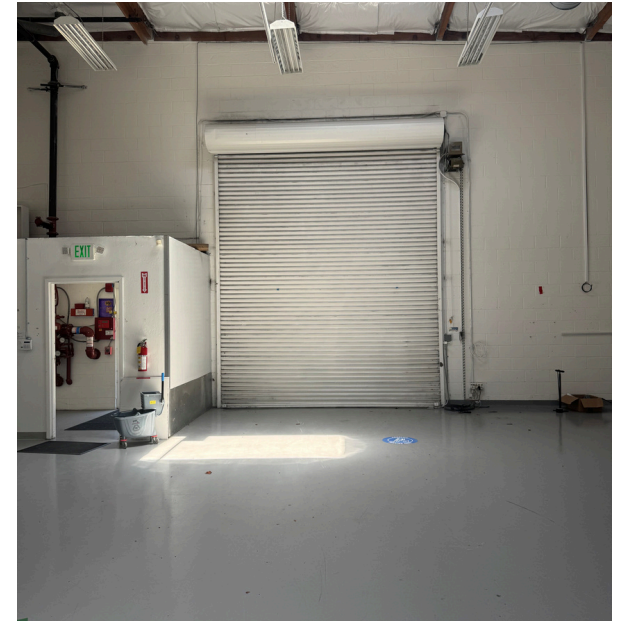

Available Floorplan

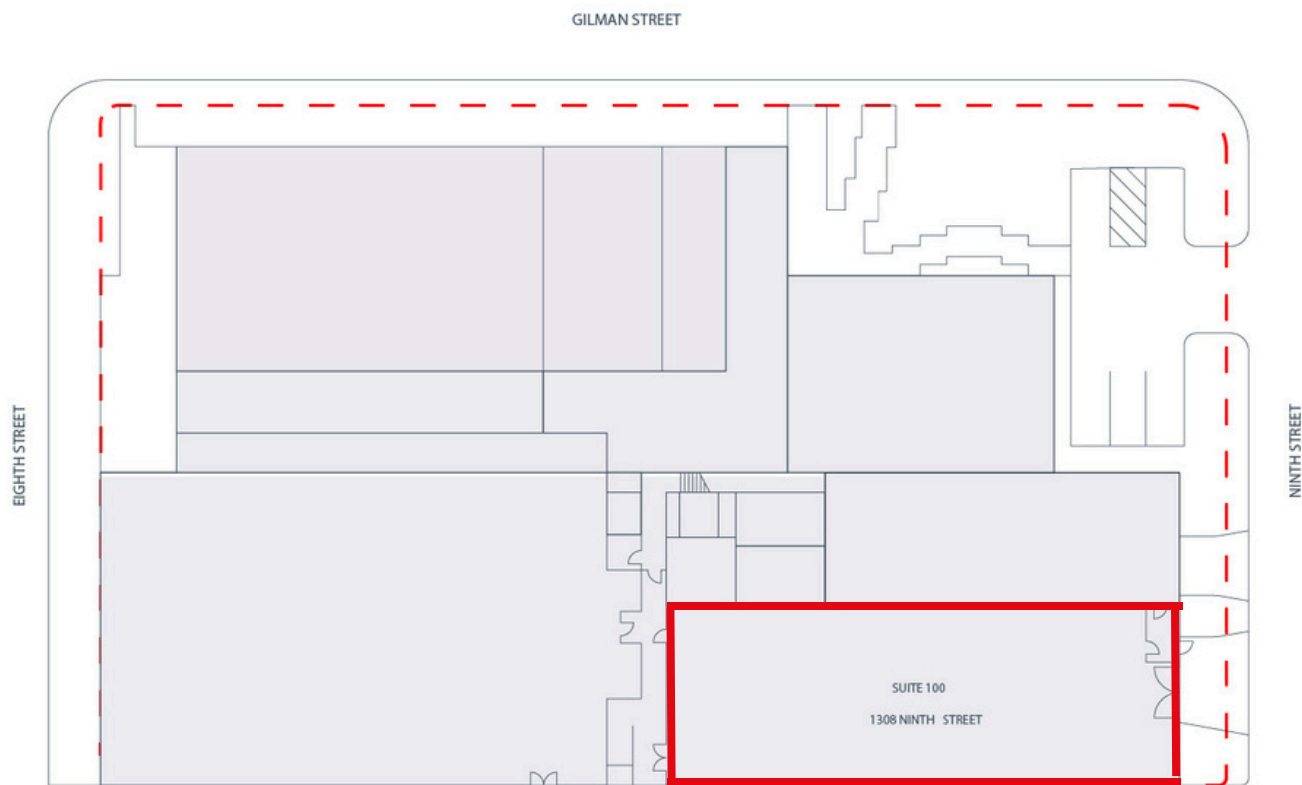

For Sublease - Advanced Manufacturing

1308 Ninth St, Suite 100, Berkeley

±5,500 SF Available



Eddie Shuai

Sr Managing Director

Eddie.Shuai@jll.com

415 336 3573

Kristi Childers

Managing Director

Kristi.Childers@jll.com

510 812 2878

Jones Lang LaSalle Brokerage, Inc. License #: 01856260

Although information has been obtained from sources deemed reliable, JLL does not make any guarantees, warranties or representations, express or implied, as to the completeness or accuracy as to the information contained herein. Any projections, opinions, assumptions or estimates used are for example only. There may be differences between projected and actual results, and those differences may be material. JLL does not accept any liability for any loss or damage suffered by any party resulting from reliance on this information. If the recipient of this information has signed a confidentiality agreement with JLL regarding this matter, this information is subject to the terms of that agreement. ©2025. Jones Lang LaSalle Brokerage, Inc. Real Estate License #01856260 All rights reserved.