



PREMIER MIDTOWN RETAIL FOR LEASE

2100 YONGE STREET



# PROPERTY DETAILS

Premises	3,273 SF
Net Rent	Please Contact Listing Agents
Available	Q4 2025
Lease Term	5-10 Years
Additional Rent	\$25.00 PSF (est. 2025)
Zoning	CR 3.0

## HIGHLIGHTS

- Ground floor retail space at the base of a luxury, 76-unit condominium project, The Davisville
- Highly visible retail space with corner exposure at Yonge Street and Manor Road West
- Retail premises showcases a stunning heritage facade featuring approx. 72 FT of frontage on Yonge Street
- Significant current and future residential development in immediate area
- Demising option available



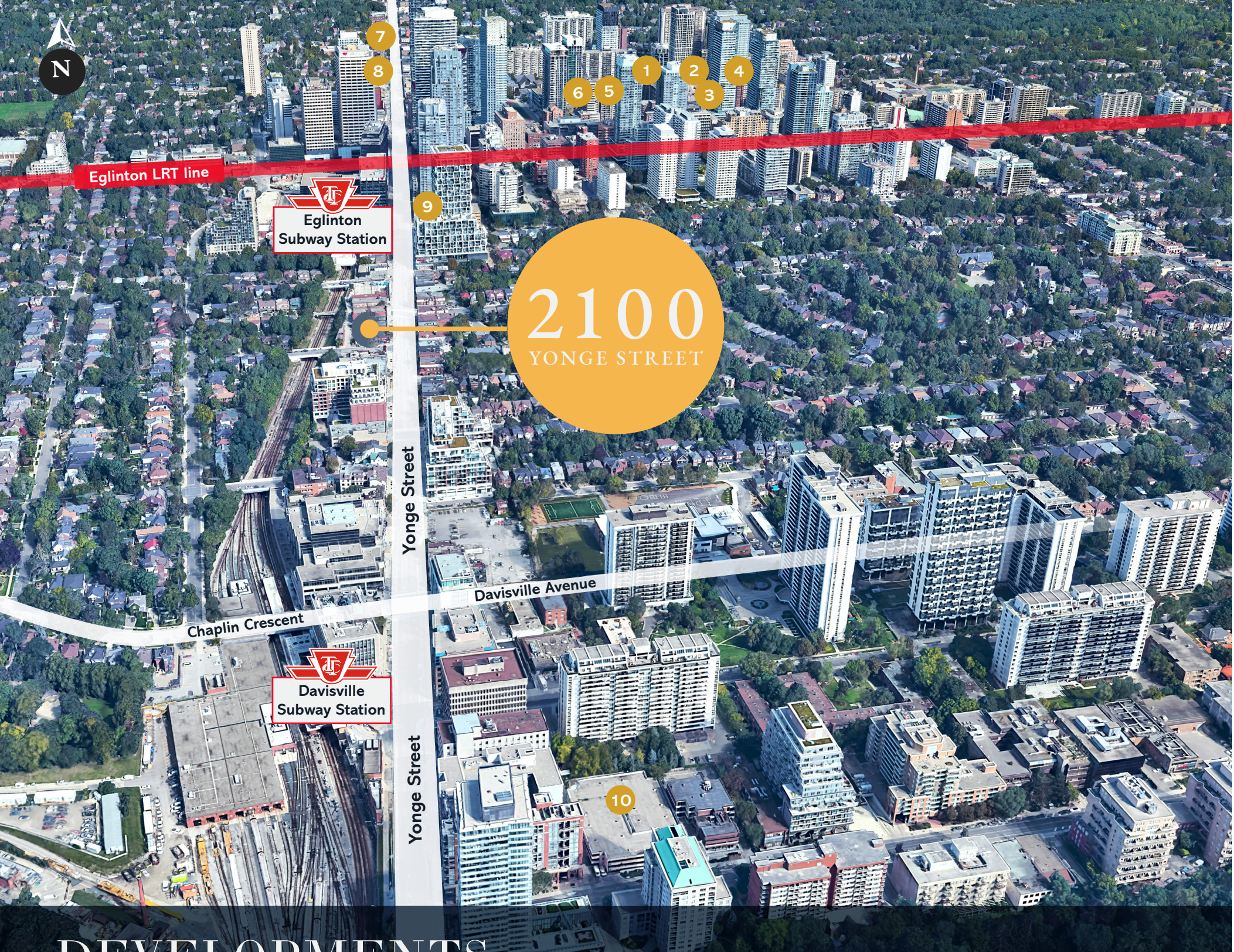

## DEVELOPMENTS

	ADDRESS	# OF STOREYS	# OF UNITS
1	109 Erskine Avenue	22	211
2	100 Broadway Avenue	39	448
3	110 Broadway Avenue	37, 26	352
4	117 Broadway Avenue	39, 28	1,010
5	75 Broadway Avenue	38	336

	ADDRESS	# OF STOREYS	# OF UNITS
6	65 Broadway Avenue	39, 39	389
7	2500 Yonge St	15	163
8	2444 Yonge St	31, 25	636
9	2161 Yonge St	38	380
10	30 Merton St	37	322

## AREA OVERVIEW

Yonge and Eglinton have long been one of Toronto's top destinations for families and young professionals alike. Today, it still remains a bustling hub of activity that includes restaurants, bars, shopping, cafes and some of the best new mixed-use developments Toronto has seen in recent years.

Renowned for its exceptional transit connectivity, this area stands out as one of Toronto's most accessible communities, attracting residents and visitors. 2100 Yonge Street is located just steps away from Eglinton Station and Davisville Station, providing convenient access to the Yonge Line as well as the Eglinton LRT.

This prime location, combined with the area's ongoing transformation and vibrant atmosphere, makes it an ideal spot for retail businesses looking to be part of Toronto's most dynamic neighbourhood.

## DEMOGRAPHICS - 1 KM

	Population	54,649
	Daytime Population	50,102
	Growth Rate (Previous 5 Years)	16.5%
	Growth Rate (Next 5 Years)	9.0%
	Total Households	30,201
	Average Household Income	\$123,591
	Median Age	37.2
	Walk Score	100
	Transit Score	92

# NEIGHBOURHOOD RETAILERS



FLOOR PLAN

3,273 SF  
TOTAL RETAIL

MANOR ROAD WEST

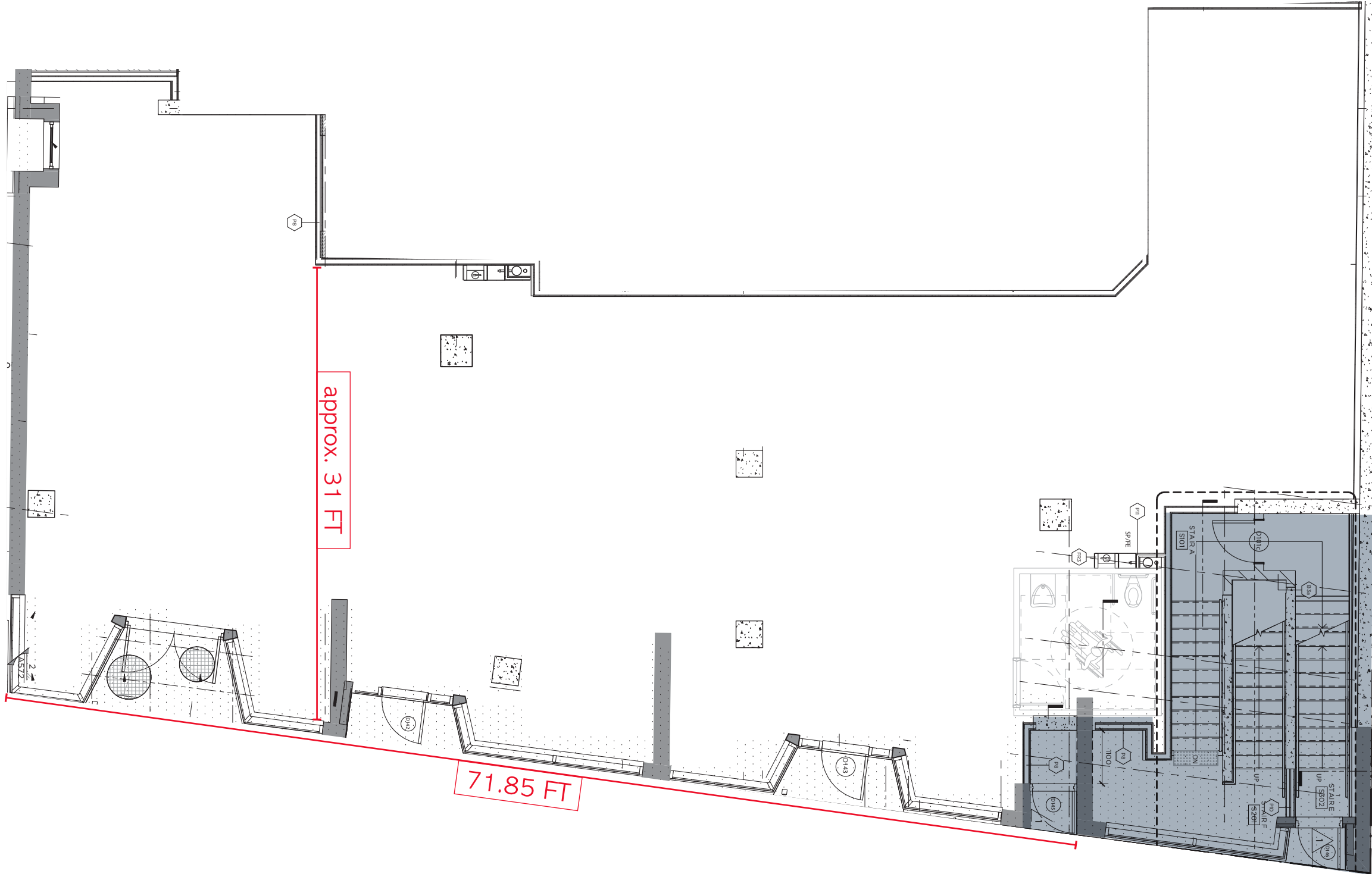

YONGE STREET





**ROCKPORT®**

PREMIER MIDTOWN RETAIL LEASE OPPORTUNITIES

# 2100 YONGE STREET

**GRAHAM SMITH\***

Executive Vice President  
+1 416 855 0914  
graham.smith@jll.com

**BRANDON GORMAN\*\***

Executive Vice President  
+1 416 855 0907  
brandon.gorman@jll.com

**AUSTIN JONES\*\***

Associate Vice President  
+1 416 304 6050  
austin.jones@jil.com

**MATTHEW MARSHALL\***

Associate Vice President  
+1 416 238 9925  
matthew.marshall@jll.com

**BRETT VAREY\***

Associate  
+1 416 304 6064  
brett.varey@jll.com

Although information has been obtained from sources deemed reliable, neither Owner nor JLL makes any guarantees, warranties or representations, express or implied, as to the completeness or accuracy as to the information contained herein. Any projections, opinions, assumptions or estimates used are for example only. There may be differences between projected and actual results, and those differences may be material. The Property may be withdrawn without notice. Neither Owner nor JLL accepts any liability for any loss or damage suffered by any party resulting from reliance on this information. If the recipient of this information has signed a confidentiality agreement regarding this matter, this information is subject to the terms of that agreement. ©2025 Jones Lang LaSalle IP, Inc. All rights reserved. \*Sales Representative. \*\*Broker.

