

# For lease

## Sunrise Business Center

2660-2668 Mercantile Drive  
Rancho Cordova, CA 95742



## Lease Rate: \$1.00 PSF MG

- Total Available SF: ±3,200 SF
- Clear Height: ±16' - 18'
- Grade Level Doors: ±10' x 12' (1)
- Monument & building signage available
- Located 1 mile from HWY 50 at Sunrise Blvd. exit
- Strategically located among several construction and home improvement services companies



Professionally owned and managed by:



# Floor plan

## Available: 2660 Mercantile Drive

- Total Available SF:  $\pm 3,200$
- Office SF:  $\pm 300$
- One restroom
- Clear Height:  $\pm 16' - 18'$
- Grade Level Doors:  $10' \times 12'$  (1)
- Sprinklered

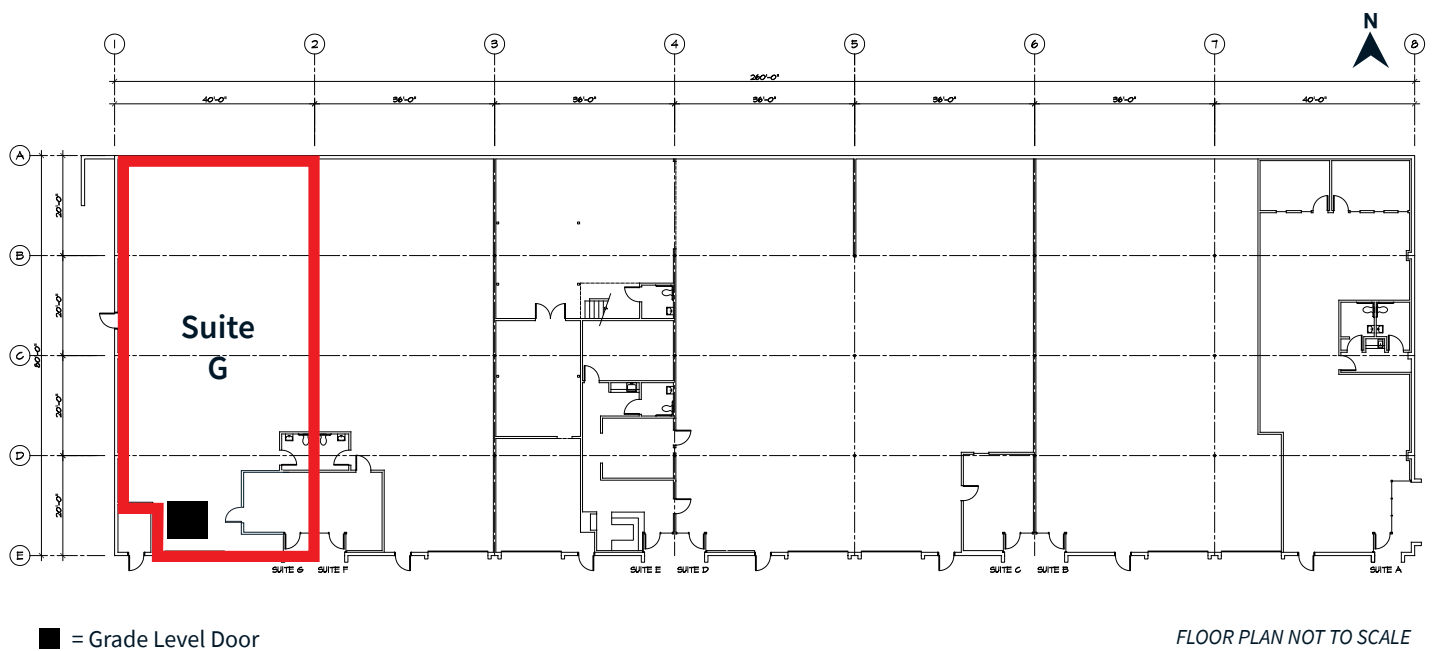

## Site plan

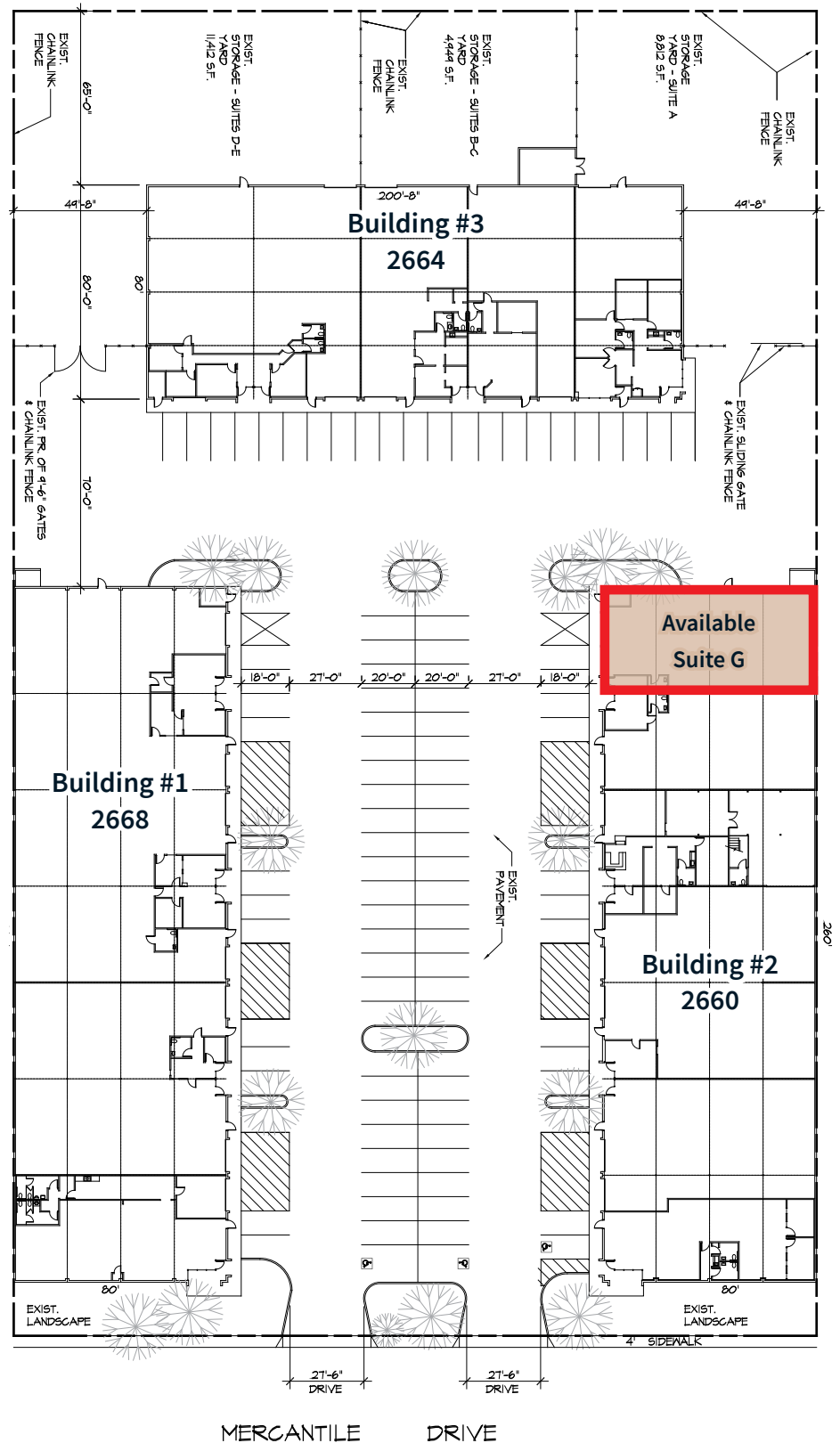

*SITE PLAN NOT TO SCALE.  
ALL MEASUREMENTS ARE APPROXIMATE.*

## Location maps

### Street map

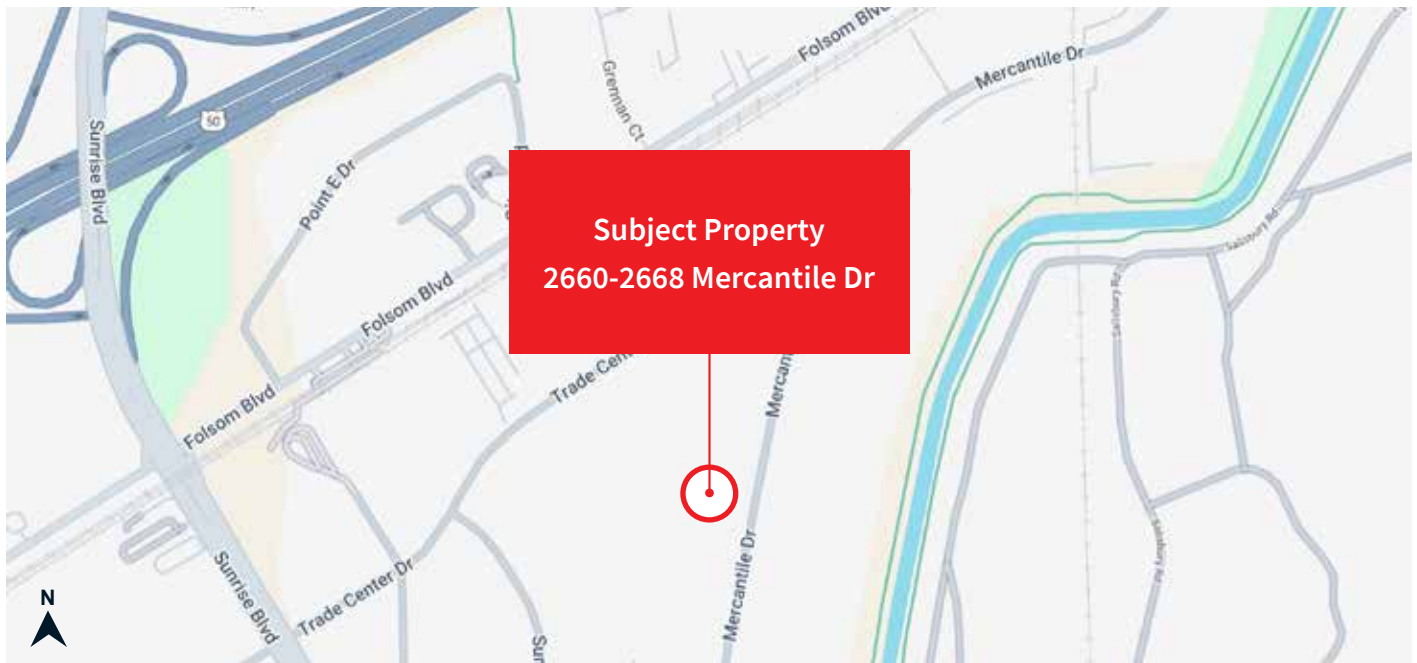

### Regional map

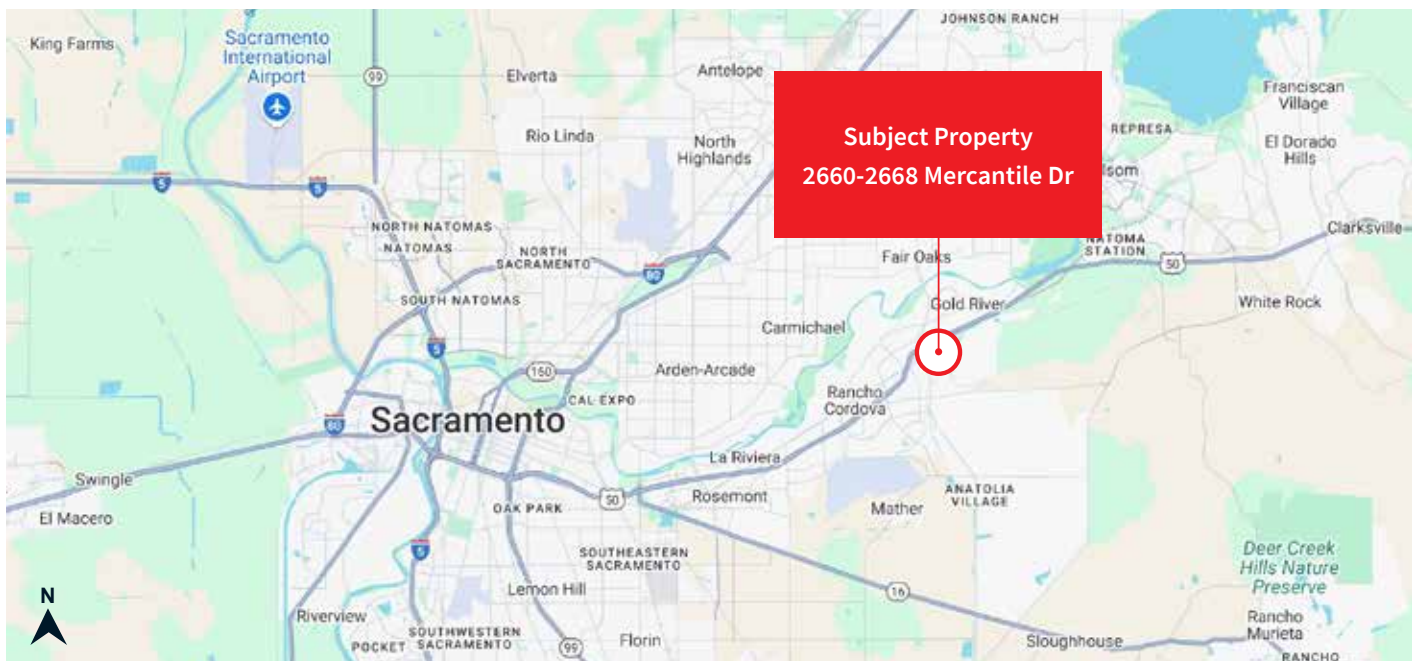

MAPS NOT TO SCALE



# For lease

## Sunrise Business Center

2660-2668 Mercantile Drive  
Rancho Cordova, CA 95742

### JLL Sacramento Industrial Team

**Dominic Smith**

*Senior Associate*

[Dominic.Smith@jll.com](mailto:Dominic.Smith@jll.com)

+1 916 995 9396

RE Lic. 02106714

**RJ Jimenez**

*Associate*

[RJ.Jimenez@jll.com](mailto:RJ.Jimenez@jll.com)

+1 940 597 9341

RE Lic. 02248675

**Mike Luca, SIOR**

*Senior Managing Director*

[Mike.Luca@jll.com](mailto:Mike.Luca@jll.com)

+1 916 214 0466

RE Lic. 01447904

*Jones Lang LaSalle  
Brokerage, Inc.*

*CA Real Estate License #01856260*