

8779 Greenwood Place
Savage, MD



OXFORD

+/- 96,473 SF available



Property Overview

Space Highlights

Available Area

96,473 SF

Availability

Immediate

Clear Height

23'

Building specifications

Total Area

96,473 SF

Loading Doors

15

Office Space

7,000 SF

Grade Doors

1 at grade drive in door

Zoning

M2

Lighting

LED on motion sensors

Sprinklers

Wet

Power

650 amps of electric

The Property

This 142,000" sf warehouse is situated in Savage MD in the heart of the Baltimore Washington Corridor. It has a side parking lot with the ability to be secured and offers at grade drive in loading as well as multiple dock high positions along front.

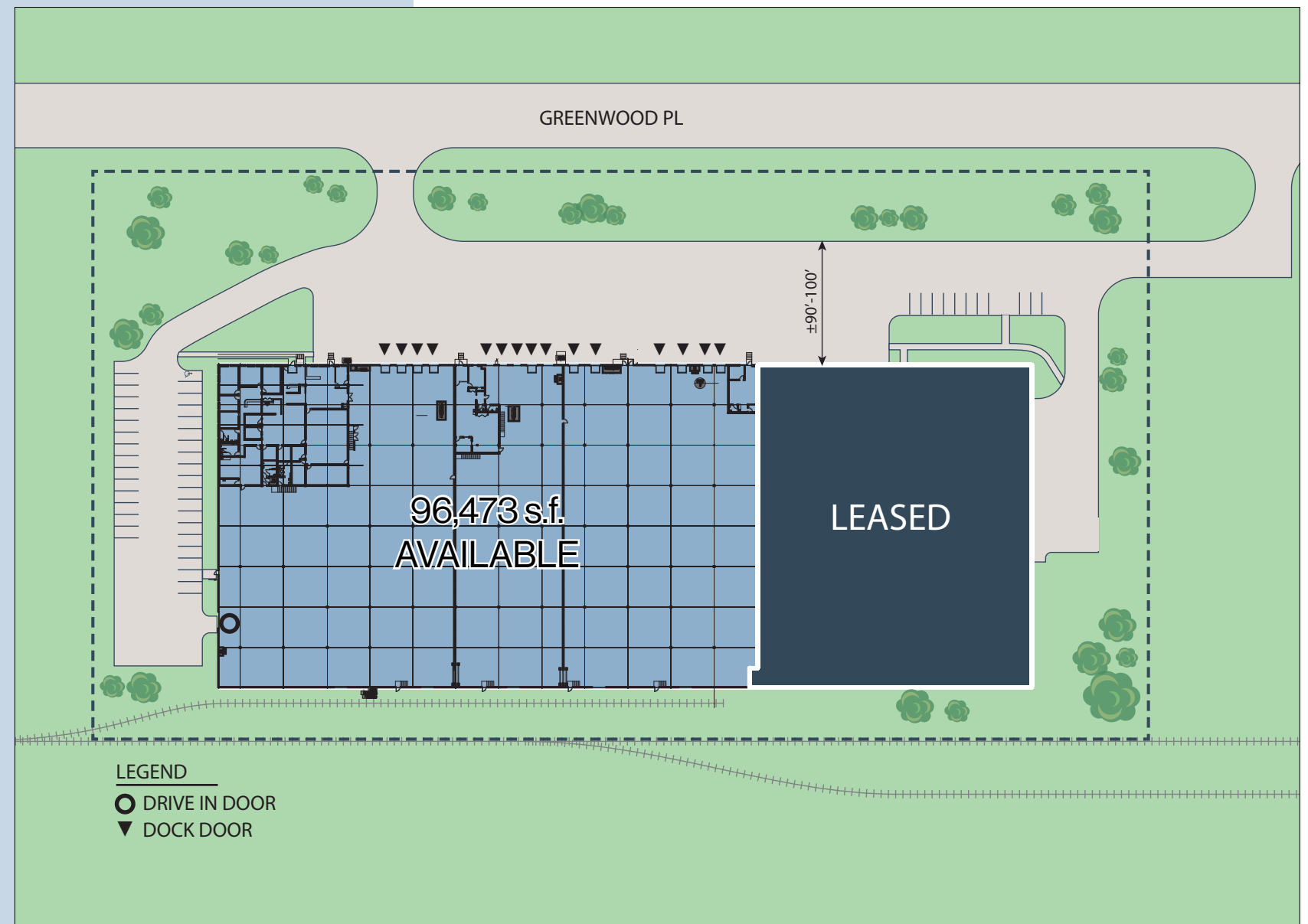

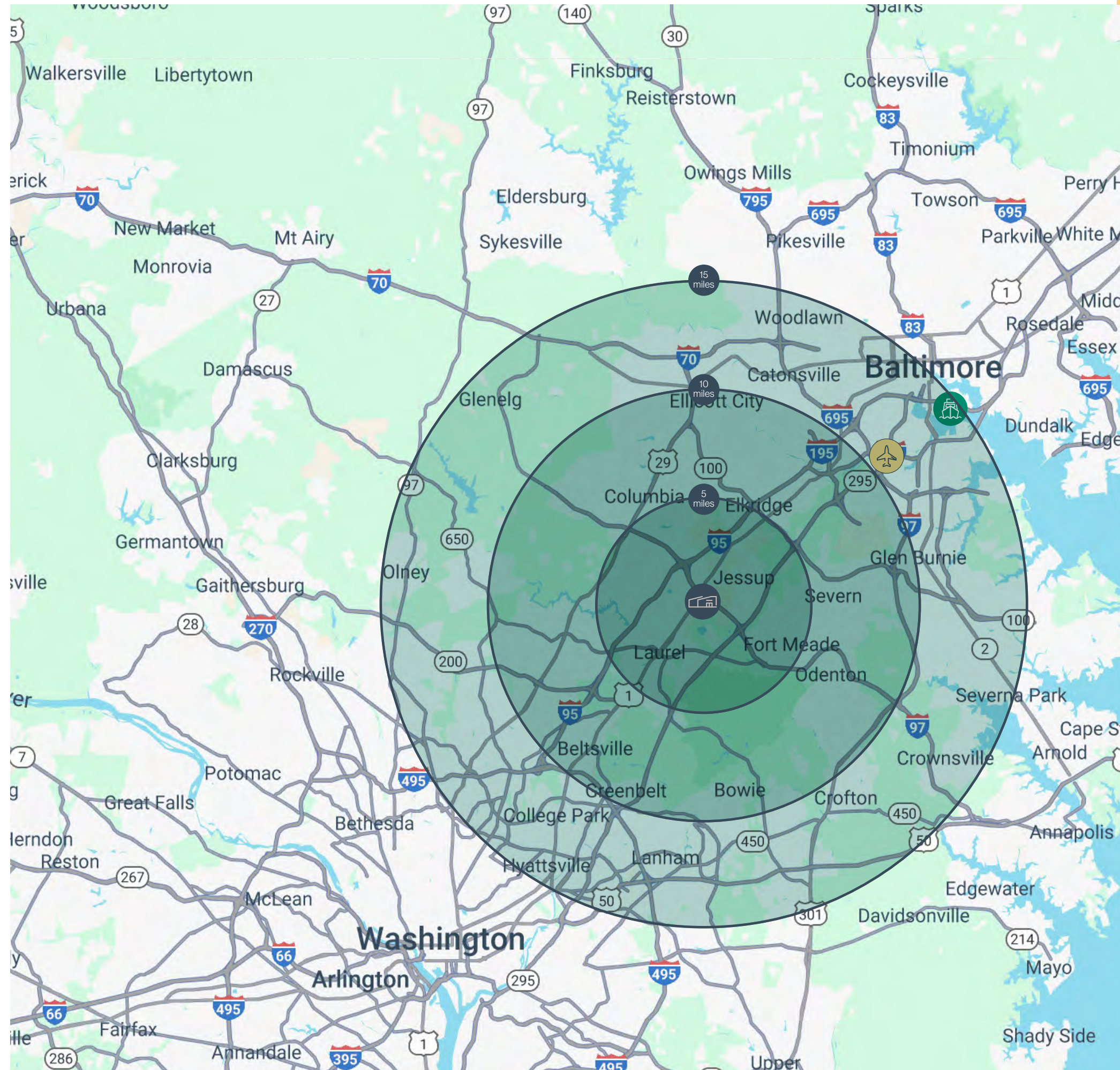

Public Transportation

Airports

Baltimore Washington International Airport
13.2 mi (17 min)

Freight Ports

Port of Baltimore

Truck Routes

 Interstate 495

 Interstate 95

 Route 1

 Interstate 97



A growling, evolving Industrial portfolio

We are investing, building and buying the physical infrastructure to deliver solutions to serve the global supply chain.

Our global industrial and logistics portfolio includes high-quality warehouse, manufacturing, and distribution facilities with a robust global development pipeline. We are committed to elevating expectations of the sector, delivering sustainable, high-functioning, and flexible spaces. We continually strive to do better - finding ways to meaningfully adapt and future-proof our assets. Our state-of-the-art properties are located in major consumption and critical supply chain nodes across North America, Europe and Asia Pacific.

98.4 M
SF Global Portfolio

\$24.5B
AUM

14.1M
SF under development

About Oxford Properties

We are a leading global real estate investor, developer, and manager. Our global portfolio included office, life sciences, industrial, retail, multifamily, hotels & alternatives and credit assets on four continents.

Our competitive advantage lies in our end-to-end- capabilities, powered by combining global knowledge with local trends and experience. Generating meaningful returns for our stakeholders. Strengthening economies and communities through real estate.

Connect with us

For more information on this property, contact:

Ben Meisels

Executive Managing Director
443 451 2614
ben.meisels@jll.com

Greg Ferraro

Executive Managing Director
443 451 2618
greg.ferraro@jll.com

