



For Sale/Lease

123 Ave Multi

14705/41 123 Avenue Edmonton, AB

±32,000 SF building
±6,400 SF bays available

- ± 6,400 SF dock and ramp-to-grade loading bays available
- Two access points into marshalling area
- Suitable for a wide range of uses

For more information contact:

Kent Simpson

Vice President

780 203 0425

Kent.Simpson@jll.com



Property Details

Municipal Address	14705/41 123 Avenue, Edmonton AB
Legal Description	Plan 5951KS; Block 4A; Lot 6
Zoning	BE (Business Employment)
Building Size	±32,000 SF
Available Area	±6,400 SF
Occupancy	Immediately
Lease Rate (PSF)	\$8.00 PSF
op. Costs (PSF)	\$5.95 PSF (2025 est.)
Sale Price	\$4,200,000
Power	TBC by Tenant
Ceiling Height	14' clear
Heating	Ceiling mounted forced air unit heaters & radiant tube
Loading	Dock and Ramp to Grade
Property Tax	TBD

Unit 14729 - 33

±6,400 SF

2 Dock doors



Unit 14729 - 33

±6,400 SF

2 Dock doors

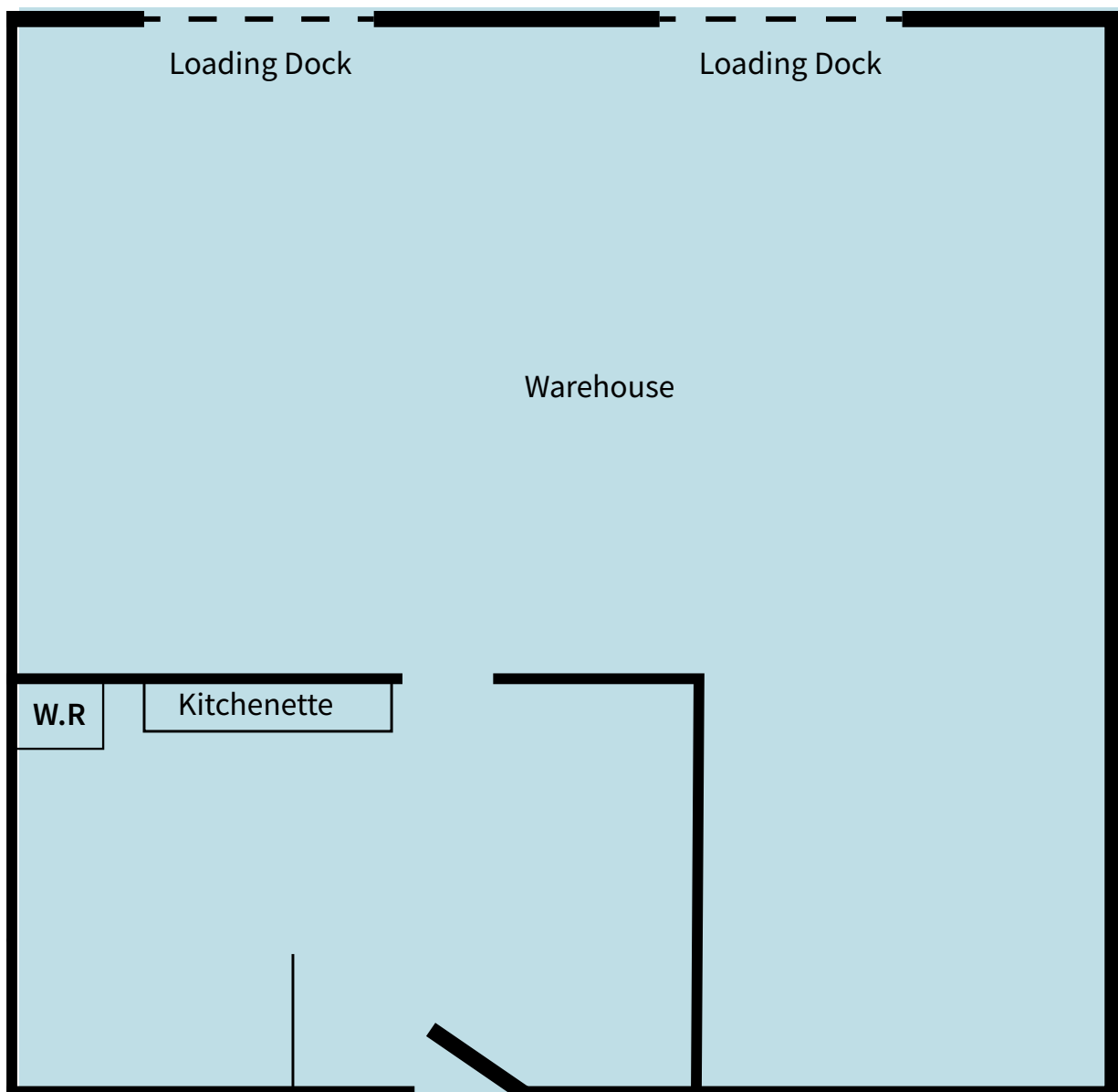

**Note: for representation purposes not drawn to scale*



Two access points into marshalling area with ample parking out front, great visibility along 123 Avenue with quick access to 149 Street, Yellowhead Highway, and Anthony Henday

Darryl McGavigan

Executive Vice President
780 328 0064
Darryl.McGavigan@jll.com

Adam Butler

Executive Vice President
780 328 0065
Adam.Butler@jll.com

Bronwyn Scrivens

Vice President, SIOR
780 807 4564
Bronwyn.Scrivens@jll.com

Kent Simpson

Vice President
780 203 0425
Kent.Simpson@jll.com

Mackenzie York

Associate Vice President
780 920 8463
Mackenzie.York@jll.com

Kailee Campbell

Senior Transaction Analyst
780 328 0069
Kailee.Campbell@jll.com

JLL Edmonton Industrial | Suite 2101, 10088 102 Avenue NW Edmonton, Alberta T5J 2Z1

DISCLAIMER: ©2024 Jones Lang LaSalle IP, Inc. All rights reserved. All information contained herein is from sources deemed reliable; however, no representation or warranty is made to the accuracy thereof. The Property may be withdrawn without notice. Neither Owner nor JLL accepts any liability for any loss or damage suffered by any party resulting from reliance on this information. Jones Lang LaSalle Real Estate Services, Inc.

