



1750

blow-dry-bar





An urban icon at the heart of Union Station, transforming our skyline and what it means to live downtown. A tower comprised of 334 residences, rising 200 feet with views to the Rockies and the plains. A collection of tasteful and thoughtful residences, all in a neighborhood that is transforming a city. With purposeful amenities and community space that embodies city life—a place to entertain, to play and to connect.

A community for Coloradans by Coloradans.





At The Coloradan, our neighborhood is the entire city, so we invited it into the building, filling our 22,000-square-foot ground floor with restauranteurs, bartenders, and baristas who represent the best of what Denver has to offer. Our retail welcomes residents and neighbors with an open environment, created to bring people together in dynamic and engaging ways.

Welcome to Union Station, a neighborhood built deliberately for a new urban way of life.



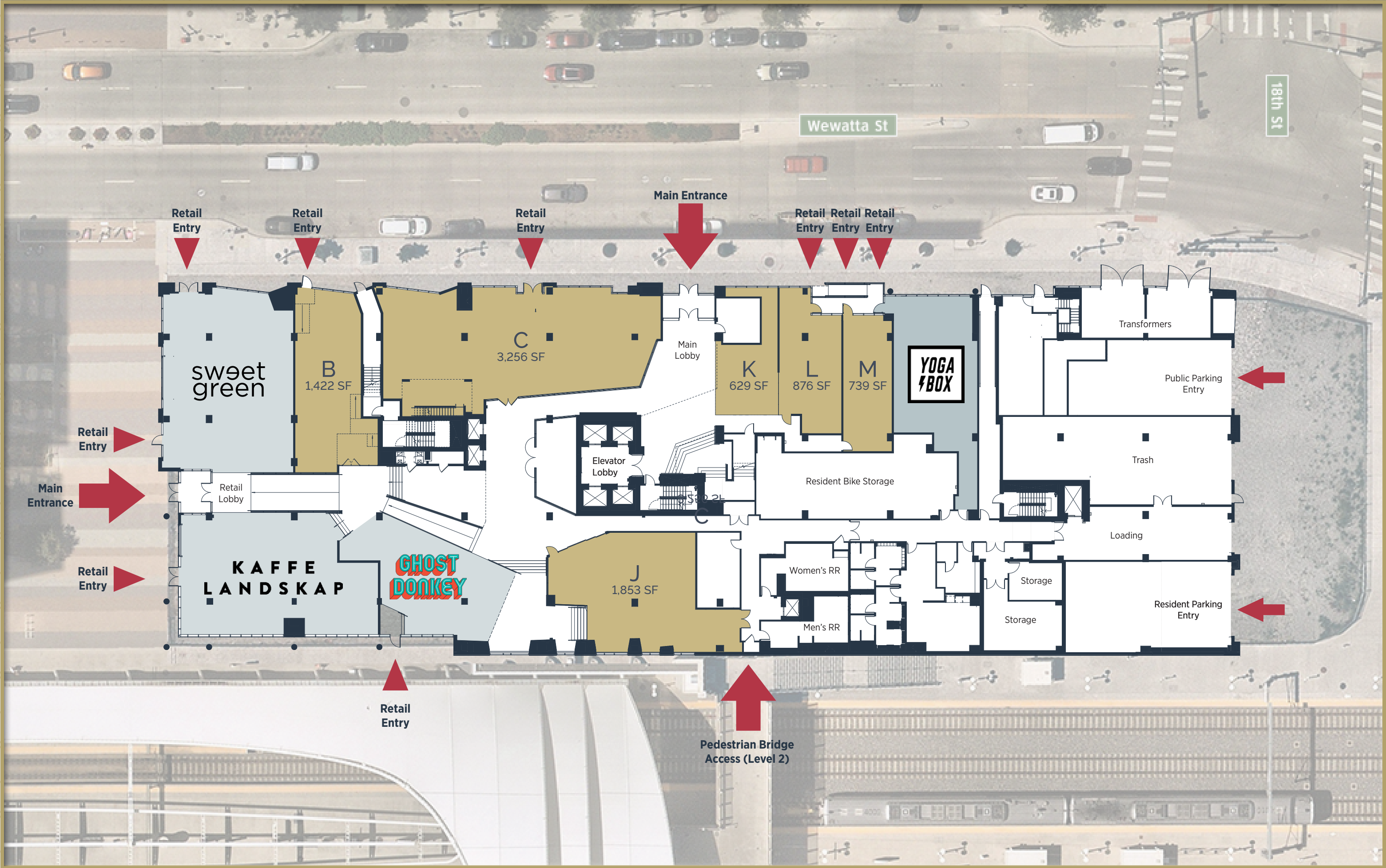

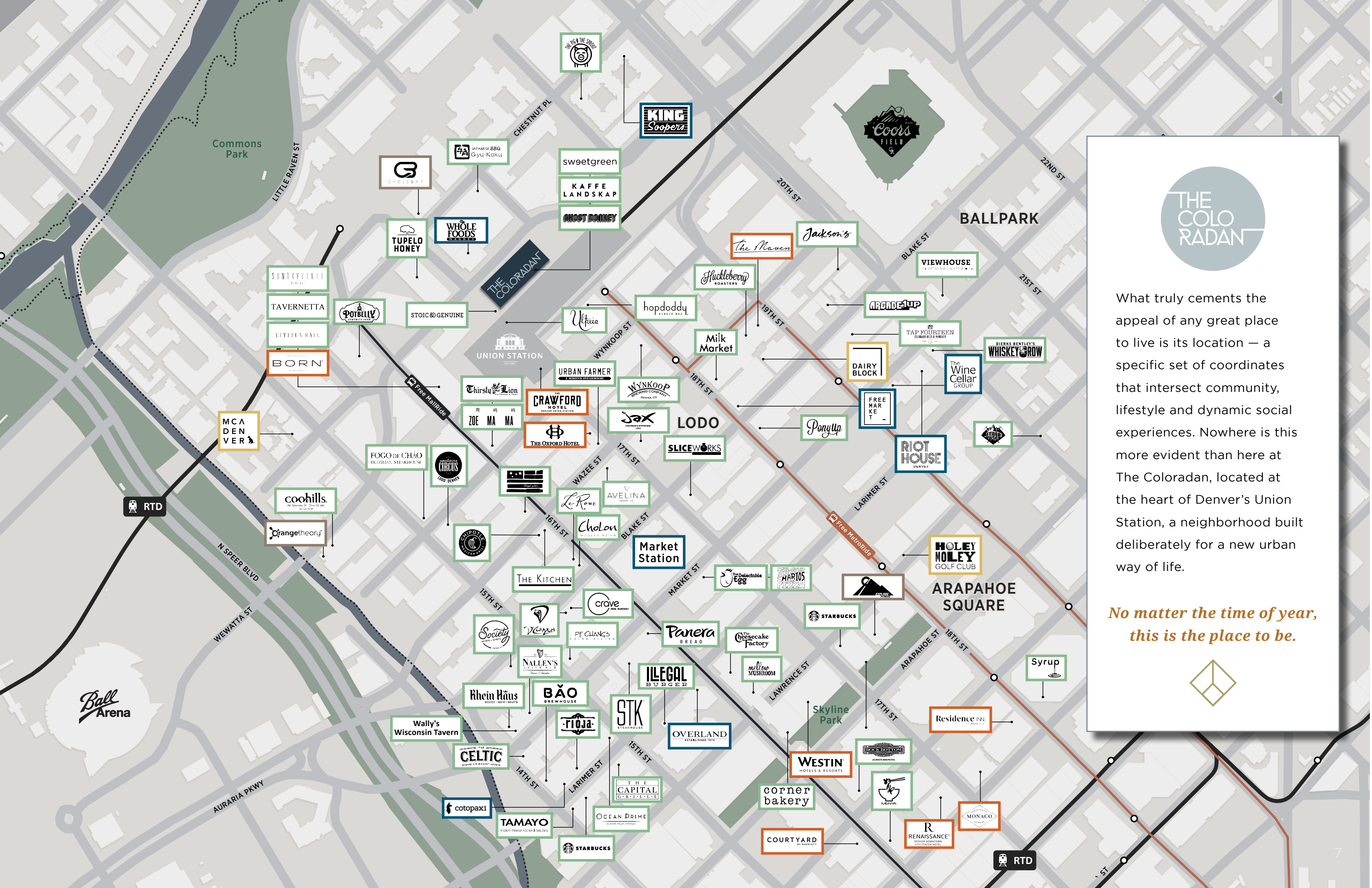

What truly cements the appeal of any great place to live is its location — a specific set of coordinates that intersect community, lifestyle and dynamic social experiences. Nowhere is this more evident than here at The Coloradan, located at the heart of Denver's Union Station, a neighborhood built deliberately for a new urban way of life.

No matter the time of year, this is the place to be.







1750 Wewatta Street | Denver, Colorado 80202

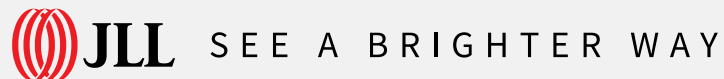

Sam Zaitz
+1 303 931 1201
sam.zaitz@jll.com

Sarah Alfano
+1 303 263 5362
sarah.alfano@jll.com

Brokerage Disclosure

© 2025 Jones Lang LaSalle IP, Inc. All rights reserved. The information contained in this document is proprietary to Jones Lang LaSalle and shall be used solely for the purposes of evaluating this proposal. All such documentation and information remains the property of Jones Lang LaSalle and shall be kept confidential. Reproduction of any part of this document is authorized only to the extent necessary for its evaluation. It is not to be shown to any third party without the prior written authorization of Jones Lang LaSalle. All information contained herein is from sources deemed reliable; however, no representation or warranty is made as to the accuracy thereof.