

For Sublease

1999 Harrison Street, Oakland

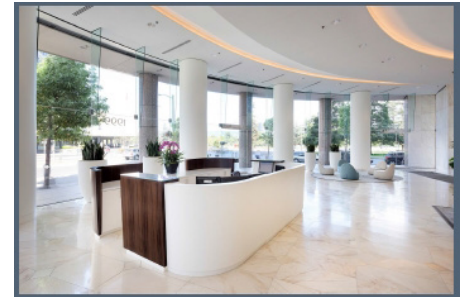

Building Highlights:

- Excellent Downtown location with limitless amenities
- 2 blocks away from 19th Street BART station
- 24-hour security, after hours key card with access to elevators and garage
- Recently renovated lobby and common areas
- Secured bike parking and repair stations with lockers and showers
- Easy access to freeways and highways
- On-site secured parking

Space Highlights:

- Suite 1210 - 12,573 RSF available immediately
- Available through January 31, 2027
- Plug & play
- 13 workstations
- 32 private offices
- 4 conference rooms
- 2 copy/print rooms
- Wellness room
- 2 storage & IDF rooms

Charlie Sweeney
Vice President
charlie.sweeney@jll.com
+1 510 593 8035
License #01987199

Kristi Childers
Managing Director
kristi.childers@jll.com
+1 510 812 2878
License #01997043

Jones Lang LaSalle Brokerage, Inc.

RE lic. #01856260

jll.com

RSF	Availability	Lease Expiration Date
12,573 RSF	Immediately	January 31, 2027

For Sublease

1999 Harrison Street, Oakland, CA



Charlie Sweeney
Vice President
charlie.sweeney@jll.com
+1 510 593 8035
License #01987199

Kristi Childers
Managing Director
kristi.childers@jll.com
+1 510 812 2878
License #01997043

Jones Lang LaSalle Brokerage, Inc.
RE lic. #01856260
jll.com

Although information has been obtained from sources deemed reliable, JLL does not make any guarantees, warranties or representations, express or implied, as to the completeness or accuracy as to the information contained herein. Any projections, opinions, assumptions or estimates used are for example only. There may be differences between projected and actual results, and those differences may be material. JLL does not accept any liability for any loss or damage suffered by any party resulting from reliance on this information. If the recipient of this information has signed a confidentiality agreement with JLL regarding this matter, this information is subject to the terms of that agreement. ©2025. Jones Lang LaSalle Brokerage, Inc. All rights reserved.

RSF	Availability	Lease Expiration Date
12,573 RSF	Immediately	January 31, 2027

For Sublease

1999 Harrison Street, Oakland, CA

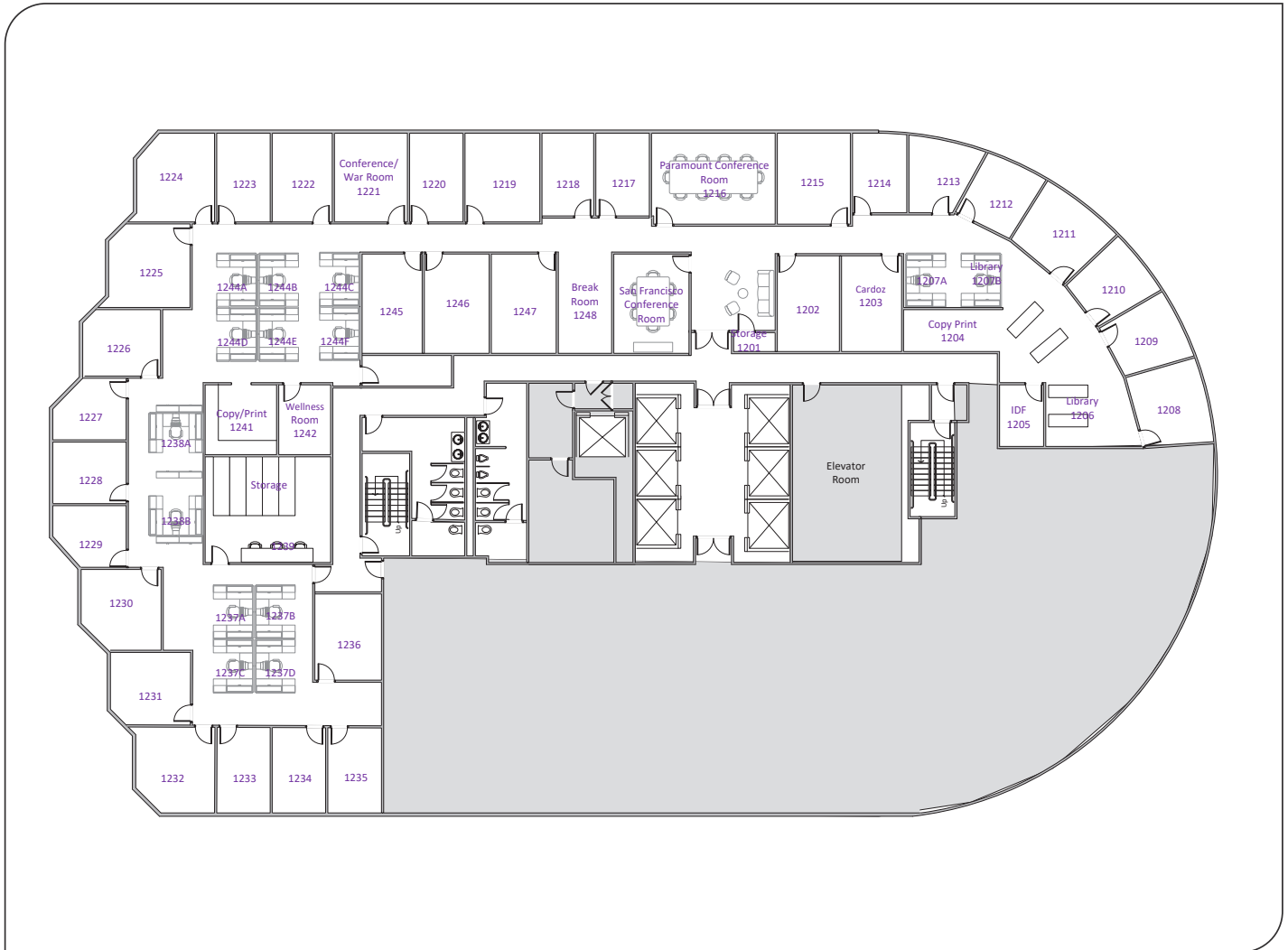

Charlie Sweeney
Vice President
charlie.sweeney@jll.com
+1 510 593 8035
License #01987199

Kristi Childers
Managing Director
kristi.childers@jll.com
+1 510 812 2878
License #01997043

Jones Lang LaSalle Brokerage, Inc.
RE lic. #01856260
jll.com

Although information has been obtained from sources deemed reliable, JLL does not make any guarantees, warranties or representations, express or implied, as to the completeness or accuracy as to the information contained herein. Any projections, opinions, assumptions or estimates used are for example only. There may be differences between projected and actual results, and those differences may be material. JLL does not accept any liability for any loss or damage suffered by any party resulting from reliance on this information. If the recipient of this information has signed a confidentiality agreement with JLL regarding this matter, this information is subject to the terms of that agreement. ©2025. Jones Lang LaSalle Brokerage, Inc. All rights reserved.