

5,086 SF
AVAILABLE NOW

11100 Roselle St, Suite B



Exclusive leasing agents:

Chad Urie
tel +1 858 410 1187
chad.urie@jll.com
RE license #01261962

Grant Schoneman
tel +1 858 410 1252
grant.schoneman@jll.com
RE license #01516695

Taylor DeBerry
tel +1 858 410 6392
taylor.deberry@jll.com
RE license #02014850

11100 ROSELLE STREET

SUITE B | 45% LAB | 55% OFFICE | AVAILABLE NOW

Virtual Tour

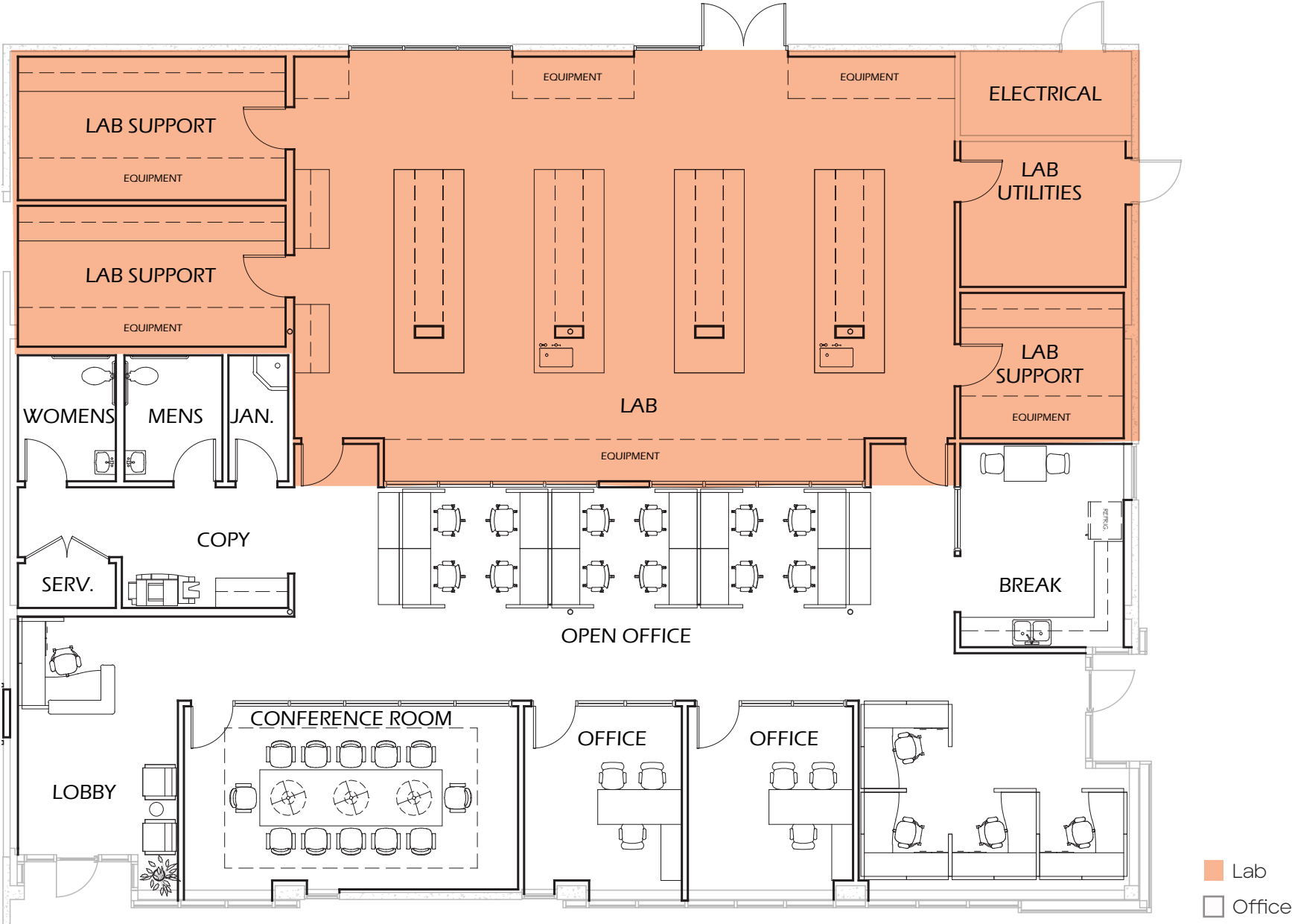



AMENITIES

- Fully Amenitized Campus
- Soma Cafe & Deli
- Conference Center
- Fitness Center
- Collaboration Lounge
- Catering Kitchen
- Restrooms/locker rooms
- Bike Storage
- Cafe
- Training Room
- Gym



Amenity Building



Cafe

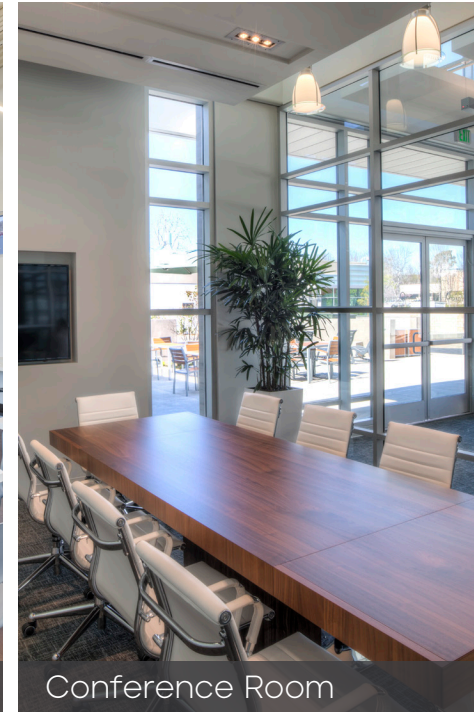

Conference Room



Training Room



Gym



Game Room