



Mission Gorge Square

Trader Joe's and Ulta Beauty Anchored
Center with Shop Space Availabilities

9640-9760 Mission Gorge Rd. Santee, CA

Property Overview

Mission Gorge Square is a thriving neighborhood center strategically situated in the bustling retail hub of Santee. Its exceptional location is further enhanced by the presence of renowned retailers and crowd-drawing retailers Trader Joe's and Ulta Beauty. The Santee trade area boasts the highest sales volumes for grocery and daily needs in East San Diego, making Mission Gorge Square an ideal destination for businesses looking to enter this lucrative market.



Rent negotiable



Anchored by a new Trader Joe's & Ulta Beauty



Surrounded by dense residential communities



New monument signage



+36,000 cars per day



Visits

1.9M
per year

Visits YoY

+16.6%
per year

Traffic Count

36K
cars per day

Property overview and demographics

- 2,425 - 4,850 SF of shop space available
- Signalized intersection
- Estimated 276,835 people living within a 5-mile radius from the shopping center
- Average household income of \$120,419 within a 5-mile radius
- Tenants include: Trader Joe's, Ulta Beauty, El Pollo Loco, IHOP



Rent negotiable



Anchored by a new Trader Joe's & Ulta Beauty



Surrounded by dense residential communities



Monument signage available



+36,000 cars per day

Nearby retailers:



Demographics

	1 mile radius	3 mile radius	5 mile radius
Total population	13,375	107,504	276,835
Avg. household income	\$114,398	\$127,365	\$120,419
Median home value	\$660,430	\$742,454	\$758,891
Total consumer expenditure	\$65,465,950	\$623,130,412	\$1,838,839,701

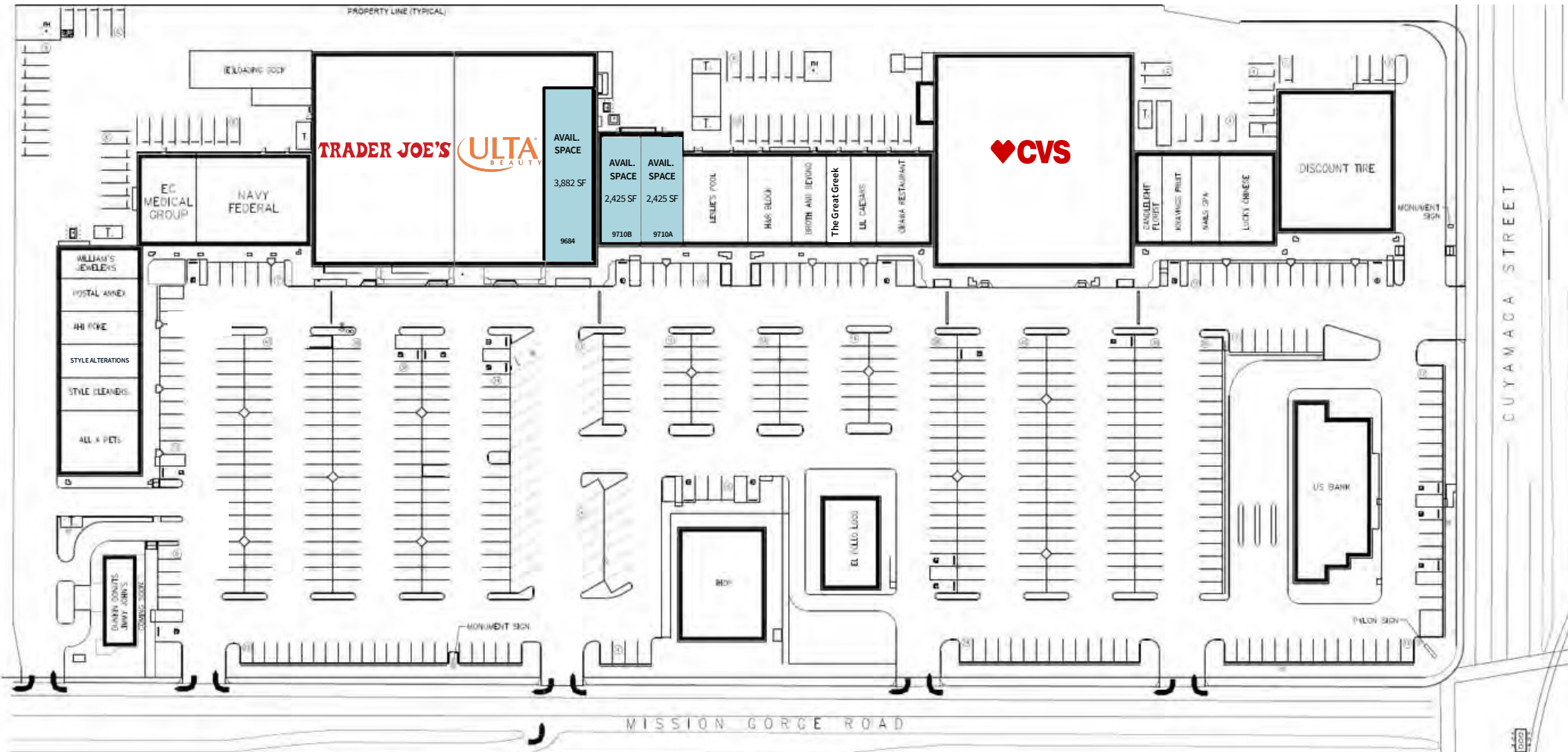

	Square Footage	Rate/SF	Availability
9684	3,882	Negotiable	Immediate
9710A	2,425	Negotiable	Immediate
9710B	2,425	Negotiable	Immediate

Area map





Craig Killman
Managing Director
+1 858 410 1237
Craig.Killman@jll.com
Lic #00884183

Shauna Mattis
Managing Director
+1 310 694 3190
Shauna.Mattis@jll.com
Lic #01071320

Maxx Killman
Associate
+1 858 812 2360
Maxx.Killman@jll.com
Lic #02243247



Although information has been obtained from sources deemed reliable, neither Owner nor JLL makes any guarantees, warranties or representations, express or implied, as to the completeness or accuracy as to the information contained herein. Any projections, opinions, assumptions or estimates used are for example only. There may be differences between projected and actual results, and those differences may be material. The Property may be withdrawn without notice. Neither Owner nor JLL accepts any liability for any loss or damage suffered by any party resulting from reliance on this information. If the recipient of this information has signed a confidentiality agreement regarding this matter, this information is subject to the terms of that agreement. © 2024 Jones Lang LaSalle IP, Inc. All rights reserved.