



# 1,500 SF Available For Lease

300 Washington Avenue, Carlstadt, NJ 07072

**Craig Parcels**

*Senior Vice President*

[craig.parcels@jll.com](mailto:craig.parcels@jll.com)

M: +1 201 618 7223





# 300 Washington Avenue

## Property Highlights

- Neighbourhood strip anchored by Valero Gas seeking tenants
- Property located at the signalized intersection of Washington Avenue and Route 120
- Approximately 100 yards to the entrance of American Dream and Meadowlands Complex
- Direct access to Route 120 and feeds into I-95/NJ Turnpike
- Available space:  
Unit 3: 1,500 SF (Kitchen infrastructure in place)
- Asking rent: Upon request
- NNN: \$7.37/SF

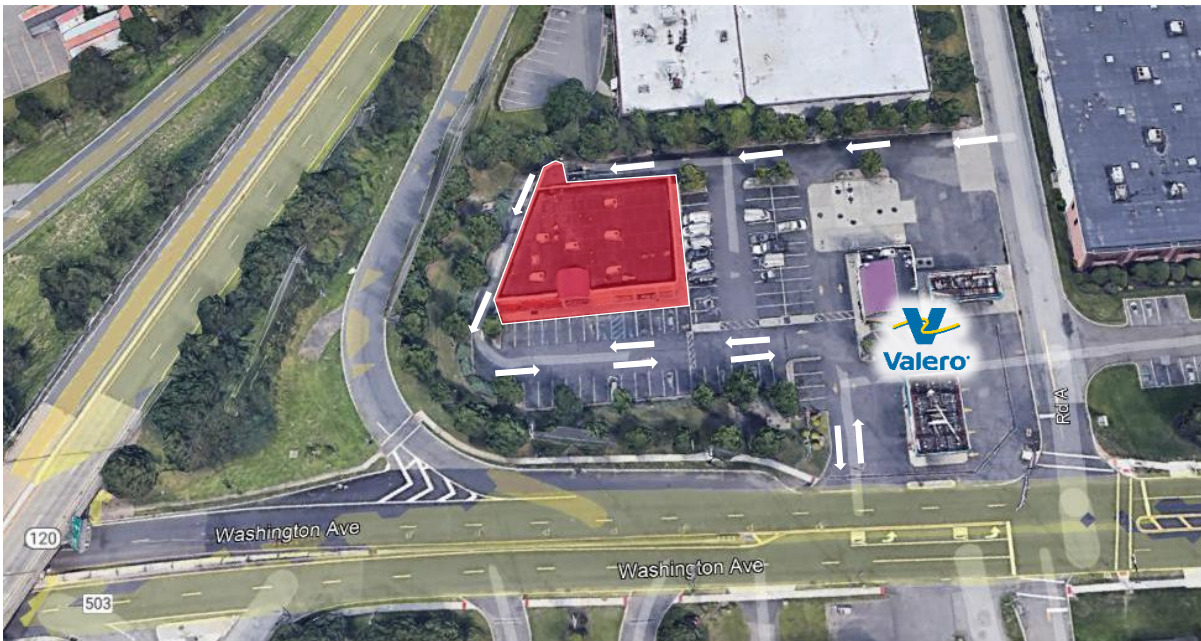

## Traffic Counts

- Paterson Plank Road: 20, VPD
- State Route 120: 51,478 VPD
- I-95: 89,893 VPD

## Signage Opportunity





# Market Aerial



## AMERICAN DREAM

### ATTRACTIONS:

BIG SNOW  
NICKELODEAN UNIVERSE THEME PARK  
THE RINK  
SEA LIFE AQUARIUM  
BLACKLIGHT MINI GOLF  
LEGOLAND DISCOVERY CENTER

AX  
ARMANI EXCHANGE

GUCCI

HERMÈS  
PARIS

John  
Fifth Avenue

DOLCE & GABBANA

lululemon

SAINT LAURENT

ZARA MANGO

TIFFANY & CO.

# Floor Plan

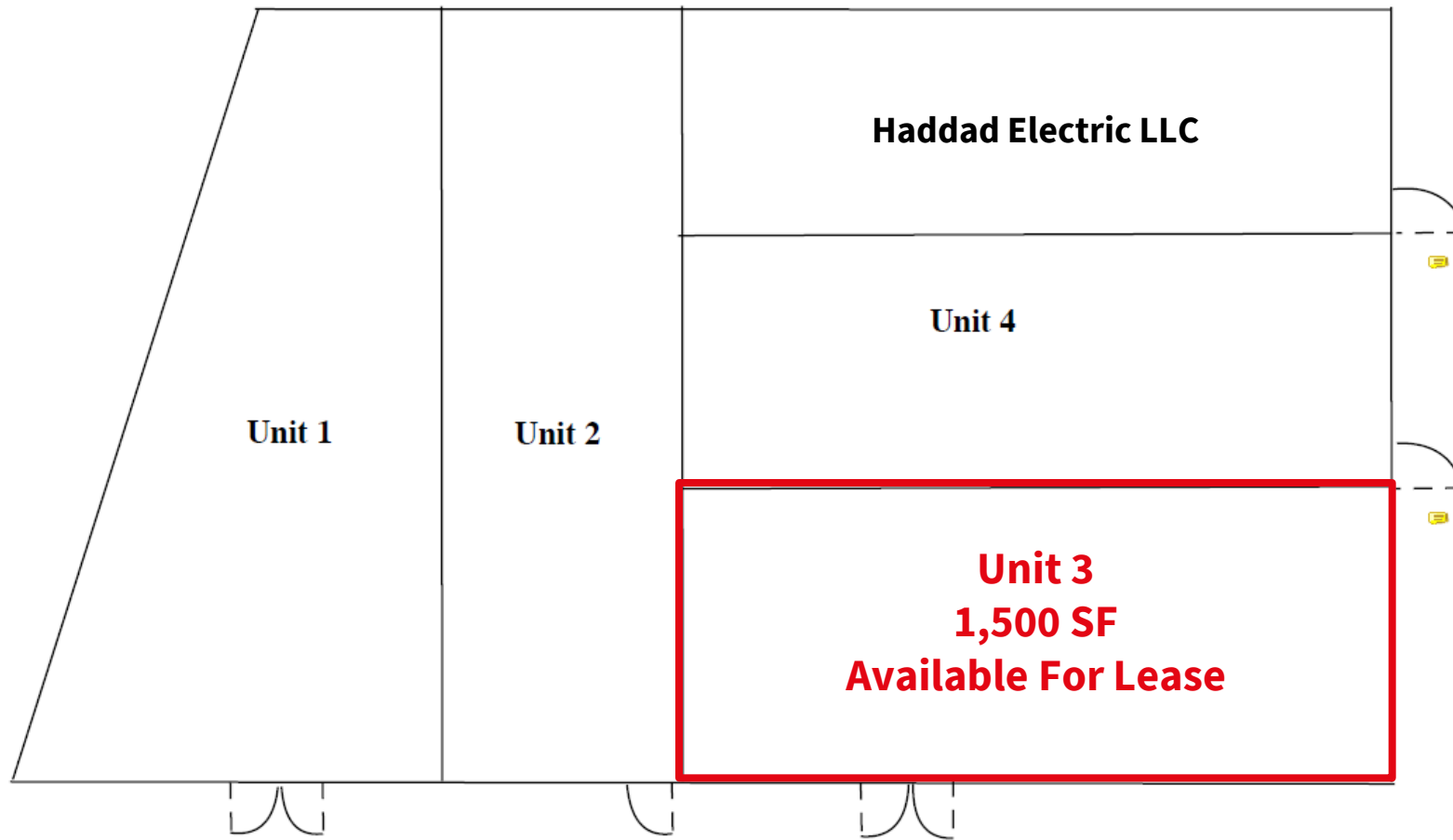

## Contact

Craig Parcels  
Vice President  
Direct: +1 973 829 4780  
Mobile: +1 201 618 7223  
craig.parcels@am.jll.com

Although information has been obtained from sources deemed reliable, JLL does not make any guarantees, warranties or representations, express or implied, as to the completeness or accuracy as to the information contained herein. Any projections, opinions, assumptions or estimates used are for example only. There may be differences between projected and actual results, and those differences may be material. JLL does not accept any liability for any loss or damage suffered by any party resulting from reliance on this information. If the recipient of this information has signed a confidentiality agreement with JLL regarding this matter, this information is subject to the terms of that agreement. ©2022. Jones Lang LaSalle IP, Inc. All rights reserved.

## Demographics



**97,249**

Population



**\$93,974**

Med. HH Income



**71,314**

Employees



**6,483**

Businesses

Demographics taken within 3 miles  
Source: ESRI, 2024

