

842

Gerrard Street East

Corner Retail Opportunity
with Ample Parking



Opportunity Overview

842 Gerrard Street East is strategically located on the corner of Carlaw Avenue and Gerrard Street East. This space offers approximately 3,500 SF of retail area with pre-existing restaurant infrastructure from its previous tenant, The Real Jerk. The 506 streetcar stops directly in front of the unit, and the location sees high vehicular traffic from Carlaw Avenue, a major north-south thoroughfare. The property features ample parking, a clean rectangular layout, and excellent signage potential. With access to the Don Valley Parkway within a 5-minute drive, the site offers convenient connectivity to major transportation routes.



Property Details

Size:	+/- 3,500 SF
Term:	5 + 5 Years
Available:	Immediately
Net Rent:	Please Contact Listing Agents
Additional Rent	\$15.00 (est. 2025)

Highlights

- High-profile retail opportunity at the corner of Carlaw Avenue and Gerrard Street East
- Pre-fixtured restaurant space
- 506 streetcar stop directly in front of the unit
- Ample on-site parking
- Clean rectangular floor plate with minimal columns
- Great branding opportunity with wrap-around frontage
- 5-minute drive to Don Valley Parkway



Floor Plan

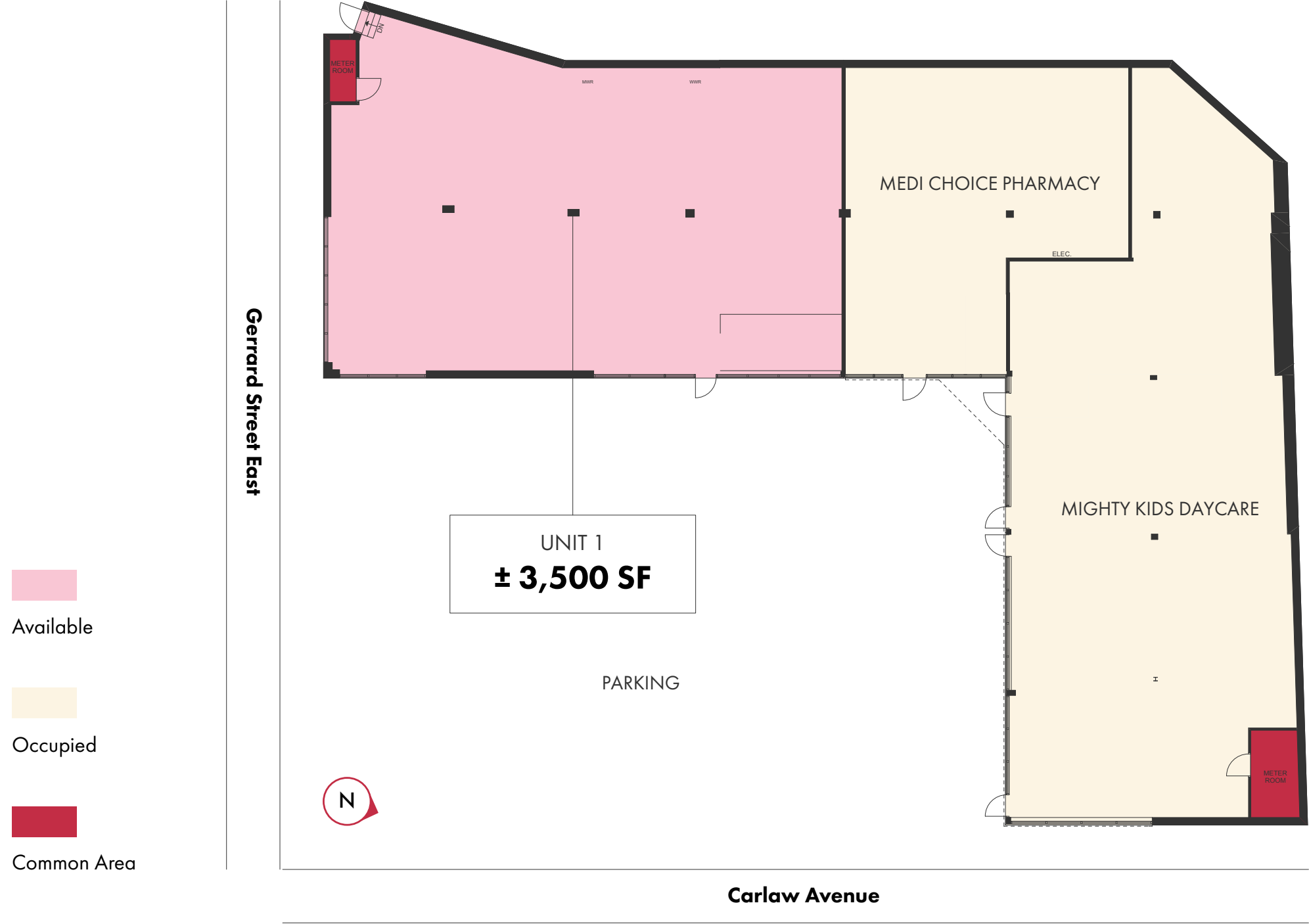

Neighborhood

Parks

- 1. Riverdale Park Track
- 2. Withrow Park
- 3. Gerrard Carlaw Parkette Dog Park

Restaurants and Cafes



- 1. Wynona Toronto
- 2. Maple Leaf Tavern
- 3. Dineen Outpost
- 4. Chula Taberna Mexicana
- 5. Riverdale Perk Cafe
- 6. Rooster Coffee House
- 7. Que Ling Vietnamese Cuisine
- 8. Lady Marmalade
- 9. Slowhand Sourdough Pizza
- 10. Lamoon Thai Cafe
- 11. Mi Mi
- 12. Piano Piano Restaurant

 **97 Walk Score**

 **91 Transit Score**

Shopping and Amenities

- 1. The Beer Store
- 2. LCBO
- 3. Gerrard Square Shopping Centre
- 4. Scotiabank
- 5. The Home Depot
- 6. Food Basics
- 7. Walmart
- 8. Staples

-  Dundas streetcar line (505)
-  Gerrard streetcar line (506)

Demographics – 2KM

- Total Population: 106,740
- Daytime Populations: 99,848
- Growth Rate Over Next 5 Years: 8.3%
- Average HH Income: \$153,027
- Median Age: 38.6

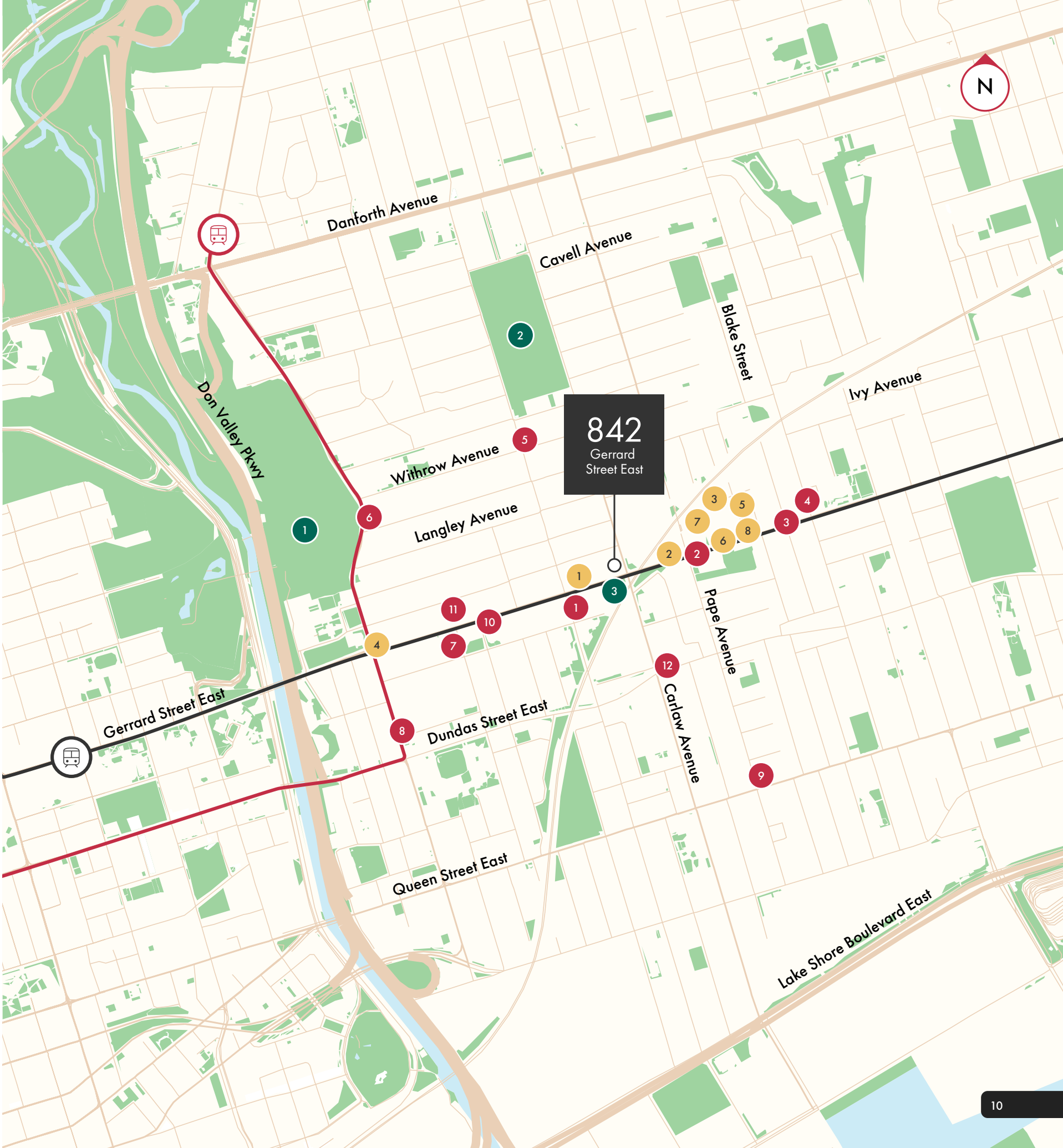



842 Gerrard Street East

Corner Retail Opportunity
with Ample Parking

Graham Smith*
Executive Vice President
+1 416 855 0914
Graham.Smith@jll.com

Brandon Gorman**
Executive Vice President
+1 416 855 0907
Brandon.Gorman@jll.com

Nick Aspros*
Senior Vice President
+1 416 938 9518
Nick.Aspros@jll.com

Austin Jones**
Associate Vice President
+1 416 304 6050
Austin.Jones@jll.com

Matthew Marshall*
Associate Vice President
+1 416 238 9925
Matthew.Marshall@jll.com

Brett Varey*
Associate
+1 416 304 6064
Brett.Varey@jll.com

Although information has been obtained from sources deemed reliable, neither Owner nor JLL makes any guarantees, warranties or representations, express or implied, as to the completeness or accuracy as to the information contained herein. Any projections, opinions, assumptions or estimates used are for example only. There may be differences between projected and actual results, and those differences may be material. The Property may be withdrawn without notice. Neither Owner nor JLL accepts any liability for any loss or damage suffered by any party resulting from reliance on this information. If the recipient of this information has signed a confidentiality agreement regarding this matter, this information is subject to the terms of that agreement. ©2025 Jones Lang LaSalle IP, Inc. All rights reserved. **Broker. *Sales Representative.