

Available November 1, 2025



For lease

4051 Fondorf Drive, Columbus, Ohio 43228

 **JLL** SEE A BRIGHTER WAY

Site plan

Property specifications

- 38,962 SF
- 3,682 SF office
- 20' clear height
- 4 dock doors
- 45' x 40' Column spacing
- LED Lighting
- 900 Amps Power
- Zoning: M Columbus

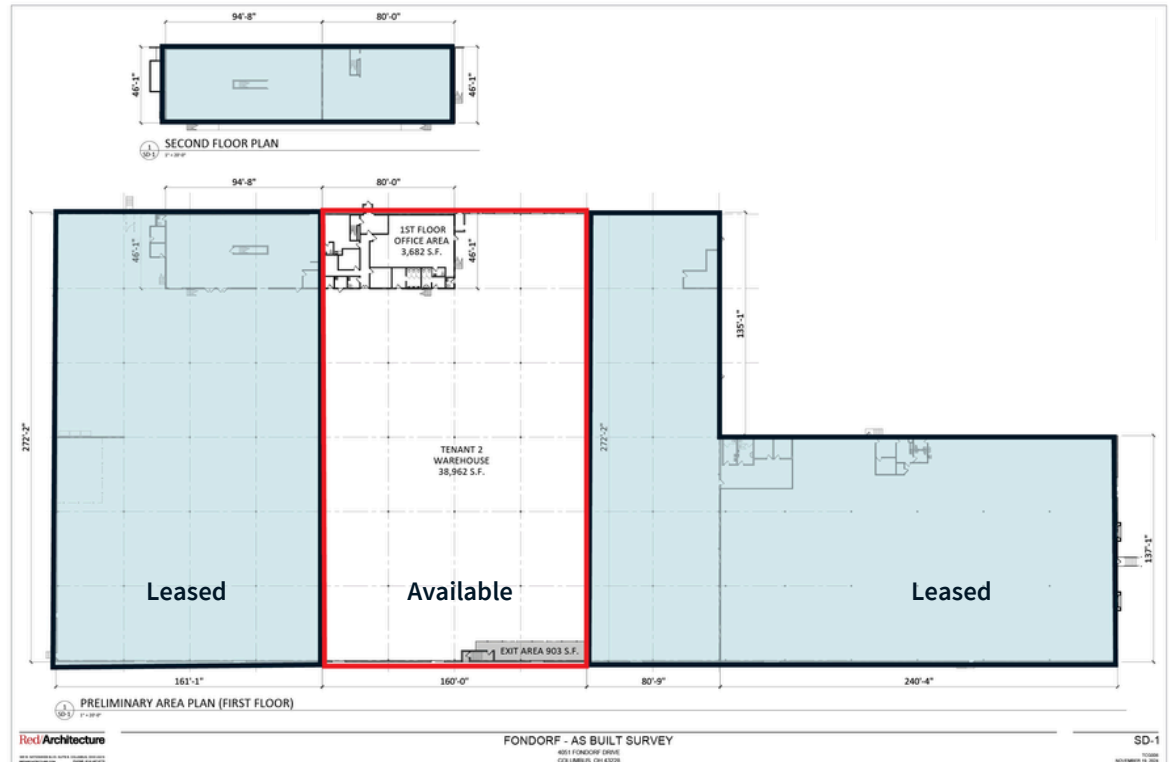

Access

Discover a prime opportunity in an infill location, perfect for seamless connectivity. With I-70 just 1.5 miles away and I-270 less than three miles, you're positioned for unmatched highway access. Plus, the added advantage of rail access makes this property a standout choice for your next venture. Explore the possibilities and see a brighter way forward with us.

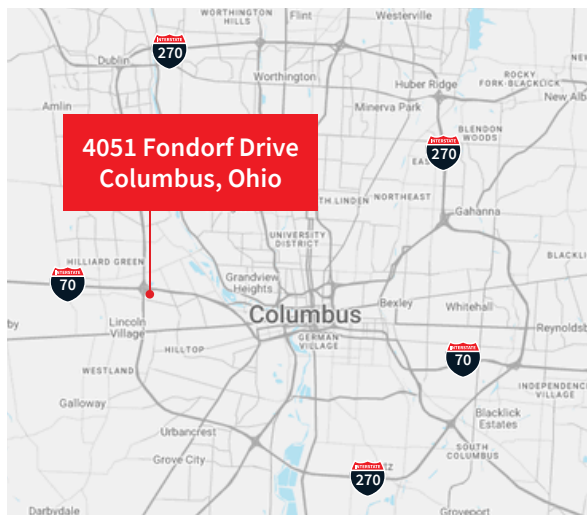

JLL

Josh Weithman

josh.weithman@jll.com
+1 (614)460 4410

Matthew Collins

matthew.collins@jll.com
+1 (614)460 4483

Jones Lang LaSalle Americas, Inc. License #: CO508577000