



For sublease

±13,724 SF
industrial space

4045 Nelson Avenue
Concord, CA

Space Specifications

- ±3,075 SF of new office space
- One (1) dock high door
- One (1) grade level door
- 480v + 208v power
- Immediate access to Hwy 4, 242 & I-680
- Sublease exp: 4/30/2028
- Rate: \$1.50/psf NNN



Chris Burns

RE Lic# 01880060

+1 925 389 0292

christopher.burns@jll.com

Matt Bracco

RE Lic# 01185434

+1 925 200 3537

matt.bracco@jll.com

Jones Lang LaSalle Brokerage, Inc. RE Lic# 01856260

Site Plan

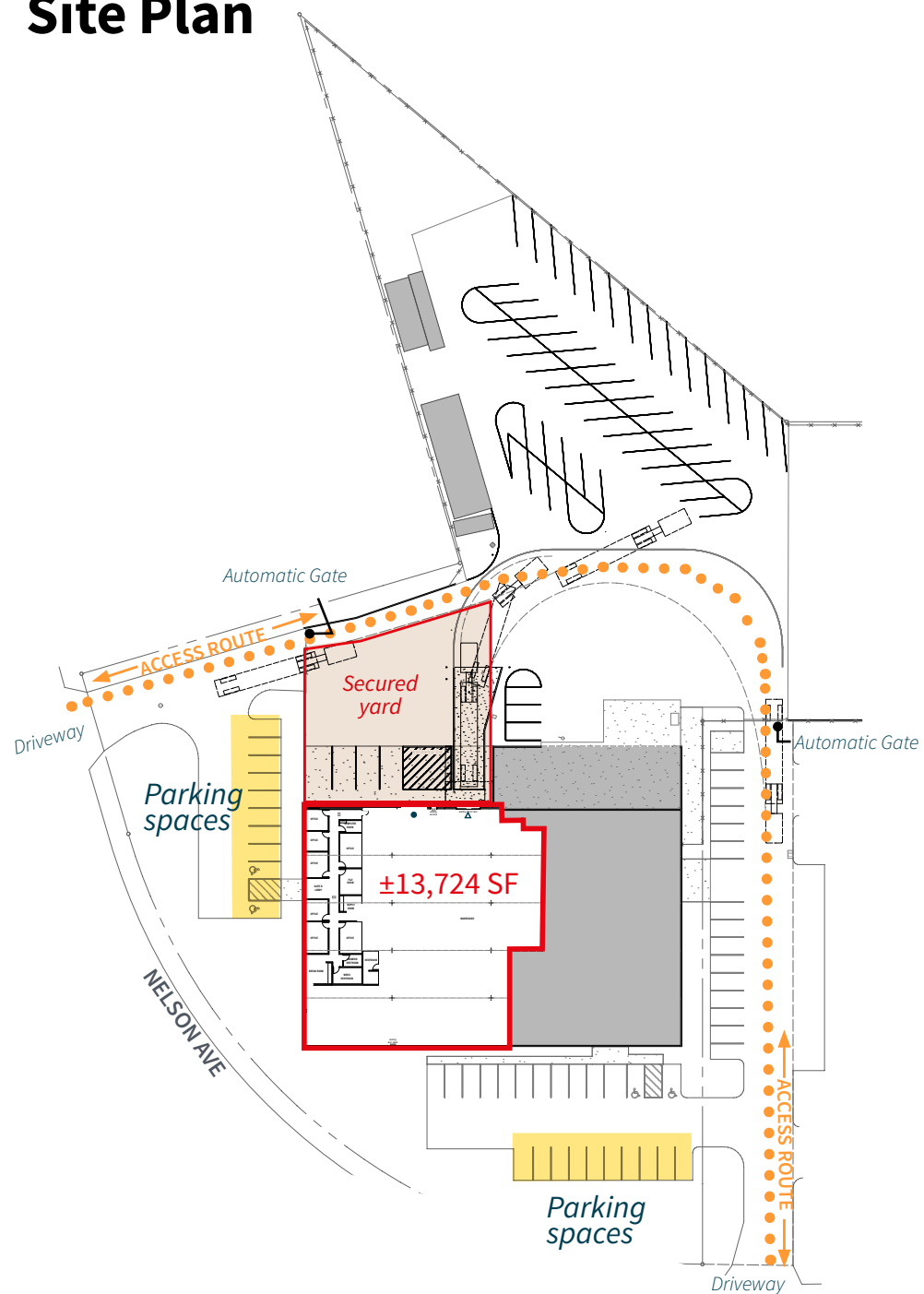

Floor Plan

±13,724 SF for sublease

- ±3,075 SF of new office space
- Dock with canopy including a 12'x14' automated door, EOD leveler, truck restraint
- Additional 12'x12' grade level door
- Secure yard with automated gated entrances
- Trailer and box van parking
- Warehouse restroom with shower
- 15' - 18' clear height
- Extensive 480v + 208v power
- LED warehouse lighting
- 1/2 mile to Hwy 4, 242 & I-680

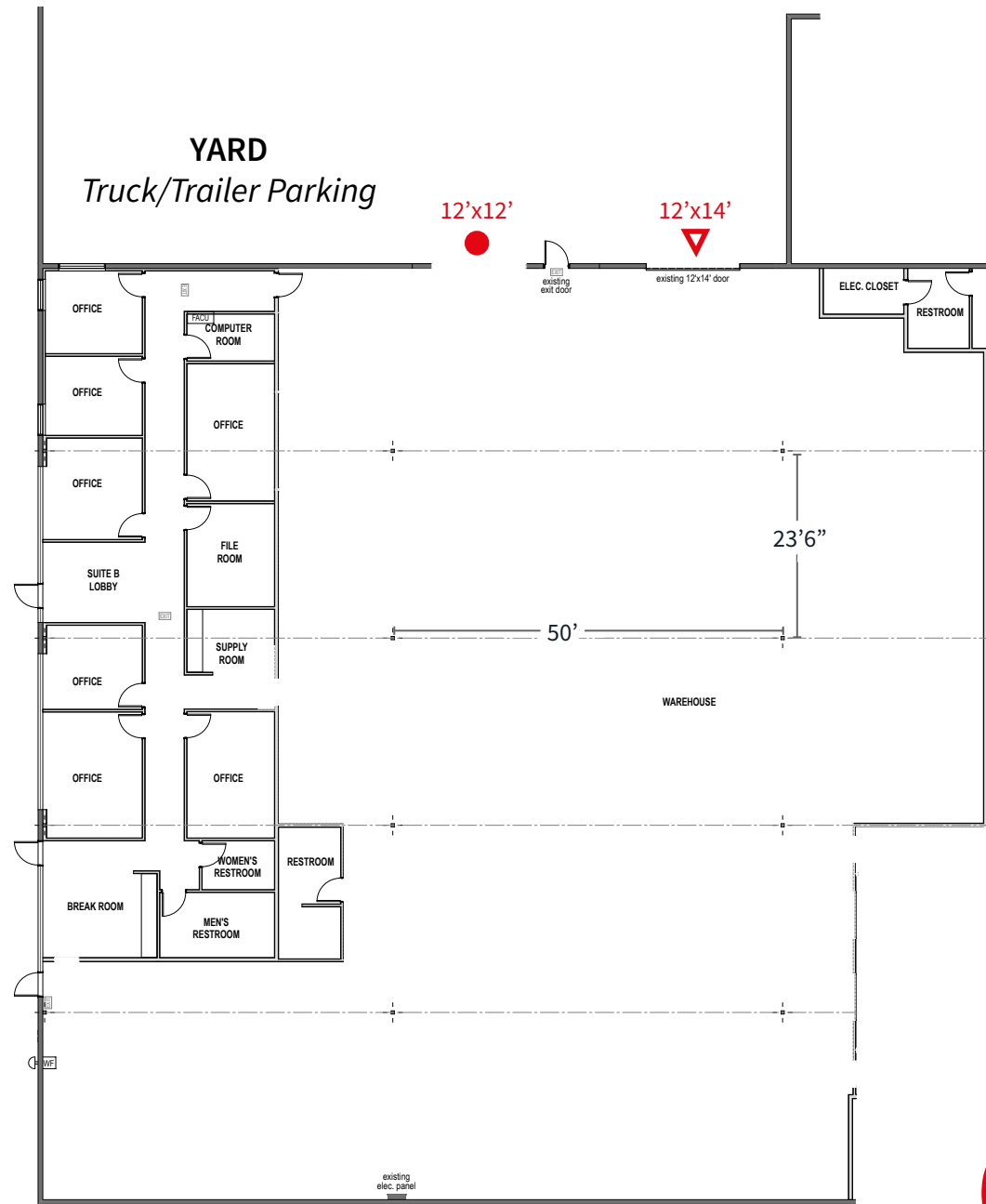

- ▽ Dock high door
- Grade level door

Location



For more information or to tour, please contact:

Chris Burns

RE Lic# 01880060

+1 925 389 0292

christopher.burns@jll.com

Matt Bracco

RE Lic# 01185434

+1 925 200 3537

matt.bracco@jll.com



Jones Lang LaSalle Brokerage, Inc. RE Lic# 01856260

Although information has been obtained from sources deemed reliable, neither Owner nor JLL makes any guarantees, warranties or representations, express or implied, as to the completeness or accuracy as to the information contained herein. Any projections, opinions, assumptions or estimates used are for example only. There may be differences between projected and actual results, and those differences may be material. The Property may be withdrawn without notice. Neither Owner nor JLL accepts any liability for any loss or damage suffered by any party resulting from reliance on this information. If the recipient of this information has signed a confidentiality agreement regarding this matter, this information is subject to the terms of that agreement. ©2025. Jones Lang LaSalle IP, Inc. All rights reserved.