



# For lease

Flex/office space available

**11,190 SF | 8,613 SF**

12000 Ridgemont Drive  
Urbandale, Iowa 50323

## Property overview

- Availability:
  - 12000: 11,190 SF
  - 12000: 8,613 SF
    - Lease rate: \$9.95 RSF NNN
- Est. OPEX: \$6.17/SF
- Year built: 2004
- Full building size: 75,000 SF

12000 Ridgemont Drive is well-located off of I-80/35. Recently updated office space and can be subdivided to 6,000 RSF. Ample parking available and building offers fully wet sprinkler system.

**Justin Lossner, CCIM, SIOR**  
Senior Managing Director  
Justin.Lossner@jll.com  
+1 515 371 0846

**Lucas Hedstrom**  
Vice President  
Lucas.Hedstrom@jll.com  
+1 515 564 9269

[jll.com/des-moines](http://jll.com/des-moines)

Jones Lang LaSalle Americas, Inc.





## Images

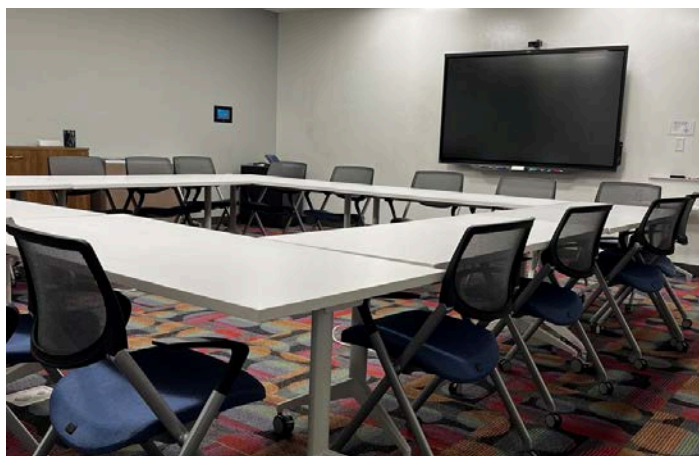

*Office layout*

*Conference room*



## Site plan

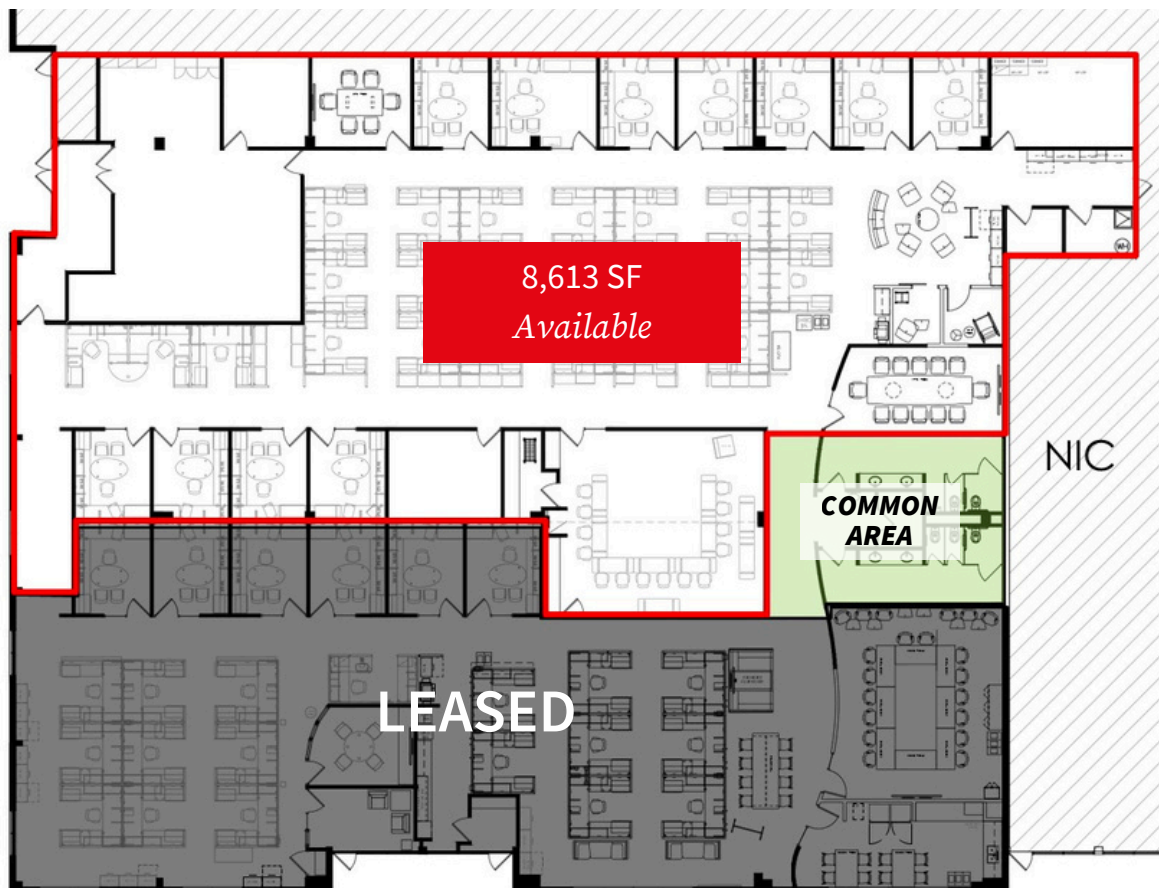
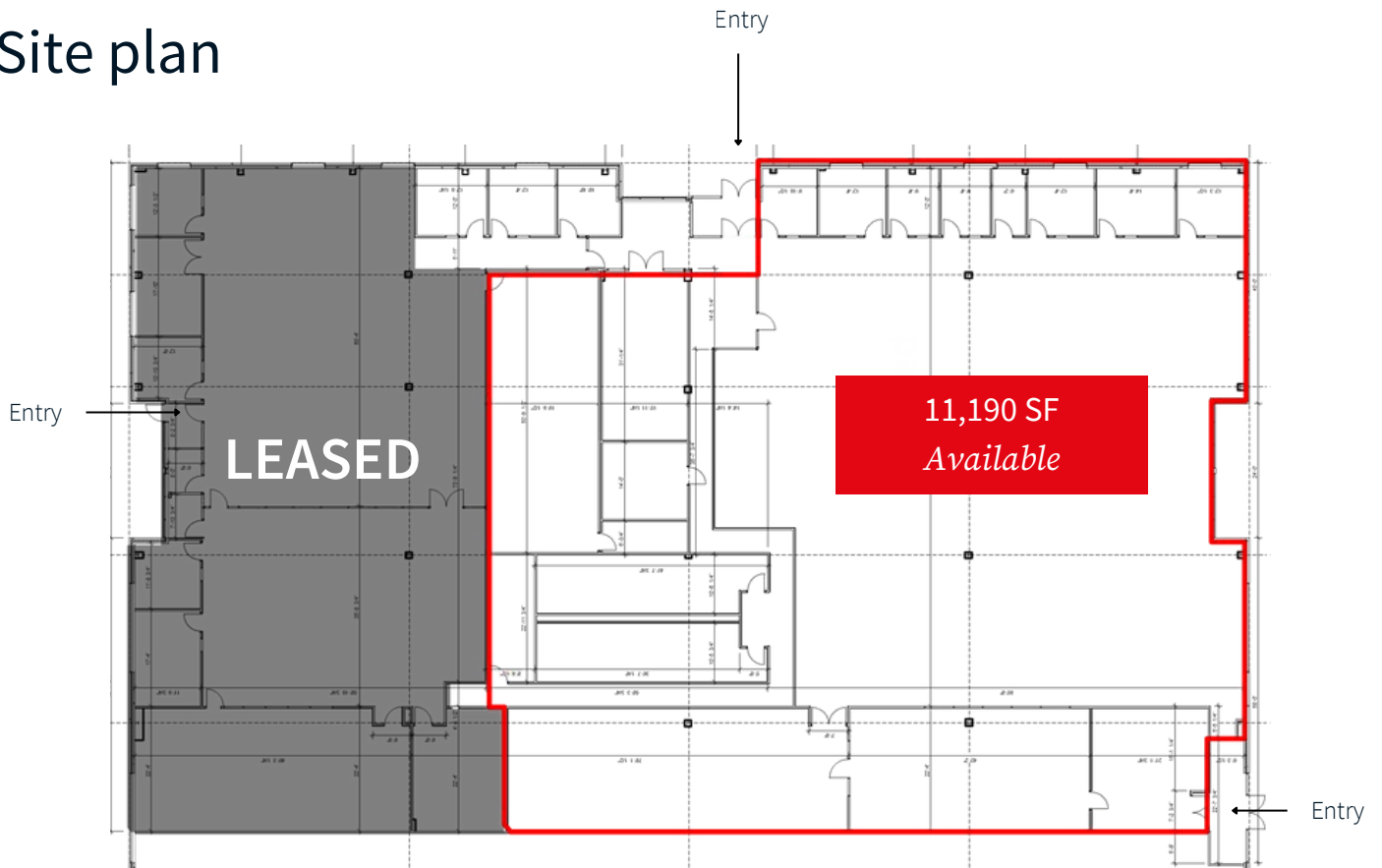



# For lease

12000 Ridgemont Drive | Urbandale, Iowa 50323



**Justin Lossner, CCIM, SIOR**

Senior Managing Director

[Justin.Lossner@jll.com](mailto:Justin.Lossner@jll.com)

+1 515 371 0846

**Lucas Hedstrom**

Vice President

[Lucas.Hedstrom@jll.com](mailto:Lucas.Hedstrom@jll.com)

+1 515 564 9269

[jll.com/des-moines](http://jll.com/des-moines)

Jones Lang LaSalle Americas, Inc.

