

For Lease

Up to 4,500 SF Available



Hwy 98 and N Glades Trail - 1 Acre Panama City Beach, FL



Hwy 98 and N Glades Trail - 1 Acre Panama City Beach, FL

Property specifications

- Traffic light planned for Hwy 98 and N Glades Trail intersection
- Traffic counts for Hwy 98 - 44,500 CPD
- Flat site with access road
- Drive through restaurant engineering plans available for use
- Close proximity to Duplin Winery of Rose Hill - a 38,000 SF award-winning entertainment complex

Estimated Demographics	1-mile	3-mile	5-mile
Estimated Population	3,984	15,145	26,582
Median Household Income	\$96,352	\$87,787	\$80,152
Median Age	49.0	43.3	43.3

Source: Esri, 2025

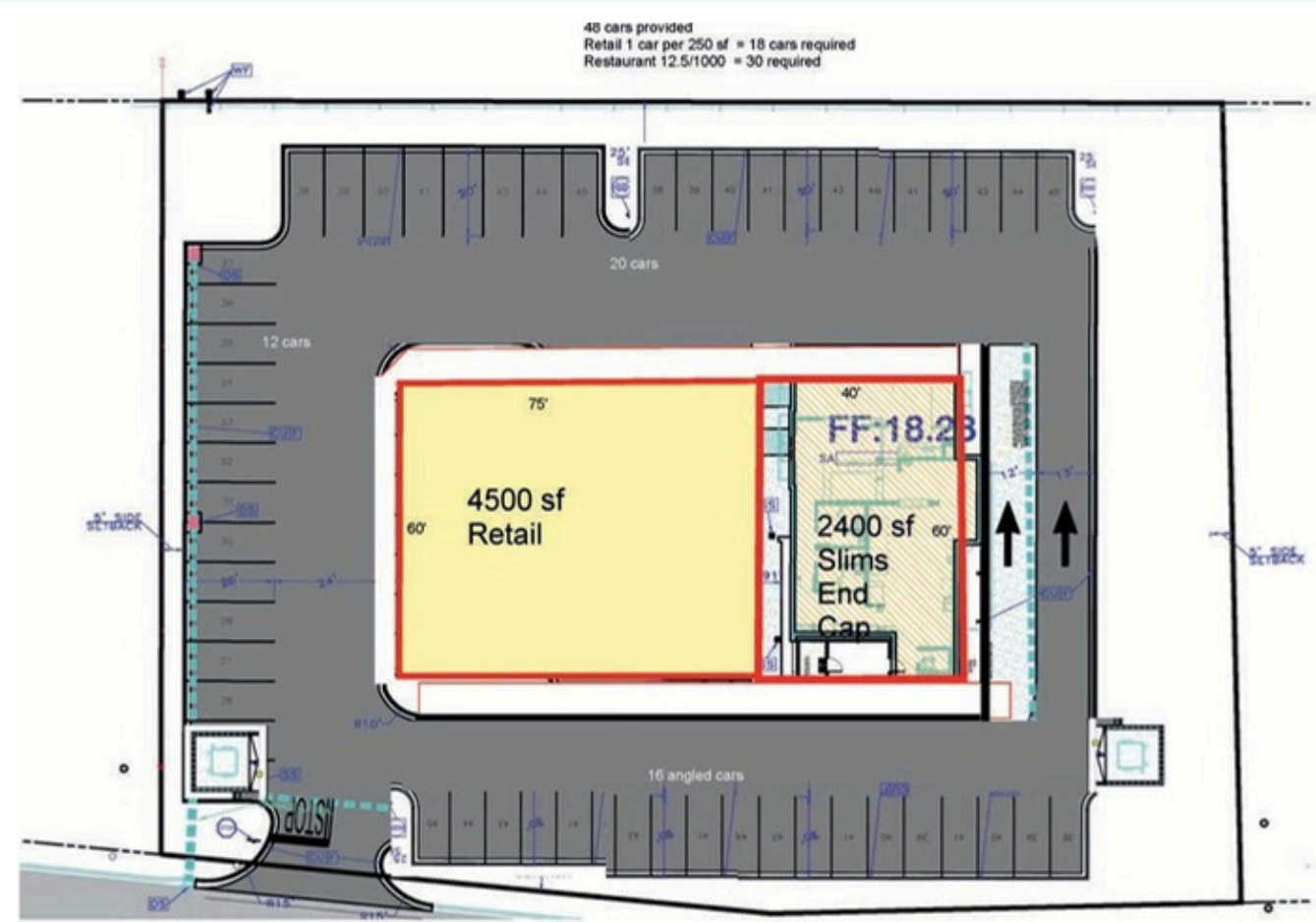



Contact for more information:

Sherri Wilson

Senior Vice President

Sherri.Wilson@jll.com

1 404 995 2274

