

# For lease



Retail space available for lease  
in Uptown Ankeny along the  
High Trestle Trail

320 - 326 SW Maple Street  
Ankeny, IA 50023

## Property overview

Available: 1,084 RSF - *Suite 324*

Lease rate: \$15.00/RSF NNN

Est. OPEX (2025): \$7.71/RSF (*utilities included*)

- Multi-tenant building suitable for office or retail uses
- Located adjacent to multiple single-family and multi-housing developments, retail, commercial, and hospitality.

Contact broker for  
additional information

[jll.com/des-moines](http://jll.com/des-moines)

### Meredith Hedstrom

Vice President

[meredith.hedstrom@jll.com](mailto:meredith.hedstrom@jll.com)

+1 515 419 2963

### Nick Anderson

Associate

[nicholas.anderson@jll.com](mailto:nicholas.anderson@jll.com)

+1 515 729 6015

### Marcus R. Pitts, CCIM, SIOR

Senior Managing Director

[marcus.pitts@jll.com](mailto:marcus.pitts@jll.com)

+1 515 556 4727



## Images

*Images show previous tenant space. Furniture and fixtures not included in lease.*



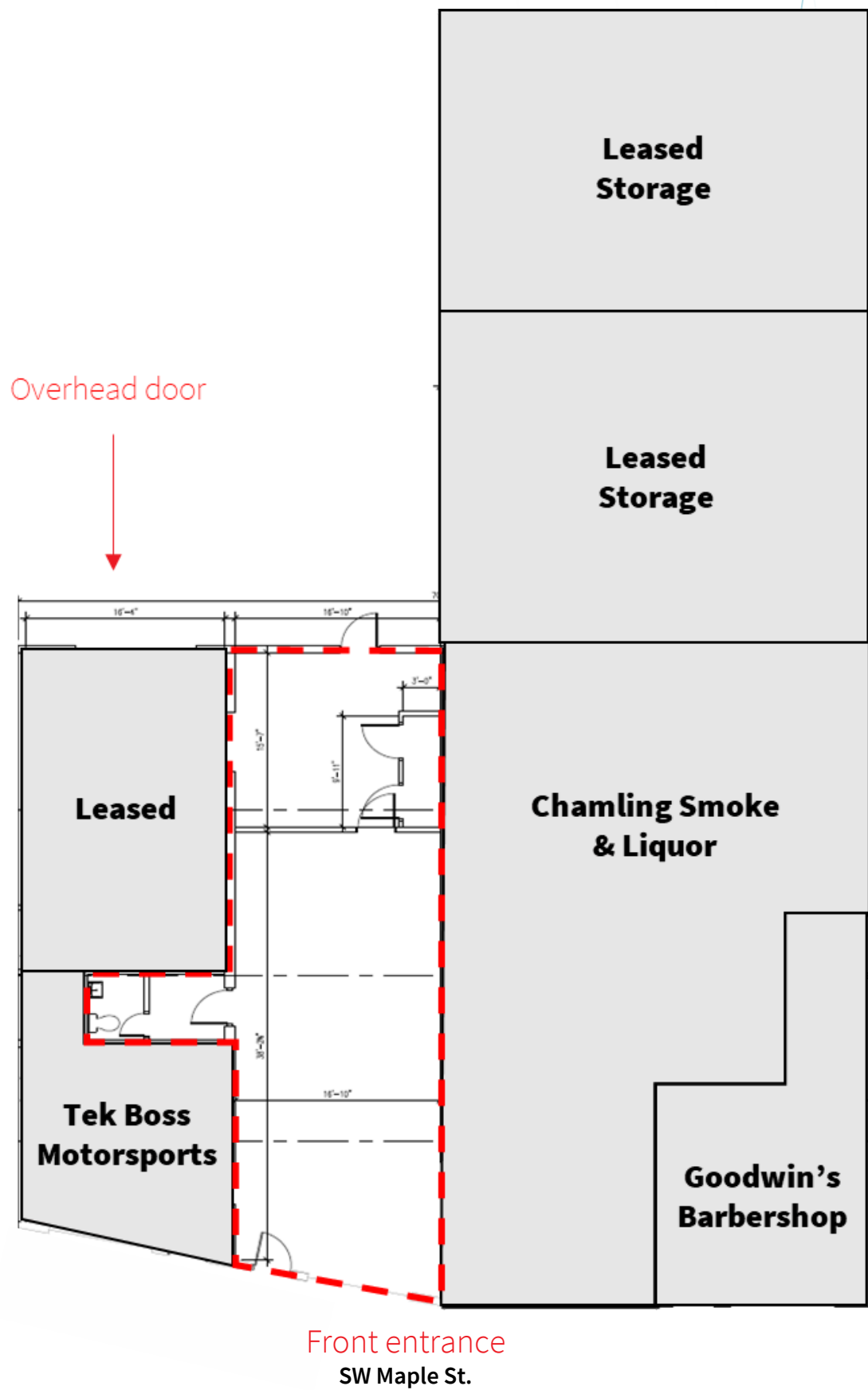



# 320 - 326 SW Maple St.

Ankeny, IA 50023



## Uptown Ankeny

The Uptown Ankeny business district is a thriving retail and commercial area that promotes entertainment, events, and tourism. Located in the heart of Ankeny on SW 3<sup>rd</sup>, from Ankeny Ankeny Blvd. all the way through SW Maple, are many locally owned businesses that have been established over the years and have helped mold Ankeny's economy to what it is today.

### Meredith Hedstrom

Vice President

[meredith.hedstrom@jll.com](mailto:meredith.hedstrom@jll.com)

+1 515 419 2963

### Nick Anderson

Associate

[nicholas.anderson@jll.com](mailto:nicholas.anderson@jll.com)

+1 515 729 6015

### Marcus R. Pitts, CCIM, SIOR

Senior Managing Director

[marcus.pitts@jll.com](mailto:marcus.pitts@jll.com)

+1 515 556 4727

[jll.com/des-moines](http://jll.com/des-moines)