

For lease

6,700 SF industrial space
in the heart of Doral

10570 NW 37th Terrace
Doral, FL 33178

Property specifications

- 6,700 SF total
- 850 SF office
- 21' clear height
- 1 double-wide OH door
- 1 concrete ramp
- All-concrete construction
- Van-high loading position
- Twin-T roof
- 8 surface parking spaces
- Power: 3-phase - 200 amps



Lease through January 1, 2026

Audley Bosch
audley.bosch@jll.com
(305) 960 8404

Matt Maciag
matt.maciag@jll.com
(305) 960-8409

Floorplan

6,700 SF available

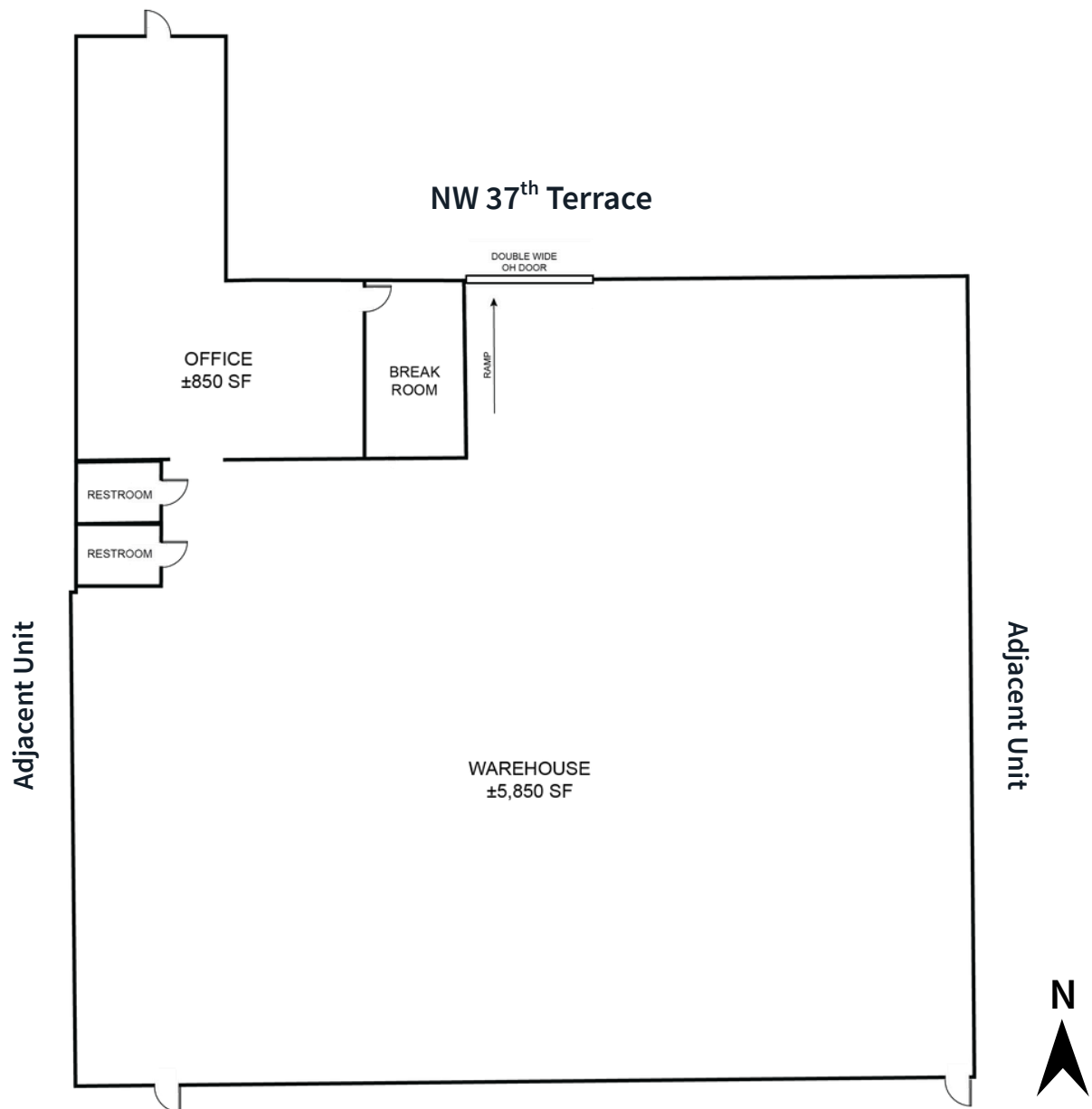

*Not an actual representation. Measurements subject to change

[Office Virtual Tour](#)

[Warehouse Virtual Tour](#)

Audley Bosch

audley.bosch@jll.com
(305) 960 8404

Matt Maciag

matt.maciag@jll.com
(305) 960-8409

