

Available for sublease

~76,700 SF Industrial Facility

**103 Tower Drive
Middletown, NY**



Property Specifications

Total building: ~76,700 sq. ft.

Acreage: 6 acres

Built: 2021

Loading: 13 dock high loading doors

Floor: 7" slab; 4,000psi

Ceiling height: 36' clear

Sprinkler: ESFR system

Sublease thru June 19, 2032

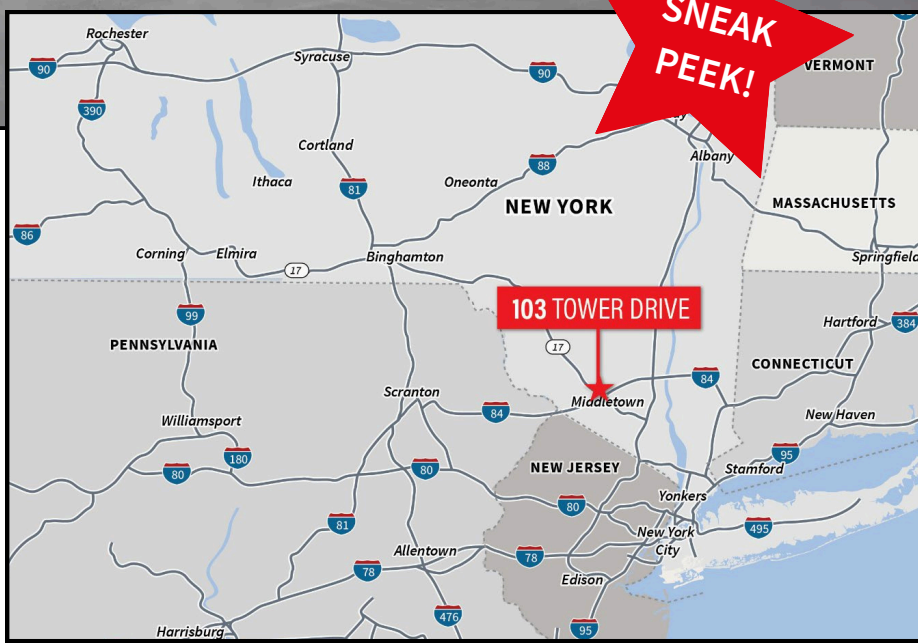

~76,700 SF
Available for sublease

103 Tower Drive
Middletown, NY

Floor plan

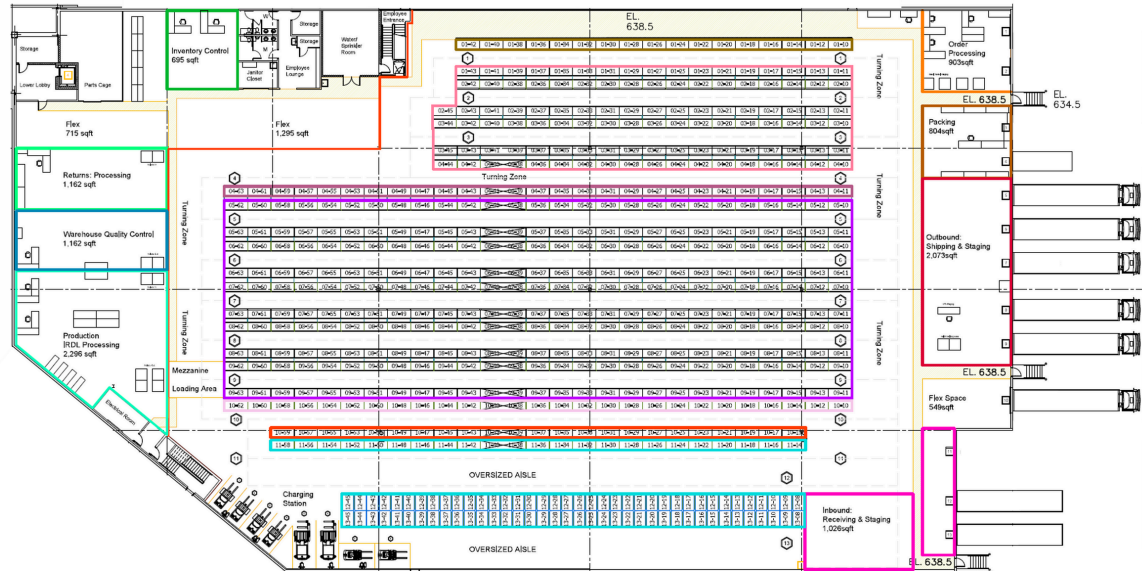

Mezzanine plan

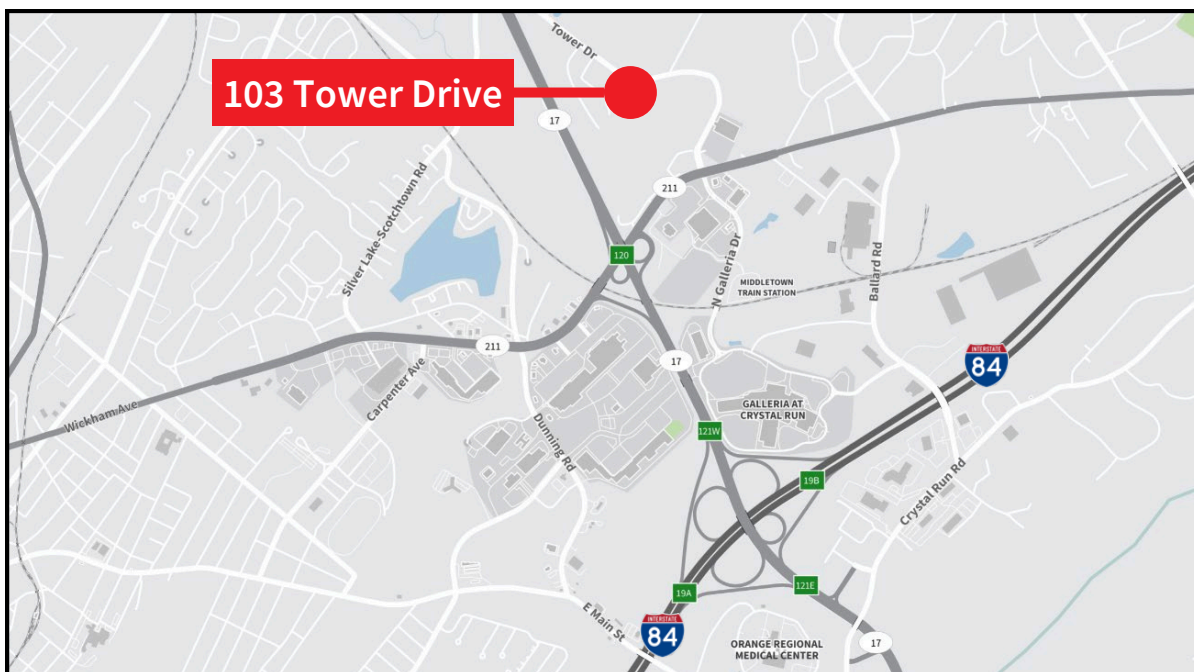
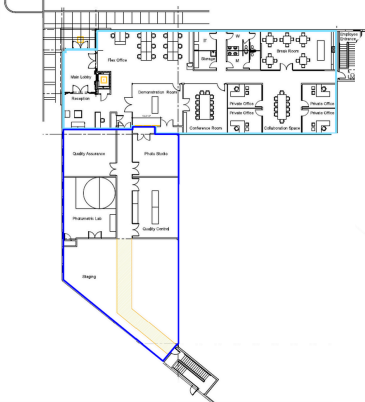

James Panczykowski
Vice Chairman
james.panczykowski@jll.com
+ 1 551 404 8834

William Zachary "Zach" Antonucci
Vice President
zach.antonucci@jll.com
+1 860 817 1402



Jones Lang LaSalle Americas, Inc. License #: CO508577000

Although information has been obtained from sources deemed reliable, neither Owner nor JLL make any guarantees, warranties or representations, express or implied, as to the completeness or accuracy as to the information contained herein. Any projections, opinions, assumptions or estimates used are for examples only. There may be differences between projected and actual results, and those differences may be material. The Property may be withdrawn without notice. Neither Owner nor JLL accepts any liability for any loss or damage suffered by any party resulting from reliance on this information. If the recipient of this information has signed a confidentiality agreement regarding this matter, this information is subject to the terms of that agreement. 2025 Jones Lang LaSalle IP, Inc. All rights reserved.