

DOWNTOWN FORT LAUDERDALE RETAIL/RESTAURANT FOR LEASE AT

**SOCIETY**

*Las Olas*

140 SW 2ND ST | FORT LAUDERDALE, FL 33301





# 3-MILE STATS

153,253

POPULATION

71,518

EST. HOUSEHOLDS

\$124,384

AVERAGE HH

202,369

DAYTIME POPULATION

14,424

BUSINESSES



Although information has been obtained from sources deemed reliable, JLL does not make any guarantees, warranties or representations, express or implied, as to the completeness or accuracy as to the information contained herein. Any projections, opinions, assumptions or estimates used are for example only. There may be differences between projected and actual results, and those differences may be material. JLL does not accept any liability for any loss or damage suffered by any party resulting from reliance on this information. If the recipient of this information has signed a confidentiality agreement with JLL regarding this matter, this information is subject to the terms of that agreement. ©2025. Jones Lang LaSalle Brokerage, Inc. All rights reserved.



# PROPERTY OVERVIEW & FLOOR PLAN

- ±1,600 SF available with grease trap at the base of Society Las Olas
- Society Las Olas retail site resides below 563 brand-new residential units
- Society Las Olas and adjacent Flow include 1,104 residential units and 98 hotel units
- Located in the heart of Downtown Fort Lauderdale in the eclectic and sought-after Las Olas Boulevard neighborhood
- Co-tenants include Pura Vida, Sweat440, The Wharf, UKIAH, Mykonos, Swizzle, Bodega, Sushi Sake, and more
- Delivery Q1 2026
- Landlord open to all uses

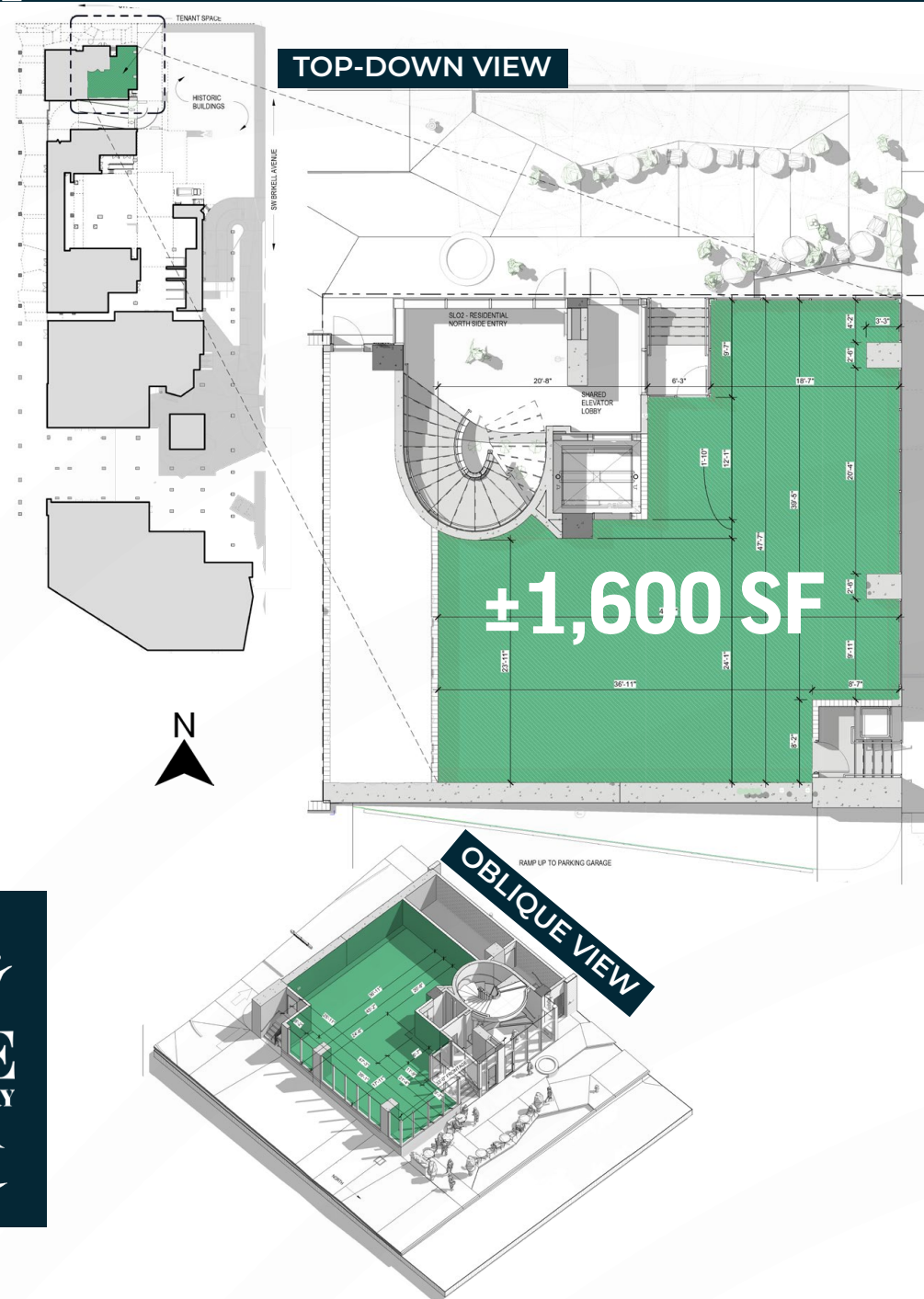



# AREA

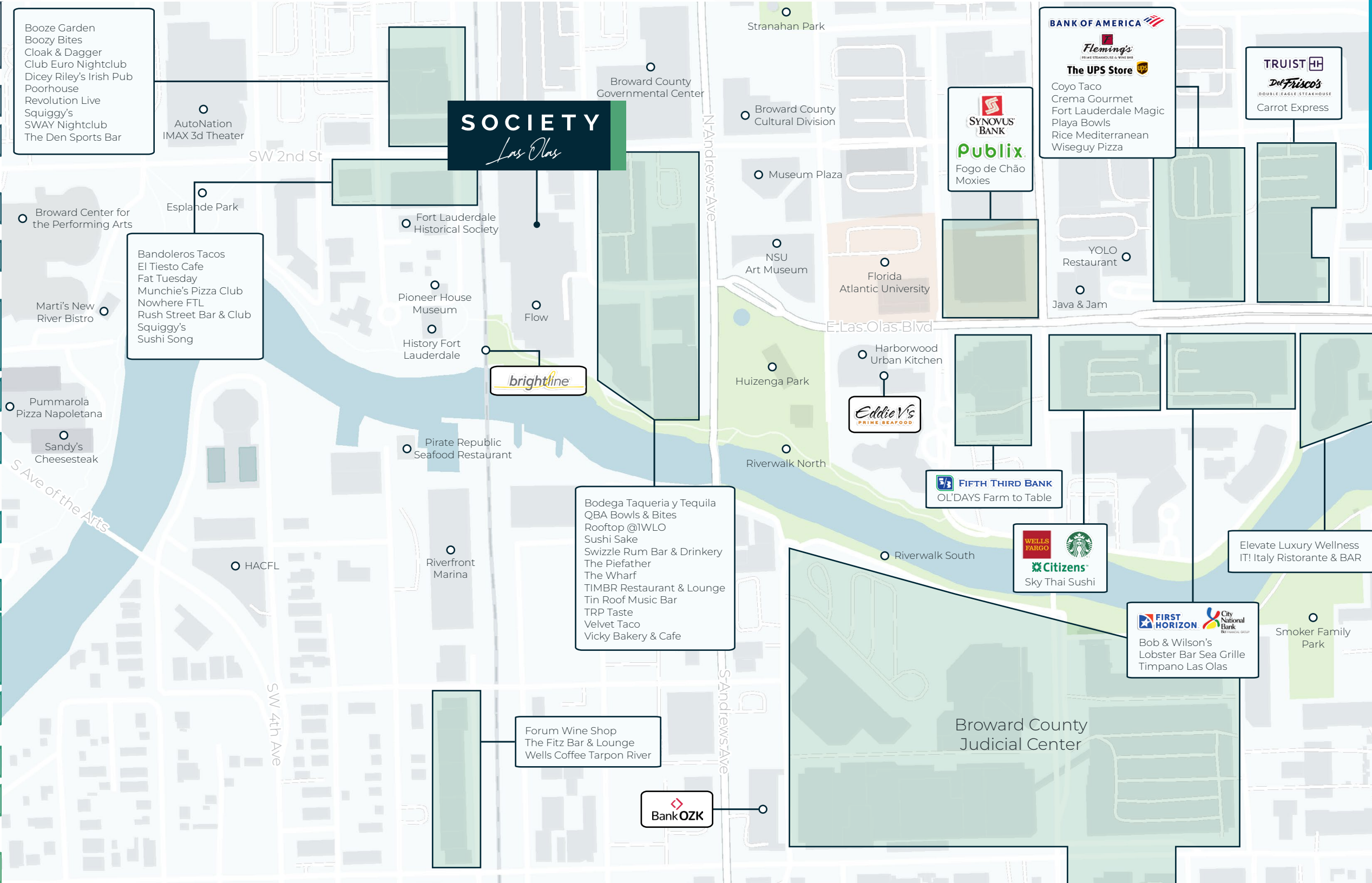



FOR MORE INFORMATION, PLEASE CONTACT:

**JONATHAN ROSEN**  
[jonathan.rosen@jll.com](mailto:jonathan.rosen@jll.com)  
954 729 1074

**SOCIETY**  
*Las Vegas*

