

# 1300

WESTINGHOUSE

GEORGE TOWN, TX 78626



FIRE ZONE TOW / AWAY ZONE OFFICE | WAREHOUSE | SHOWROOM FROM 12,927 - 55,457 SF

## 68,384 SF

Available now for lease





# 1300

## WESTINGHOUSE

The Project is located just off I-35 and along Westinghouse Road. The property's convenient location allows for easy access to both I-35 and 130 Toll Road. 1300 Westinghouse is also minutes away from the Round Rock Outlet Mall, providing a multitude of eating and shopping options for employees.

- 1 University of Texas at Austin**  
20 min | 25 mi
- 2 Downtown Austin**  
30 min | 25 mi
- 3 Tesla Giga Factory**  
35 min | 33 mi
- 4 Austin-Bergstrom International Airport**  
30 min | 30 mi
- 5 Amazon Fulfilment Center**  
10 min | 5 mi
- 6 Downtown Georgetown**  
10 min | 5 mi
- 7 Domain**  
20 min | 16 mi
- 8 Samsung**  
30 min | 18 mi
- 9 Round Rock Outlet Mall**





# THE SITE PLAN

**1300**  
WESTINGHOUSE

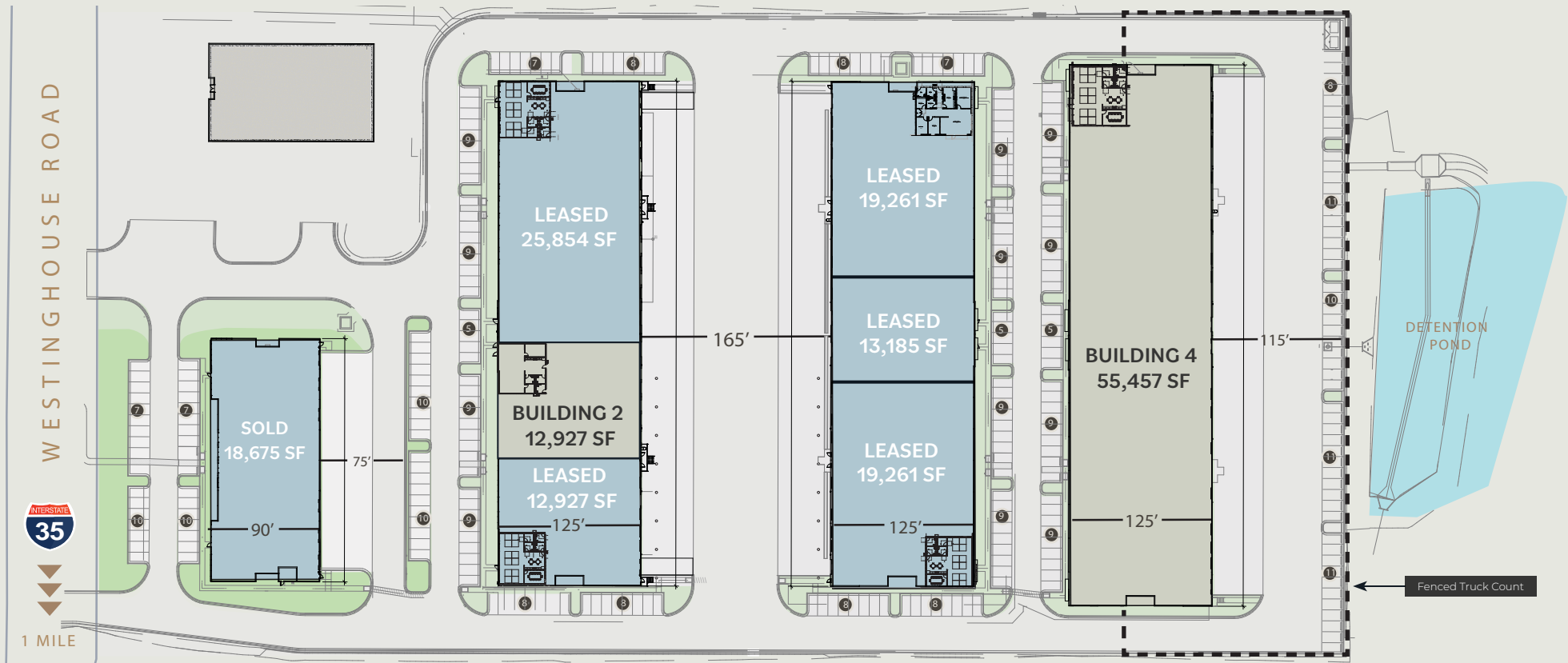

## BUILDING 1 (SOLD)

- 18,675 SF Total
- ESFR Sprinkler
- 6 Grade Level Doors
- 20' Clear Height
- 34 Parking Spaces
- 90' Building Depth
- 1200 Amps of Power

## BUILDING 2

- 51,707 SF Total
- 12,927 SF Remaining
- 1,965 SF Spec Office
- ESFR Sprinklers
- 16 Dock High Doors
- (2) 12'x14' OH Doors w/Ramps
- 28' Clear Height
- 92 Parking Spaces
- 125' Building Depth
- 1200 Amps of Power

## BUILDING 3 (FULLY LEASED)

- 51,707 S F
- ESFR Sprinkler
- 22 Dock High Doors
- (2) 12' x14' OH Doors w/Ramps
- 28' Clear Height
- 72 Parking Spaces
- 125' Building Depth
- 1200 Amps of Power

## BUILDING 4

- 55,457 SF Total
- 2,300 SF Spec Office
- ESFR Sprinkler
- 16 Dock High Doors
- (2) 12'x14' OH Doors w/Ramps
- 28' Clear Height
- 92 Parking Spaces
- 125' Building Depth
- 1200 Amps of Power
- Fenced & Secured Private Truck

## BUILDING TWO

12,927 SF AVAILABLE

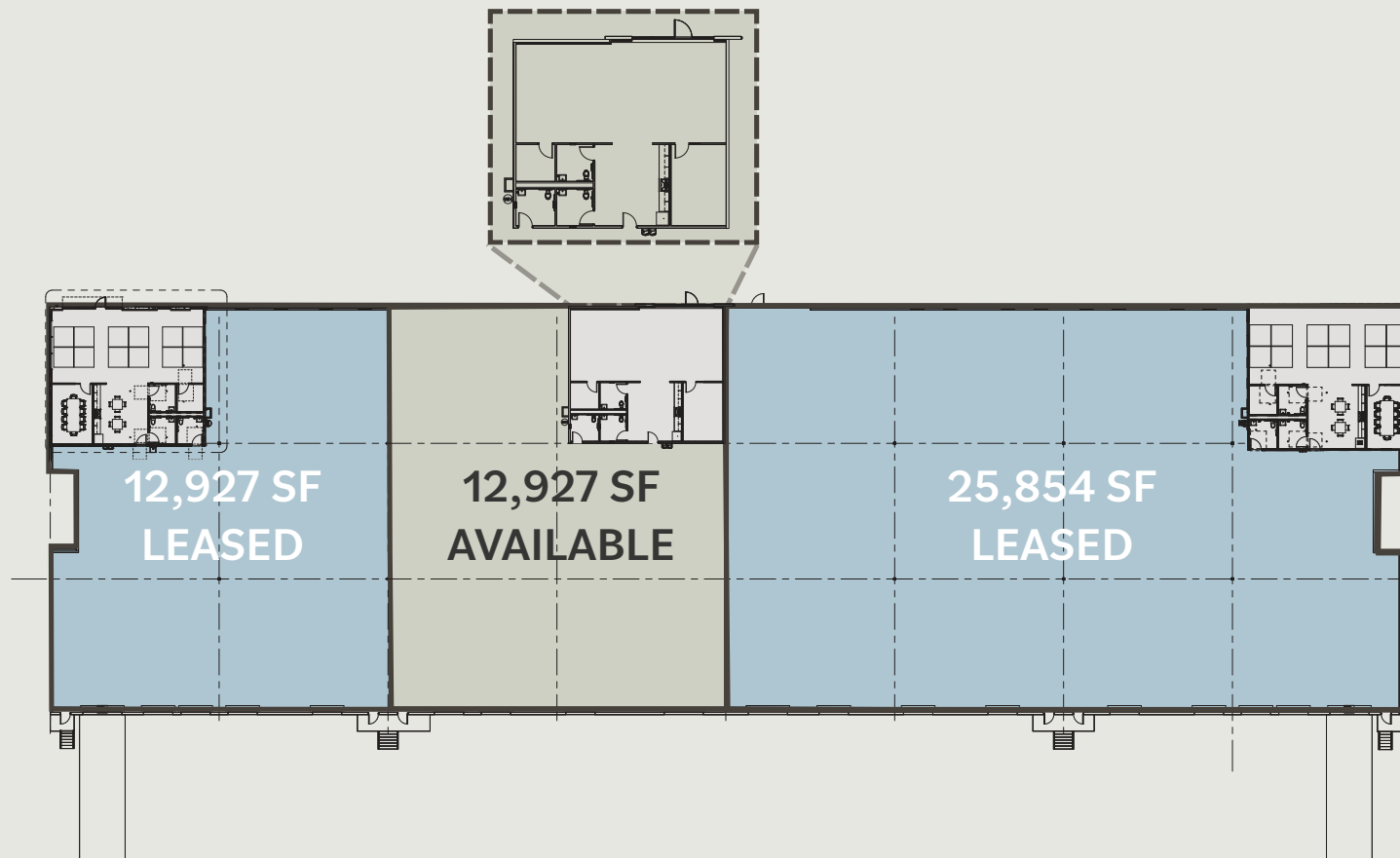
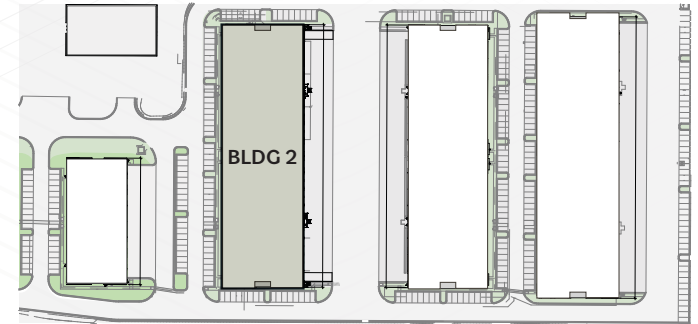

- 12,927 SF Remaining
- 1,965 SF Spec Office
- ESFR Sprinkler
- 4 Dock High Doors

- 28' Clear Height
- 22 Parking Spaces
- 125' Building Depth

# BUILDING FOUR

55,457 SF AVAILABLE

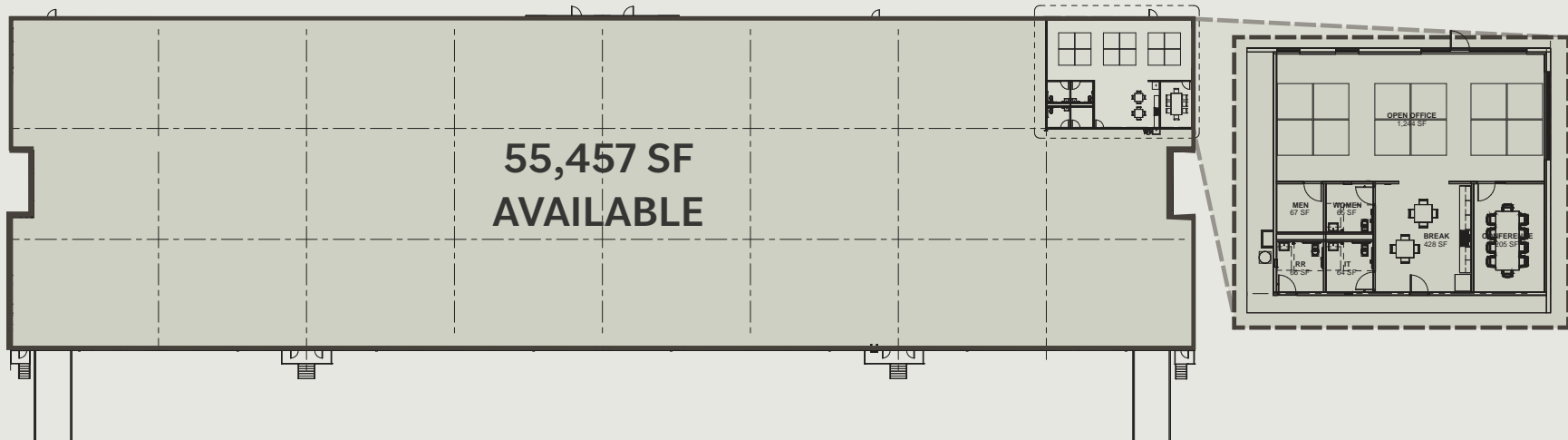
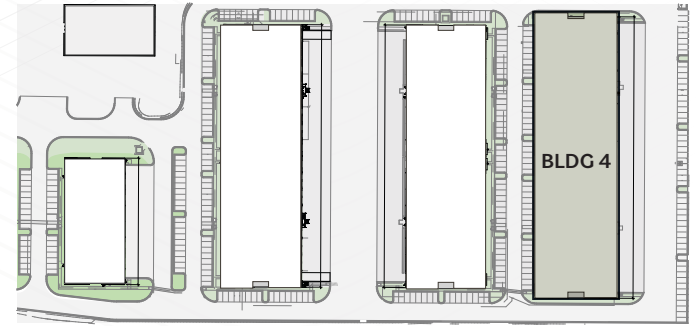

- 55,457 SF
- 2,300 SF Spec Office
- ESFR Sprinkler
- 16 Dock High Doors
- (2) 12'x14' Overhead Doors w/Ramps

- 28' Clear Height
- 92 Parking Spaces
- 125' Building Depth
- 1200 Amps of Power
- Fenced & Secured Private Truck Court







# 1300 WESTINGHOUSE



## FOR MORE INFORMATION, CONTACT

### Travis Secor

+1 512 593 4891

[travis.secor@jll.com](mailto:travis.secor@jll.com)

### Ace Schlameus

+1 512 535 8104

[ace.schlameus@jll.com](mailto:ace.schlameus@jll.com)

### Zane Cole

+1 512 636 1657

[zane.cole@jll.com](mailto:zane.cole@jll.com)

### Kyle McCulloch

+1 512 225 2713

[kyle.mcculloch@jll.com](mailto:kyle.mcculloch@jll.com)

Although information has been obtained from sources deemed reliable, JLL does not make any guarantees, warranties or representations, express or implied, as to the completeness or accuracy as to the information contained herein. Any projections, opinions, assumptions or estimates used are for example only. There may be differences between projected and actual results, and those differences may be material. JLL does not accept any liability for any loss or damage suffered by any party resulting from reliance on this information. If the recipient of this information has signed a confidentiality agreement with JLL regarding this matter, this information is subject to the terms of that agreement. ©2025 Jones Lang LaSalle Brokerage, Inc. All rights reserved.

