



AN HQ OPPORTUNITY WITH  
EXECUTIVE-CLASS FEATURES





# THE BRANNAN EDGE

**274 Brannan** offers high-end, recently improved creative workspace. This exceptional opportunity features a rare  $\pm 42,000$  RSF HQ Opportunity.

*The perfect blend of functionality and inspiration awaits.*

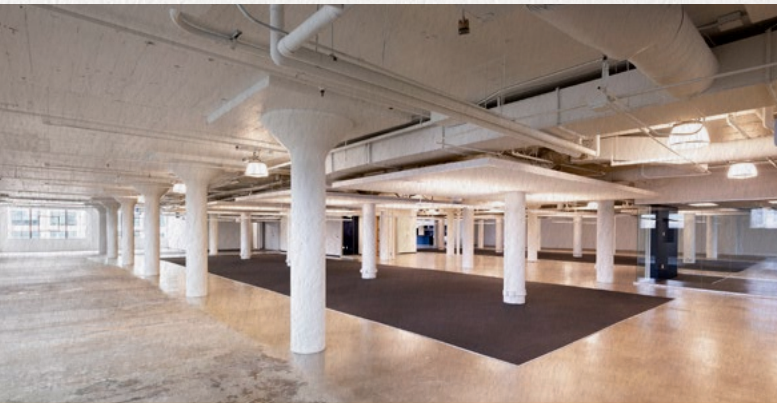

**Efficient Floor Plates**  
 $\pm 21,000$  RSF per floor for optimal layout flexibility



**Stunning Bay Views**  
Potential panoramic views of San Francisco Bay



**Private Rooftop Decks**  
Tenant-exclusive outdoor spaces for collaboration and relaxation



**High-End Finishes**  
Polished concrete floors and open exposed ceilings



**Exceptional Natural Light**  
Abundant natural light throughout



**Recently Improved**  
Updated creative space ready for immediate occupancy



# THE OPPORTUNITY

6th Floor  
21,348 RSF

5th Floor  
21,566 RSF

Total Block  
42,914 RSF







# 5TH FLOOR

 Full floor opportunity

 Creative spec suite

 Open exposed ceilings

 Polished concrete floors

 3 medium conference rooms

 6 small conference rooms

 6 phone rooms

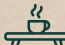
 Open kitchen

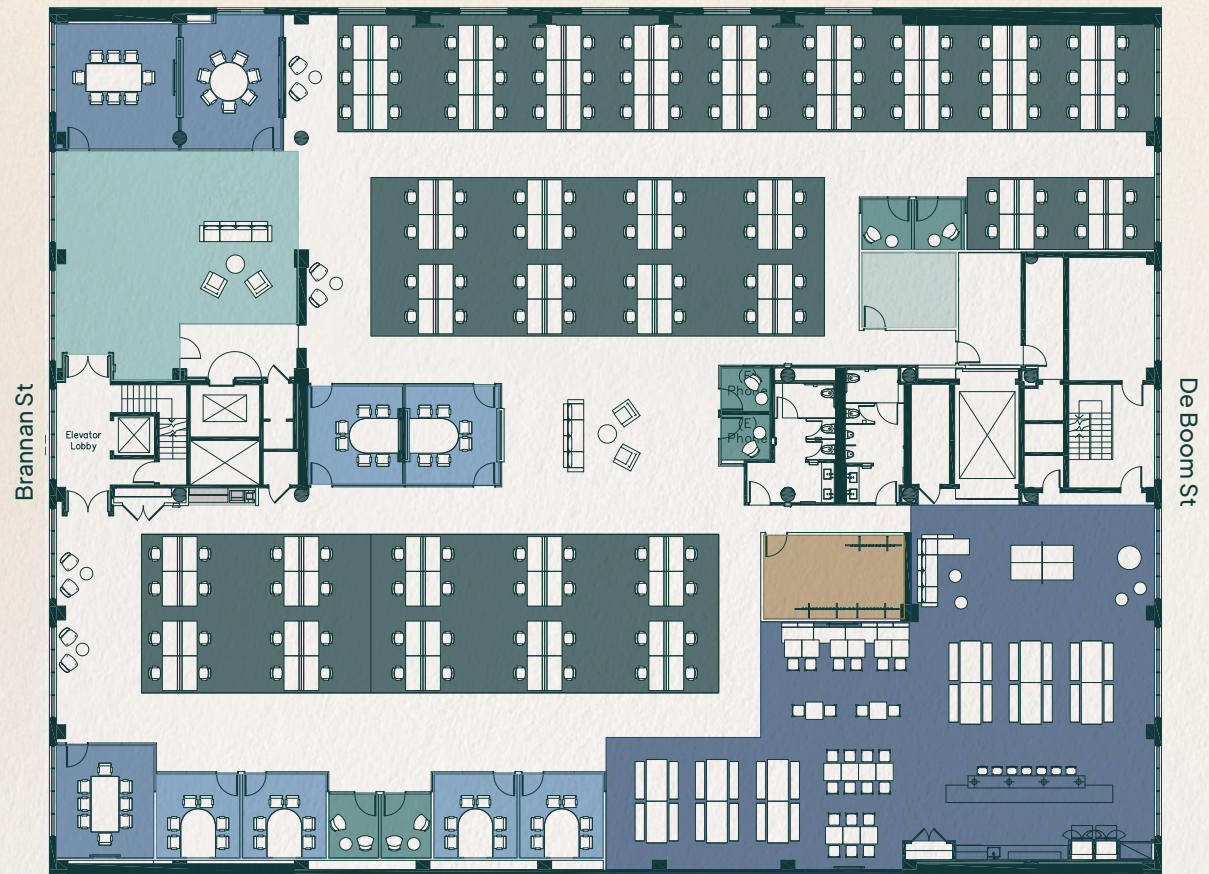

● Break area   
 ● Open office   
 ● Large Conference room   
 ● Medium Conference room   
 ● Small Conference room  
● Copy/Print   
 ● Phone Room   
 ● Reception   
 ● Storage







# 6TH FLOOR

 Full floor opportunity

 Creative spec suite

 Open exposed ceilings

 Polished concrete floors

 2 large & 2 medium conference rooms

 6 small conference rooms

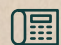
 4 phone rooms

 Open kitchen

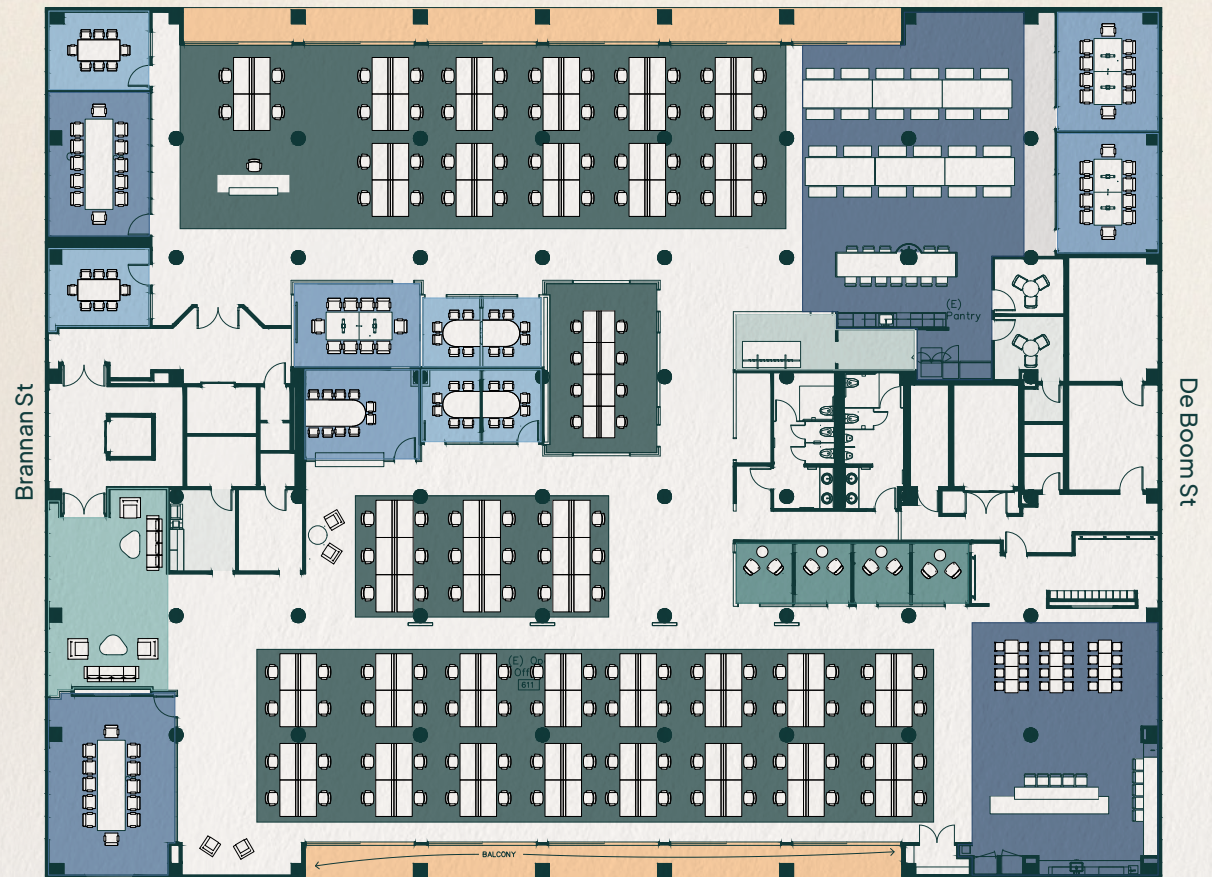
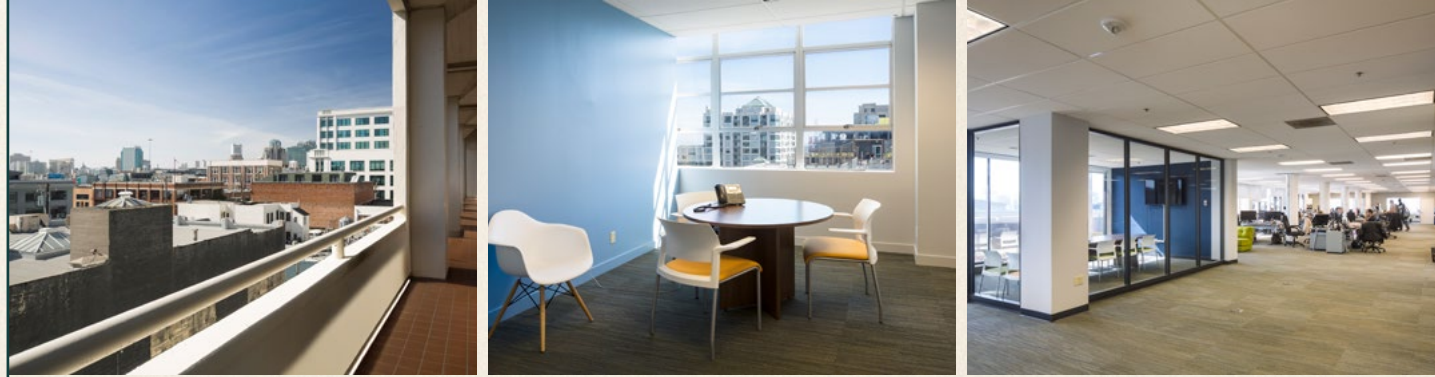

- Break area
- Open office
- Large Conference room
- Medium Conference room
- Small Conference room
- Copy/Print
- Phone Room
- Reception
- Storage
- Roof Decks





# AT YOUR DOORSTEP

**274 Brannan** sits in the heart of San Francisco's Financial District with unmatched access to BART, Muni, major freeways, and the city's top dining and business amenities.



**40+ AMENITIES IN  
A 4 BLOCK RADIUS**

- Service and Shopping
- Restaurants





**Tom Doupe**  
415 395 4933  
tom.doupe@jll.com  
RE Lic #01921218

**John Diepenbrock**  
916 296 7185  
john.diepenbrock@jll.com  
RE Lic. #01911627

**Dan Johnson**  
415 265 5216  
dan.johnson@jll.com  
RE Lic. #01919201

Although information has been obtained from sources deemed reliable, neither Owner nor JLL makes any guarantees, warranties or representations, express or implied, as to the completeness or accuracy as to the information contained herein. Any projections, opinions, assumptions or estimates used are for example only. There may be differences between projected and actual results, and those differences may be material. The Property may be withdrawn without notice. Neither Owner nor JLL accepts any liability for any loss or damage suffered by any party resulting from reliance on this information. If the recipient of this information has signed a confidentiality agreement regarding this matter, this information is subject to the terms of that agreement. ©2025. Jones Lang LaSalle IP, Inc. All rights reserved.