

Cold Storage Facility



 **JLL** SEE A BRIGHTER WAY

For lease

38,434 SF available

Expandable to 57,434 SF

200 Eagle Court, Logan Township, NJ

Location



Corporate neighbors



Site plan

Total building s.f.	38,434 s.f.	Dock doors	10
Potential expansion	19,000 s.f.	Drive-in doors	1
Cooler	23,731 s.f.	Car parking	102
Freezer	5,010 s.f.	Building Dimensions	181' x 199'
Office	6,754 s.f.	Column spacing	50' x 45'
Mezzanine test kitchen & office	2,939 s.f.	Power	1,200-amp, 480/277-volt, 3-phase, 4-wire service
Clear Height	24'		



Site plan - 200 Eagle Court

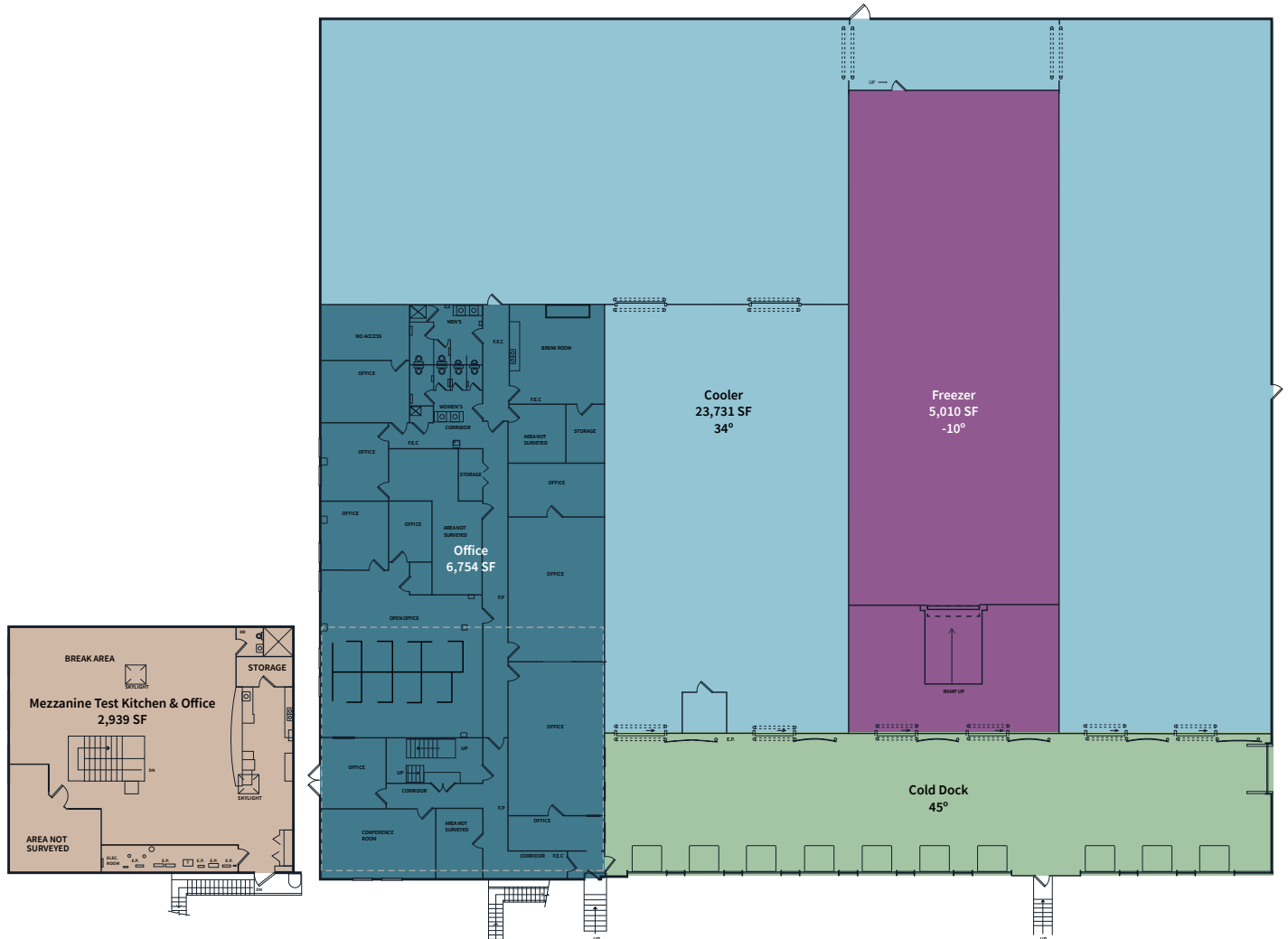

Cooler Photos - 200 Eagle Court



Dock Door & Freezer Photos- 200 Eagle Court



Regional overview

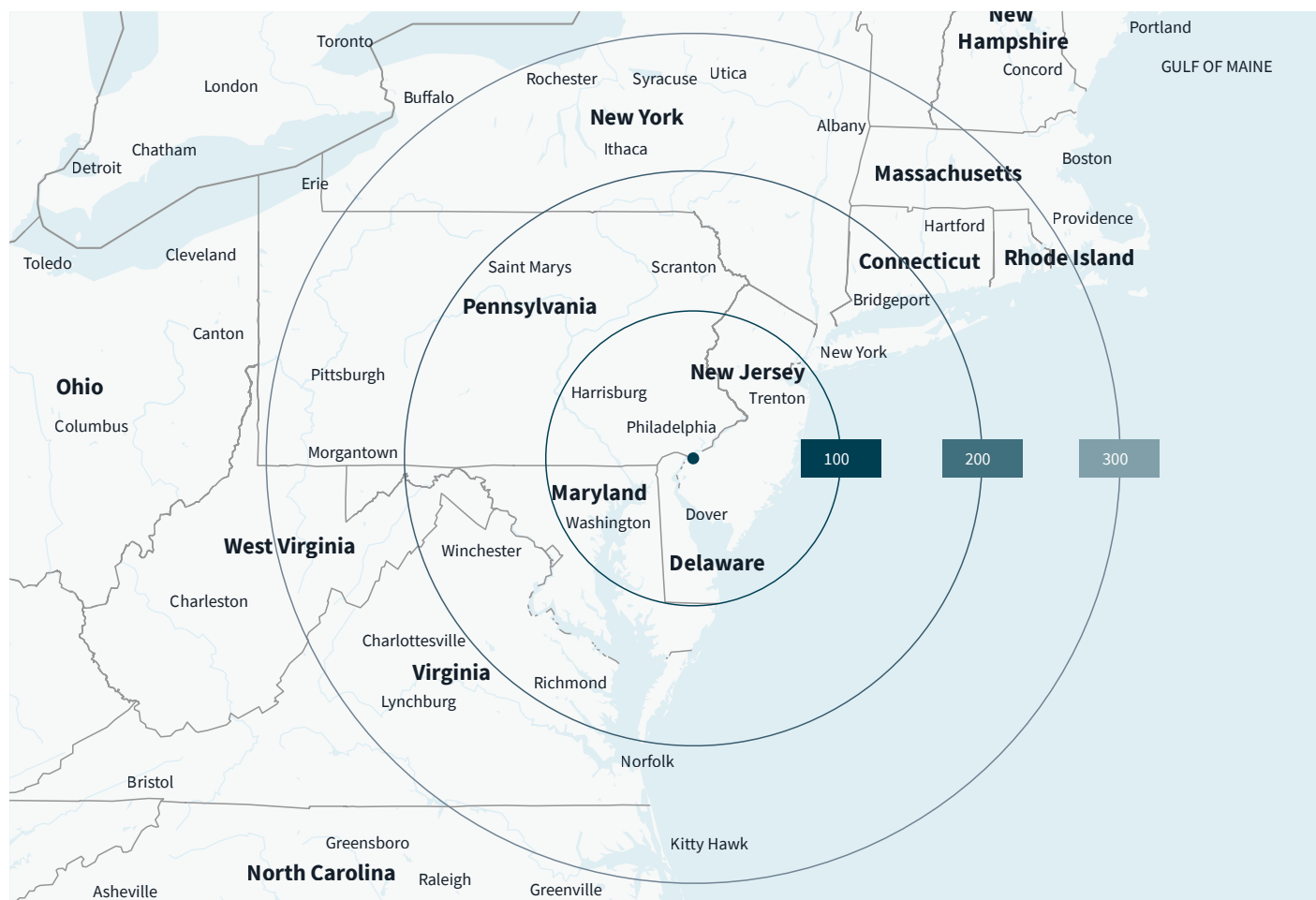

18.4 miles

Wilmington, DE

25.2 miles

Philadelphia, PA

82.5 miles

Baltimore, MD

112 miles

Manhattan, NY

121 miles

Washington D.C.



17.1 miles

Port of Wilmington

27.9 miles

Port of Philadelphia

102 miles

Port of Newark

Dean Torosian

Executive Managing Director

dean.torosian@jll.com

+1 609 472 4953

Jones Lang LaSalle

220 Lake Drive East, Suite 102

Cherry Hill, New Jersey 08002