



# The Mayfair Apartments 5496 S Hyde Park Blvd

2nd Generation Restaurant available for lease  
Hyde Park  
Chicago, IL



## Courtney Rouleau

Vice President

+1 312 228 3431

[courtney.rouleau@jll.com](mailto:courtney.rouleau@jll.com)

## Natalie Belloff

Associate

+1 312 228 2008

[natalie.belloff@jll.com](mailto:natalie.belloff@jll.com)





## Property overview & demographics

- Second generation, endcap location at signalized intersection.
- Take advantage of a fully built out former restaurant space with plenty of window line and frontage on both E 55th & S Hyde Park Blvd.
- Close proximity to regional traffic drivers including The University of Chicago, home to approximately 18,000 students , and The Museum of Science and Industry, spanning over 400,000 SF and attracting over 1.5 Million visitors per year.
- The site neighbors coming soon Obama Presidential Center (2026 opening), the 19-acre campus is estimated to attract over 700,000 annual visitors as a community hub featuring a museum, library, and recreational facilities.
- Utilize steady pedestrian flow with excellent accessibility via nearby Metra rail, CTA Green Line, and multiple bus routes serving the area.



Address	5496 S Hyde Park Blvd Chicago, IL 60615
---------	--

Size	3,368 SF
------	----------

Asking rent	Upon request
-------------	--------------

Status	Available
--------	-----------

Possession	Immediate
------------	-----------

### Area retailers

ASCIONE  
BISTRO

STRETCHLAB



MORRY'S  
Deli



	1 mile	3 miles	5 miles
Population	37,266	191,883	470,816
Daytime population	41,407	180,574	422,463
Avg household income	\$108,145	\$73,038	\$74,065
Households	19,489	91,869	207,930

## Trade area



# Hyde Park

Lease outline drawing

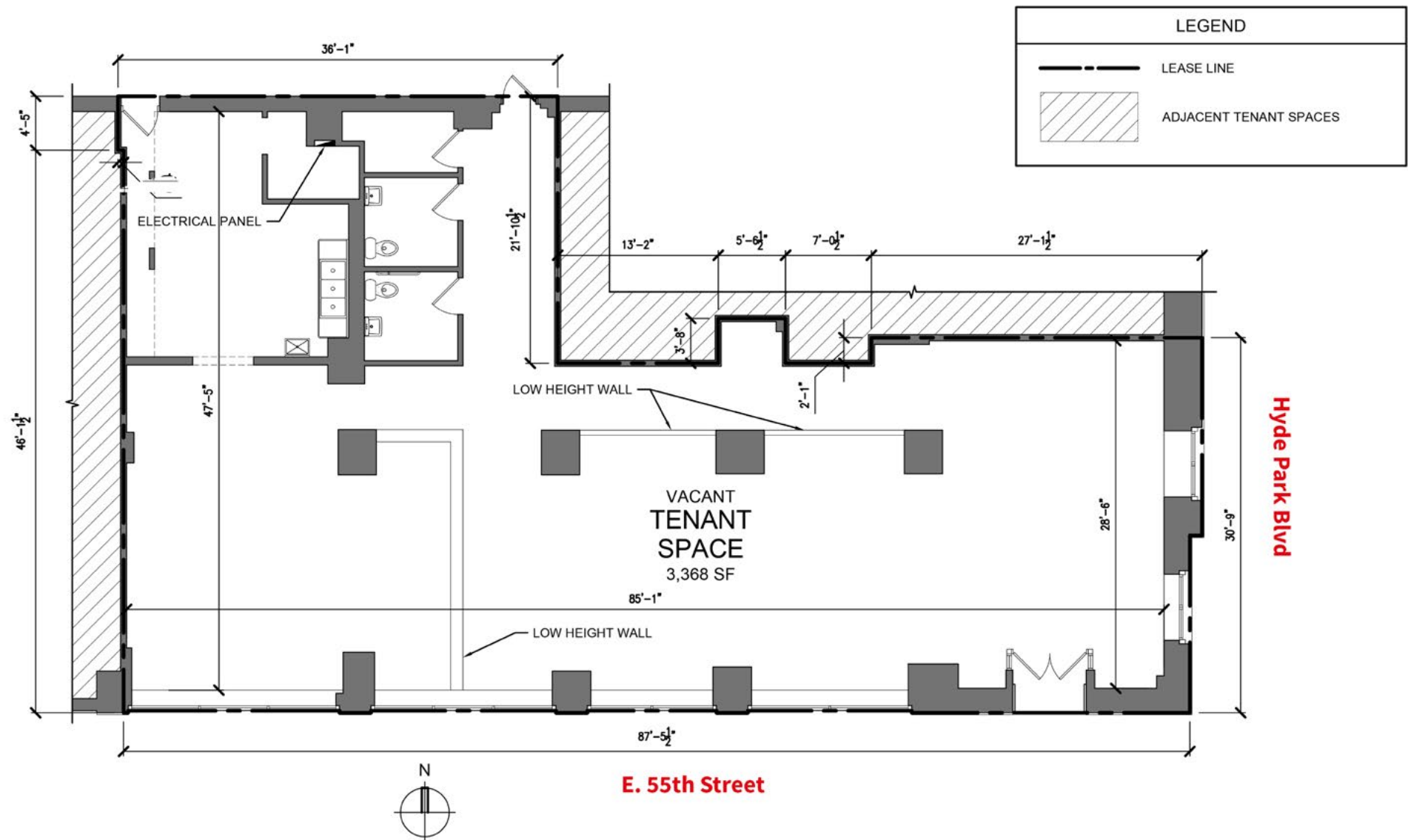

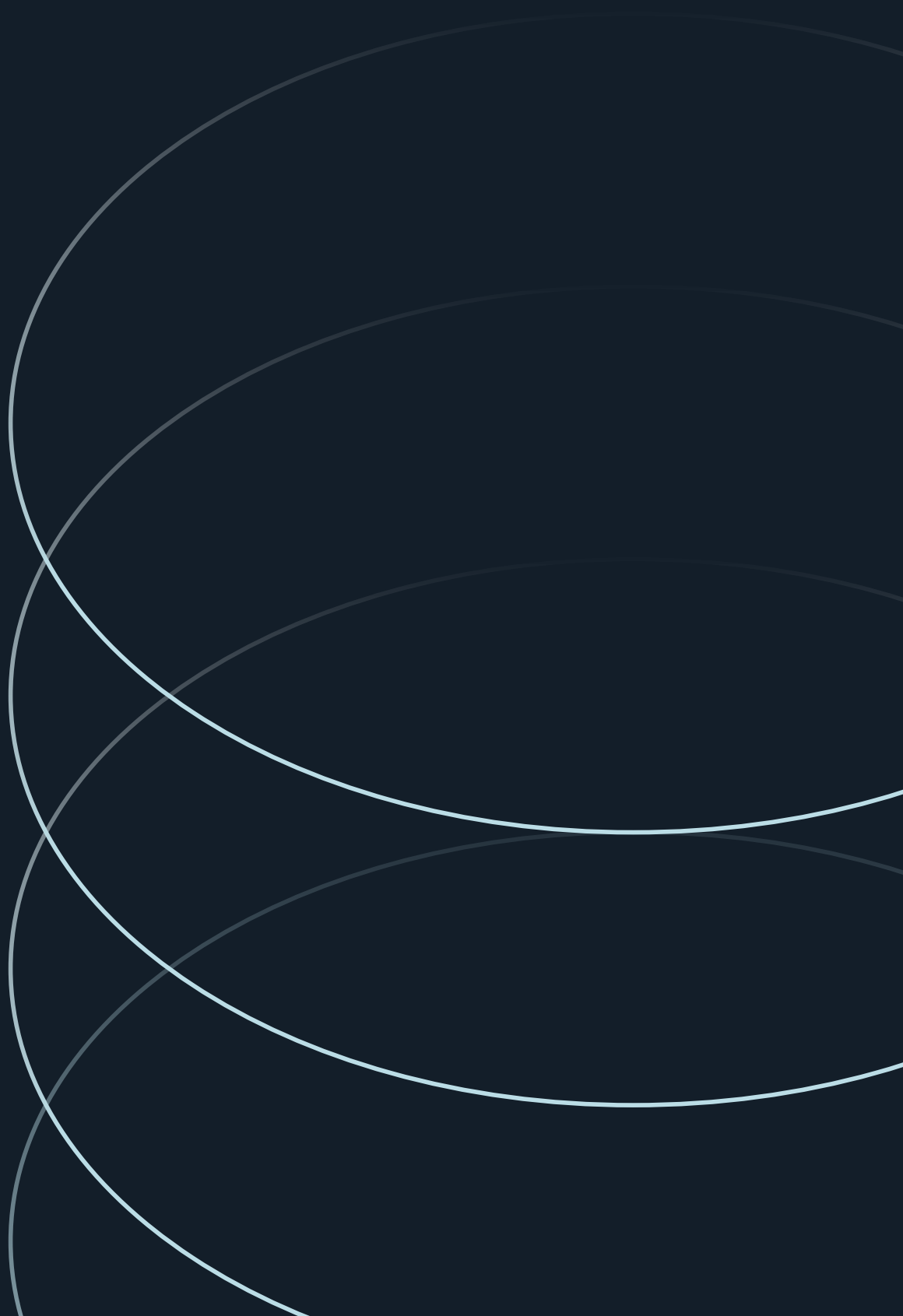

**Courtney Rouleau**

Vice President

+1 312 228 3431

[courtney.rouleau@jll.com](mailto:courtney.rouleau@jll.com)

**Natalie Belloff**

Associate

+1 312 228 2008

[natalie.belloff@jll.com](mailto:natalie.belloff@jll.com)