

For Sublease

2,520 SF Available

1825 Summit Ave. Suite 204

Plano, TX 75074



1825 Summit Ave. Suite 204, Dallas, TX 75074

Property Specifications

- 2,520 Total SF
- 800 SF Office
- 1,720 SF Warehouse
- 16'-18' Clear Height
- One (1) Grade Level Door
- Sublease Through 1/30/2029

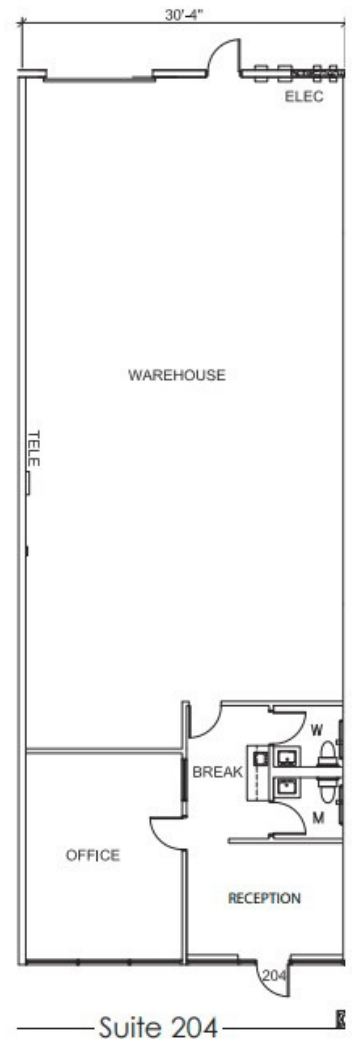
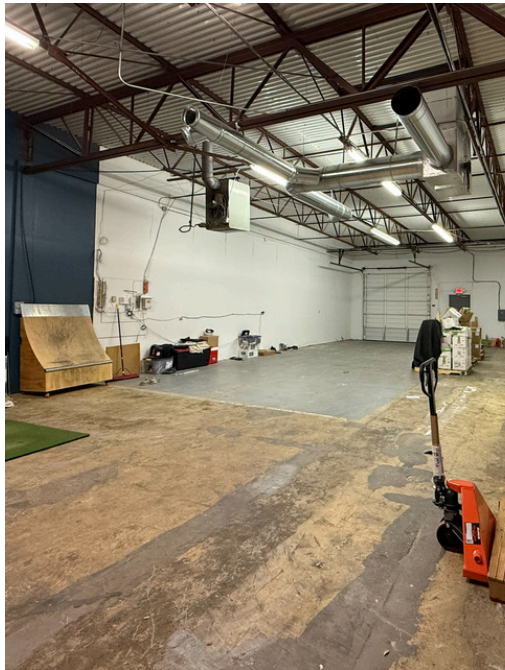

Parker Grona

Parker.Grona@jll.com

[\(817\) 739.6910](tel:(817)739.6910)

Jones Lang LaSalle Brokerage, Inc.

Although information has been obtained from sources deemed reliable, neither Owner nor JLL makes any guarantees, warranties or representations, express or implied, as to the completeness or accuracy as to the information contained herein. Any projections, opinions, assumptions or estimates used are for example only. There may be differences between projected and actual results, and those differences may be material. The Property may be withdrawn without notice. Neither Owner nor JLL accepts any liability for any loss or damage suffered by any party resulting from reliance on this information. If the recipient of this information has signed a confidentiality agreement regarding this matter, this information is subject to the terms of that agreement. ©2023 Jones Lang LaSalle IP, Inc. All rights reserved.