



1,841 SF for Sublease

Old Mill Business Center II

6415 S 3000 E

Salt Lake City, UT 84121

6415 S 3000 E
Salt Lake City, UT 84121

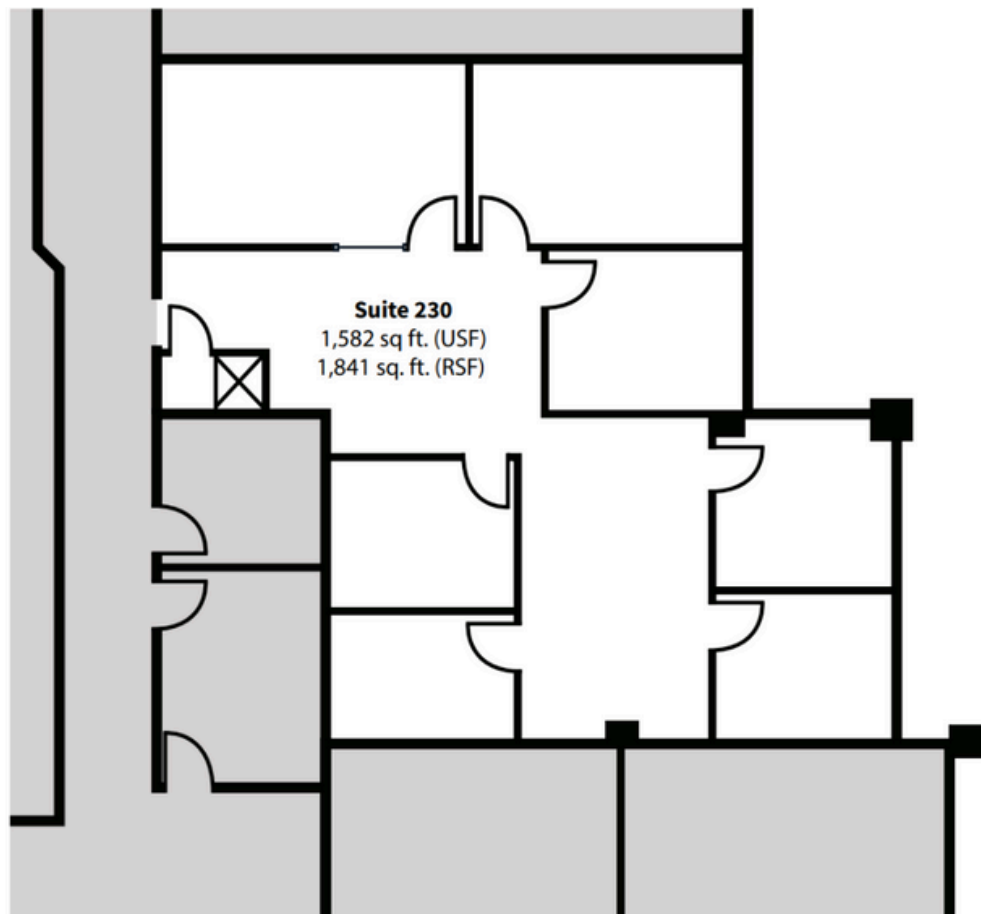

1,841
Available RSF



12/31/26
Sublease expiration



\$18.00/FSG
Sublease rate / SF

Building highlights

- Recently remodeled common area
- Highly desirable Cottonwood location
- Walking distance to restaurants, coffee shops and hotels





Contact Us

Jones Lang LaSalle Brokerage, Inc.

Jami Marsh

Executive Vice President

+1 801 699 3490

jami.marsh@jll.com

Laura Dehtear

Associate

+1 801 921 3467

laura.dehtear@jll.com