

For Sublease

20,682 SF Available

2901 Technology Dr. | Plano, TX 75074



JLL Contacts

Brandon Brower

281 685.2511

brandon.brower@jll.com

Graham Cash

310 525.8320

graham.cash@jll.com

Property Specifications

- Building Size: 72,133 SF
- Availability: 20,682 SF
- 3,225 SF Office
- 20' Clear Height
- Five (5) Dock High Doors
- Sublease Expiration: 6/30/2028
- One (1) Ramped Drive-In
- Wet Sprinkler System
- 1.25/1,000 SF Parking Ratio
- Light Industrial Zoning
- Racking is negotiable

Site Plan

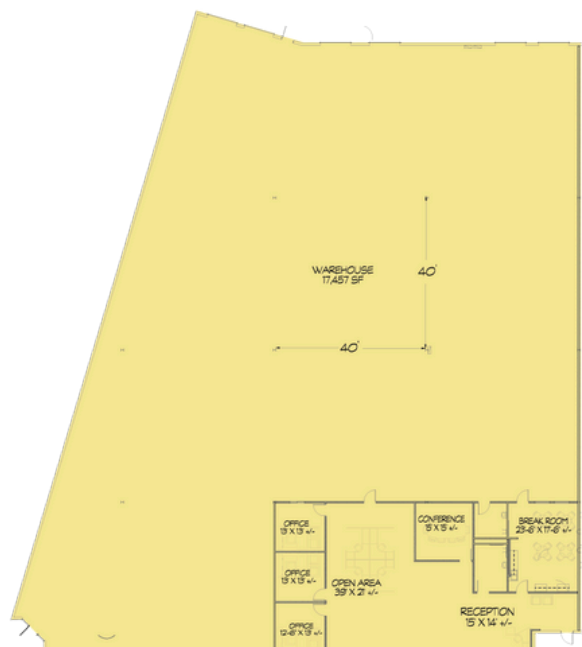
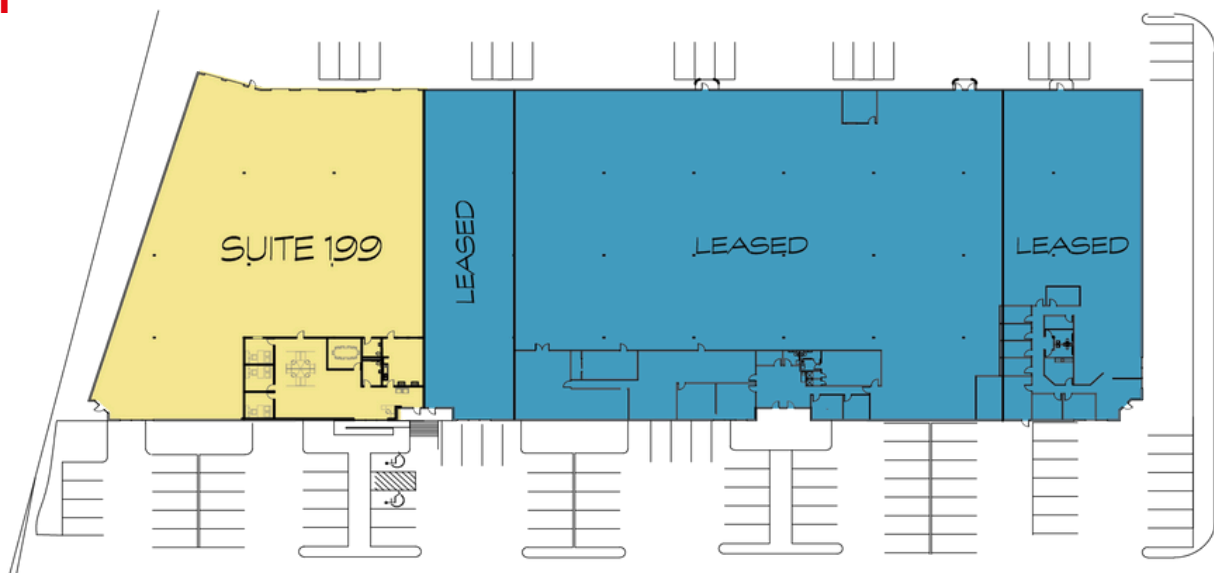

Site photos

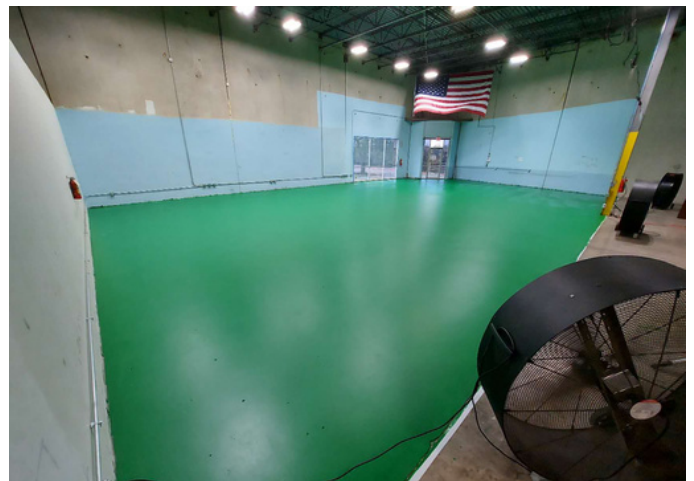
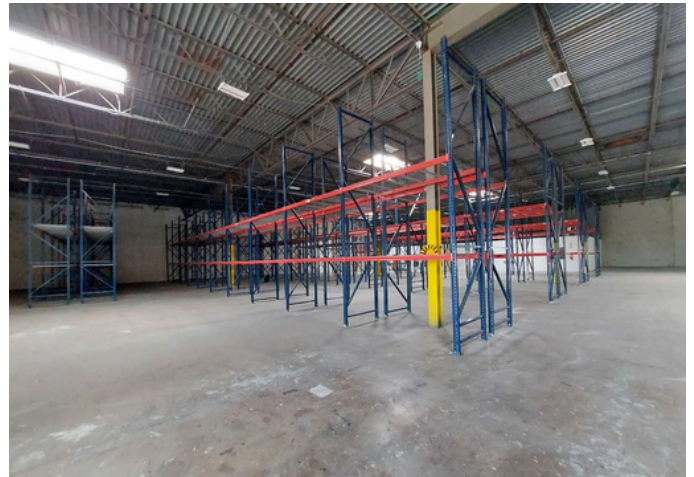

Convenient access to President George Bush
Turpike (1 mile) and US-75 (2 miles)

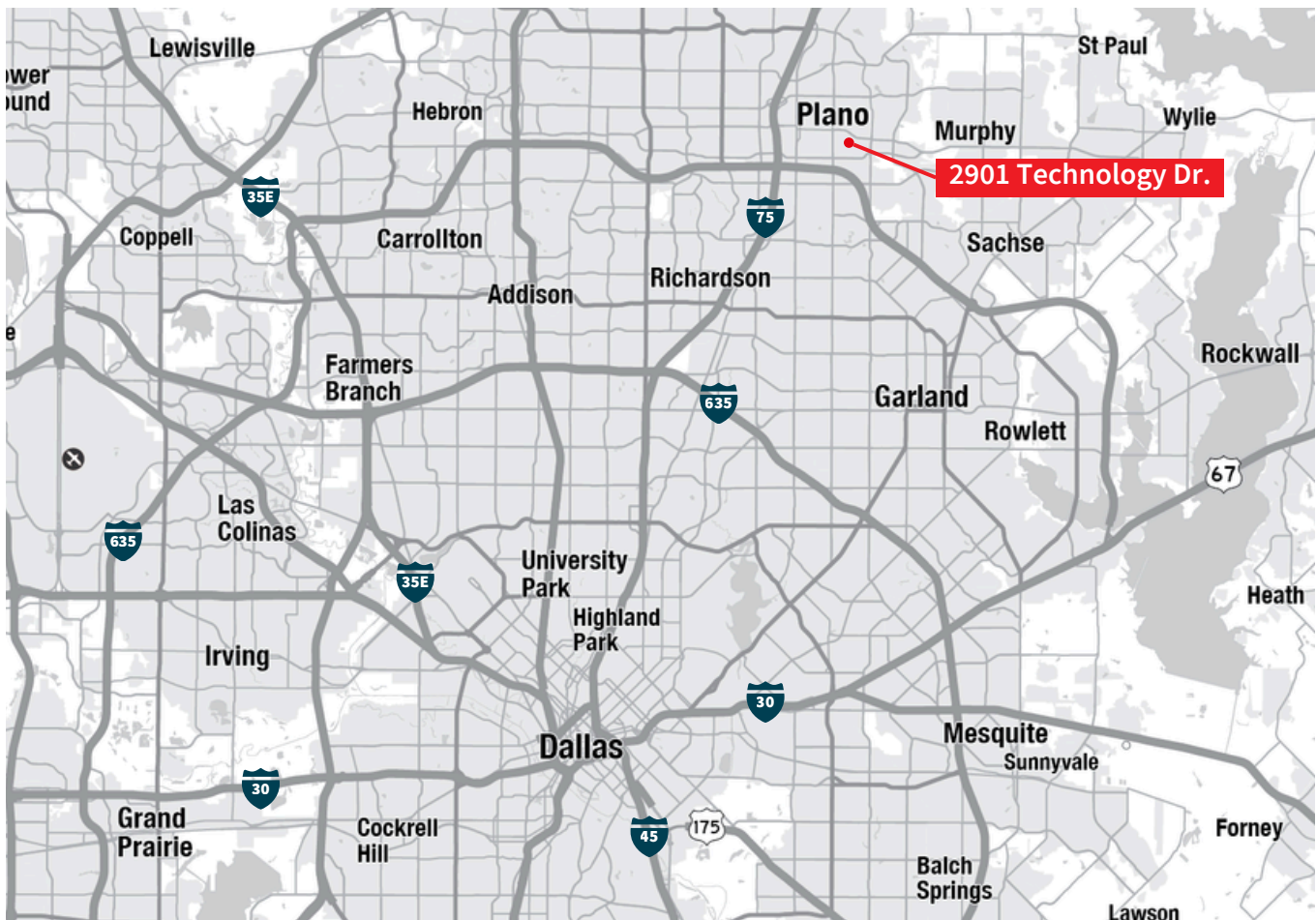

JLL Contacts

Brandon Brower

281.685.2511

brandon.brower@jll.com

Graham Cash

310.525.8320

graham.cash@jll.com

Although information has been obtained from sources deemed reliable, neither Owner nor JLL makes any guarantees, warranties or representations, express or implied, as to the completeness or accuracy as to the information contained herein. Any projections, opinions, assumptions or estimates used are for example only. There may be differences between projected and actual results, and those differences may be material. The Property may be withdrawn without notice. Neither Owner nor JLL accepts any liability for any loss or damage suffered by any party resulting from reliance on this information. If the recipient of this information has signed a confidentiality agreement regarding this matter, this information is subject to the terms of that agreement. ©2023 Jones Lang LaSalle IP, Inc. All rights reserved.