

FOR SALE OR LEASE

861 SLOAN AVENUE
HAMILTON TOWNSHIP, NJ

138,851 SF
Divisible to 59,508 SF



Lincoln

www.861Sloan.com



GARY POLITI

Executive Managing Director
908 391 9059
gary.politi@jll.com

MICHAEL VIERA

Senior Associate
848 327 0082
michael.viera@jll.com

JOHN BUCKLEY

Senior Managing Director
908 601 3261
john.buckley@jll.com

861SLOAN.COM

SPECIFICATIONS

TOTAL AVAILABLE: 138,851 SF
(divisible to 59,508 SF)

AVAILABILITY: Immediate

OFFICES: 2,250 SF new spec office

CLEAR HEIGHT: 36'

LOADING: 13 loading docks with
levelers - expandable to 18

COLUMN SPACING: 60'w x 52'd
(wider than 90+% of competitors)

SPEED BAY: Massive **105'** deep speed bay
(enhanced safety and productivity)

POWER: 1,200 amp, 277/480 volt, 3 phase,
4 wire

CAR PARKING: 120 spaces

TRAILER PARKING: 9 stalls - additional room
in truck court

TAXES: \$1.30 PSF

OPEX ±40% BELOW AVG OF COMPETING PROPERTIES



RECENT PROPERTY UPGRADES

- Asphalt
- Warehouse roof
- Docks with levelers
- Electric system
- ESFR sprinkler system
- LED lighting
- Exterior paint
- Spec office

SITE PLANS

Total Building Plan

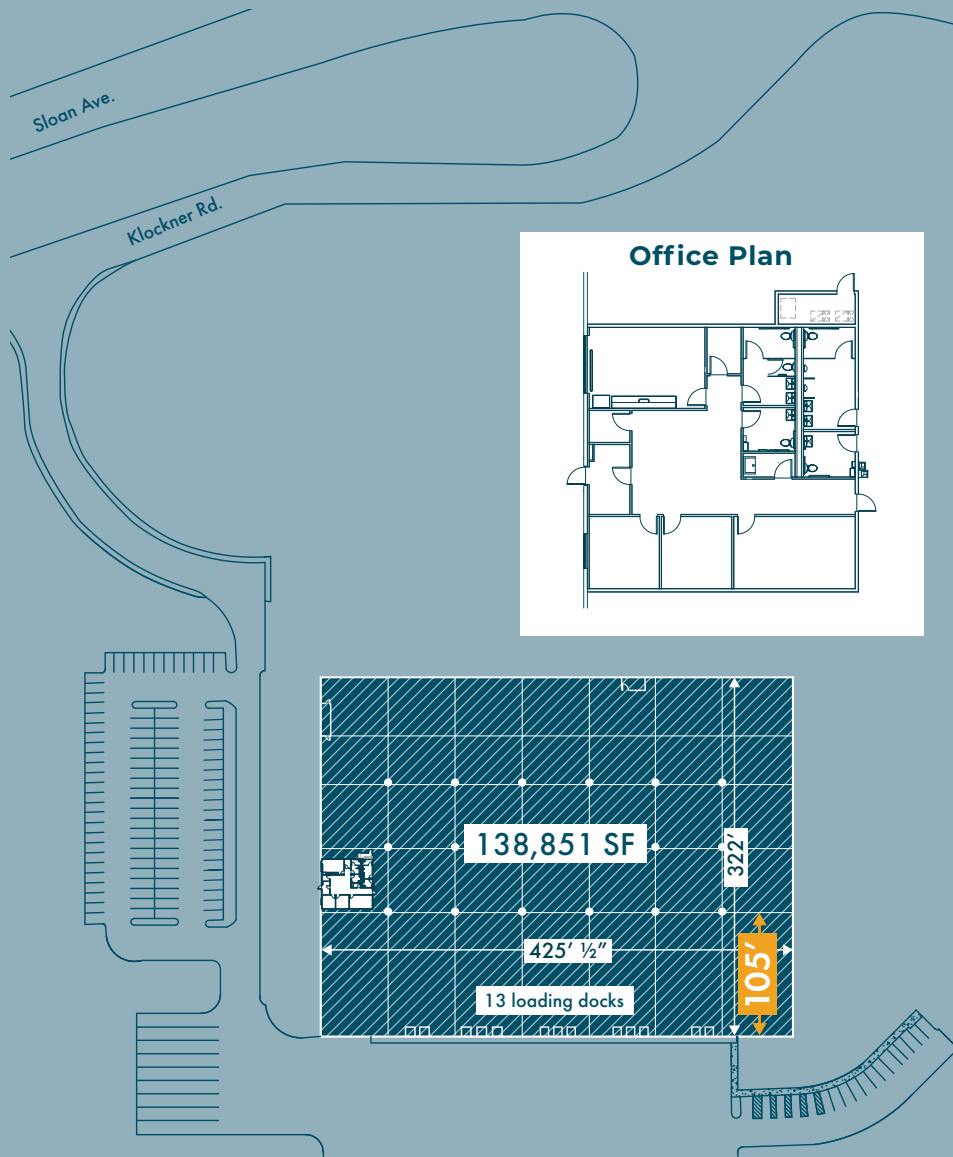

Building Demise Plan



LOCATION

KEY DISTANCES



HAMILTON TRAIN STATION 0.4 miles



INTERSTATE 295 0.6 miles



ROUTE 1 1.5 miles



INTERSTATE 195 5.8 miles



NJ TURNPIKE

EXIT 7A 11 miles

EXIT 8 13 miles

EXIT 8A 16 miles



PORT OF PHILADELPHIA 33.8 miles



NEWARK LIBERTY INTERNATIONAL AIRPORT 55.7 miles



PORT OF NEWARK/ELIZABETH 60.9 miles

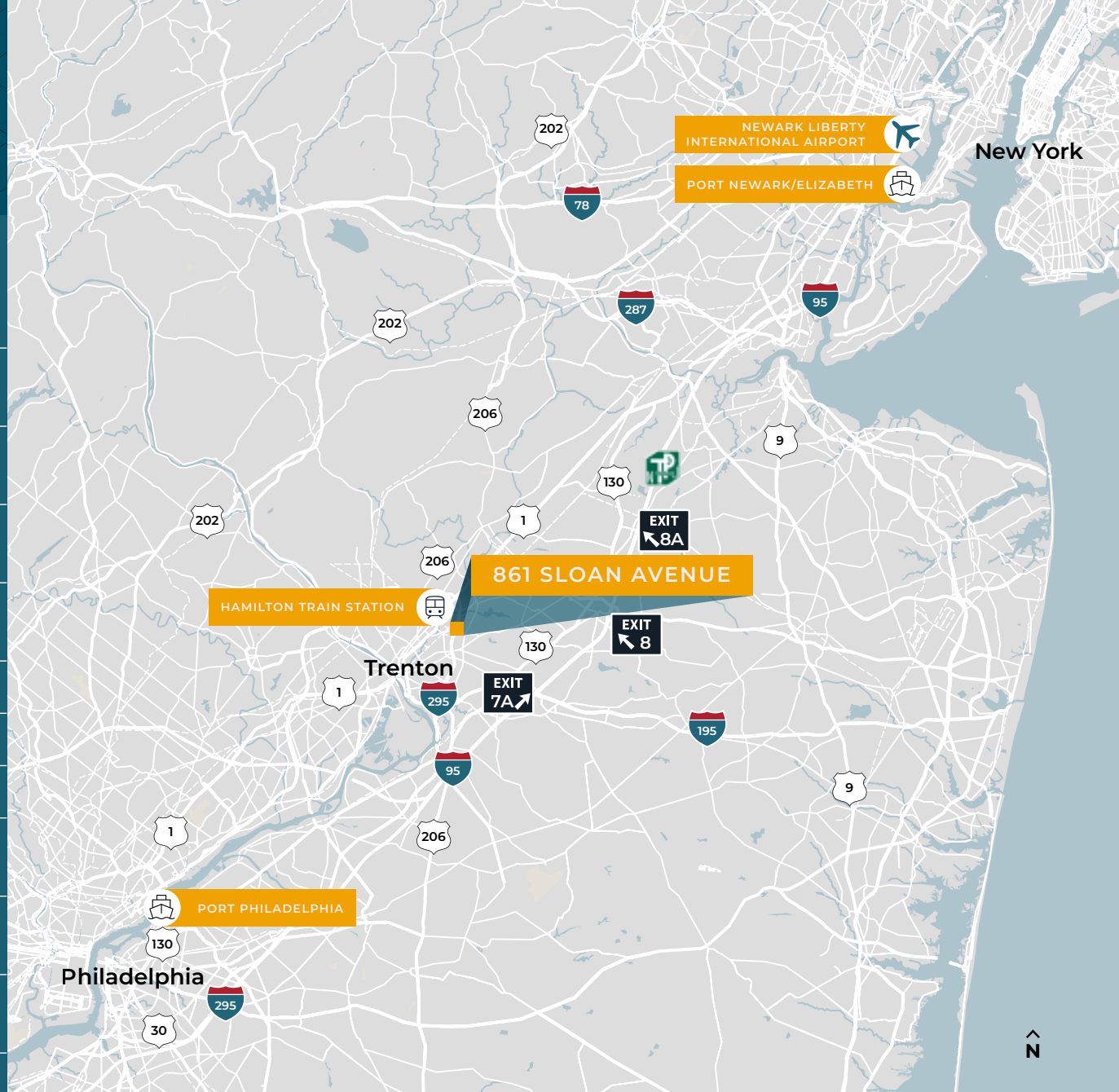

Although information has been obtained from sources deemed reliable, JLL does not make any guarantees, warranties or representations, express or implied, as to the completeness or accuracy as to the information contained herein. Any projections, opinions, assumptions or estimates used are for example only. There may be differences between projected and actual results, and those differences may be material. JLL does not accept any liability for any loss or damage suffered by any party resulting from reliance on this information. If the recipient of this information has signed a confidentiality agreement with JLL regarding this matter, this information is subject to the terms of that agreement. ©2025 Jones Lang LaSalle Brokerage, Inc. All rights reserved.



Lincoln

[861SLOAN.COM](https://www.861SLOAN.COM)