



# PARMER 7.3

HIGH BAY FLEX/OFFICE

28,500 SF Available



# Welcome to the Parmer Campus

A flexible campus with opportunities to grow in a well-supported environment with a long-term owner and operator, Alexandria Real Estate Equities, Inc.



**1.16M**  
RSF

**8**  
BUILDINGS

**20 mins**  
TO DOWNTOWN

- ▶ Ideally situated in the heart of Northeast Austin
- ▶ Class A, newly constructed, multi-tenant campus
- ▶ Convenient access to all of Austin's major arterials
- ▶ Owned and operated in-house by the most trusted and largest dedicated R&D landlord in the country

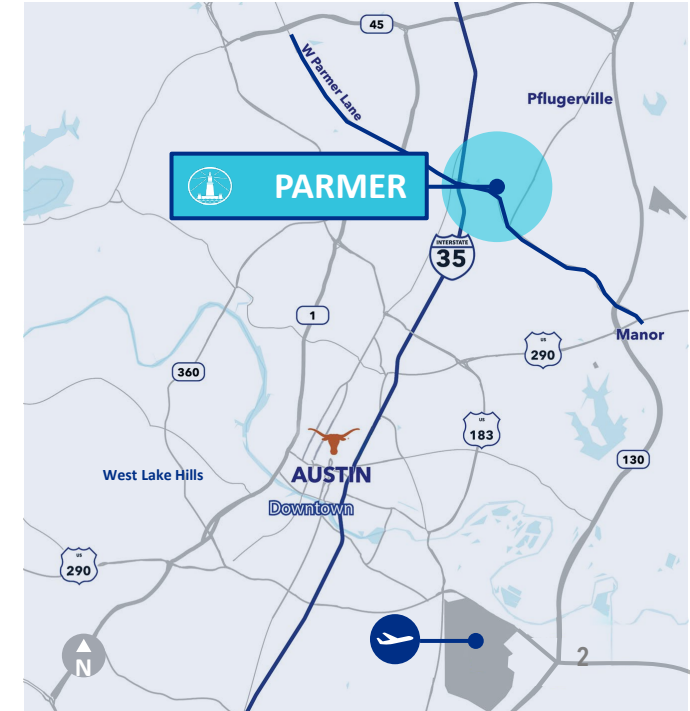



# Northeast Austin's Premier Destination for Innovation

## Availability

### Parmer 3.4

115,000 RSF  
Available  
Now

### Parmer 7.3

28,468 RSF  
Available  
Now

## Neighboring Tenants



BAE SYSTEMS

Cognizant

DELL Technologies



Infosys

natera

Qualcomm



SAMSUNG

TEXAS  
The University of Texas at Austin  
Impact Labs





# Campus Amenities



Ability to scale and grow



24/7 security monitoring



Onsite in-house asset management team



Open Preserve 5-mile walk/bike trail



20-person conference room

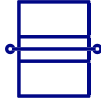

Sand Volleyball/ Pickleball Courts

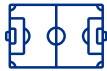

Soccer Fields



# PopStroke

**PopStroke combines an elevated mini-golf course experience with a full-service bar and restaurant. They bring a new spin to mini-golf where they swapped windmills and waterfalls with next-generation technology and custom-designed courses.**

**2019**

Opened First  
Location

**13**

Locations in  
the US

**7**

Additional venues  
Underway

- ▶ PopStroke opened to the public in September 2025 and will operate The Pitch.
- ▶ Two 18-hole putting courses with jumbotrons and TVs throughout and a full service restaurant, BarTenders Eatery.
- ▶ Co-owned by Tiger Woods, alongside Greg Bartoli and TaylorMade Golf Company





# Parmer 7.3

507 E HOWARD LN, BUILDING 3





# Parmer 7.3

28,468 RSF

- **Timing:** Immediate
- **Condition:** High-bay Office
- **Building Size:** 131,425 RSF
- **Floor to Floor:** 28'
- **Parking Ratio:** 4.0:1,000 RSF
- **Built:** 2019
- **Floors:** 1

## Features

- Flex, industrial, lab & data center capable
- 100% HVAC
- Existing dock high truck loading (three 9' docks and one 12' dock)
- Slab-on-grade loading: 3500 (PSI)
- Power: 4000 amps (upgraded to 8000 amps by 1Q26)
- Column spacing: 40'
- Professionally managed in-house by Alexandria Real Estate Equities, Inc.



# Parmer 7.3

FLOOR PLAN

28,468 RSF

- Conference/Meeting/Huddle
- Private Office
- Utilities/IDF/Storage/Print

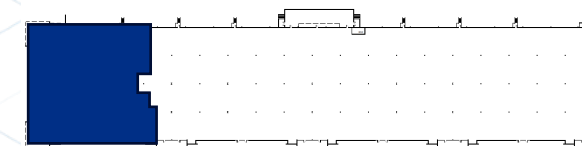

Open Office



Huddle Room



# Parmer 7.3

## SUITE PLAN

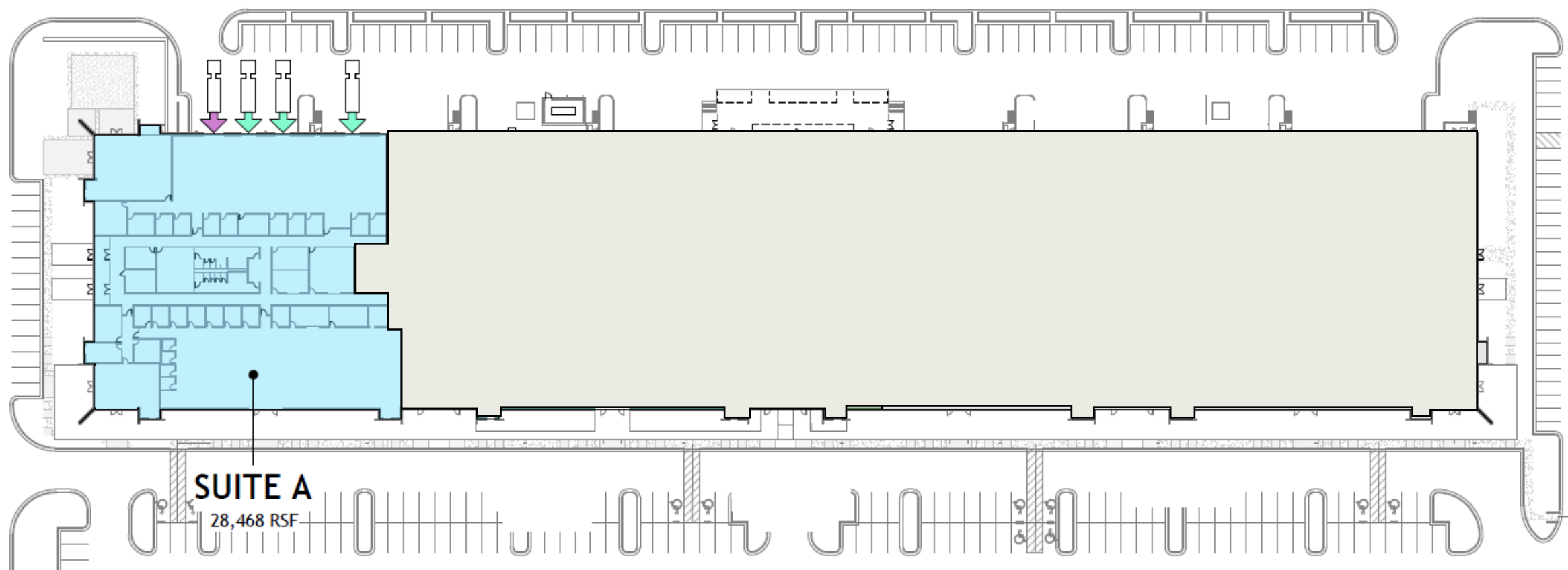



# Location

PARMER offers unparalleled accessibility in Northeast Austin. Easy vehicular connectivity through multiple routes, including Parmer Lane, I-35, SH 130 and US 183.

Tenants will have the opportunity to experience the charm and allure of renowned bedroom communities, including Cedar Park, Round Rock, Pflugerville.

The property is also surrounded by top-tier school districts such as Round Rock ISD, Leander ISD, and Pflugerville ISD. **PARMER** tenants can **enjoy the perfect blend of convenience**, comfort, and a thriving tech community.

## Close to everything

**Domain:** 10 mins

**Round Rock:** 11 mins

**Downtown:** 20 mins

**Tesla Giga:** 25 mins

**Pflugerville:** 10 mins

**Cedar Park:** 18 mins

**Airport:** 20 mins

**Samsung (Taylor):** 35 mins

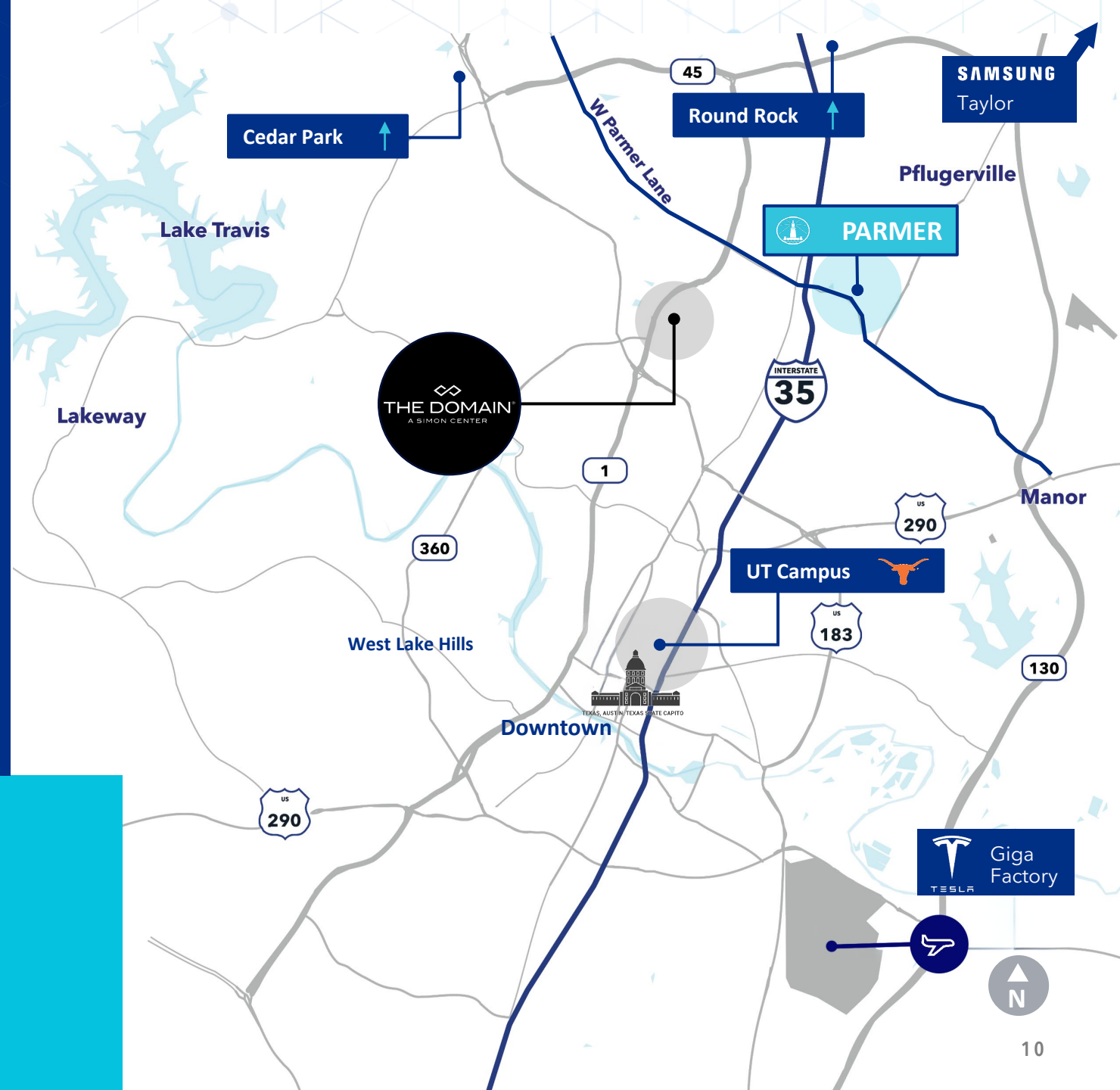



# Local Retail Amenities

Within 5-minute drive

<b>37</b>	<b>4</b>	<b>7</b>	<b>9</b>
Restaurants	Entertainment	Fitness	Hotels



Located only 10 minutes from the Domain. The Domain is Austin's 2<sup>nd</sup> Downtown and features over 100 upscale and mainstream retail stores and restaurants in a walkable environment.

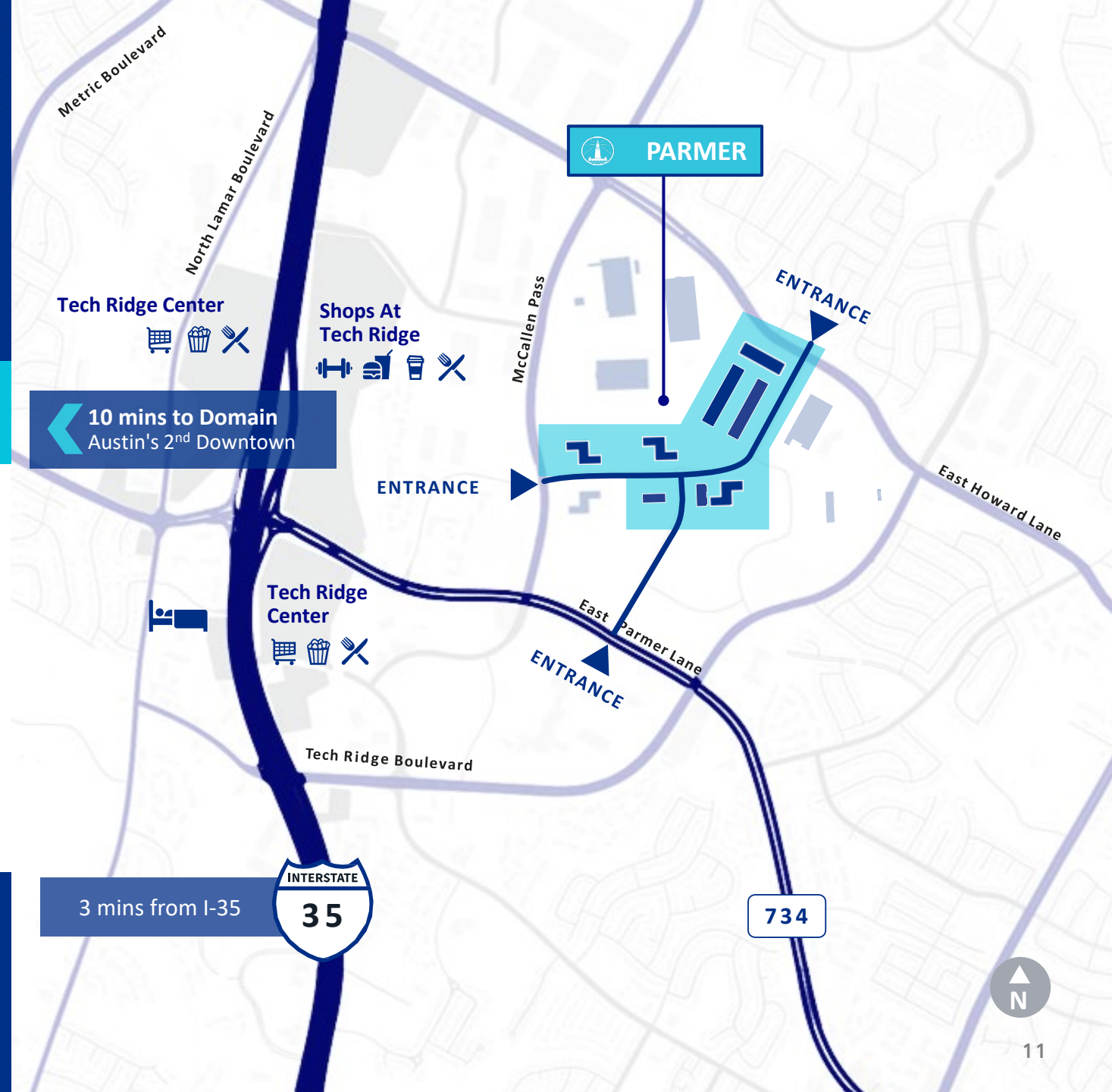





# The Austin Advantage

## Business-Friendly Climate

- #1 Hub for HQ Relocations<sup>1</sup>
- 7 out of 7 of the “Magnificent Seven” tech companies have a presence

## Attractive Location for Talent

- 171,000 University Students<sup>3</sup>
- Major destination for key influencers and entertainers.

## Low Cost of Living

- Affordable compared to major technology centers including San Francisco, New York, Boston, San Diego and Seattle.
- Strong housing advantage compared to other major metros

## Low Tax Burden

- State and Local Tax Burden 18% lower than national average<sup>4</sup>
- No Personal State Income Tax

1. Source: CBRE Dec. 2023 Report. Analysis of nearly 500 HQ relocations over past 5 years.

2. Source: Opportunity Austin, “Why Austin”, 2023. Students from 20+ Area Colleges and Universities.

3. Source: Opportunity Austin, “Why Austin”, 2023.



# Austin

## Where Culture and Lifestyle Thrive!

Austin has transformed from a quiet state capital into one of the fastest-growing metros in the country. Universally regarded for its thriving economy, prosperous employment opportunities, and innovative ecosystem, Austin's quality of life is truly what sets it apart from other cities. Known as the "Live Music Capital of the World", people are drawn to the city's cultural vitality, outdoor spaces, and vibrant food and entertainment scene.



### Local Events

ACL Music Festival  
Formula 1™ Grand Prix Event  
Rodeo Austin  
SXSW® Music & Film Conference

### Abundant Recreation<sup>4</sup>

350 parks  
20,000 acres of green space  
269 miles of trails  
28 miles of lakes



# #1

BEST-PERFORMING  
CITY<sup>1</sup>

# #2

FASTEST GROWING  
METROS<sup>2</sup>

# 33%

OF POPULATION  
IS AGE 25-44<sup>3</sup>

# 30M

ANNUAL  
VISITORS<sup>3</sup>

1. Source: Milken Institute, 2024 Best Performing Cities in annual assessment of economic growth  
2. Source: U.S. Census Bureau, March 2024  
3. Source: Opportunity Austin  
4. Source: austintexas.gov, Annual Report FY2023





## Building the Future of Life-Changing Innovation®

Alexandria Real Estate Equities, Inc. (NYSE:ARE), an S&P 500® company, is a best-in-class, mission-driven life science REIT making a positive and lasting impact on the world. As the pioneer of the life science real estate niche with our founding in 1994, Alexandria is the longest-tenured owner, operator, and developer of collaborative life science and technology mega campuses in AAA innovation cluster locations across the nation. Alexandria has a longstanding and proven track record of providing its tenants with highly dynamic, collaborative, and healthy work environments that enhance our tenant's ability to recruit and retain talent, inspire productivity and foster innovation. For more information, please visit [www.are.com](http://www.are.com).

30+  
Years

39.1M SF  
Operating Properties

\$27.8 Billion  
Market Cap

BBB+ S&P 500 rating

\$4.2B Significant Liquidity

Trusted Strategic Relationships with the world's most innovative companies:

Alphabet

SINCE 1999

Bristol Myers Squibb™

SINCE 1998

GILEAD

SINCE 2004

illumina®

SINCE 2011

Lilly

SINCE 2008

MERCK

SINCE 2000

MIT  
Massachusetts  
Institute of  
Technology

SINCE 2006

NOVARTIS

SINCE 1996

Pfizer

SINCE 1998

Roche

SINCE 2005

sanofi

SINCE 2008

Stanford  
University

SINCE 1999

As of September 30, 2025

ALEXANDRIA REAL ESTATE EQUITIES, INC. | All Rights Reserved © 2025

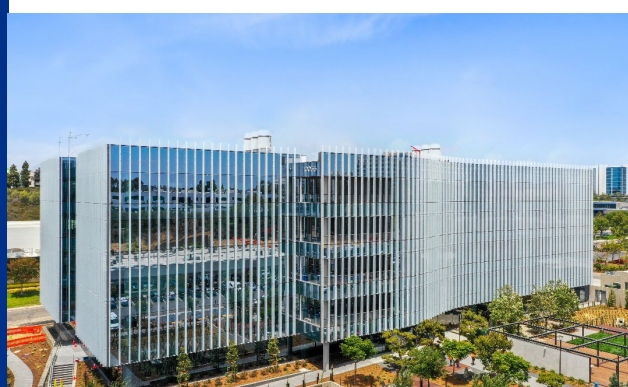





# PARMER

For more information, please contact

**BETHANY PEREZ**

+1 512.225.1731

bethany.perez@jll.com

**COLTON MCCASLAND**

+1 512.225.1738

colton.mccasland@jll.com

**BRENT POWDRILL**

+1 512.225.1737

brent.powdrill@jll.com

Although information has been obtained from sources deemed reliable, JLL does not make any guarantees, warranties or representations, express or implied, as to the completeness or accuracy as to the information contained herein. Any projections, opinions, assumptions or estimates used are for example only. There may be differences between projected and actual results, and those differences may be material. JLL does not accept any liability for any loss or damage suffered by any party resulting from reliance on this information. If the recipient of this information has signed a confidentiality agreement with JLL regarding this matter, this information is subject to the terms of that agreement. © 2025 Jones Lang LaSalle Brokerage, Inc. All rights reserved.



THE FUTURE BEGINS NOW