

933 MACARTHUR
BOULEVARD

Fully-Furnished HQ Opportunity in Bergen County's Newest Building

PLUG-AND-PLAY SPACE OFFERING
3 FLOORS OF BEAUTIFUL OFFICES



MAHWAH, NJ



Opportunity Highlights



UP TO 50,500 SF AVAILABLE



NEWEST BUILDING IN BERGEN COUNTY WITH PREMIUM, BEAUTIFUL FINISHES



MANICURED WALKING TRAILS AROUND THE PARKING LOT PERIMETER



BUILDING SIGNAGE AVAILABLE TO A MAJORITY TENANT



OFFERED FULLY FURNISHED – JUST PLUG AND PLAY



-4 MINUTES FROM I-287 AND CLOSE TO ALL MAJOR AREA HIGHWAYS/ ROUTES (ROUTE 87, ROUTE 17)

933 MacArthur Boulevard offers an exceptional fully-furnished headquarters opportunity in Bergen County's newest Class A office building. This LEED Gold-certified, 50,500 square-foot facility features premium finishes and plug-and-play office space across three floors. Located in Mahwah, New Jersey with convenient access to I-287 and major highways, the property includes manicured walking trails and available building signage for a majority tenant.

BUILDING SPECS



CLASS A



50,500 SF TOTAL



BUILT IN 2016



3 STORIES



LEED GOLD BUILDING



DEDICATED ENTRANCE FOR FLOOR 1 AND FLOOR 2



Floor 1

17,580 SF

PRIVATE OFFICE BOARDROOM CONFERENCE ROOM

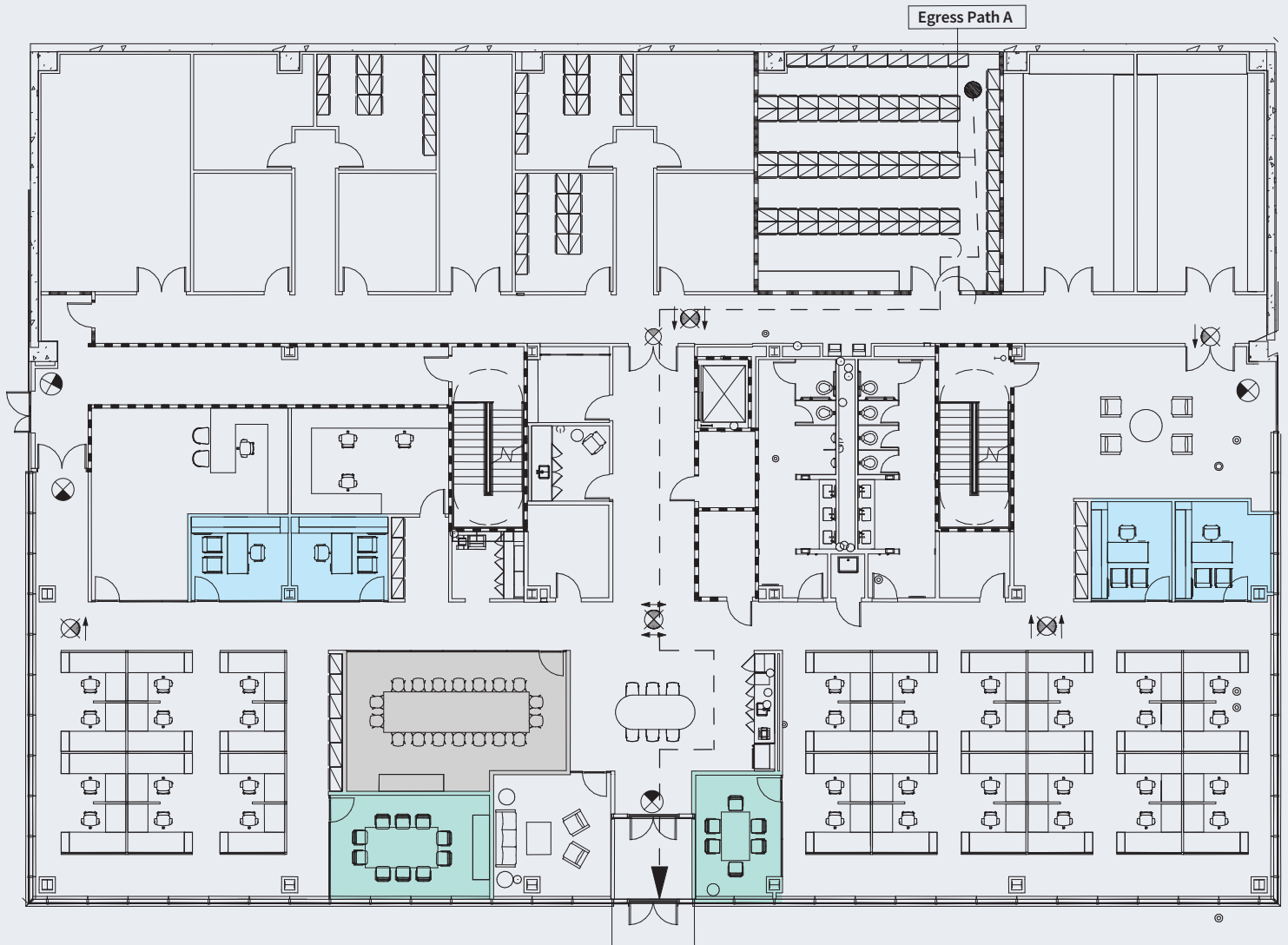

Floor 2

16,460 SF

PRIVATE OFFICE BOARDROOM CONFERENCE ROOM

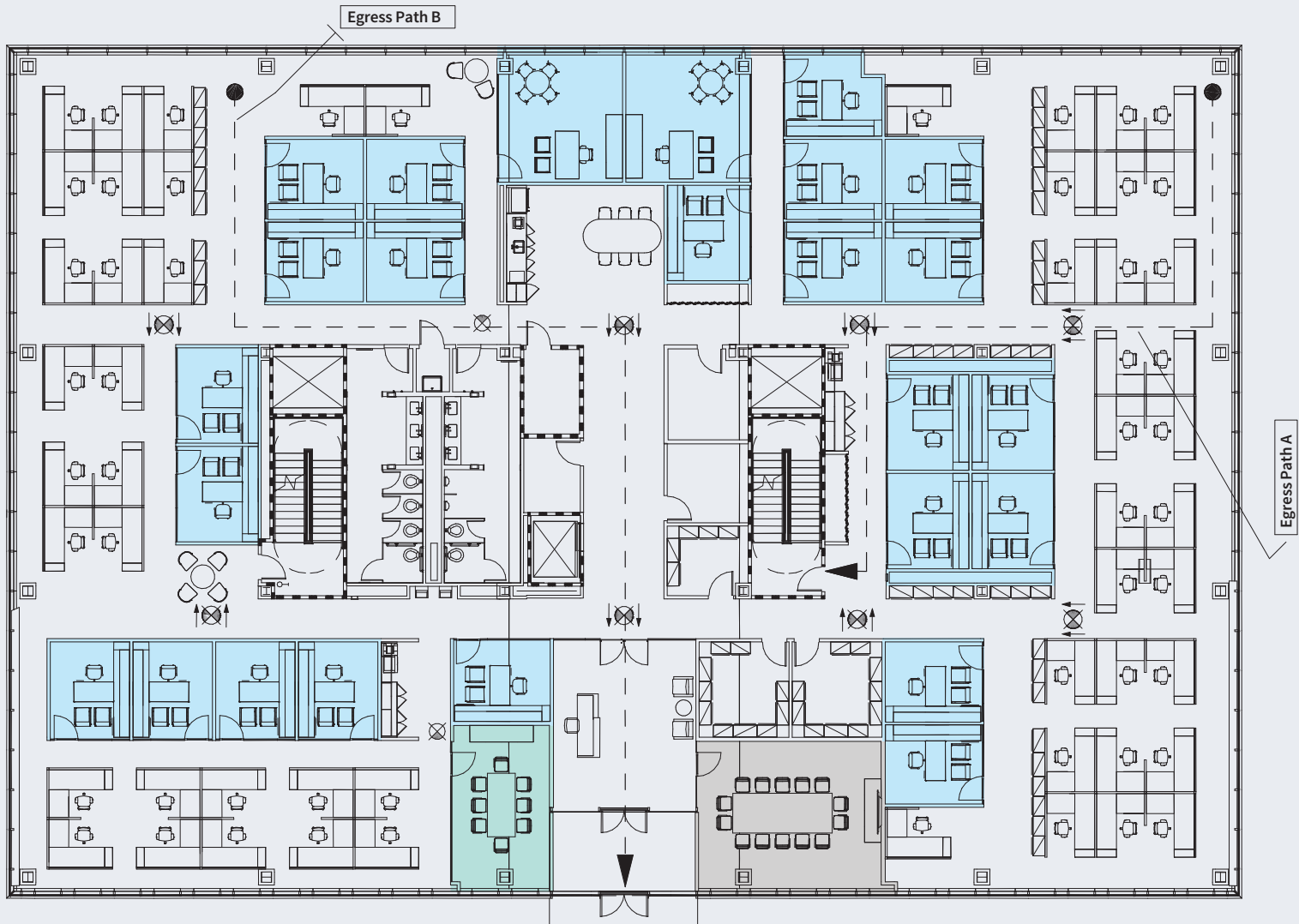

Floor 3

16,460 SF

PRIVATE OFFICE BOARDROOM CONFERENCE ROOM

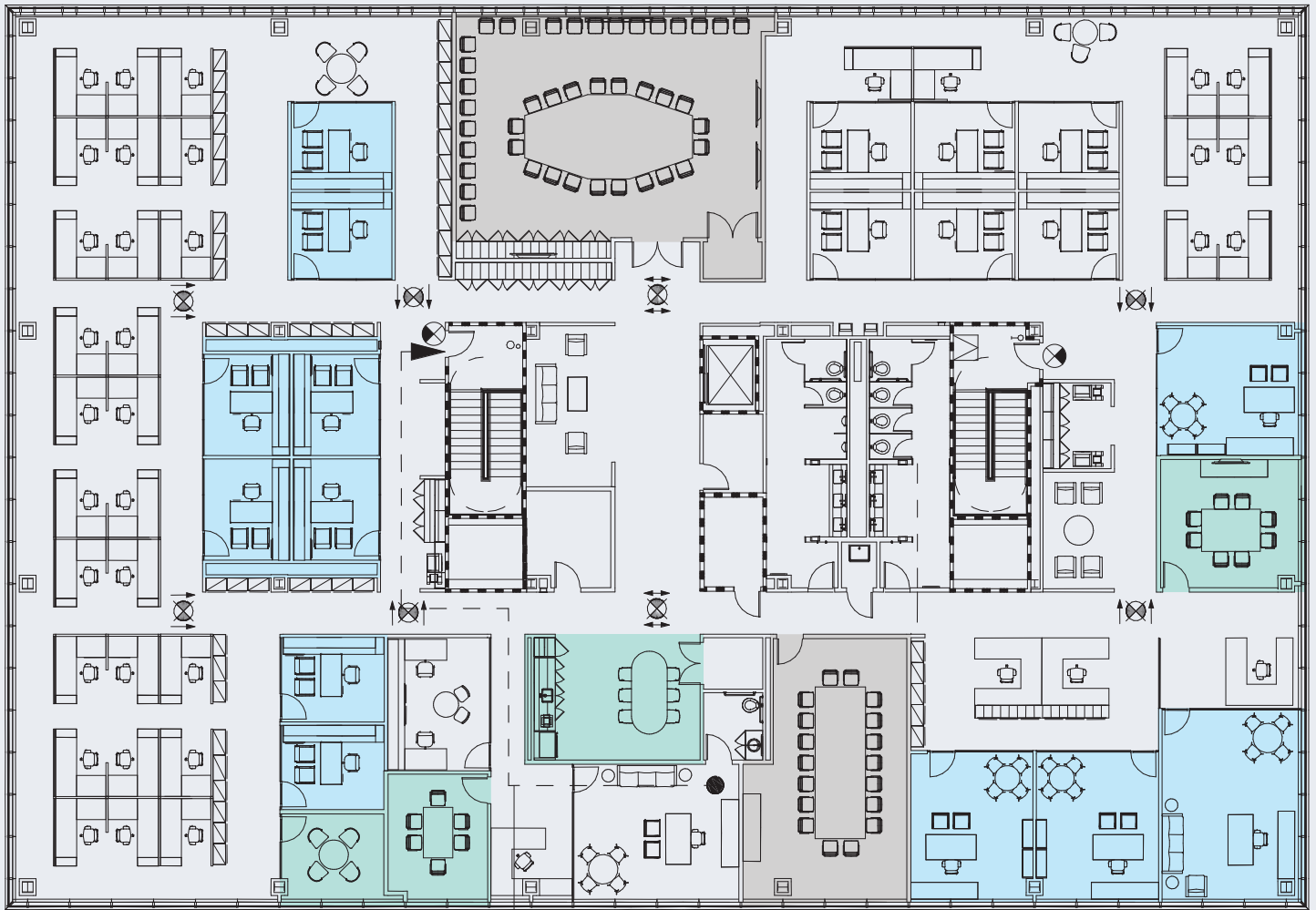

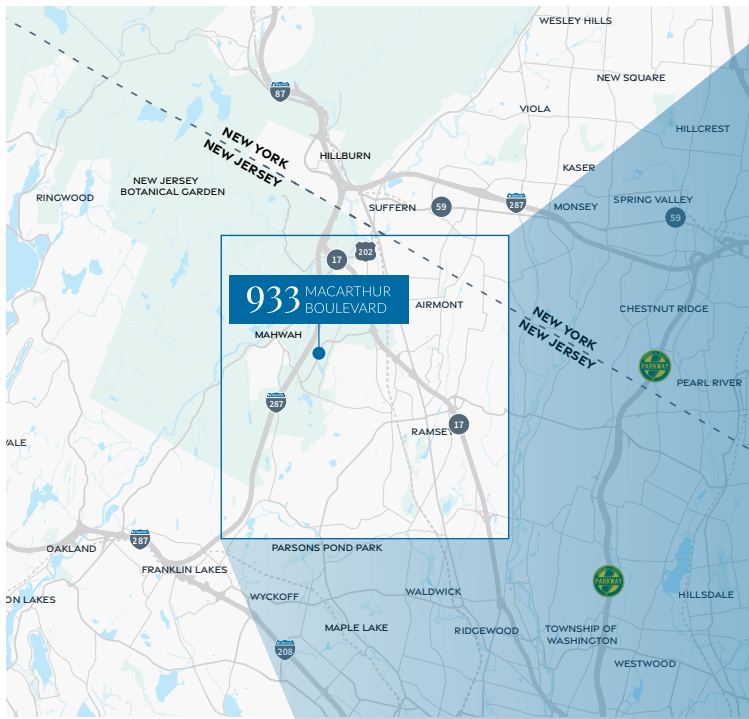

Around Town

RAMPO VALLEY
COUNTRY RESERVATION

933 MACARTHUR
BOULEVARD

INTERSTATE SHOPPING CENTER



DO







933 MACARTHUR BOULEVARD

FOR MORE
INFORMATION AND TO
ARRANGE A PRIVATE
TOUR, PLEASE CONTACT:

Scott Lesh

+1 973 829 4693

scott.lesh@Jll.com

Derek DeMartino

+1 973 997 1117

derek.demartino@Jll.com



Although information has been obtained from sources deemed reliable, neither Owner nor JLL makes any guarantees, warranties or representations, express or implied, as to the completeness or accuracy as to the information contained herein. Any projections, opinions, assumptions or estimates used are for example only. There may be differences between projected and actual results, and those differences may be material. The Property may be withdrawn without notice. Neither Owner nor JLL accepts any liability for any loss or damage suffered by any party resulting from reliance on this information. If the recipient of this information has signed a confidentiality agreement regarding this matter, this information is subject to the terms of that agreement. ©2025 Jones Lang LaSalle IP, Inc. All rights reserved.