



Hwy 98 & N Glades Trail

Panama City Beach, Florida 32407



Property highlights

Prime Retail & Drive-Thru Site on Hwy 98 at New Signalized Intersection

- Traffic light planned for Hwy 98 and N Glades Trail intersection
- Traffic counts for Hwy 98 - 44,500 CPD
- Flat site with access road
- Drive through restaurant engineering plans available for use
- Close proximity to Duplin Winery of Rose Hill - a 38,000 SF award-winning entertainment complex

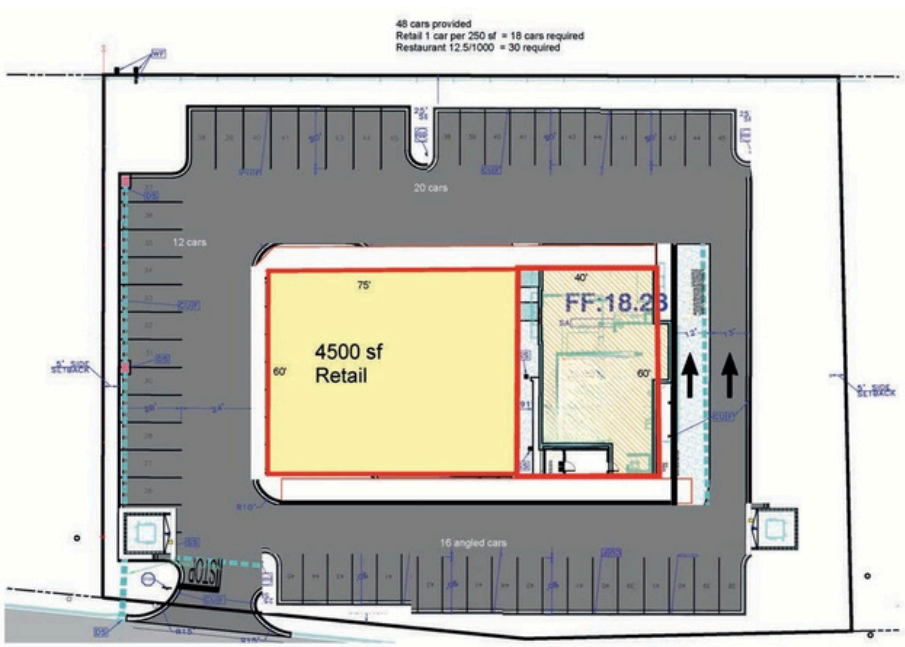

Demographics

	11-mile	3-mile	55-mile
Daytime Population Average	3,984	15,145	26,582
Household Income	\$96,352	\$87,787	\$80,152
Median Age	49.0	43.3	43.3



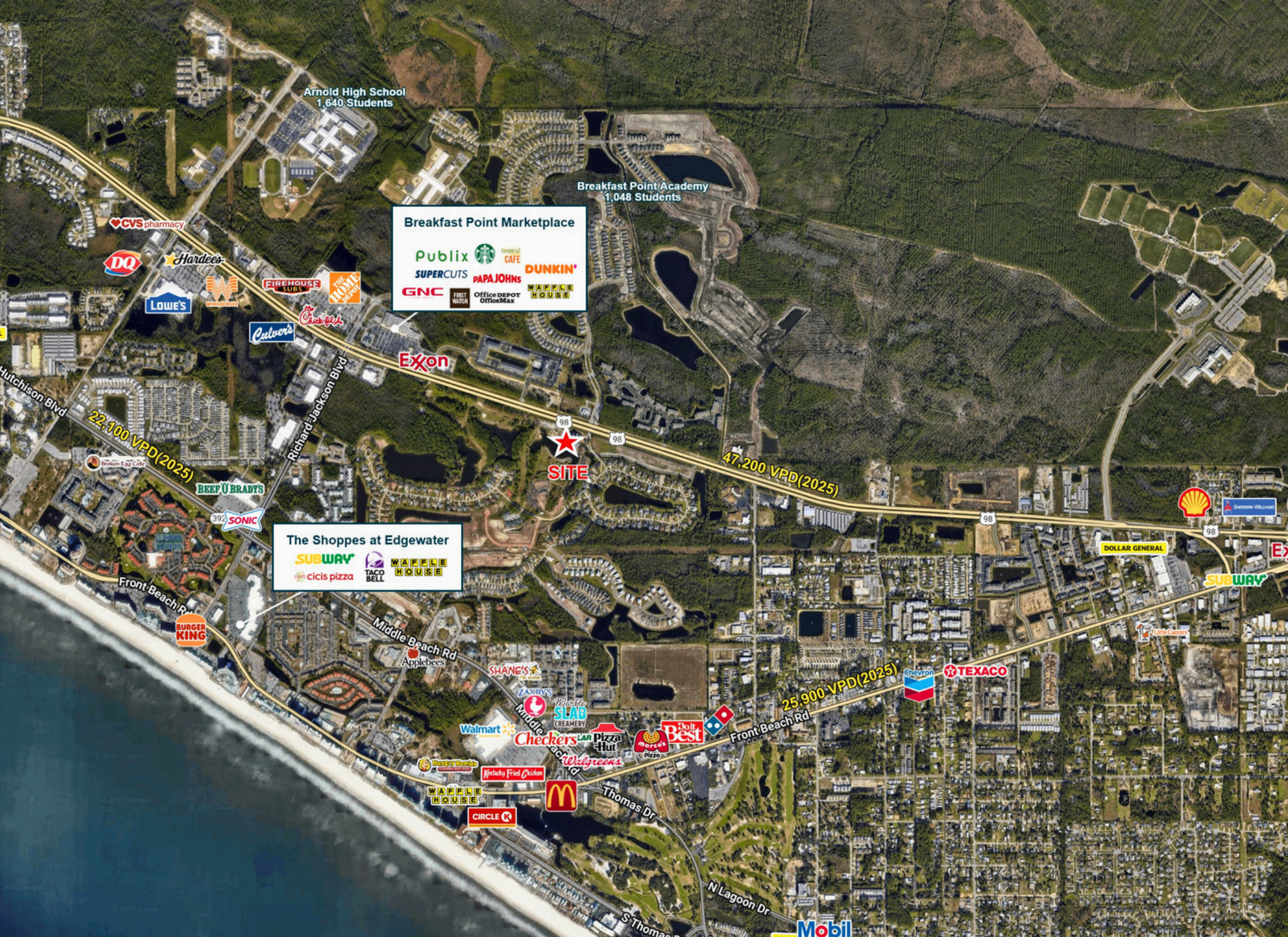

Arnold High School
1,640 Students

Breakfast Point Academy
1,048 Students

Breakfast Point Marketplace

- Publix
- Starbucks
- Tropical Cafe
- Dunkin'
- Supercuts
- Papa John's
- Waffle House
- GNC
- Office Depot
- OfficeMax
- First Watch

The Shoppes at Edgewater

- Subway
- Cicis Pizza
- Taco Bell
- Waffle House

SITE

22,100 VPD(2025)

47,200 VPD(2025)

25,900 VPD(2025)

Front Beach Rd

Middle Beach Rd

Front Beach Rd

Thomas Dr

N Lagoon Dr

S Thomas Dr



JLL

Sherri Wilson

Senior Vice President

sherri.wilson@jll.com

+1 404 995 2274

Although information has been obtained from sources deemed reliable, JLL does not make any guarantees, warranties or representations, express or implied, as to the completeness or accuracy as to the information contained herein. Any projections, opinions, assumptions or estimates used are for example only. There may be differences between projected and actual results, and those differences may be material. JLL does not accept any liability for any loss or damage suffered by any party resulting from reliance on this information. If the recipient of this information has signed a confidentiality agreement with JLL regarding this matter, this information is subject to the terms of that agreement. ©2025 Jones Lang LaSalle Brokerage, Inc. All rights reserved.