



CORNERSTONE



2750 E COTTONWOOD PKWY
COTTONWOOD HEIGHTS, UT 84121

3,359 RSF AVAILABLE

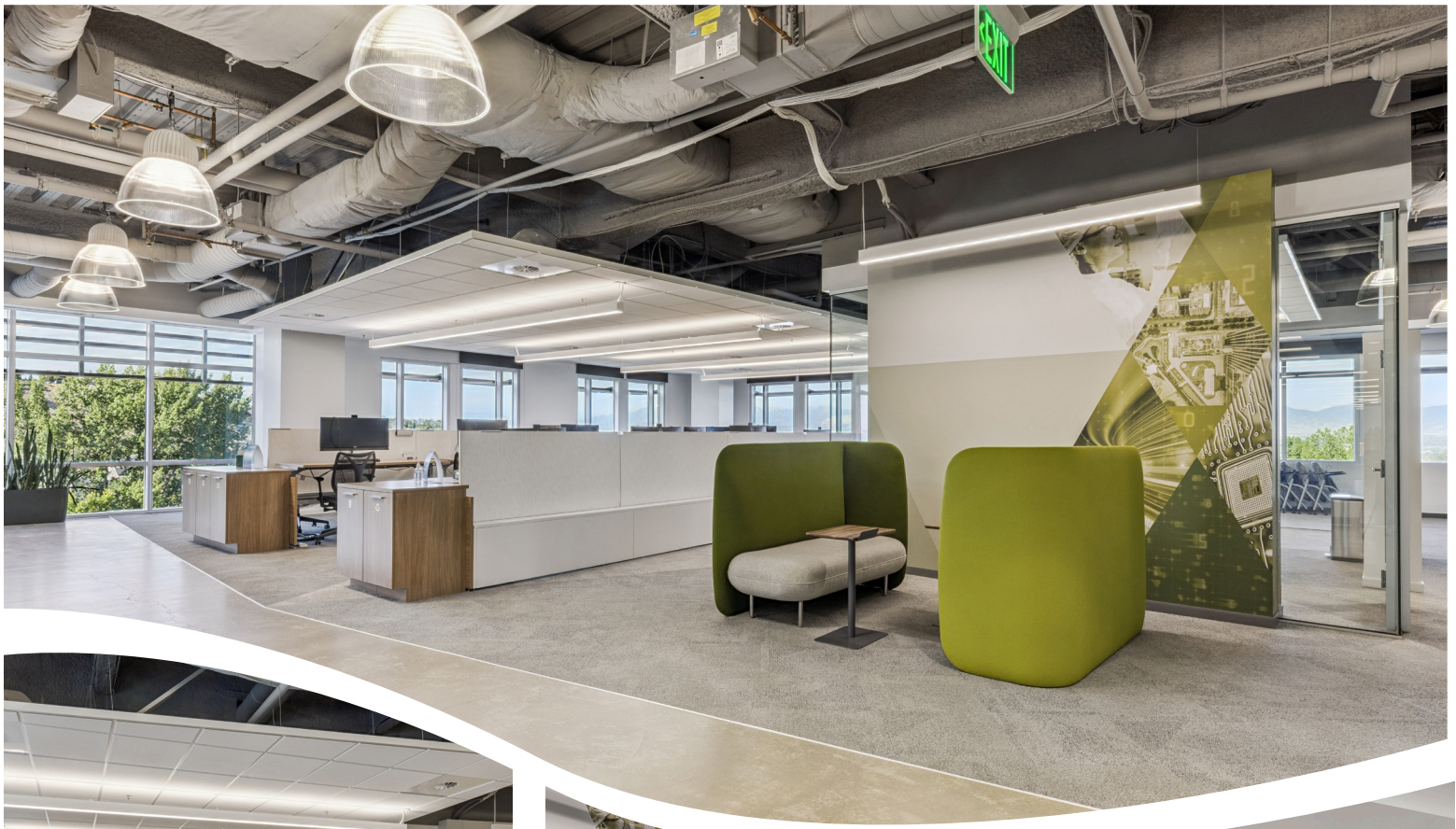

FEATURES

- High-End Glass Finishes Throughout
- LEED Gold Certified
- Redundant Fiber
- Free Electric Car Chargers
- Walking / Biking Paths
- Newest Class A Building in Cottonwood
- Covered and Executive Parking Available
- Toasters cafe on site
- Modern building systems
- On-site property management
- Walkable to restaurants, retail and transit

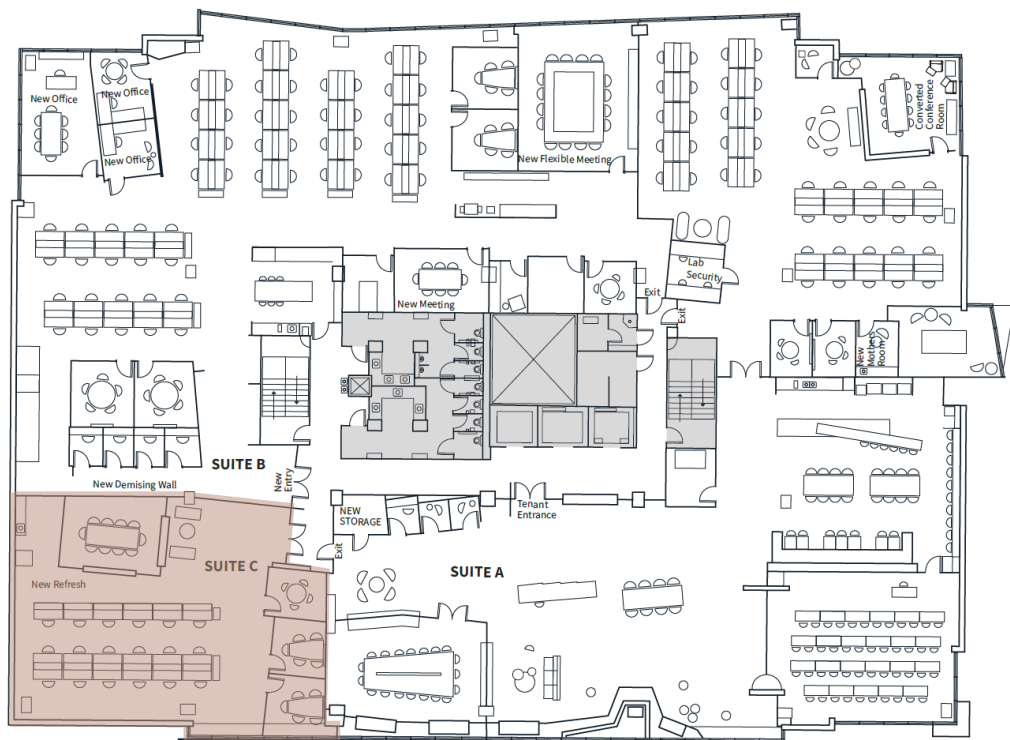

Available

3,359 RSF AVAILABLE

- 4th Floor - Suite C
- Lease Rate \$42.00 FSG
- Plug and Play
- Floor to Ceiling Exterior Glass
- Glass Front Offices
- Conference Room
- Elevator Presence
- Available Now



On-site fitness area w/ lockers & showers



Floor-to-ceiling glass



Toasters Cafe
on site

2750 E COTTONWOOD PKWY

- Strategically located on the prestigious East Bench of Salt Lake City
- Situated just below the Wasatch Mountains with quick access to Snowbird, Solitude, Brighton and Alta ski resorts
- Immediate access to I-215 makes Downtown Salt Lake City and the Salt Lake International Airport only a 15-20 minute drive

AMENITIES

1. Market Street Grill
2. Mountain America
3. Zions Bank
4. The Happy Sumo
5. Bout Time
6. Residence Inn
7. Spitz
8. Hyatt Place
9. Starbucks
10. Bandits' Grill & Bar
11. Mint Tapas and Sushi
12. Toasters Cafe (onsite)



For further information please contact:

DAVID NIXON

+1 801 456 9518
david.nixon@jll.com

BRONSON RAWLINS

+1 801 456 9513
bronson.rawlins@jll.com



DAKOTA PACIFIC
Real Estate

