

FOR LEASE

2870

CORDELIA ROAD



±7,200 - 13,200 SF OFFICE / WAREHOUSE SUITES
OR ±20,400 SF COMBINED - FAIRFIELD BUSINESS CENTER

AVAILABLE SPACES

Suite 150

- ±13,200 SF office/warehouse suite for lease*
- ±3,200 SF of office area
- 22'-24' clear height
- 2 docks with auto levelers
- 1 grade-level door
- 400 amps of 277/480v, 3-phase electrical service

*Suites 130 & 150 can be combined for a total of ±20,400 SF

Suite 130

- ±7,200 SF office/warehouse suite for lease*
- ±500 SF of office area
- 22'-24' clear height
- 1 dock-high and 1 grade-level door
- 800 amps of 277/480v, 3-phase electrical service

PROPERTY HIGHLIGHTS

- ±98,800 SF in 3 light industrial / flex buildings
- Automatic gates to access fenced rear yard
- 24/7 exterior camera monitoring throughout park
- 3 per 1,000 SF parking ratio



CHRIS NEEB

chris.neeb@jll.com

(707) 495 7777

RE License No: 01324612

MATT BRACCO

matt.bracco@jll.com

(925) 200 3537

RE License No: 01185434

GLEN DOWLING

glen.dowling@jll.com

(707) 227 7800

RE License No: 00890450

Jones Lang LaSalle Brokerage, Inc.
Real Estate Lic# 01856260

FLOOR PLANS

Suite 150

- $\pm 13,200$ SF industrial/office suite
- $\pm 3,200$ SF office area
- Reception, 4 private offices, open plan area, break area and lab area
- 22'-24' clear height
- 2 docks with auto levelers
- 1 grade-level door
- 400 amps of 277/480 volt, 3-phase electrical service
- New LED lighting in office area and warehouse
- New HVAC in office area

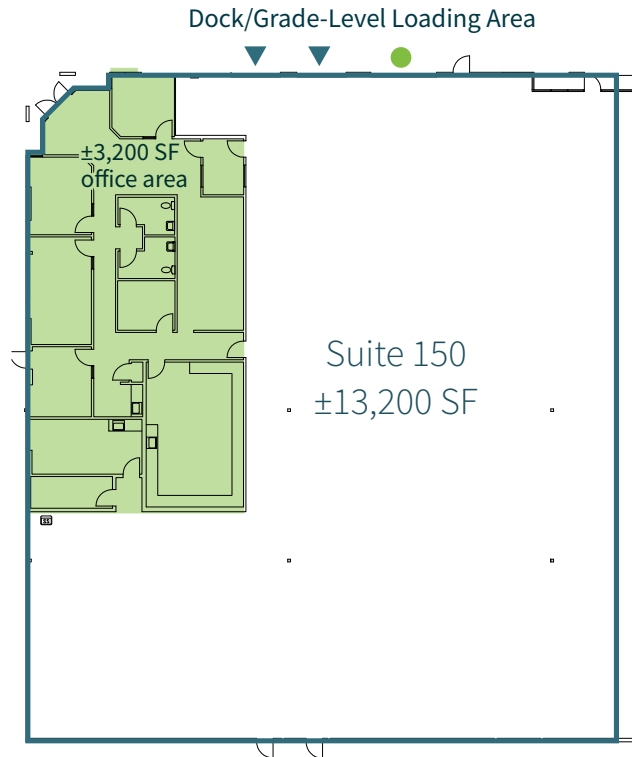

Suite 130

- $\pm 7,200$ SF industrial/office suite
- ± 500 SF office area
- 22'-24' clear height
- Two open office areas with 2 restrooms
- 1 dock-high and 1 grade-level door
- 800 amps of 277/480 volt, 3-phase electrical service
- Newly renovated

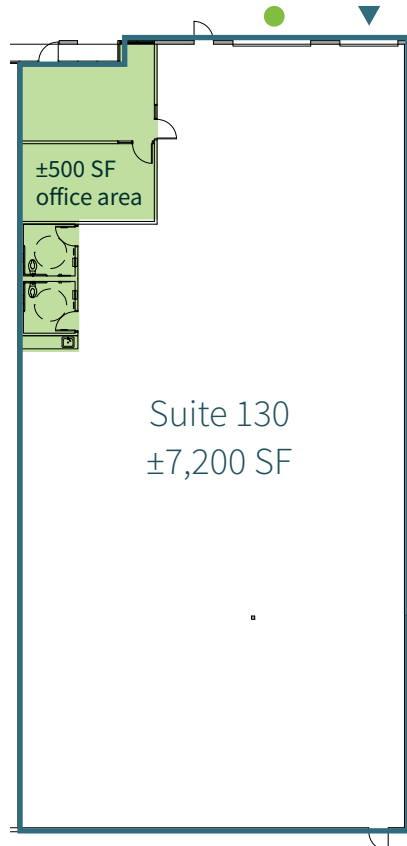

FOR LEASE

2870
CORDELIA ROAD



SITE PLAN

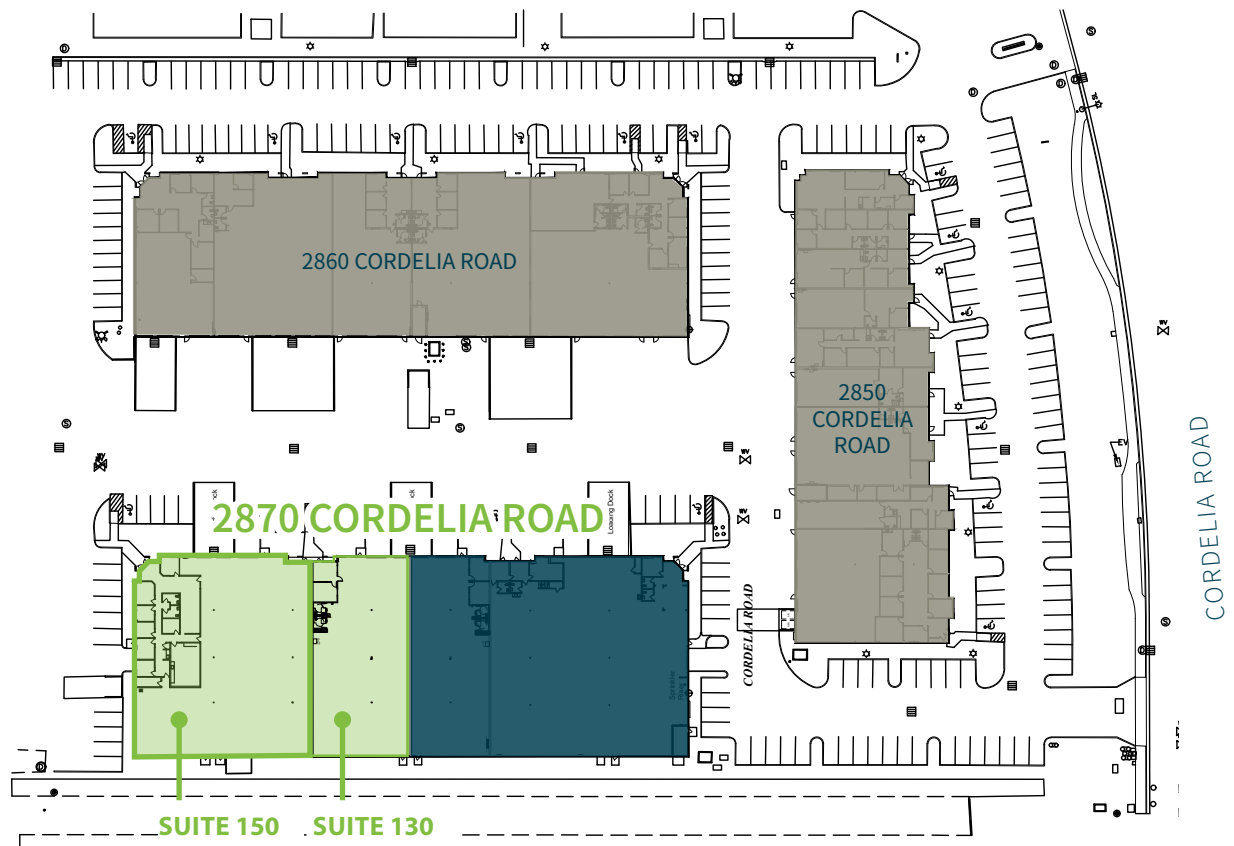

To Schedule a Tour or For More Information, Please Contact:

Jones Lang LaSalle Brokerage, Inc. Real Estate License #: 01856260



CHRIS NEEB
chris.neeb@jll.com
(707) 495 7777
RE License No: 01324612

MATT BRACCO
matt.bracco@jll.com
(925) 200 3537
RE License No: 01185434

GLEN DOWLING
glen.dowling@jll.com
(707) 227 7800
RE License No: 00890450