

For lease

2345 S Watney Way | Fairfield

- $\pm 100,460$ SF warehouse space
- Divisible to $\pm 25,000$ SF
- 16 dock-high loading doors
 - 8 with edge of dock levelers
- 3 grade-level loading doors
- 25'-27' clear height



2.9 AC also available for:

- Secure yard storage
- Additional trailer parking
- Future building expansion

Recent building improvements:

- 60 Mil GAF TPO roof (20 yr warranty)
- Parking lot seal, coat & striping
- Significant asphalt replacement
- Building exterior re-painted

Space highlights

Address:	2345 S Watney Way Fairfield, CA
Available SF:	±100,460 SF (divisible to ±25,000 SF)
Office SF:	3 separate office areas: 2,825 SF 1,392 SF 1,005 SF
Loading Doors:	- 16 dock high doors (8 with edge of dock levelers) - 3 grade-level doors
Clear height:	25' - 27'
Column spacing:	45' x 22.7'
Auto stalls:	145
Power:	2,000a, 277/480v, 3-phase
Sprinklers:	.32 GPM over 2,000 sprinkler density ratio
Zoning:	IL - Limited Industrial
Yard:	2.9 AC adjacent lot also available for lease

Site Plan

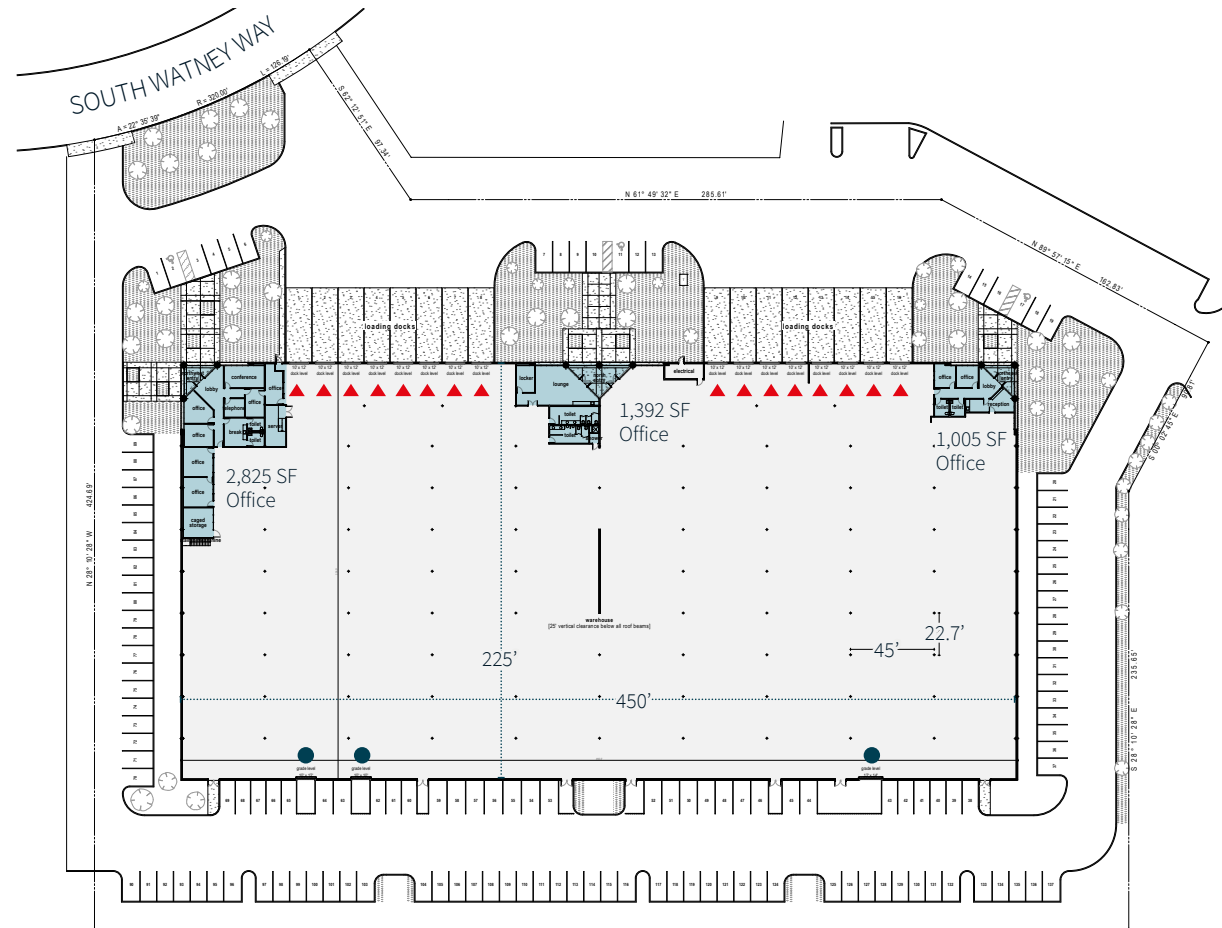

- ▲ Dock High Door
- Grade-Level Door
- Office space

Floor Plan

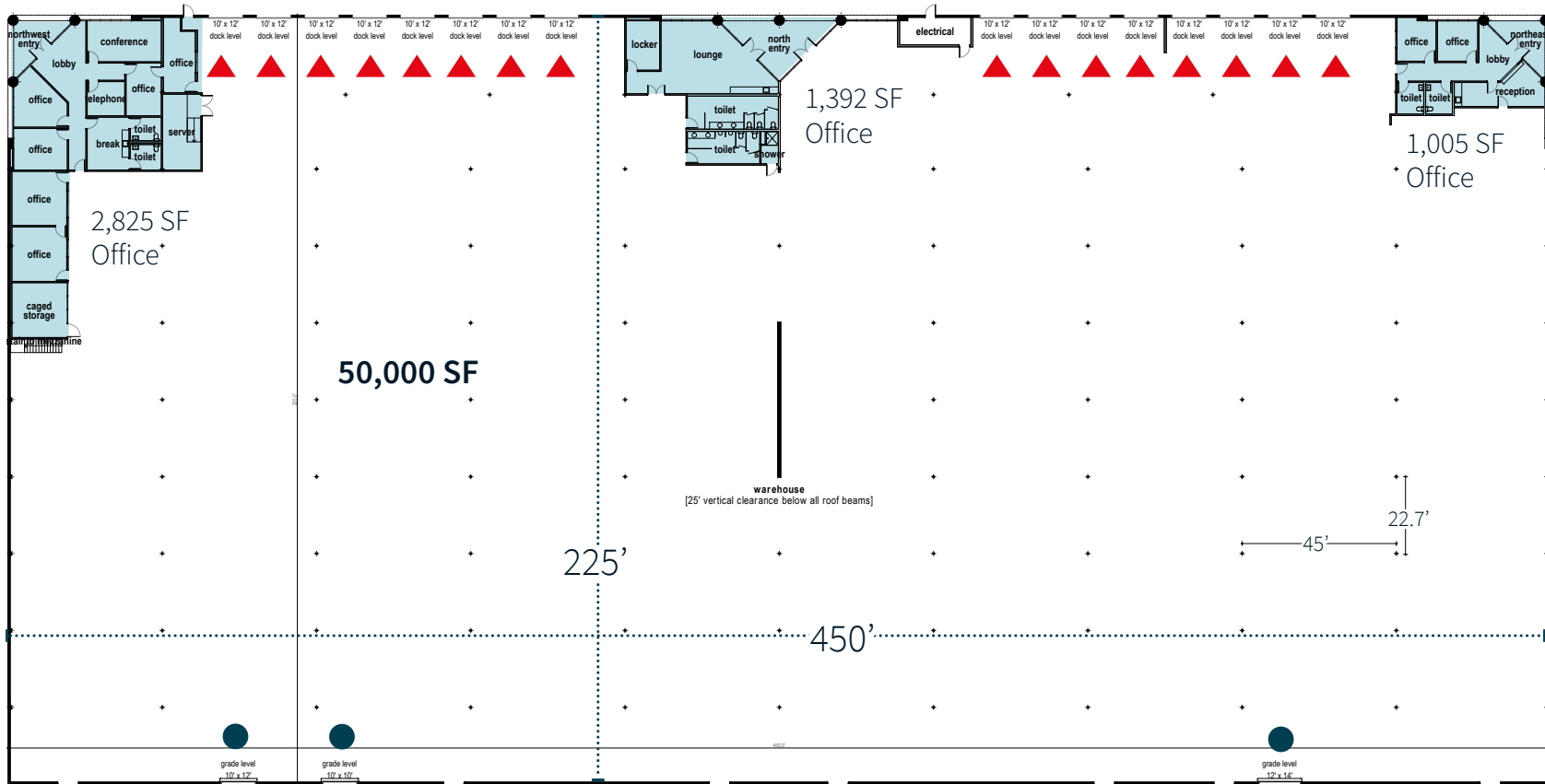

- ▲ Dock High Door
- Grade-Level Door
- Office space



**2345 S
WATNEY WAY**

CHRIS NEEB
 chris.neeb@jll.com
 (707) 495 7777
 RE License #01324612

MATT BRACCO
 matt.bracco@jll.com
 (925) 200 3537
 RE License #01185434

GLEN DOWLING
 glen.dowling@jll.com
 (707) 227 7800
 RE License #00890450

CHRIS BURNS
 christopher.burns@jll.com
 (925) 389 0292
 RE License #01880060

ZACK CAUZ
 zack.cauz@jll.com
 (415) 912 0794
 RE License #02340691



Although information has been obtained from sources deemed reliable, neither Owner nor JLL makes any guarantees, warranties or representations, express or implied, as to the completeness or accuracy as to the information contained herein. Any projections, opinions, assumptions or estimates used are for example only. There may be differences between projected and actual results, and those differences may be material. The Property may be withdrawn without notice. Neither Owner nor JLL accepts any liability for any loss or damage suffered by any party resulting from reliance on this information. If the recipient of this information has signed a confidentiality agreement regarding this matter, this information is subject to the terms of that agreement. ©2026. Jones Lang LaSalle IP, Inc. All rights reserved.