

Price reduction! 2 months free rent with a 5-year lease



For lease

Flex/office space
available in Urbandale, IA

5,988 SF | 8,613 SF

12000 Ridgemont Drive
Urbandale, Iowa 50323

Property overview

- Availability:
 - 12000: 5,988 SF
 - 12000: 8,613 SF
 - Lease rate: \$7.50 RSF NNN
- Est. OPEX: \$6.17/SF
- Year built: 2004
- Full building size: 75,000 SF

12000 Ridgemont Drive is well-located off of I-80/35. Recently updated office space and can be subdivided to 6,000 RSF. Ample parking available and building offers fully wet sprinkler system.

Justin Lossner, CCIM, SIOR
Senior Managing Director
justin.lossner@jll.com
+1 515 371 0846

Lucas Hedstrom
Vice President
lucas.hedstrom@jll.com
+1 515 564 9269

jll.com/des-moines

Jones Lang LaSalle Americas, Inc.



Images



Office layout

Conference room



Site plan

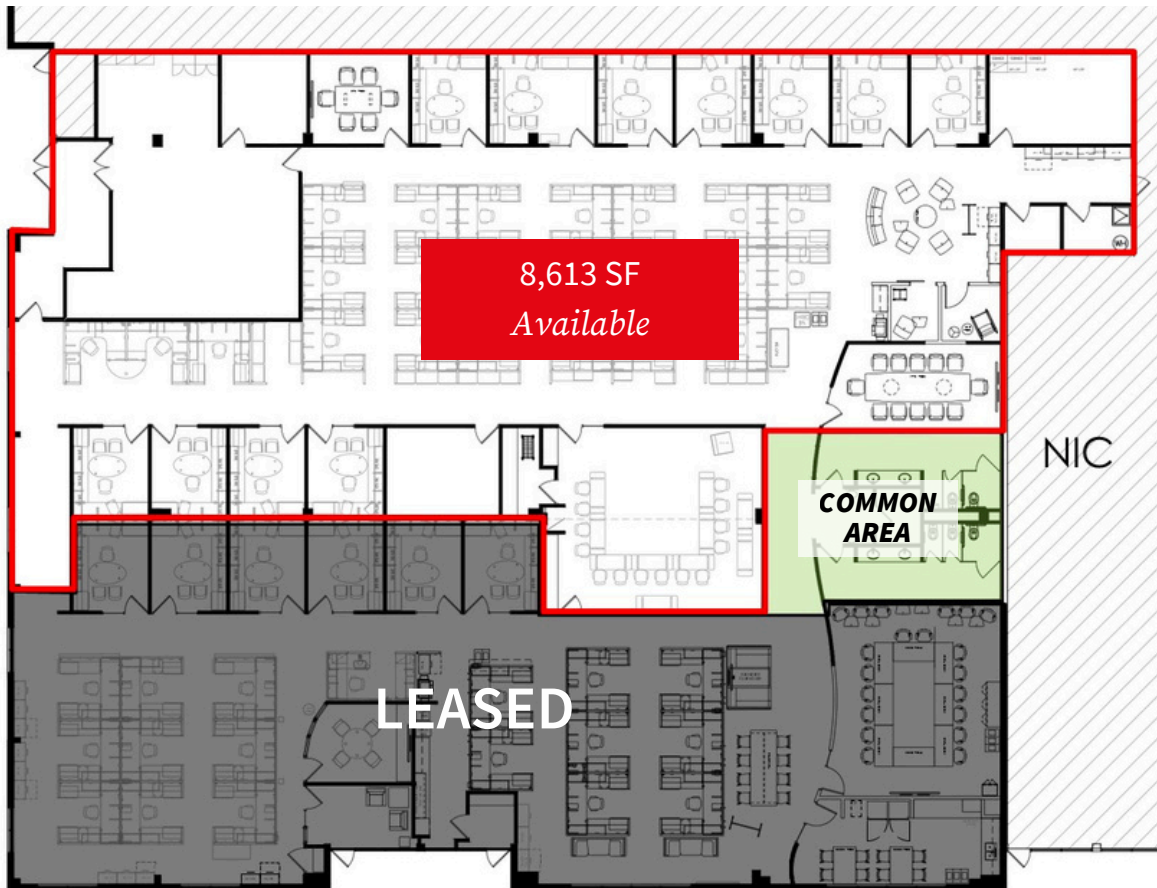
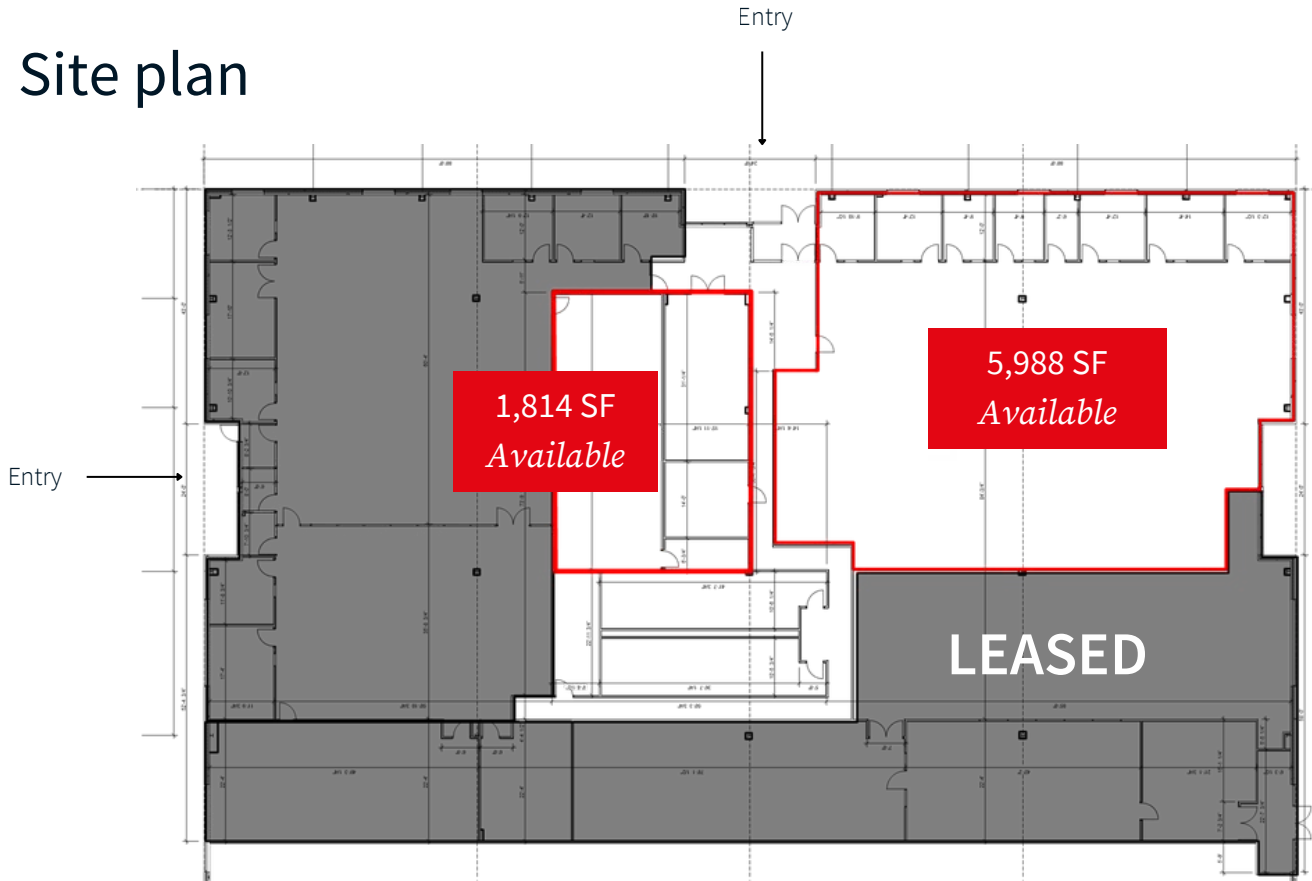

For lease

12000 Ridgemont Drive | Urbandale, Iowa 50323



Justin Lossner, CCIM, SIOR

Senior Managing Director

justin.lossner@jll.com

+1 515 371 0846

Lucas Hedstrom

Vice President

lucas.hedstrom@jll.com

+1 515 564 9269

jll.com/des-moines

Jones Lang LaSalle Americas, Inc.

