

FOR LEASE

66,504 SF
MANUFACTURING SPACE

N88W13901 MAIN ST., MENOMONEE FALLS, WI



JAMES YOUNG
Senior Vice President
+1 262 853 4002
james.young@jll.com

JOE CAROLLO
Vice President
+1 414 412 3363
joe.carollo@jll.com



OVERVIEW

BUILDING INFORMATION



110,000 SF Manufacturing building



Masonry & steel construction



1973 Built **1995** Renovated



3 / 1,000 SF Parking ratio



I-1 Zoning

AVAILABLE SPACE



66,504 RSF
Available



8,500 RSF
Office space



\$7.50 NNN
Rent PSF



April 2026
Availability

SHOP & PRODUCTION AREAS:



18' Clear height



40'x40' Column spacing



3-Phase Power, Est. 2,000 AMPS, 240 V



Six (6) Loading docks (2 covered, 5 with automatic levelers)



One (1) Grade 14' level door



New Busbar (2024)



Electrical & Air Drops



100% Climate Controlled



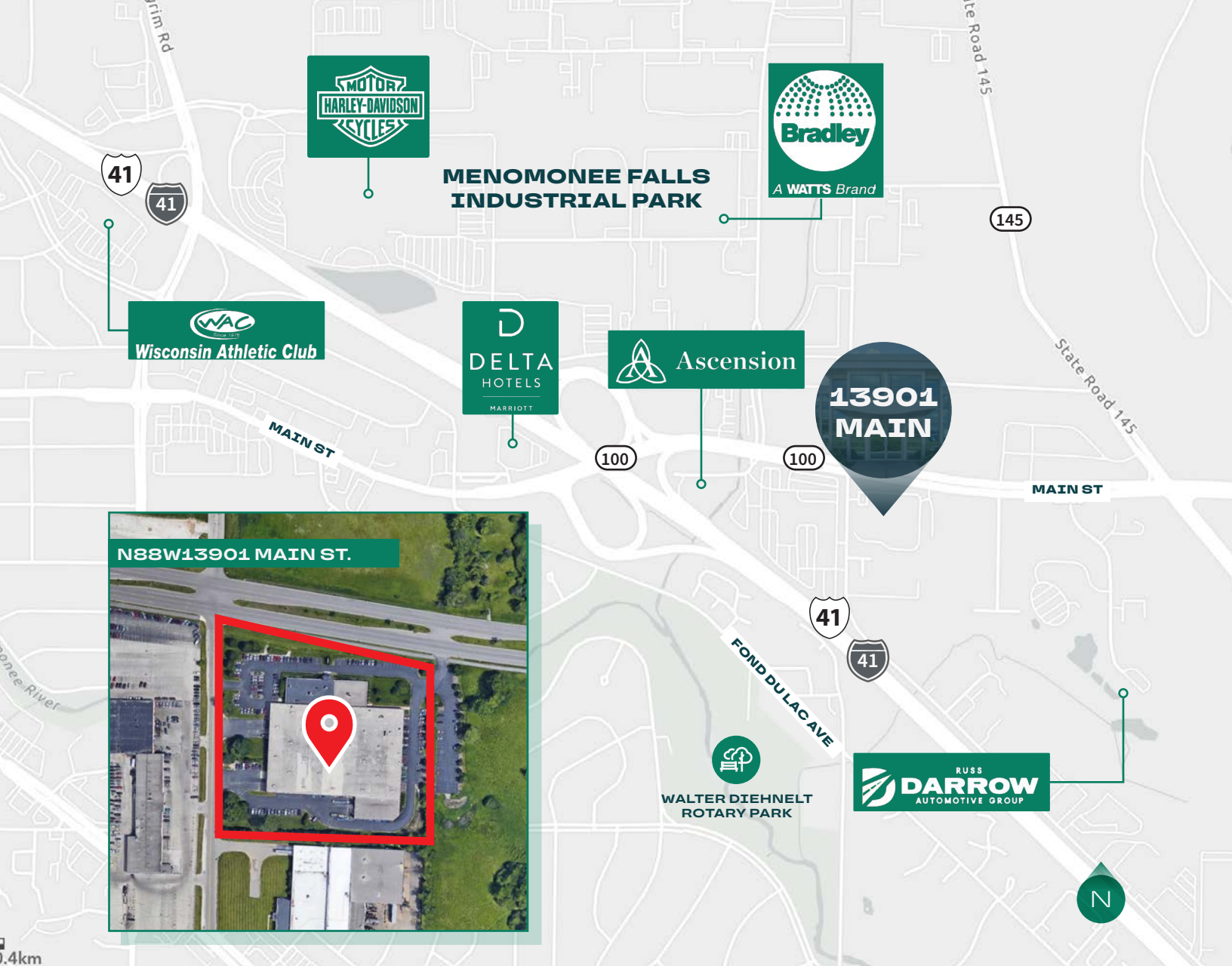

0.5 MILES: INTERSTATE 41 | **12 MILES:** ZOO INTERCHANGE
18 MILES: MARQUETTE INTERCHANGE | **24 MILES:** MITCHELL INT'L AIRPORT

LOCATION

Highway-Adjacent with Retail Convenience

Strategically positioned off Interstate 41 in Menomonee Falls, this property sits directly across from the Menomonee Falls Industrial Park. The location offers exceptional convenience with an abundance of nearby amenities, including numerous hotels, shopping centers featuring nationally recognized retailers, and a diverse selection of restaurants, making it an ideal location for businesses and their employees.

FLOOR PLAN

66,504 RSF Total SF: 58,004 RSF of Industrial Space | 8,500 RSF of Office Space

The office space features a **reception area** positioned next to the **main conference room**, along with eight **private offices**, three **additional conference rooms**, an **open workspace** containing 14 cubicles, a **break room** with **kitchenette** facilities, a **product development zone** with 11 workstations, and restroom facilities.

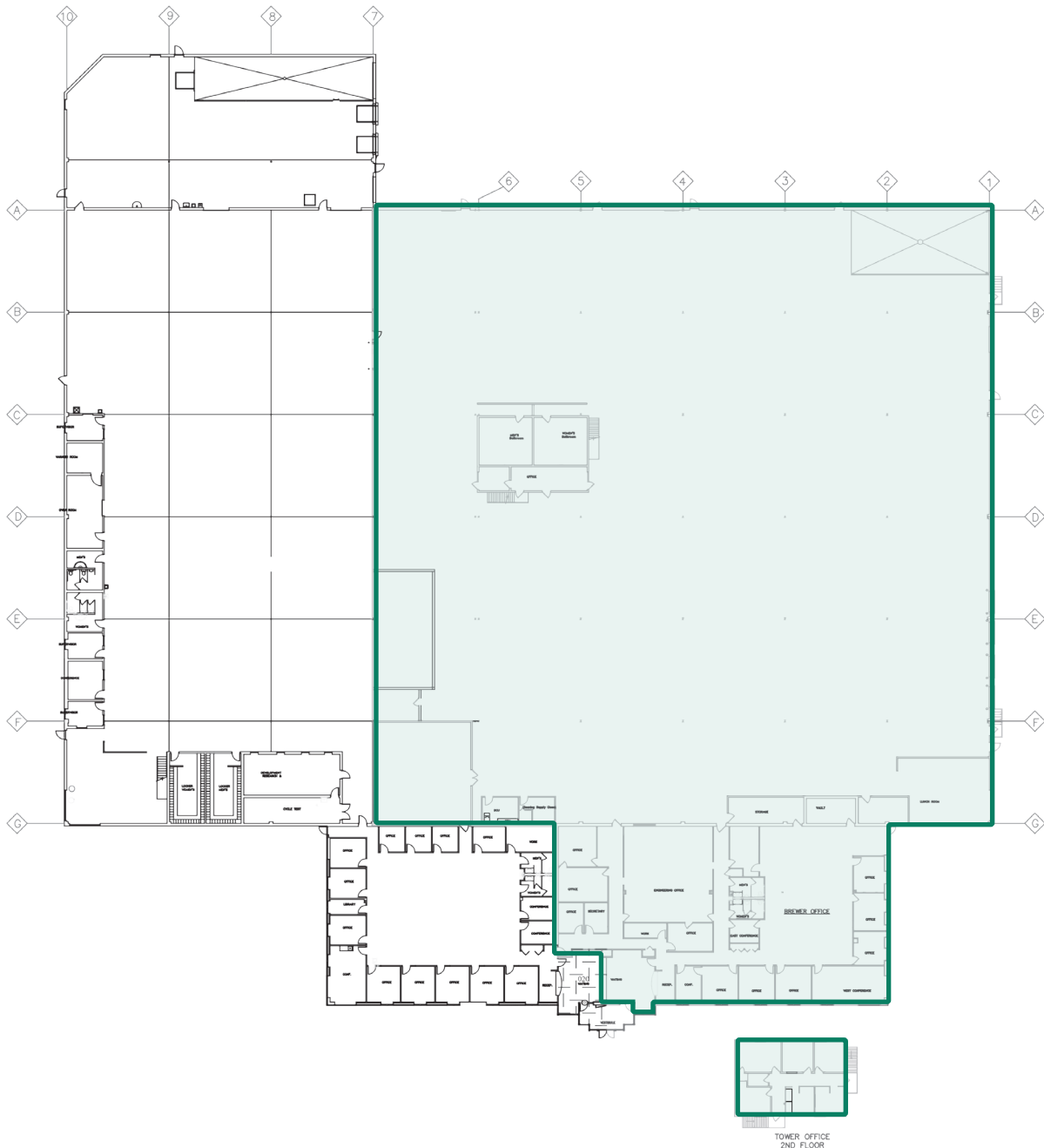



WAREHOUSE SPACE



WAREHOUSE SPACE



RECEPTION



OFFICE SPACE



CONFERENCE ROOM

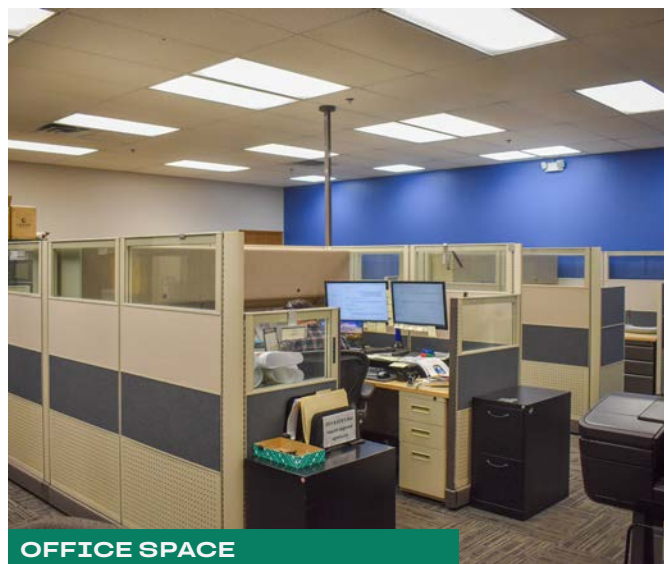

OFFICE SPACE

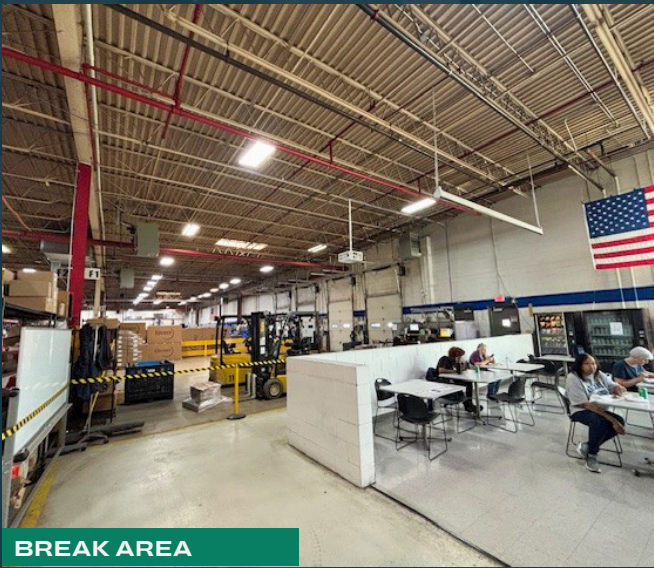

BREAK AREA



WAREHOUSE



WAREHOUSE



SIGNAGE

FOR LEASE

66,504 SF
MANUFACTURING SPACE

N88W13901 MAIN ST., MENOMONEE FALLS, WI

CONTACT

For more information or to schedule a tour, contact:

JAMES YOUNG

Senior Vice President

+1 262 853 4002

james.young@jll.com

JOE CAROLLO

Vice President

+1 414 412 3363

joe.carollo@jll.com

JLL Milwaukee

250 E. Wisconsin Ave. Suite 1700

Milwaukee, WI 53202

jll.com

Although information has been obtained from sources deemed reliable, neither Owner nor JLL makes any guarantees, warranties or representations, express or implied, as to the completeness or accuracy as to the information contained herein. Any projections, opinions, assumptions or estimates used are for example only. There may be differences between projected and actual results, and those differences may be material. The Property may be withdrawn without notice. Neither Owner nor JLL accepts any liability for any loss or damage suffered by any party resulting from reliance on this information. If the recipient of this information has signed a confidentiality agreement regarding this matter, this information is subject to the terms of that agreement. ©2026 Jones Lang LaSalle IP, Inc. All rights reserved.



DISCLOSURE TO NON-RESIDENTIAL CUSTOMERS

1 Prior to negotiating on your behalf the brokerage firm, or an agent associated with the firm, must provide you the
2 following disclosure statement:

- 3 **DISCLOSURE TO CUSTOMERS** You are a customer of the brokerage firm (hereinafter Firm). The Firm is either an agent
4 of another party in the transaction or a subagent of another firm that is the agent of another party in the transaction. A
5 broker or a salesperson acting on behalf of the Firm may provide brokerage services to you. Whenever the Firm is
6 providing brokerage services to you, the Firm and its brokers and salespersons (hereinafter Agents) owe you, the
7 customer, the following duties:
- 8 (a) The duty to provide brokerage services to you fairly and honestly.
 - 9 (b) The duty to exercise reasonable skill and care in providing brokerage services to you.
 - 10 (c) The duty to provide you with accurate information about market conditions within a reasonable time if you request
11 it, unless disclosure of the information is prohibited by law.
 - 12 (d) The duty to disclose to you in writing certain Material Adverse Facts about a property, unless disclosure of the
13 information is prohibited by law (see lines 42-51).
 - 14 (e) The duty to protect your confidentiality. Unless the law requires it, the Firm and its Agents will not disclose your
15 confidential information or the confidential information of other parties (see lines 23-41).
 - 16 (f) The duty to safeguard trust funds and other property held by the Firm or its Agents.
 - 17 (g) The duty, when negotiating, to present contract proposals in an objective and unbiased manner and disclose the
18 advantages and disadvantages of the proposals.

19 Please review this information carefully. An Agent of the Firm can answer your questions about brokerage services,
20 but if you need legal advice, tax advice, or a professional home inspection, contact an attorney, tax advisor, or home
21 inspector. This disclosure is required by section 452.135 of the Wisconsin statutes and is for information only. It is a
22 plain-language summary of the duties owed to a customer under section 452.133(1) of the Wisconsin statutes.

23 **CONFIDENTIALITY NOTICE TO CUSTOMERS** The Firm and its Agents will keep confidential any information given to the
24 Firm or its Agents in confidence, or any information obtained by the Firm and its Agents that a reasonable person
25 would want to be kept confidential, unless the information must be disclosed by law or you authorize the Firm to
26 disclose particular information. The Firm and its Agents shall continue to keep the information confidential after the
27 Firm is no longer providing brokerage services to you.

28 The following information is required to be disclosed by law:

- 29 1. Material Adverse Facts, as defined in Wis. Stat. § 452.01(5g) (see lines 42-51).
- 30 2. Any facts known by the Firm or its Agents that contradict any information included in a written inspection
31 report on the property or real estate that is the subject of the transaction.

32 To ensure that the Firm and its Agents are aware of what specific information you consider confidential, you may
33 list that information below (see lines 35-41) or provide that information to the Firm or its Agents by other means. At a
34 later time, you may also provide the Firm or its Agents with other Information you consider to be confidential.

35 **CONFIDENTIAL INFORMATION:** _____
36 _____
37 _____

38 **NON-CONFIDENTIAL INFORMATION** (the following information may be disclosed by the Firm and its Agents): _____
39 _____
40 _____

41 _____ *(Insert information you authorize to be disclosed, such as financial qualification information.)*

42 **DEFINITION OF MATERIAL ADVERSE FACTS**

43 A "Material Adverse Fact" is defined in Wis. Stat. § 452.01(5g) as an Adverse Fact that a party indicates is of such
44 significance, or that is generally recognized by a competent licensee as being of such significance to a reasonable
45 party, that it affects or would affect the party's decision to enter into a contract or agreement concerning a transaction
46 or affects or would affect the party's decision about the terms of such a contract or agreement.

47 An "Adverse Fact" is defined in Wis. Stat. § 452.01(1e) as a condition or occurrence that a competent licensee
48 generally recognizes will significantly and adversely affect the value of the property, significantly reduce the structural
49 integrity of improvements to real estate, or present a significant health risk to occupants of the property; or information
50 that indicates that a party to a transaction is not able to or does not intend to meet his or her obligations under a
51 contract or agreement made concerning the transaction.

52 **NOTICE ABOUT SEX OFFENDER REGISTRY** You may obtain information about the sex offender registry and persons
53 registered with the registry by contacting the Wisconsin Department of Corrections on the Internet at
54 <http://www.doc.wi.gov> or by telephone at 608-240-5830.

No representation is made as to the legal validity of any provision or the adequacy of any provision in any specific transaction.
Drafted by Attorney Debra Peterson Conrad