A photograph of the Northpointe Professional Center, a modern multi-story office building with a curved facade and large windows. The building is constructed of reddish-brown brick and has a prominent entrance canopy with the name 'Northpointe Professional Center' written on it. The sky is blue with light clouds.

Northpointe Professional Center

# **NORTHPOINTE PROFESSIONAL CENTER**

9425 North Nevada Street, Spokane, WA

## **OFFICE SPACE FOR LEASE**

Jones Lang LaSalle Brokerage, Inc.  
Real Estate License #: 01856260

## **ABOUT THE LANDLORD**

Established in the early 1970's, Vandervert Developments & Hotels has expanded exponentially in most recent years, now owning and managing dozens of development properties throughout the region. It is no surprise that Vandervert's legacy continues to grow thanks to the unwavering commitment to excellence and quality. We encourage you to discover for yourself why countless businesses have opted to lease their office, retail, and tech space from Vandervert Developments.

**VANDERVERT**  
*Developments*

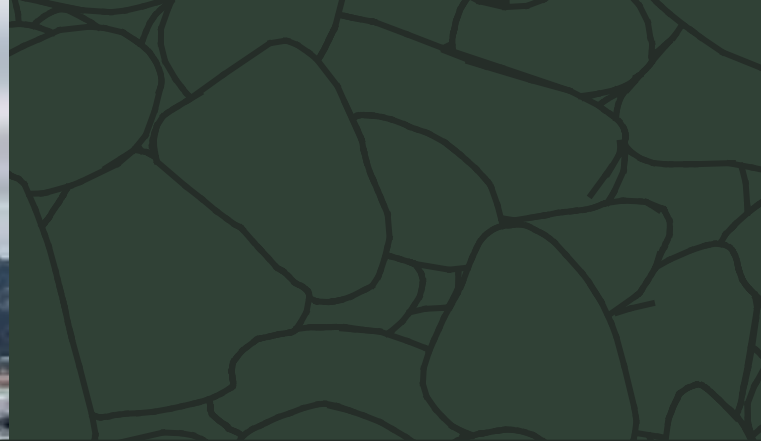

**LOCATED IN THE HEART OF  
SPOKANE'S NORTH CORRIDOR**

Northpointe Professional Center offers flexible office space in a variety of sizes to accommodate any tenant.

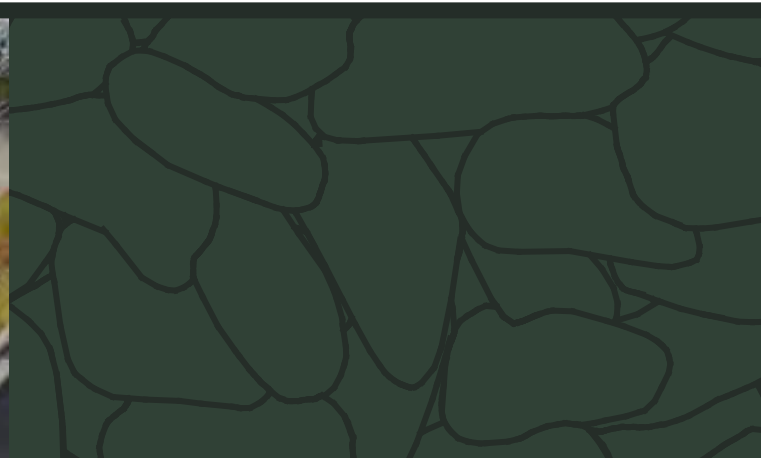

# FEATURES

- Elevator
- Grand staircase
- Natural light
- Updated units
- Locational amenities
- Exterior signage potential

**Leased space is offered on a fully serviced basis that includes:**

- Utilities
- Janitorial service
- Common area maintenance
- Snow removal

Tenant improvements are available to help users customize spaces to their individual needs.

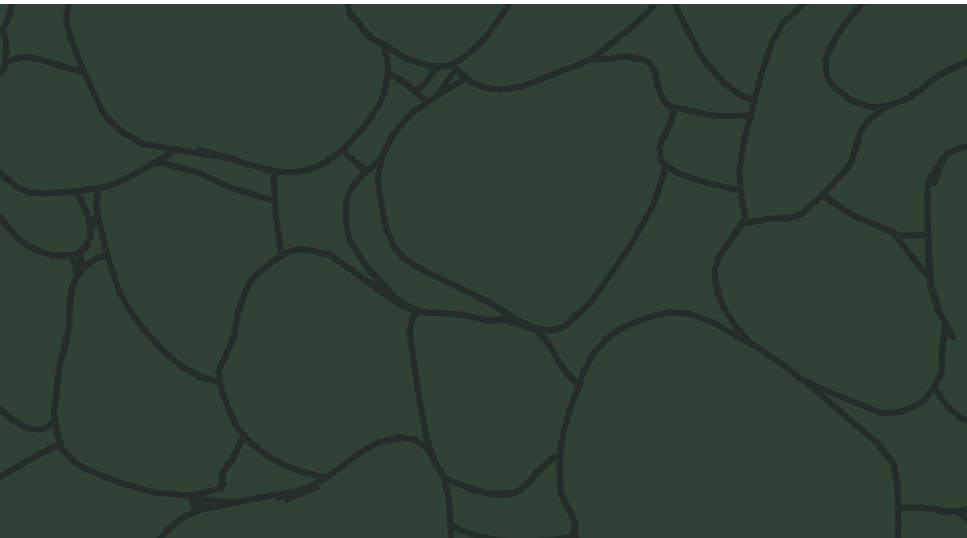

# FLOOR 1

Suite 100  
±3,030 SF

Suite 101  
±1,257 SF

Suite 102  
±844 SF

Highlights:  
Available Q3 2026



# FLOOR 2

Suite 206    Suite 212  
2,486 SF    605 SF

Highlights:  
Available now

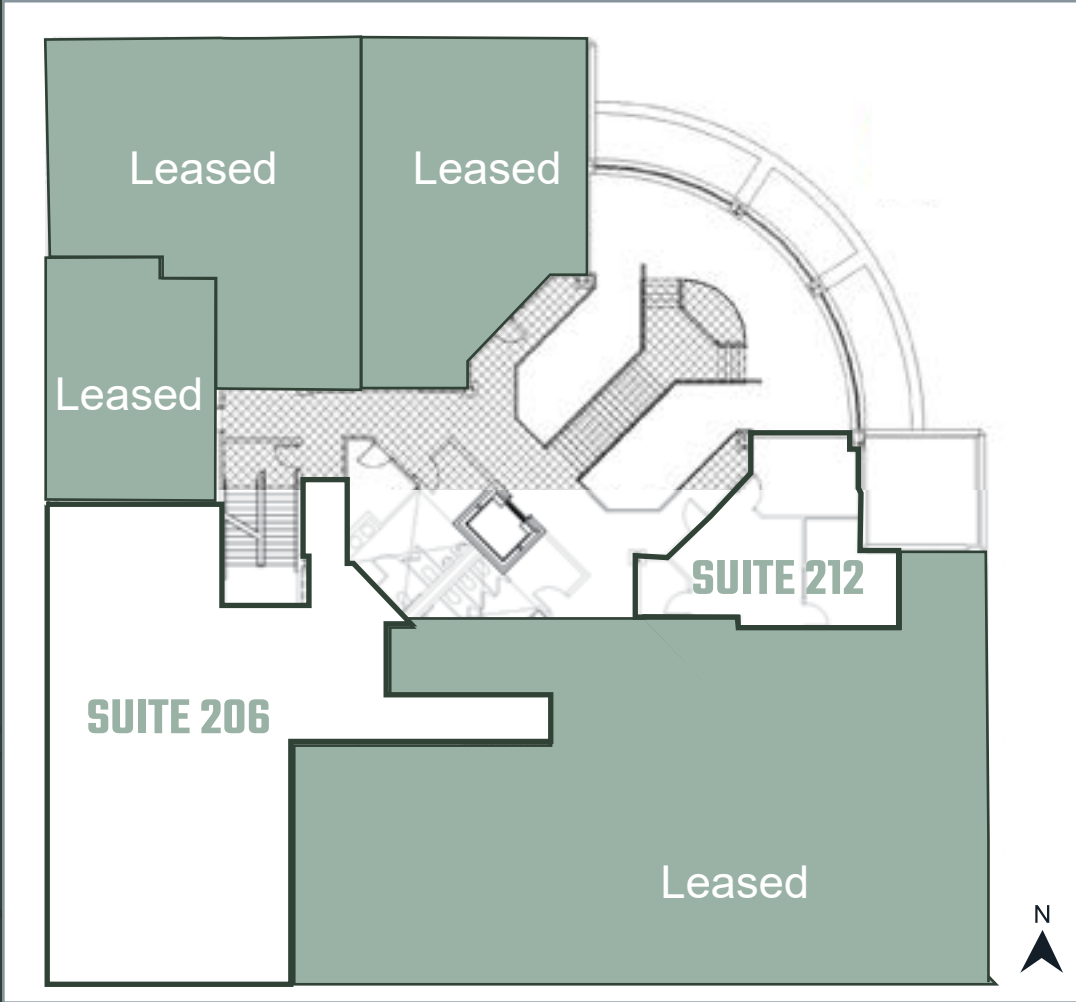





## **MICHAEL SHARAPATA**

Senior Managing Director  
+1 509 822 0088  
michael.sharapata@jll.com

## **JARED SMITH**

Vice President  
+1 509 505 7459  
j.smith@jll.com

Although information has been obtained from sources deemed reliable, JLL does not make any guarantees, warranties or representations, express or implied, as to the completeness or accuracy as to the information contained herein. Any projections, opinions, assumptions or estimates used are for example only. There may be differences between projected and actual results, and those differences may be material. JLL does not accept any liability for any loss or damage suffered by any party resulting from reliance on this information. If the recipient of this information has signed a confidentiality agreement with JLL regarding this matter, this information is subject to the terms of that agreement. ©2026 Jones Lang LaSalle Brokerage, Inc. All rights reserved.