

For Lease

±18,434 SF Industrial Space Available

2545 Napa Valley Corporate Drive, Suite A | Napa, CA

5,000 AMPS of power



Property Highlights



Rare availability and location in the city of Napa



Excellent visibility within the Napa Valley Commons; Napa's premier business park



Superior space for winery and food manufacturing production processing use types



Suite A - Specifications

- ±18,434 SF industrial space
- Includes ±5,000 SF of office area
- High profile, corner suite location
- 24' clear height
- 2 dock-high loading doors
- 1 grade-level loading door
- 5,000 amps, 270/480v, electrical service (tenant to verify electrical service)
- Skylights in warehouse
- Building signage available

Site Plan

2557 NVCD

2545 NVCD

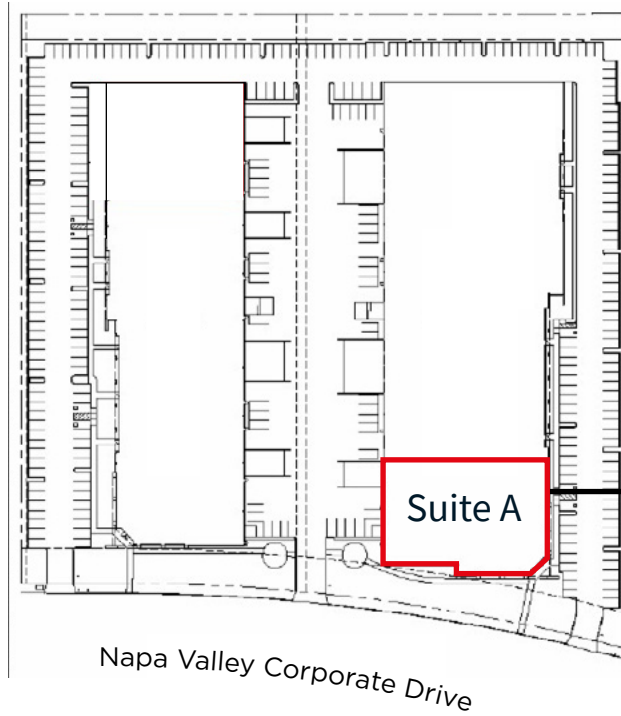

Floor Plan

Suite A

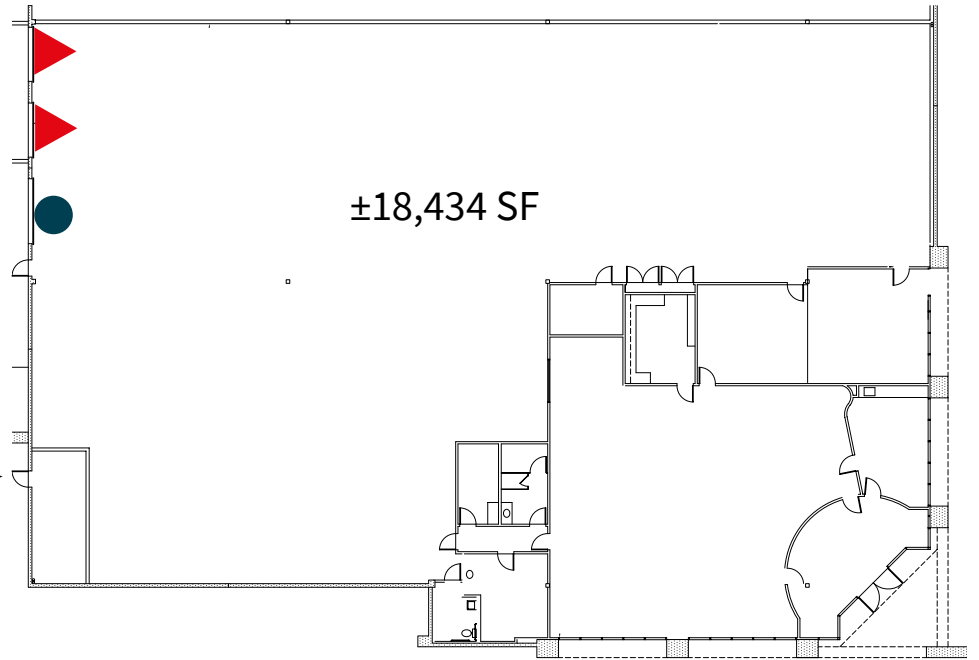

▲ Dock-high loading door

● Grade-level door

Ideal Location

2545 Napa Valley Corporate Drive is located within the City of Napa along Highway 221 with easy access to Highways 29 & 12. Within minutes of downtown Napa and close proximity to over 700 wineries in the Napa Valley.

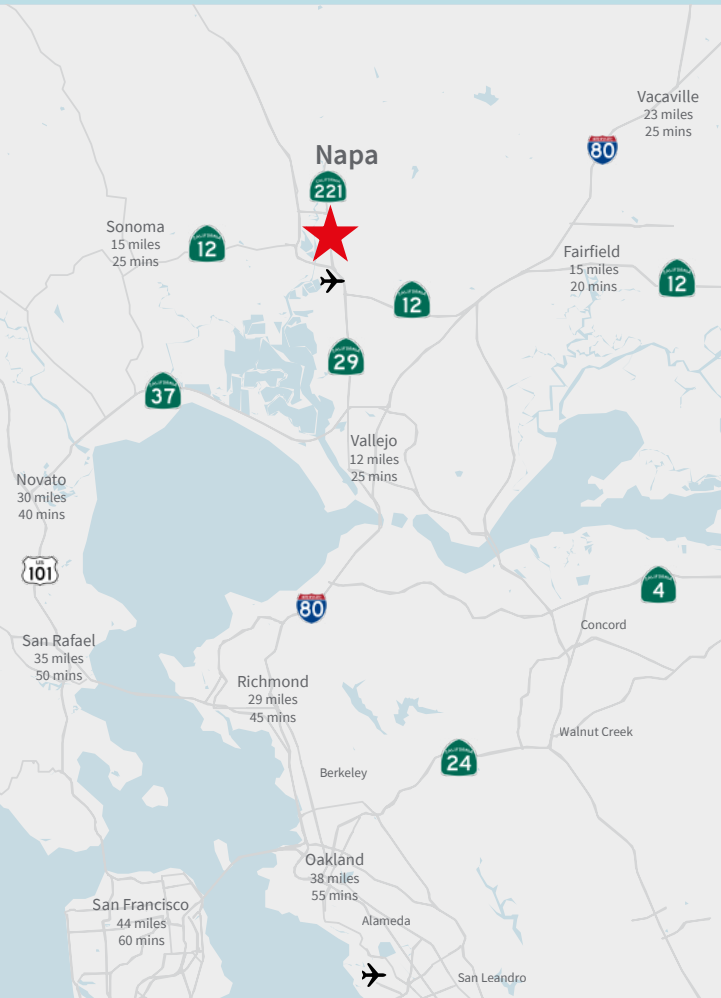

2545 Napa Valley Corporate Drive



Glen Dowling
RE Lic# 00890450
+1 707 227 7800
glen.dowling@jll.com

Chris Neeb
RE Lic# 01324612
+1 707 495 7777
chris.neeb@jll.com

Matt Bracco
RE Lic# 01185434
+1 925 200 3537
matt.bracco@jll.com



Jones Lang LaSalle Brokerage, Inc.
RE Lic #01856260

Although information has been obtained from sources deemed reliable, neither Owner nor JLL makes any guarantees, warranties or representations, express or implied, as to the completeness or accuracy as to the information contained herein. Any projections, opinions, assumptions or estimates used are for example only. There may be differences between projected and actual results, and those differences may be material. The Property may be withdrawn without notice. Neither Owner nor JLL accepts any liability for any loss or damage suffered by any party resulting from reliance on this information. If the recipient of this information has signed a confidentiality agreement regarding this matter, this information is subject to the terms of that agreement. ©2026. Jones Lang LaSalle IP, Inc. All rights reserved.