



For Lease

# 123 Ave Multi

14705/41 123 Avenue Edmonton, AB

±6,400 SF bay available

- ± 6,400 SF dock loading bay available
- Two access points into marshalling area
- Suitable for a wide range of uses

For more information contact:

**Kent Simpson**

Vice President

780 203 0425

[Kent.Simpson@jll.com](mailto:Kent.Simpson@jll.com)



# Property Details

<b>Municipal Address</b>	14705/41 123 Avenue, Edmonton AB
<b>Legal Description</b>	Plan 5951KS; Block 4A; Lot 6
<b>Zoning</b>	BE (Business Employment)
<b>Available Area</b>	±6,400 SF
<b>Occupancy</b>	May 1, 2026
<b>Lease Rate (PSF)</b>	\$8.00 PSF
<b>Op. Costs (PSF)</b>	\$6.01 PSF
<b>Power</b>	TBC by Tenant
<b>Ceiling Height</b>	14' clear
<b>Heating</b>	Ceiling mounted forced air unit heaters & radiant tube
<b>Loading</b>	Dock loading

**Unit 14729 - 33**  
±6,400 SF  
2 Dock doors  
Available May 1, 2026



## Unit 14729 - 33

±6,400 SF

2 Dock doors

Available May 1, 2026

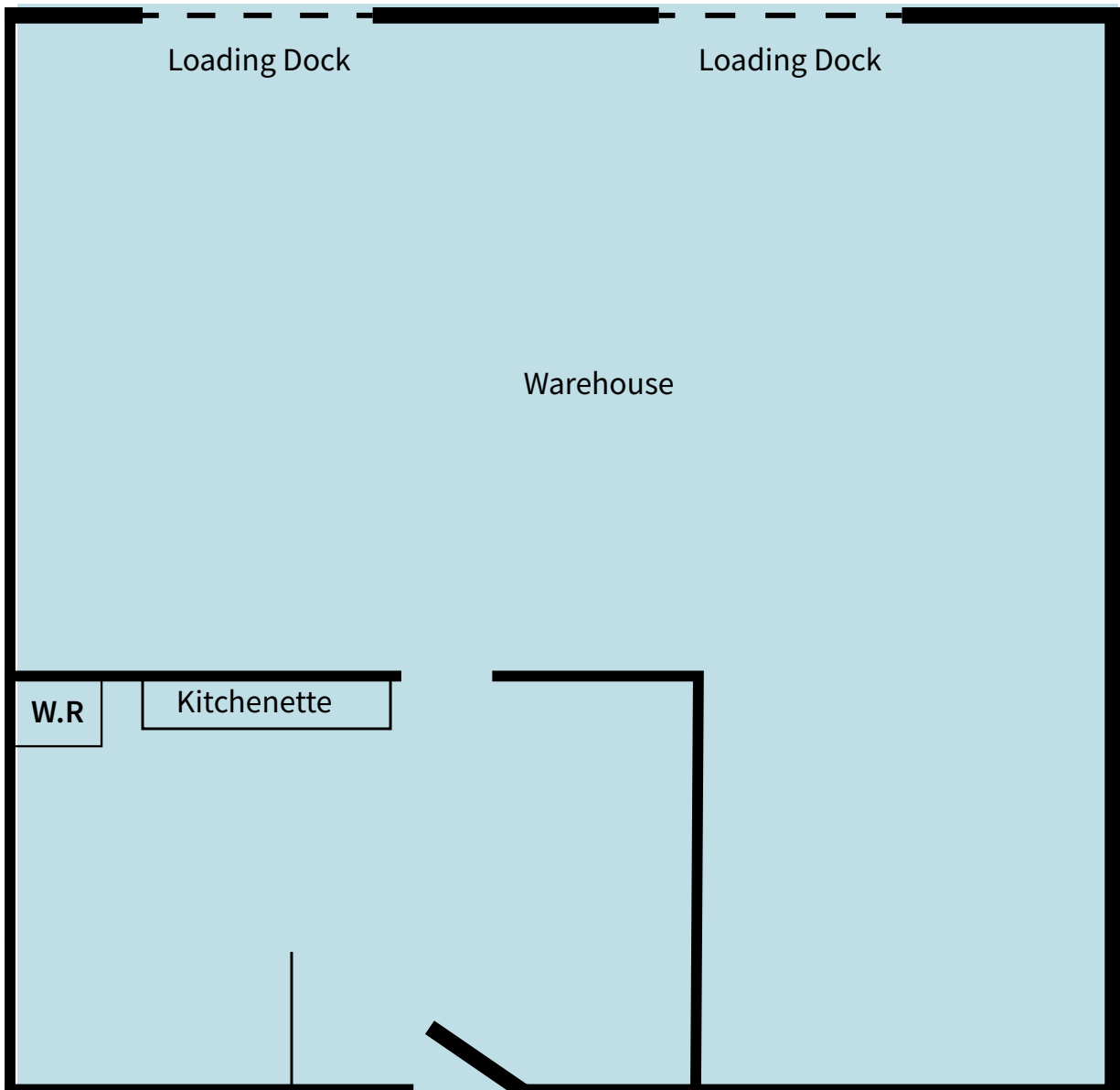

*\*Note: for representation purposes not drawn to scale*



Two access points into marshalling area with ample parking out front, great visibility along 123 Avenue with quick access to 149 Street, Yellowhead Highway, and Anthony Henday

**Darryl McGavigan**

Executive Vice President  
780 328 0064  
Darryl.McGavigan@jll.com

**Adam Butler**

Executive Vice President  
780 328 0065  
Adam.Butler@jll.com

**Bronwyn Scrivens**

Vice President, SIOR  
780 807 4564  
Bronwyn.Scrivens@jll.com

**Kent Simpson**

Vice President  
780 203 0425  
Kent.Simpson@jll.com

**Mackenzie York**

Associate Vice President  
780 920 8463  
Mackenzie.York@jll.com

**Kailee Campbell**

Senior Transaction Analyst  
780 328 0069  
Kailee.Campbell@jll.com

**JLL Edmonton Industrial** | National Bank Centre - 3560, 10180 101 Street NW, Edmonton, AB, T5J 3S4

DISCLAIMER: ©2026 Jones Lang LaSalle IP, Inc. All rights reserved. All information contained herein is from sources deemed reliable; however, no representation or warranty is made to the accuracy thereof. The Property may be withdrawn without notice. Neither Owner nor JLL accepts any liability for any loss or damage suffered by any party resulting from reliance on this information. Jones Lang LaSalle Real Estate Services, Inc.

